

Latitude: 40°15'00" (SHL) SURFACE HOLE 8486'

Latitude: 40°17'30" (BHL) BOTTOM HOLE 10835'

Longitude: 80°32'30" (SHL) SURFACE HOLE 1203'

Longitude: 80°32'30" (BHL) BOTTOM HOLE 10184'



CIVIL & ENVIRONMENTAL CONSULTANTS, INC.
600 MARKETPLACE AVENUE, SUITE 200
BRIDGEPORT, WV 26330
304-933-3119

PERMIT SURFACE HOLE LOCATION (SHL):

UTM (NAD83, ZONE 17, METERS):
NORTHING: 4,455,197.288
EASTING: 536,394.785

PERMIT LANDING POINT (LPL):

UTM (NAD83, ZONE 17, METERS):
NORTHING: 4,455,327.161
EASTING: 536,554.061

PERMIT BOTTOM HOLE LOCATION (BHL):

UTM (NAD83, ZONE 17, METERS):
NORTHING: 4,457,107.998
EASTING: 535,853.476

SURFACE HOLE LOCATION (SHL):

UTM (NAD83, ZONE 17, METERS):
NORTHING: 4,455,197.262
EASTING: 536,394.767

LANDING POINT (LPL):

UTM (NAD83, ZONE 17, METERS):
NORTHING: 4,455,320.105
EASTING: 536,548.886

BOTTOM HOLE LOCATION (BHL):

UTM (NAD83, ZONE 17, METERS):
NORTHING: 4,457,101.890
EASTING: 535,653.697

GRID NORTH
UTM, NAD83 DATUM, ZONE 17, US FT

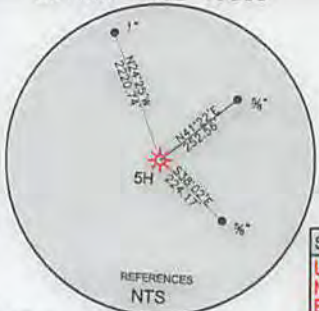

AS-DRILLED

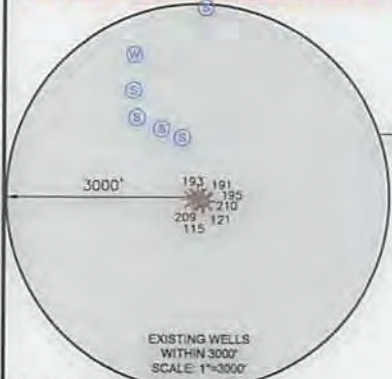

WELL RESTRICTIONS

1. NO OCCUPIED DWELLINGS > 2500 SQ FT. WITHIN 625 FEET OF CENTER OF PAD.
2. NO AGRICULTURE BUILDINGS > 2500 SQ FT. WITHIN 625 FEET OF CENTER OF PAD.
3. WATER WELLS OR DEVELOPED SPRINGS ARE WITHIN 969 FEET OF PROPOSED WELL.
4. PERENNIAL STREAMS, LAKES, PONDS, OR RESERVOIRS WITHIN 800 FEET OF THE LIMITS OF DISTURBANCE.
5. NO NATURALLY PRODUCING TROUT STREAM WITHIN 300 FEET OF LIMITS OF DISTURBANCE.
6. NO GROUND INTAKE OR PUBLIC WATER SUPPLY WITHIN 1000 FEET OF WELL PAD, LIMITS OF DISTURBANCE, E & S CONTROLS OR PUBLIC WATER SUPPLY.

NOTES ON SURVEY

1. SURFACE AND ROYALTY OWNER INFORMATION AND THEIR BOUNDARIES SHOWN HEREON WERE PLOTTED FROM DEEDS AND/OR TAX PARCEL MAPS PROVIDED BY CLIENT AND/OR FIELD LOCATIONS.
2. THIS PLAT DOES NOT REPRESENT A BOUNDARY SURVEY OF THE PARCELS SHOWN HEREON.
4. ALL INSETS ARE GRID NORTH UNLESS OTHERWISE DEPICTED.

I, THE UNDERSIGNED, HEREBY CERTIFY THAT THIS PLAT IS CORRECT TO THE BEST OF MY KNOWLEDGE AND BELIEF AND SHOWS ALL THE INFORMATION REQUIRED BY LAW AND REGULATIONS ISSUED AND PRESCRIBED BY THE DEPARTMENT OF ENVIRONMENTAL PROTECTION.

P.S. 991

Dennis E. Miller

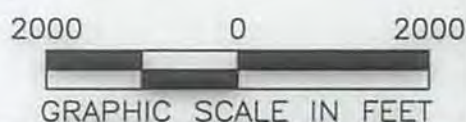

COMPANY: **SWN** Production Company, LLC



(+) DENOTES LOCATION OF WELL ON UNITED STATES TOPOGRAPHIC MAPS
WVDEP
OFFICE OF OIL & GAS
601 57TH STREET
CHARLESTON, WV 25034

MINIMUM DEGREE OF ACCURACY: 1/200
PROVEN SURVEY SOURCE OF GRADE GPS ELEVATION: (NAVD 88, US FT)

ALAN H DEGARMO BRK
OPERATOR'S WELL #: 5H
API WELL #: 47 STATE 009 COUNTY 00190 PERMIT

WELL TYPE: OIL WASTE DISPOSAL PRODUCTION DEEP GAS LIQUID INJECTION STORAGE SHALLOW
 WATERSHED: UPPER OHIO SOUTH ELEVATION: 1204.0
 DISTRICT: BUFFALO COUNTY: BROOKE QUADRANGLE: BETHANY
 SURFACE OWNER: ALAN H. DEGARMO & MARY KAY DEGARMO LIFE ESTATE ACREAGE: 140.97±
 OIL & GAS ROYALTY OWNER: ALAN H. DEGARMO ACREAGE: 140.97±
 DRILL DRILL DEEPER REDRILL FRACTURE OR STIMULATE PLUG OFF OLD FORMATION PERFORATE NEW FORMATION
 CONVERT PLUG & ABANDON CLEAN OUT & REPLUG OTHER CHANGE (SPECIFY) **ASDRILLED**
 TARGET FORMATION: MARCELLUS ESTIMATED DEPTH: 5851 TVD 12,772 TMD

WELL OPERATOR: SWN PRODUCTION COMPANY, LLC DESIGNATED AGENT: DEE SOUTHALL
 ADDRESS: P.O. BOX 1300 ADDRESS: P.O. BOX 1300
 CITY: JANE LEW STATE: WV ZIP CODE: 26378 CITY: JANE LEW STATE: WV ZIP CODE: 26378

LEGEND:

	PROPOSED SURFACE HOLE / BOTTOM HOLE		SURVEYED BOUNDARY
	EXISTING / PRODUCING WELLHEAD		DRILLING UNIT
	LANDING POINT LOCATION		LEASE BOUNDARY
	EXISTING WATER WELL		ASDRILLED PATH
	EXISTING SPRING		PROPOSED PATH

REVISIONS:	DATE: 04-18-2017
	DRAWN BY: K.E.S.
	SCALE: 1" = 2000'
	DRAWING NO: 164-764
	WELL LOCATION PLAT



AS-DRILLED

CIVIL & ENVIRONMENTAL CONSULTANTS, INC.
600 MARKETPLACE AVENUE, SUITE 200
BRIDGEPORT, WV 26330
304-933-3119

WELL BORE TABLE FOR SURFACE OWNERS			
TRACT	SURFACE OWNER	TAX PARCEL	ACRES
1	ALAN H. DEGARMO AND MARY KAY DEGARMO LIFE ESTATE	3-B33-20	140.97
2	WEST VIRGINIA DEPARTMENT OF TRANSPORTATION, DIVISION OF HIGHWAYS	GENTEEL RIDGE ROAD	1.68

ADJOINING OWNERS TABLE			
TRACT	SURFACE OWNER	TAX PARCEL	ACRES
A	CHARLES STEWART	3-B33-55.1	1.01
B	JEFFERY L. MARTINDILL	3-B33-9	1.6
C	RICHARD C. & BONNIE OLENICK	3-B33-8	1.4
D	EDWARD FRANK MARKER III & TERESA ANN MARKER	3-B33-11	1.68
E	JOHN WILLIAM & HELEN DARLENE MCGOWAN	3-B33-15	2.49
F	JOHN WILLIAM & HELEN DARLENE MCGOWAN	3-B33-16	2.50
G	ROBERT ANTILL JR. & CYNTHIA ANTILL	3-B33-17.2	1.053
H	LEONARD F. WOODS III & LISA MARIE WOODS	3-B33-17.1	2.0
I	ROBERT ANTILL JR. & CYNTHIA ANTILL	3-B33-18	0.90
J	THOMAS M. & DEBORAH J. OLDAKER	3-B33-2	0.41
K	THOMAS M. & DEBORAH J. OLDAKER	3-B33-1	2.39
L	JOANN MYERS LIFE ESTATE & JAMES W. MYERS REMAINDER	3-B33-19	2.40
M	MICHEAL W. SOMON	3-B27-25	3.12
N	ANTHONY & KRYSTEN LONG	3-B27-24	0.68
O	LARRY B. & SHELLY ARACICH	3-B27-23	5.01
P	VERMURI HOME & GARDEN LLC.	3-B27-20	0.459
Q	DAVID E. & DEBORAH CRAWFORD	3-B27-19	1.60
R	DAVID E. & DEBORAH CRAWFORD	3-B27H-50	5.69
S	JAMES & KRISTIE FLOYD	3-B27H-49	5.03
T	MARY B. WILSON NORTHCRAFT	3-B27H-48	3.22
U	WILLIAM GEORGE ALLISON & CHERYL ANN ALLISON	3-B27H-48.1	18.49
V	ROBERT & LUANN SOMON	3-B28E-1	3.92
W	GEORGE & DEBORAH A STRAKA	3-B28E-2	3.46
X	RUSSELL D HERVEY	3-B28E-5	1.0
Y	JOEL LYNN ROGERS SR.	3-B28E-4	1.0
Z	JOEL LYNN ROGERS SR.	3-B28E-14	1.0
AA	CHAD E. ROGERS	3-B28E-15	1.0
BB	LARRY & JOAN NICHOLSON	3-B28E-16	1.13
CC	CALVIN STANLEY & LYNETTE STANLEY	3-B28-1	0.85
DD	CALVIN STANLEY & LYNETTE STANLEY	3-B28-2	1.15
EE	DANIEL STANLEY	3-B28-3	3.89
FF	JOHN & LUANNE SNYDER	3-B28-8	4.382
GG	JOHN & LUANNE SNYDER	3-B28-9	4.04
HH	LANA LOU GILKEY	3-B28-19	8.83
II	RYAN & CAROLYN BOOK	3-B28-25	1.60
JJ	ROBERT W & TAMMY L HOLMES	3-B28-24	0.5
KK	ALEXANDER & DONNA DIGHT	3-B28-21	0.74
LL	ALEXANDER & DONNA DIGHT	3-B28-22	0.67
MM	ALEXANDER & DONNA DIGHT	3-B28-23	0.66
NN	CHARLES & MADELIN MCGOWAN	3-B28-26	1.0
OO	TRUSTEES OF THE STONE CHAPEL CHURCH	3-B33-36	0.3
PP	JOH T & MARLENA L SMITH	3-B33-37	2.0
QQ	LEONA LAROCHE, LAWRENCE MCLAUGHLIN, & FLOYD HENNIS	3-B33-38	2.18
RR	LEONA LAROCHE, LAWRENCE MCLAUGHLIN, & FLOYD HENNIS	3-B33-39	1.1
SS	CHARLES & ETHEL RUSSELL	3-B33-42	1.0
TT	LISA MERIGO	3-B33-44	1.0
UU	AMY & NICKOLAS CROSS	3-B33-45	3.52
VV	KATHRYN DEGARMO	3-B33-20.1	2.50
WW	MARRY ANN CHARLTON & DAVID M. EDWARDS	3-B33-21	1.53
XX	PATRICK DEGARMO	3-B33-20.2	1.53

07/20/2018

REVISIONS:	COMPANY:		
	OPERATOR'S	ALAN H DEGARMO BRK	
	WELL #:	5H	
	DISTRICT:	COUNTY:	STATE:
	BUFFALO	BROOKE	WV
			DATE: 04-18-2017
			DRAWN BY: K.E.S.
			SCALE: N/A
			DRAWING NO: 164-764
			WELL LOCATION PLAT 2