

Longitude: 80°32'30" SURFACE HOLE 8563' Longitude: 80°35'00" BOTTOM HOLE 855' Latitude: 40°15'00" SURFACE HOLE 1203'



CIVIL & ENVIRONMENTAL CONSULTANTS, INC.
600 MARKETPLACE AVENUE, SUITE 200
BRIDGEPORT, WV 26330
304-933-3119

SURFACE HOLE LOCATION (SHL):
UTM (NAD83, ZONE 17, METERS):
NORTHING: 4,455,195.789
EASTING: 536,377.789
LANDING POINT (LPL):
UTM (NAD83, ZONE 17, METERS):
NORTHING: 4,455,045.562
EASTING: 536,071.870
BOTTOM HOLE LOCATION (BHL):
UTM (NAD83, ZONE 17, METERS):
NORTHING: 4,456,885.134
EASTING: 535,210.074

GRID NORTH
UTM, NAD83 DATUM, ZONE 17, US FT

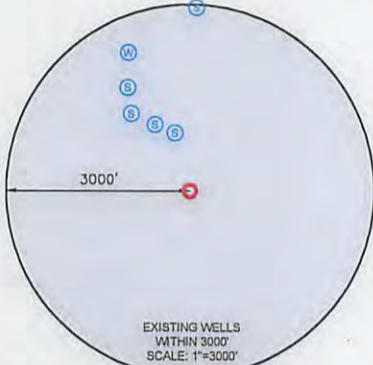
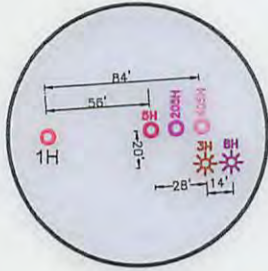

WELL RESTRICTIONS

1. NO OCCUPIED DWELLINGS > 2500 SQ FT. WITHIN 625 FEET OF CENTER OF PAD.
2. NO AGRICULTURE BUILDINGS > 2500 SQ FT. WITHIN 625 FEET OF CENTER OF PAD.
3. WATER WELLS OR DEVELOPED SPRINGS ARE WITHIN 957 FEET OF PROPOSED WELL.
4. PERENNIAL STREAMS, LAKES, PONDS, OR RESERVOIRS WITHIN 800 FEET OF THE LIMITS OF DISTURBANCE.
5. NO NATURALLY PRODUCING TROUT STREAM WITHIN 300 FEET OF LIMITS OF DISTURBANCE.
6. NO GROUND INTAKE OR PUBLIC WATER SUPPLY WITHIN 1000 FEET OF WELL PAD, LIMITS OF DISTURBANCE, E & S CONTROLS OR PUBLIC WATER SUPPLY.

NOTES ON SURVEY

1. SURFACE AND ROYALTY OWNER INFORMATION AND THEIR BOUNDARIES SHOWN HEREON WERE PLOTTED FROM DEEDS AND/OR TAX PARCEL MAPS PROVIDED BY CLIENT AND/OR FIELD LOCATIONS.
2. THIS PLAT DOES NOT REPRESENT A BOUNDARY SURVEY OF THE PARCELS SHOWN HEREON.
3. ALL INSETS ARE GRID NORTH UNLESS OTHERWISE DEPICTED.

I, THE UNDERSIGNED, HEREBY CERTIFY THAT THIS PLAT IS CORRECT TO THE BEST OF MY KNOWLEDGE AND BELIEF AND SHOWS ALL THE INFORMATION REQUIRED BY LAW AND REGULATIONS ISSUED AND PRESCRIBED BY THE DEPARTMENT OF ENVIRONMENTAL PROTECTION.

P.S. 991



COMPANY: **SWN** Production Company, LLC

<p>(+) DENOTES LOCATION OF WELL ON UNITED STATES TOPOGRAPHIC MAPS</p> <p>WVDEP OFFICE OF OIL & GAS 601 57TH STREET CHARLESTON, WV 25034</p>	<p>MINIMUM DEGREE OF ACCURACY: 1/200</p> <p>PROVEN SURVEY SOURCE OF ELEVATION: GRADE GPS (NAVD 88, US FT)</p>	<p>ALAN H DEGARMO BRK</p> <p>OPERATOR'S WELL #: 1H</p> <p>API WELL #: 47 009 00193 H6A</p> <p>STATE COUNTY PERMIT</p>
---	---	---

WELL TYPE: OIL WASTE DISPOSAL PRODUCTION DEEP GAS LIQUID INJECTION STORAGE SHALLOW

WATERSHED: UPPER OHIO SOUTH ELEVATION: 1204.0

DISTRICT: BUFFALO COUNTY: BROOKE QUADRANGLE: BETHANY

SURFACE OWNER: ALAN H DEGARMO & MARY KAY DEGARMO, LIFE ESTATE ACREAGE: 140.97±

OIL & GAS ROYALTY OWNER: ALAN H DEGARMO ACREAGE: 140.97±

DRILL DRILL DEEPER REDRILL FRACTURE OR STIMULATE PLUG OFF OLD FORMATION PERFORATE NEW FORMATION

CONVERT PLUG & ABANDON CLEAN OUT & REPLUG OTHER CHANGE (SPECIFY)

TARGET FORMATION: MARCELLUS ESTIMATED DEPTH: 5,902 TVD 13,133 TMD

WELL OPERATOR: SWN PRODUCTION COMPANY, LLC DESIGNATED AGENT: DEE SOUTHALL

ADDRESS: P.O. BOX 1300 ADDRESS: P.O. BOX 1300

CITY: JANE LEW STATE: WV ZIP CODE: 26378 CITY: JANE LEW STATE: WV ZIP CODE: 26378

<p>LEGEND:</p> <ul style="list-style-type: none"> ○ PROPOSED SURFACE HOLE / BOTTOM HOLE ☼ EXISTING / PRODUCING WELLHEAD LPL* LANDING POINT LOCATION ⊙ EXISTING WATER WELL ⊙ EXISTING SPRING — SURVEYED BOUNDARY — DRILLING UNIT ==== LEASE BOUNDARY — PROPOSED PATH 	<p>REVISIONS:</p> <table border="1"> <tr> <td> </td> <td> </td> </tr> <tr> <td> </td> <td> </td> </tr> <tr> <td> </td> <td> </td> </tr> </table>							<p>DATE: 01-18-2017</p> <p>DRAWN BY: D. MILLER</p> <p>SCALE: 1" = 2000'</p> <p>DRAWING NO: XXXXX</p> <p>WELL LOCATION PLAT</p>



CIVIL & ENVIRONMENTAL CONSULTANTS, INC.
 600 MARKETPLACE AVENUE, SUITE 200
 BRIDGEPORT, WV 26330
 304-933-3119

WELL BORE TABLE FOR SURFACE / ROYALTY OWNERS			
TRACT	SURFACE OWNER (S) / ROYALTY OWNER (R)	TAX PARCEL	ACRES
	ALAN H. DEGARMO & MARY KAY DEGARMO LIFE ESTATE KATHRYN A. DEGARMO AND PATRICK A. DEGARMO REMAINDER	3-B33-20	140.97
TRACT	SURFACE OWNER	TAX PARCEL	ACRES
1	CHRISTY A. CYBULSKI	3-B33-10	87.12

ADJOINING OWNERS TABLE			
TRACT	SURFACE OWNER	TAX PARCEL	ACRES
A	CHARLES STEWART	3-B33-55.1	1.01
B	JEFFERY L. MARTINDILL	3-B33-9	1.6
C	RICHARD C. & BONNIE OLENICK	3-B33-8	1.4
D	EDWARD FRANK MARKER III & TERESA ANN MARKER	3-B33-11	1.68
E	JOHN WILLIAM & HELEN DARLENE MCGOWAN	3-B33-15	2.49
F	JOHN WILLIAM & HELEN DARLENE MCGOWAN	3-B33-16	2.5
G	ROBERT ANTILL, JR & CYNTHIA ANTILL	3-B33-17.2	1.0530
H	JOANN MYERS LIFE ESTATE & JAMES W. MYERS REMAINDER	3-B33-19	2.40
I	THOMAS M. & DEBORAH J. OLDAKER	3-B33-1	2.39
J	MICHEAL W. SOMON	3-B27-25	3.12
K	LARRY B. & SHELLY D. ARACICH	3-B27-23	5.01
L	ZACCHEUS PROPERTIES	3-B27-20	0.459
M	KATHRYN DEGARMO	3-B33-20.1	2.5
N	MARY ANN CHARLTON & DAVID M. EDWARDS	3-B33-21	1.5329
O	PARTICK DEGARMO	3-B33-20.2	1.53

9-00193 H6A
 06/02/2017

REVISIONS:	COMPANY:			DATE: 01-18-2017
				DRAWN BY: D. MILLER
	OPERATOR'S	ALAN H DEGARMO BRK		SCALE: N/A
	WELL #:	1H		DRAWING NO: XXXXX
	DISTRICT:	COUNTY:	STATE:	WELL LOCATION PLAT 2
	BUFFALO	BROOKE	WV	