

LATITUDE: 40°15'00" SURFACE HOLE

6265'

LATITUDE: 40°15'00" BOTTOM HOLE

10155'

JHA
SURVEYORS
ENGINEERS
ENVIRONMENTAL
GIS MAPPING

www.jhacompanies.com
68011 Vineyard Road
St. Clairsville, Ohio 43950
740-695-6100

EXISTING BOTTOM HOLE

LINE	BEARING	DISTANCE
L1	S75°04'47"E	956.91'
L2	S28°42'56"W	1878.01'

GRID NORTH
UTM, NAD83 DATUM, ZONE 17, US FT

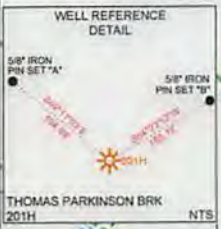

SURFACE HOLE LOCATION (SHL): UTM (NAD83, ZONE 17, METERS): NORTHING: 4451461.07 EASTING: 537093.33
LANDING POINT LOCATION (LPL): UTM (NAD83, ZONE 17, METERS): NORTHING: 4451399.69 EASTING: 536787.13
BOTTOM HOLE LOCATION (BHL): UTM (NAD83, ZONE 17, METERS): NORTHING: 4453863.04 EASTING: 535891.14

- NOTES ON SURVEY**
- COORDINATE SYSTEM IS UTM NAD 83 DATUM, ZONE 17, U.S. FOOT AND WELL COORDINATES ESTABLISHED USING SURVEY GRADE GPS.
 - SURFACE AND ROYALTY OWNER INFORMATION AND THEIR BOUNDARIES SHOWN HEREON WERE PLOTTED FROM DEEDS AND/OR TAX PARCEL MAPS PROVIDED BY CLIENT AND/OR FIELD LOCATIONS.
 - THIS PLAT DOES NOT REPRESENT A BOUNDARY SURVEY OF THE PARCELS SHOWN HEREON.
 - NO DWELLINGS OR BUILDINGS WITHIN 825 FEET OF PROPOSED CENTER OF PAD.
 - NO PERENNIAL STREAMS, LAKES, PONDS, RESERVOIRS OR WETLANDS WITHIN 100 FEET OF THE LIMITS OF DISTURBANCE.
 - NO NATURALLY PRODUCING TROUT STREAM WITHIN 300 FEET OF THE LIMITS OF DISTURBANCE.
 - NO WATER WELLS OR DEVELOPED SPRINGS WITHIN 250 FEET OF PROPOSED WELL.
 - THIS AS-DRILLED PLAT IS PREPARED FROM THE FINAL WELL PLAT PREPARED BY ANOTHER CONSULTANT AND THE DRILLING INFORMATION IS PROVIDED TO JHA.

SURFACE HOLE LOCATION (SHL): UTM (NAD83, ZONE 17, METERS): NORTHING: 4451460.93 EASTING: 537093.48
LANDING POINT LOCATION (LPL): UTM (NAD83, ZONE 17, METERS): NORTHING: 4451531.13 EASTING: 536736.53
BOTTOM HOLE LOCATION (BHL): UTM (NAD83, ZONE 17, METERS): NORTHING: 4453860.37 EASTING: 535895.54

I, THE UNDERSIGNED, HEREBY CERTIFY THAT THIS PLAT IS CORRECT TO THE BEST OF MY KNOWLEDGE AND BELIEF AND SHOWS ALL THE INFORMATION REQUIRED BY LAW AND REGULATIONS ISSUED AND PRESCRIBED BY THE DEPARTMENT OF ENVIRONMENTAL PROTECTION.

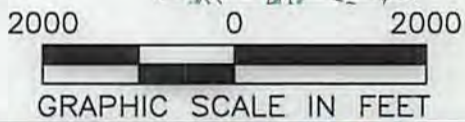

COMPANY: **SWN** Production Company, LLC

<p>WVDEP OFFICE OF OIL & GAS 601 57TH STREET CHARLESTON, WV 25034</p>	(+) DENOTES LOCATION OF WELL ON UNITED STATES TOPOGRAPHIC MAPS MINIMUM DEGREE OF ACCURACY: 1/200 PROVEN SURVEY SOURCE OF GRADE GPS ELEVATION: (NAVD 88, US FT)	THOMAS PARKINSON BRK OPERATOR'S WELL #: 201H API WELL #: 47 009 00235 STATE COUNTY PERMIT
---	--	--

WELL TYPE: OIL WASTE DISPOSAL PRODUCTION DEEP GAS LIQUID INJECTION STORAGE SHALLOW

WATERSHED: UPPER OHIO SOUTH ELEVATION: 1,160.5'

DISTRICT: BUFFALO COUNTY: BROOKE QUADRANGLE: BETHANY, WV

SURFACE OWNER: BETHANY COLLEGE ACREAGE: ±822.26

OIL & GAS ROYALTY OWNER: BETHANY COLLEGE, A CORPORATION, F/N/A THE TRUSTEES OF BETHANY COLLEGE, F/N/A THE TRUSTEES OF BETHANY COLLEGE, A CORPORATION ACREAGE: ±822.26

DRILL DRILL DEEPER REDRILL FRACTURE OR STIMULATE PLUG OFF OLD FORMATION PERFORATE NEW FORMATION

CONVERT PLUG & ABANDON CLEAN OUT & REPLUG OTHER CHANGE (SPECIFY) AS-DRILLED

TARGET FORMATION: MARCELLUS ESTIMATED DEPTH: 6,000' TVD 15,078.0' TMD

WELL OPERATOR: SWN PRODUCTION COMPANY, LLC DESIGNATED AGENT: BRITTANY WOODY
 ADDRESS: P.O. BOX 1300 ADDRESS: P.O. BOX 1300
 CITY: JANE LEW STATE: WV ZIP CODE: 26378 CITY: JANE LEW STATE: WV ZIP CODE: 26378

LEGEND:	<ul style="list-style-type: none"> PROPOSED SURFACE HOLE / BOTTOM HOLE EXISTING / PRODUCING WELLHEAD LPL: LANDING POINT LOCATION EXISTING WATER WELL EXISTING SPRING PUBLIC ROAD NATURAL WATERWAY SURVEYED BOUNDARY LEASE BOUNDARY ASDRILLED PATH PROPOSED PATH 	REVISIONS: DATE: 09-28-2018 DRAWN BY: D. REED SCALE: 1" = 2000' DRAWING NO: 2018-675 WELL LOCATION PLAT
----------------	--	---