

JHA
SURVEYORS
ENGINEERS
ENVIRONMENTAL
GIS MAPPING

www.jhacompanies.com
68611 Vineyard Road
St. Clairsville, Ohio 43086
740-695-8100

LINE	BEARING	DISTANCE
L1	N06°53'22"W	1814.30'
L2	S12°11'51"W	1902.30'

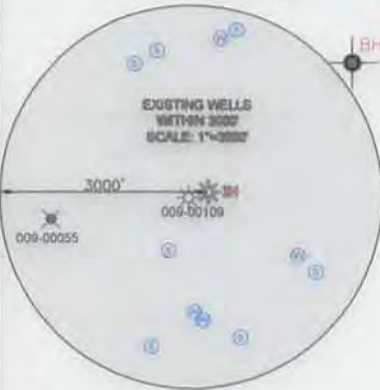
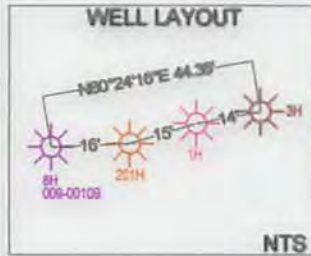
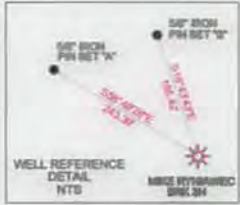

SURFACE HOLE LOCATION (SHL): UTM (NAD83, ZONE 17, METERS): NORTHING: 4448997.45 EASTING: 533265.00
LANDING POINT LOCATION (LPL): UTM (NAD83, ZONE 17, METERS): NORTHING: 4449298.84 EASTING: 533145.39
BOTTOM HOLE LOCATION (BHL): UTM (NAD83, ZONE 17, METERS): NORTHING: 4452287.49 EASTING: 532016.96

I, THE UNDERSIGNED, HEREBY CERTIFY THAT THIS PLAT IS CORRECT TO THE BEST OF MY KNOWLEDGE AND BELIEF AND SHOWS ALL THE INFORMATION REQUIRED BY LAW AND REGULATIONS ISSUED AND PRESCRIBED BY THE DEPARTMENT OF ENVIRONMENTAL PROTECTION.

P.S. 2041



(+) DENOTES LOCATION OF WELL ON UNITED STATES TOPOGRAPHIC MAPS

WVDEP
OFFICE OF OIL & GAS
601 57TH STREET
CHARLESTON, WV 25034

MINIMUM DEGREE OF ACCURACY: 1/200

PROVEN SURVEY SOURCE OF GRADE GPS ELEVATION: (NAVD 88, US FT)

COMPANY: **SWN** Production Company, LLC

MIKE RYNIWEC BRK
OPERATOR'S WELL #: 3H
API WELL #: 47 STATE 009 COUNTY 00237 PERMIT

WELL TYPE: OIL WASTE DISPOSAL PRODUCTION DEEP GAS LIQUID INJECTION STORAGE SHALLOW

WATERSHED: UPPER OHIO SOUTH DISTRICT: BUFFALO COUNTY: BROOKE ELEVATION: 1147.3'

SURFACE OWNER: MIKE RYNIWEC OIL & GAS ROYALTY OWNER: MIKE RYNIWEC QUADRANGLE: BETHANY, WV ACREAGE: ±102.0 ACREAGE: ±102.0

DRILL DRILL DEEPER REDRILL FRACTURE OR STIMULATE PLUG OFF OLD FORMATION PERFORATE NEW FORMATION
CONVERT PLUG & ABANDON CLEAN OUT & REPLUG OTHER CHANGE (SPECIFY) AS-DRILLED

TARGET FORMATION: MARCELLUS ESTIMATED DEPTH: 5,927' TVD 16,917.0' TMD

WELL OPERATOR: SWN PRODUCTION COMPANY, LLC ADDRESS: P.O. BOX 1300 CITY: JANE LEW STATE: WV ZIP CODE: 26378

DESIGNATED AGENT: BRITTANY WOODY ADDRESS: P.O. BOX 1300 CITY: JANE LEW STATE: WV ZIP CODE: 26378

LEGEND: ○ PROPOSED SURFACE HOLE / BOTTOM HOLE * EXISTING / PRODUCING WELLHEAD LPL* LANDING POINT LOCATION ⊙ EXISTING WATER WELL ⊕ EXISTING SPRING	REVISIONS:	DATE: 10-10-2018
○ SURVEYED BOUNDARY ===== LEASE BOUNDARY --- ASDRILLED PATH --- PROPOSED PATH		DRAWN BY: D. REED SCALE: 1" = 2000' DRAWING NO: 2017-220 WELL LOCATION PLAT

- NOTES ON SURVEY**
- COORDINATE SYSTEM IS UTM NAD 83 DATUM, ZONE 17, U.S. FOOT AND WELL COORDINATES ESTABLISHED USING SURVEY GRADE GPS.
 - SURFACE AND ROYALTY OWNER INFORMATION AND THEIR BOUNDARIES SHOWN HEREON WERE PLOTTED FROM DEEDS AND/OR TAX PARCEL MAPS PROVIDED BY CLIENT AND/OR FIELD LOCATIONS.
 - THIS PLAT DOES NOT REPRESENT A BOUNDARY SURVEY OF THE PARCELS SHOWN HEREON.
 - NO DWELLINGS OR BUILDINGS WITHIN 625 FEET OF PROPOSED CENTER OF PAD.
 - NO PERENNIAL STREAMS, LAKES, PONDS, RESERVOIRS OR WETLANDS WITHIN 100 FEET OF THE LIMITS OF DISTURBANCE.
 - NO NATURALLY PRODUCING TROUT STREAM WITHIN 300 FEET OF THE LIMITS OF DISTURBANCE.
 - NO WATER WELLS OR DEVELOPED SPRINGS WITHIN 250 FEET OF PROPOSED WELL.

SURFACE HOLE LOCATION (SHL): UTM (NAD83, ZONE 17, METERS): NORTHING: 4448997.65 EASTING: 533265.03
LANDING POINT LOCATION (LPL): UTM (NAD83, ZONE 17, METERS): NORTHING: 4449222.14 EASTING: 533178.85
BOTTOM HOLE LOCATION (BHL): UTM (NAD83, ZONE 17, METERS): NORTHING: 4452285.93 EASTING: 532016.30



GRID NORTH
UTM, NAD83 DATUM, ZONE 17, US FT

Longitude: -80°35'00" SURFACE HOLE
Longitude: -80°35'00" BOTTOM HOLE