

Longitude: 80°35'00"

SURFACE HOLE 10813'

Longitude: 80°35'00"

BOTTOM HOLE 7990'



CIVIL & ENVIRONMENTAL CONSULTANTS, INC.
600 MARKETPLACE AVENUE, SUITE 200
BRIDGEPORT, WV 26330
304-933-3119

SURFACE HOLE LOCATION (SHL):
UTM (NAD83, ZONE 17, METERS):
NORTHING: 4,455,775.227
EASTING: 532,140.201

LANDING POINT (LPL):
UTM (NAD83, ZONE 17, METERS):
NORTHING: 4,455,796.502
EASTING: 531,844.200

BOTTOM HOLE LOCATION (BHL):
UTM (NAD83, ZONE 17, METERS):
NORTHING: 4,453,215.118
EASTING: 533,022.428

GRID NORTH
UTM, NAD83 DATUM, ZONE 17, US FT

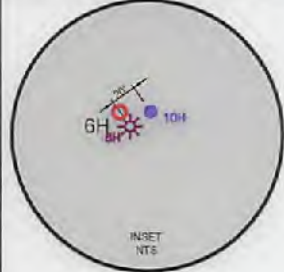
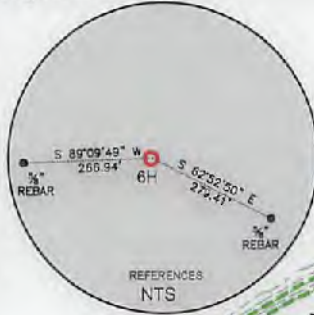

WELL RESTRICTIONS

1. NO OCCUPIED DWELLINGS > 2500 SQ FT. WITHIN 625 FEET OF CENTER OF PAD.
2. NO AGRICULTURE BUILDINGS > 2500 SQ FT. WITHIN 625 FEET OF CENTER OF PAD.
3. WATER WELLS OR DEVELOPED SPRINGS ARE WITHIN 2,068 FEET OF PROPOSED WELL.
4. PERENNIAL STREAMS, LAKES, PONDS, OR RESERVOIRS WITHIN 800 FEET OF THE LIMITS OF DISTURBANCE.
5. NO NATURALLY PRODUCING TROUT STREAM WITHIN 300 FEET OF LIMITS OF DISTURBANCE.
6. NO GROUND INTAKE OR PUBLIC WATER SUPPLY WITHIN 1000 FEET OF WELL PAD, LIMITS OF DISTURBANCE, E & S CONTROLS OR PUBLIC WATER SUPPLY.

NOTES ON SURVEY

1. SURFACE AND ROYALTY OWNER INFORMATION AND THEIR BOUNDARIES SHOWN HEREON WERE PLOTTED FROM DEEDS AND/OR TAX PARCEL MAPS PROVIDED BY CLIENT AND/OR FIELD LOCATIONS.
2. THIS PLAT DOES NOT REPRESENT A BOUNDARY SURVEY OF THE PARCELS SHOWN HEREON.
3. ALL INSETS ARE GRID NORTH UNLESS OTHERWISE DEPICTED.

I, THE UNDERSIGNED, HEREBY CERTIFY THAT THIS PLAT IS CORRECT TO THE BEST OF MY KNOWLEDGE AND BELIEF AND SHOWS ALL THE INFORMATION REQUIRED BY LAW AND REGULATIONS ISSUED AND PRESCRIBED BY THE DEPARTMENT OF ENVIRONMENTAL PROTECTION.

P.S. 991

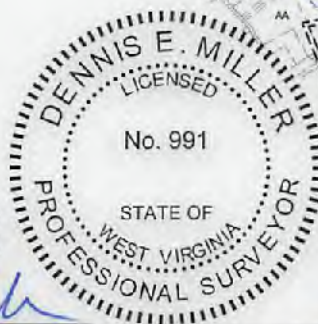

COMPANY: **SWN** Production Company, LLC

(+) DENOTES LOCATION OF WELL ON UNITED STATES TOPOGRAPHIC MAPS
WVDEP
OFFICE OF OIL & GAS
601 57TH STREET
CHARLESTON, WV 25034

MINIMUM DEGREE OF ACCURACY: 1/200
PROVEN SURVEY SOURCE OF ELEVATION: GRADE GPS (NAVD 88, US FT)

OPERATOR'S WELL #: 6H
API WELL #: 47 009 00240
STATE COUNTY PERMIT

WELL TYPE: OIL WASTE DISPOSAL PRODUCTION DEEP GAS LIQUID INJECTION STORAGE SHALLOW
WATERSHED: UPPER OHIO WHEELING
DISTRICT: BUFFALO COUNTY: BROOKE
SURFACE OWNER: LINDA COEN (LIFE ESTATE-VIOLET L COSS)
OIL & GAS ROYALTY OWNER: VIOLET L COSS
DRILL DRILL DEEPER REDRILL FRACTURE OR STIMULATE PLUG OFF OLD FORMATION PERFORATE NEW FORMATION
CONVERT PLUG & ABANDON CLEAN OUT & REPLUG OTHER CHANGE (SPECIFY)
TARGET FORMATION: MARCELLUS ESTIMATED DEPTH: 5,810 TVD 15,564 TMD

WELL OPERATOR: SWN PRODUCTION COMPANY, LLC
ADDRESS: P.O. BOX 1300
CITY: JANE LEW STATE: WV ZIP CODE: 26378
DESIGNATED AGENT: DEE SOUTHALL
ADDRESS: P.O. BOX 1300
CITY: JANE LEW STATE: WV ZIP CODE: 26378

LEGEND:
PROPOSED SURFACE HOLE / BOTTOM HOLE
EXISTING / PRODUCING WELLHEAD
LANDING POINT LOCATION
EXISTING WATER WELL
EXISTING SPRING
SURVEYED BOUNDARY DRILLING UNIT
LEASE BOUNDARY
PROPOSED PATH
REVISIONS:
DATE: 09-28-2017
DRAWN BY: D. MILLER
SCALE: 1" = 2000'
DRAWING NO: 172-287
WELL LOCATION PLAT



CIVIL & ENVIRONMENTAL CONSULTANTS, INC.
 800 MARKETPLACE AVENUE, SUITE 200
 BRIDGEPORT, WV 26330
 304-933-3119

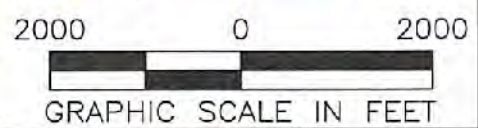
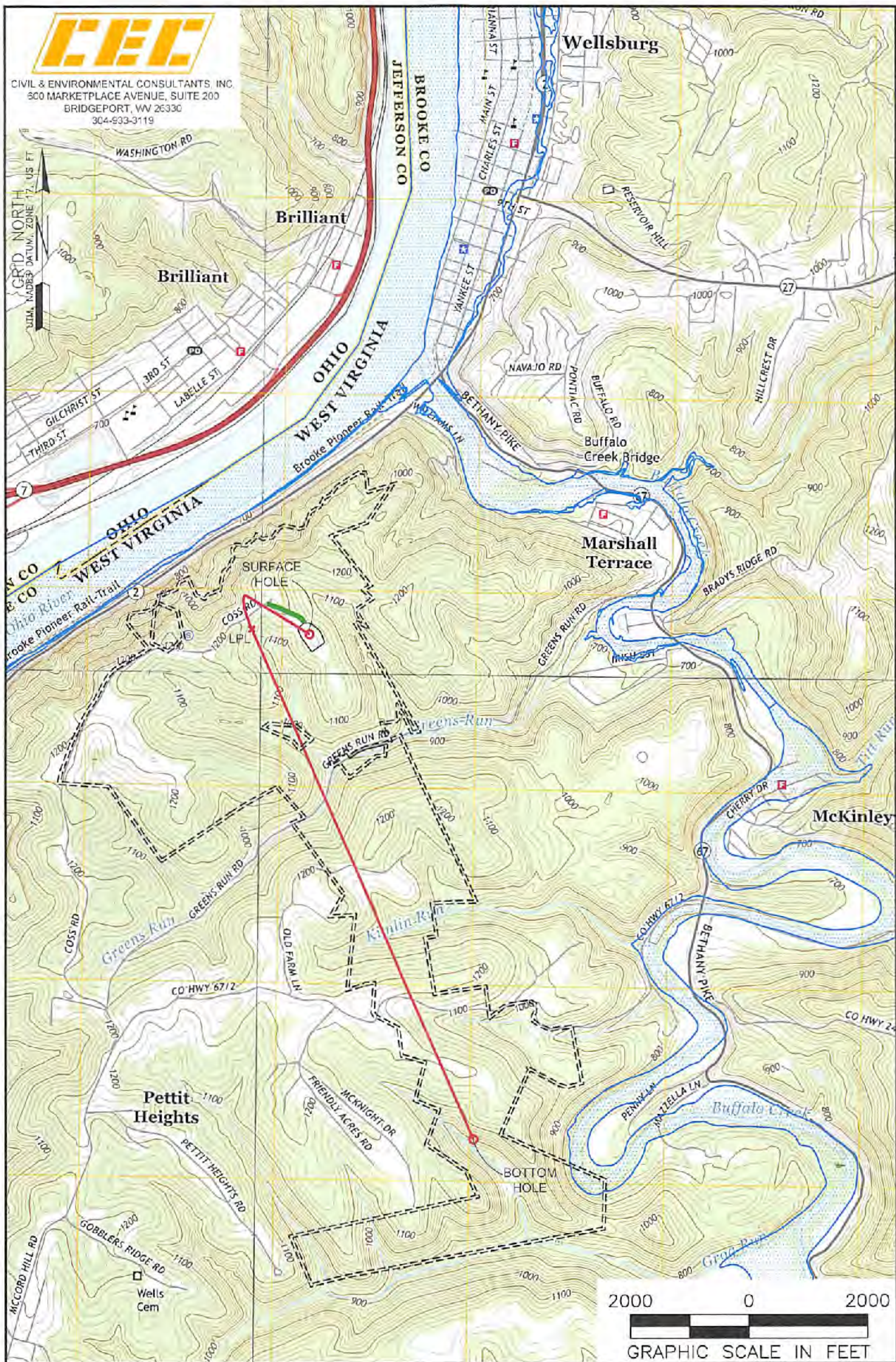

NOTES ON SURVEY

1. SURFACE AND ROYALTY OWNER INFORMATION AND THEIR BOUNDARIES SHOWN HEREON WERE PLOTTED FROM DEEDS AND/OR TAX PARCEL MAPS PROVIDED BY CLIENT AND/OR FIELD LOCATIONS.
2. THIS PLAT DOES NOT REPRESENT A BOUNDARY SURVEY OF THE PARCELS SHOWN HEREON.
3. ALL INSETS ARE GRID NORTH UNLESS OTHERWISE DEPICTED.

RECEIVED
 Office of Oil and Gas

OCT 01 2017

WV Department of
 Environmental Protection

LEGEND:

- PROPOSED SURFACE HOLE / BOTTOM HOLE
- EXISTING / PRODUCING WELLHEAD
- LPL LANDING POINT LOCATION
- FLOOD PLAN
- ACCESS ROAD
- PUBLIC ROAD
- ACCESS ROAD TO PREV. SITE
- LEASE BOUNDARY
- PROPOSED PATH

01/12/2018

WELL OPERATOR:
 SWN PRODUCTION COMPANY, LLC
 ADDRESS:
 P.O. BOX 1300 JANE LEW, WV 26378
 SURFACE OWNER:
 LINDA COEN (LIFE ESTATE-VIOLET L COSS)

WELL (FARM) NAME:
 VIOLET COSS BRK
 COUNTY - CODE
 BROOKE - 009
 USGS 7 1/2 QUADRANGLE MAP NAME
 BETHANY, WV

WELL #
 6H
 SERIAL #
 XXXX

DISTRICT;
 BUFFALO