

LATITUDE: 40°22'30" SURFACE HOLE

7741'

LATITUDE: 40°20'00" BOTTOM HOLE

5420'



www.jhacompanies.com

68011 Vineyard Road
St. Clairsville, Ohio 43950
740-695-6100

NOTES ON SURVEY

1. COORDINATE SYSTEM IS UTM NAD 83 DATUM, ZONE 17, U.S. FOOT AND WELL COORDINATES ESTABLISHED USING SURVEY GRADE GPS.
2. SURFACE AND ROYALTY OWNER INFORMATION AND THEIR BOUNDARIES SHOWN HEREON WERE PLOTTED FROM DEEDS AND/OR TAX PARCEL MAPS PROVIDED BY CLIENT AND/OR FIELD LOCATIONS.
3. THIS PLAT DOES NOT REPRESENT A BOUNDARY SURVEY OF THE PARCELS SHOWN HEREON.
4. NO DWELLINGS OR BUILDINGS WITHIN 825 FEET OF PROPOSED CENTER OF PAD
5. NO PERENNIAL STREAMS, LAKES, PONDS, RESERVOIRS OR WETLANDS WITHIN 100 FEET OF THE LIMITS OF DISTURBANCE.
6. NO NATURALLY PRODUCING TROUT STREAM WITHIN 300 FEET OF THE LIMITS OF DISTURBANCE.
7. NO WATER WELLS OR DEVELOPED SPRINGS WITHIN 250 FEET OF PROPOSED WELL.

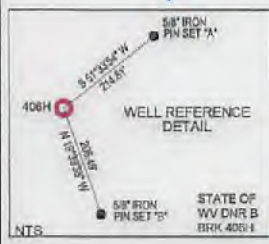
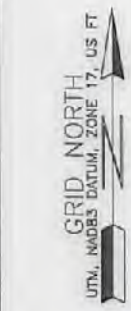

LINE	BEARING	DISTANCE
L1	S 07°38'17" W	704.97'
L2	S 33°41'03" E	1266.64'

SURFACE HOLE LOCATION (SHL):
 UTM (NAD83, ZONE 17, METERS):
 NORTHING: 4455695.725
 EASTING: 540101.898

LANDING POINT LOCATION (LPL):
 UTM (NAD83, ZONE 17, METERS):
 NORTHING: 4465423.757
 EASTING: 539488.867

BOTTOM HOLE LOCATION (BHL):
 UTM (NAD83, ZONE 17, METERS):
 NORTHING: 4462801.274
 EASTING: 540825.277



I, THE UNDERSIGNED, HEREBY CERTIFY THAT THIS PLAT IS CORRECT TO THE BEST OF MY KNOWLEDGE AND BELIEF AND SHOWS ALL THE INFORMATION REQUIRED BY LAW AND REGULATIONS ISSUED AND PRESCRIBED BY THE DEPARTMENT OF ENVIRONMENTAL PROTECTION.

P.S. 2041 *[Signature]* 2-9-18

(+) DENOTES LOCATION OF WELL ON UNITED STATES TOPOGRAPHIC MAPS

WVDEP
 OFFICE OF OIL & GAS
 601 57TH STREET
 CHARLESTON, WV 25034

MINIMUM DEGREE OF ACCURACY: 1/200

PROVEN SOURCE OF ELEVATION: SURVEY GRADE GPS (NAVD 88, US FT)

STATE OF WV DNR B
 OPERATOR'S WELL #: BRK 406H

API WELL #: 47 009 00344
 STATE COUNTY PERMIT

WELL TYPE: OIL WASTE DISPOSAL PRODUCTION DEEP GAS LIQUID INJECTION STORAGE SHALLOW

WATERSHED: UPPER OHIO NORTH ELEVATION: 1,201.22'

DISTRICT: CROSS CREEK COUNTY: BROOKE QUADRANGLE: STEUBENVILLE EAST

SURFACE OWNER: STATE OF WEST VIRGINIA, BUREAU OF COMMERCE, DNR ACREAGE: ±169.43

OIL & GAS ROYALTY OWNER: STATE OF WEST VIRGINIA, BUREAU OF COMMERCE, DNR ACREAGE: ±169.43

DRILL DRILL DEEPER REDRILL FRACTURE OR STIMULATE PLUG OFF OLD FORMATION PERFORATE NEW FORMATION

CONVERT PLUG & ABANDON CLEAN OUT & REPLUG OTHER CHANGE (SPECIFY)

TARGET FORMATION: MARCELLUS ESTIMATED DEPTH: 5,815' TO 6,200'

WELL OPERATOR: SWN PRODUCTION COMPANY, LLC DESIGNATED AGENT: DEE SOUTHALL

ADDRESS: P.O. BOX 1300 ADDRESS: P.O. BOX 1300

CITY: JANE LEW STATE: WV ZIP CODE: 26378 CITY: JANE LEW STATE: WV ZIP CODE: 26378

LEGEND:
 ● PROPOSED SURFACE HOLE / BOTTOM HOLE
 ☼ EXISTING / PRODUCING WELLHEAD
 LPL* LANDING POINT LOCATION
 Ⓜ EXISTING WATER WELL
 Ⓞ EXISTING SPRING

— SURVEYED BOUNDARY
 - - - - - DRILLING UNIT
 - - - - - LEASE BOUNDARY
 - - - - - PROPOSED PATH

REVISIONS:

DATE: 02-09-2018

DRAWN BY: D. REED
 SCALE: 1" = 2000'
 DRAWING NO: 2017-541
 WELL LOCATION PLAT

LONGITUDE: -80°30'00" SURFACE HOLE

12437'

LONGITUDE: -80°30'00" BOTTOM HOLE

LONGITUDE: -80°30'00" SURFACE HOLE

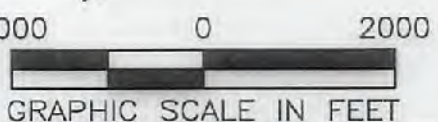

SWN Production Company, LLC SWN Production Company, LLC

04/20/2018

68011 Vineyard Road
 St. Clairsville, Ohio 43950
 740-695-6100

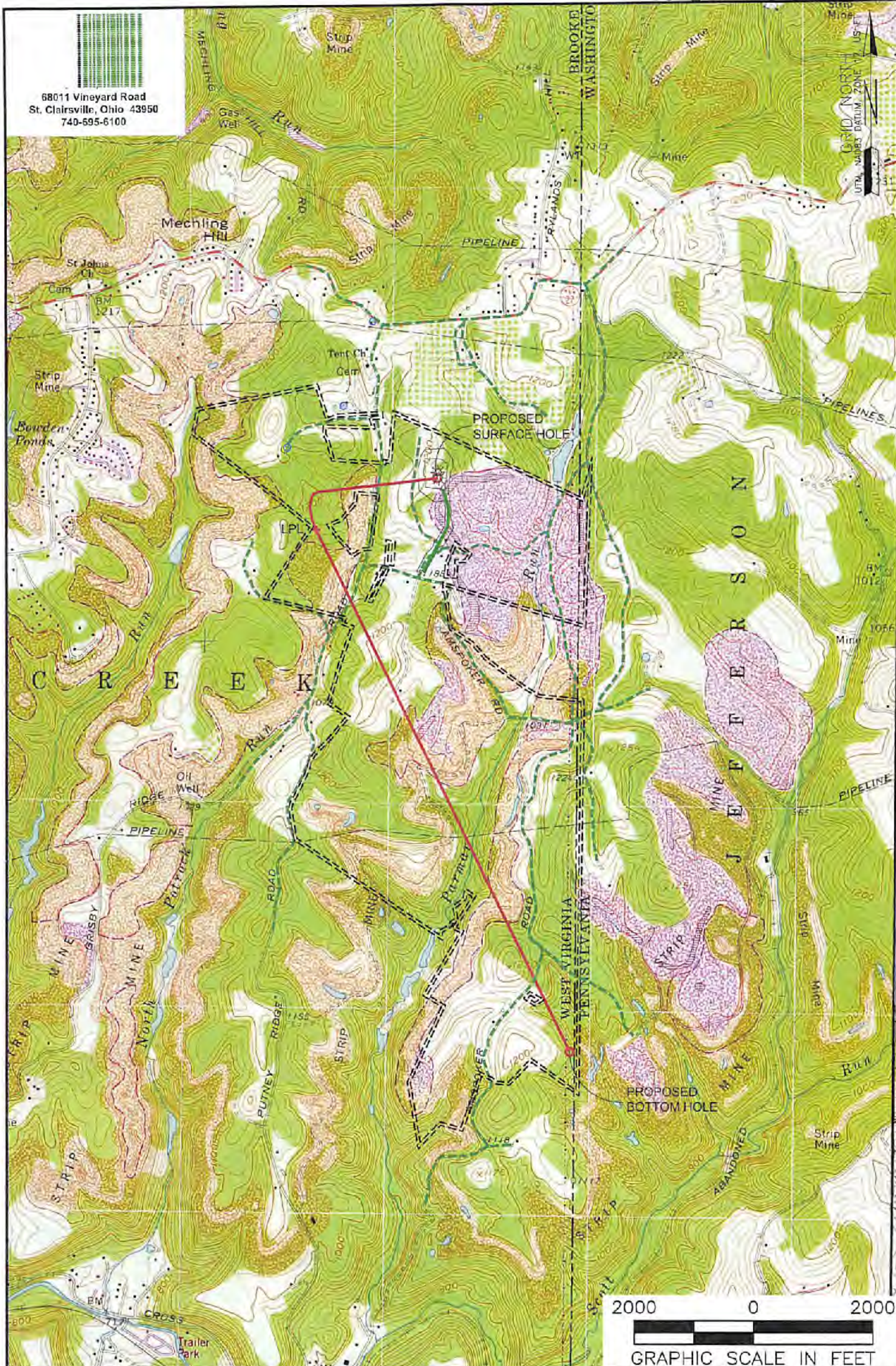

NOTES ON SURVEY
 1. SURFACE AND ROYALTY OWNER INFORMATION AND THEIR BOUNDARIES SHOWN HEREON WERE PLOTTED FROM DEEDS AND/OR TAX PARCEL MAPS PROVIDED BY CLIENT AND/OR FIELD LOCATIONS.
 2. THIS PLAT DOES NOT REPRESENT A BOUNDARY SURVEY OF THE PARCELS SHOWN HEREON.
 3. ALL INSETS ARE GRID NORTH UNLESS OTHERWISE DEPICTED.

RECEIVED
 Office of Oil and Gas
 FEB 15 2018
 WV Department of Environmental Protection

LEGEND:
 ○ PROPOSED SURFACE HOLE / BOTTOM HOLE
 * EXISTING / PRODUCING WELLHEAD
 LPL ✕ LANDING POINT LOCATION
 〰 FLOOD PLAIN
 — ACCESS ROAD
 - - - PUBLIC ROAD
 - - - ACCESS ROAD TO PREV. SITE
 - - - LEASE BOUNDARY
 — PROPOSED PATH

WELL OPERATOR: SWN PRODUCTION COMPANY, LLC	WELL (FARM) NAME: STATE OF WV DNR B	WELL # 406H	SERIAL # XXXX
ADDRESS: P.O. BOX 1300 JANE LEW, WV 26378	COUNTY - CODE BROOKE - 009	DISTRICT; CROSS CREEK	
SURFACE OWNER: STATE OF WEST VIRGINIA, BUREAU OF COMMERCE, DNR	USGS 7 1/2 QUADRANGLE MAP NAME STUEBENVILLE EAST		