

Latitude: 40°22'30" SURFACE HOLE

Latitude: 40°20'00" BOTTOM HOLE

7771'

5510'



www.jhacompanies.com  
68011 Vineyard Road  
St. Clairsville, Ohio 43950  
740-695-6100

**NOTES ON SURVEY**

1. COORDINATE SYSTEM IS UTM NAD 83 DATUM, ZONE 17, U.S. FOOT AND WELL COORDINATES ESTABLISHED USING SURVEY GRADE GPS.
2. SURFACE AND ROYALTY OWNER INFORMATION AND THEIR BOUNDARIES SHOWN HEREON WERE PLOTTED FROM DEEDS AND/OR TAX PARCEL MAPS PROVIDED BY CLIENT AND/OR FIELD LOCATIONS.
3. THIS PLAT DOES NOT REPRESENT A BOUNDARY SURVEY OF THE PARCELS SHOWN HEREON.
4. NO DWELLINGS OR BUILDINGS WITHIN 625 FEET OF PROPOSED CENTER OF PAD
5. NO PERENNIAL STREAMS, LAKES, PONDS, RESERVOIRS OR WETLANDS WITHIN 100 FEET OF THE LIMITS OF DISTURBANCE.
6. NO NATURALLY PRODUCING TROUT STREAM WITHIN 300 FEET OF THE LIMITS OF DISTURBANCE.
7. NO WATER WELLS OR DEVELOPED SPRINGS WITHIN 250 FEET OF PROPOSED WELL.

LINE	BEARING	DISTANCE
L1	S 5°40'24" W	716.32'
L2	S 34°07'28" E	1292.72'

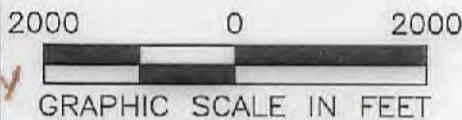
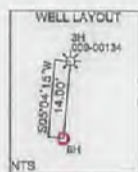

<b>SURFACE HOLE LOCATION (SHL):</b> UTM (NAD83, ZONE 17, METERS): NORTHING: 4465690.924 EASTING: 540108.896
<b>LANDING POINT LOCATION (LPL):</b> UTM (NAD83, ZONE 17, METERS): NORTHING: 4465576.027 EASTING: 539923.049
<b>BOTTOM HOLE LOCATION (BHL):</b> UTM (NAD83, ZONE 17, METERS): NORTHING: 4463825.736 EASTING: 540808.172

I, THE UNDERSIGNED, HEREBY CERTIFY THAT THIS PLAT IS CORRECT TO THE BEST OF MY KNOWLEDGE AND BELIEF AND SHOWS ALL THE INFORMATION REQUIRED BY LAW AND REGULATIONS ISSUED AND PRESCRIBED BY THE DEPARTMENT OF ENVIRONMENTAL PROTECTION.

P.S. 2041



(+) DENOTES LOCATION OF WELL ON UNITED STATES TOPOGRAPHIC MAPS  
WVDEP  
OFFICE OF OIL & GAS  
601 57TH STREET  
CHARLESTON, WV 25034

MINIMUM DEGREE OF ACCURACY: 1/200  
PROVEN SOURCE OF ELEVATION: SURVEY GRADE GPS (NAVD 88, US FT)

**SWN** Production Company, LLC **SWN** Production Company™

STATE OF WV DNR B  
OPERATOR'S WELL #: BRK 6H  
API WELL #: 47 STATE 009 COUNTY 00247 PERMIT

WELL TYPE: OIL  WASTE DISPOSAL  PRODUCTION  DEEP  GAS  LIQUID INJECTION  STORAGE  SHALLOW

WATERSHED: UPPER OHIO NORTH ELEVATION: 1201.0'

DISTRICT: CROSS CREEK COUNTY: BROOKE QUADRANGLE: STEUBENVILLE EAST

SURFACE OWNER: STATE OF WEST VIRGINIA, BUREAU OF COMMERCE, DNR ACREAGE: ±169.43

OIL & GAS ROYALTY OWNER: STATE OF WEST VIRGINIA, BUREAU OF COMMERCE, DNR ACREAGE: ±169.43

DRILL  DRILL DEEPER  REDRILL  FRACTURE OR STIMULATE  PLUG OFF OLD FORMATION  PERFORATE NEW FORMATION

CONVERT  PLUG & ABANDON  CLEAN OUT & REPLUG  OTHER CHANGE  (SPECIFY)

TARGET FORMATION: MARCELLUS ESTIMATED DEPTH: 5,773

WELL OPERATOR: SWN PRODUCTION COMPANY, LLC DESIGNATED AGENT: DEE SOUTHALL  
ADDRESS: P.O. BOX 1300 ADDRESS: P.O. BOX 1300  
CITY: JANE LEW STATE: WV ZIP CODE: 26378 CITY: JANE LEW STATE: WV ZIP CODE: 26378

<b>LEGEND:</b> ○ PROPOSED SURFACE HOLE / BOTTOM HOLE * EXISTING / PRODUCING WELLHEAD LPL LANDING POINT LOCATION ⊙ EXISTING WATER WELL ⊙ EXISTING SPRING	<b>REVISIONS:</b>	DATE: 01-12-2018
— SURVEYED BOUNDARY - - - DRILLING UNIT ===== LEASE BOUNDARY - - - PROPOSED PATH		DRAWN BY: D. REED SCALE: 1" = 2000' DRAWING NO: 2017-541 WELL LOCATION PLAT



4700900247

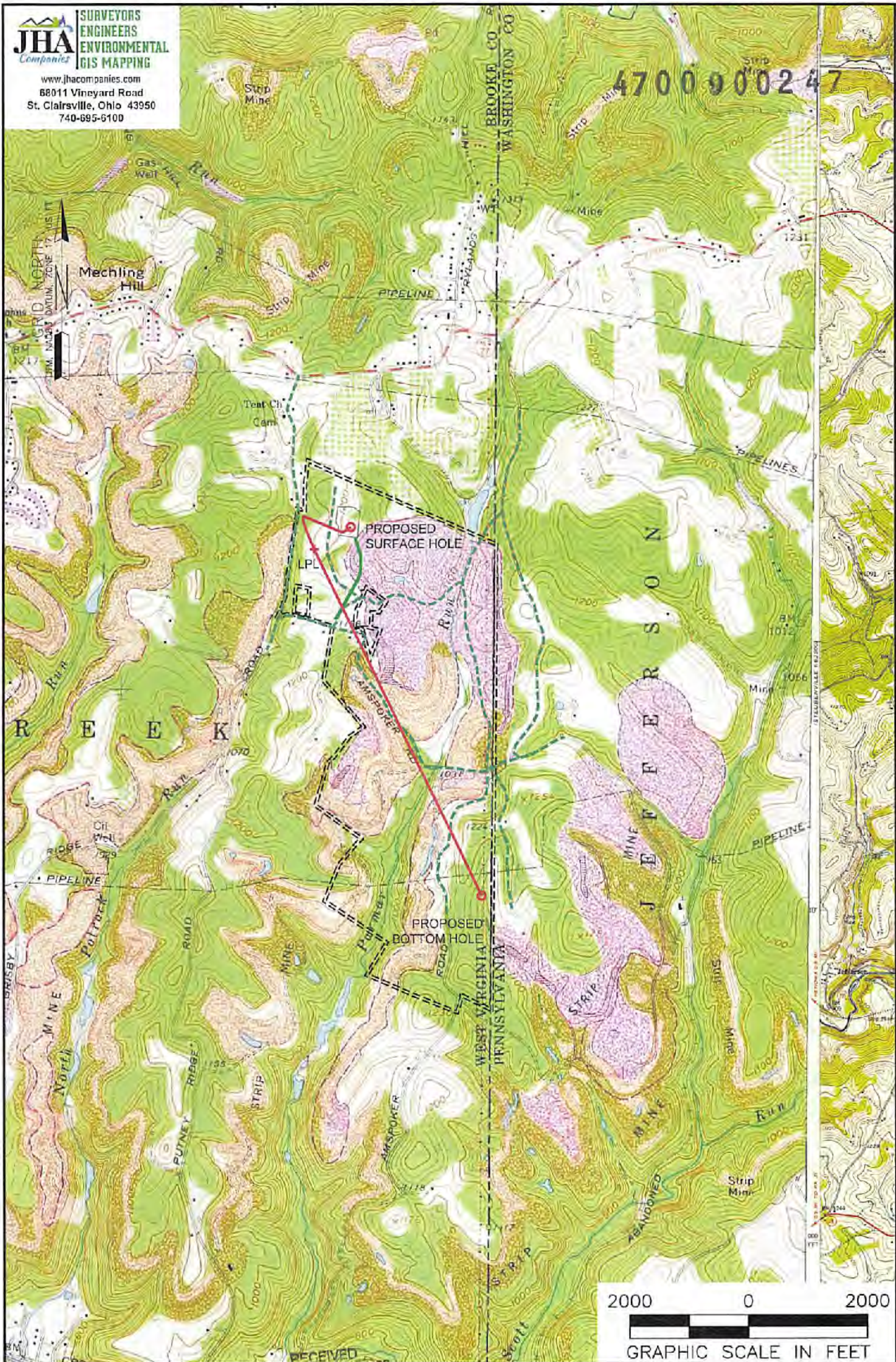

**NOTES ON SURVEY**  
 1. SURFACE AND ROYALTY OWNER INFORMATION AND THEIR BOUNDARIES SHOWN HEREON WERE PLOTTED FROM DEEDS AND/OR TAX PARCEL MAPS PROVIDED BY CLIENT AND/OR FIELD LOCATIONS.  
 2. THIS PLAT DOES NOT REPRESENT A BOUNDARY SURVEY OF THE PARCELS SHOWN HEREON.  
 3. ALL INSETS ARE GRID NORTH UNLESS OTHERWISE DEPICTED.

RECEIVED  
 Office of Oil and Gas  
 JAN 16 2018  
 WV Department of Environmental Protection

**LEGEND:**  
 ○ PROPOSED SURFACE HOLE / BOTTOM HOLE  
 \* EXISTING / PRODUCING WELLHEAD  
 LPL\* LANDING POINT LOCATION  
 FLOOD PLAN  
 — ACCESS ROAD  
 - - - PURCHASE  
 - - - ACCESS ROAD TO PREV. SITE  
 - - - LEASE BOUNDARY  
 - - - PROPOSED PATH

WELL OPERATOR: SWN PRODUCTION COMPANY, LLC	WELL (FARM) NAME: STATE OF WV DNR B	WELL # 6H	SERIAL # XXXX
ADDRESS: P.O. BOX 1300 JANE LEW, WV 26378	COUNTY - CODE BROOKE - 009	DISTRICT; CROSS CREEK	
SURFACE OWNER: STATE OF WEST VIRGINIA, BUREAU OF COMMERCE, DNR	USGS 7 1/2 QUADRANGLE MAP NAME STEBENVILLE EAST		