

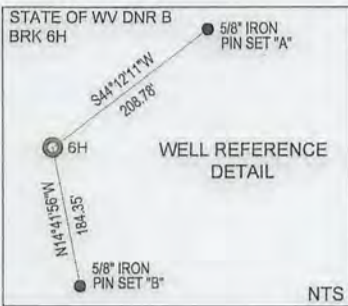

www.jhacompanies.com
68011 Vineyard Road
St. Clairsville, Ohio 43950
740-695-6100



| LINE | BEARING | DISTANCE |
|------|-------------|----------|
| L1 | S05°40'24"W | 718.39' |
| L2 | S34°07'28"E | 1292.70' |

| |
|---|
| SURFACE HOLE LOCATION (SHL): UTM (NAD83, ZONE 17, METERS): NORTHING: 4465690.92 EASTING: 540108.90 |
| LANDING POINT LOCATION (LPL): UTM (NAD83, ZONE 17, METERS): NORTHING: 4465576.03 EASTING: 539923.05 |
| BOTTOM HOLE LOCATION (BHL): UTM (NAD83, ZONE 17, METERS): NORTHING: 4463825.74 EASTING: 540808.17 |

I, THE UNDERSIGNED, HEREBY CERTIFY THAT THIS PLAT IS CORRECT TO THE BEST OF MY KNOWLEDGE AND BELIEF AND SHOWS ALL THE INFORMATION REQUIRED BY LAW AND REGULATIONS ISSUED AND PRESCRIBED BY THE DEPARTMENT OF ENVIRONMENTAL PROTECTION.

P.S. 2041



(+) DENOTES LOCATION OF WELL ON UNITED STATES TOPOGRAPHIC MAPS
WVDEP
OFFICE OF OIL & GAS
601 57TH STREET
CHARLESTON, WV 25034

MINIMUM DEGREE OF ACCURACY: 1/200
PROVEN SURVEY SOURCE OF ELEVATION: GRADE GPS (NAVD 88, US FT)

STATE OF WV DNR B BRK
OPERATOR'S WELL #: 6H
API WELL #: 47 009 DD247MOD
STATE COUNTY PERMIT

WELL TYPE: OIL WASTE DISPOSAL PRODUCTION DEEP GAS LIQUID INJECTION STORAGE SHALLOW
 WATERSHED: UPPER OHIO NORTH ELEVATION: 1201.0'
 DISTRICT: CROSS CREEK COUNTY: BROOKE QUADRANGLE: STEUBENVILLE EAST, OH
 SURFACE OWNER: STATE OF WEST VIRGINIA, BUREAU OF COMMERCE, DNR ACREAGE: ±169.43
 OIL & GAS ROYALTY OWNER: STATE OF WEST VIRGINIA, BUREAU OF COMMERCE, DNR ACREAGE: ±169.43
 DRILL DRILL DEEPER REDRILL FRACTURE OR STIMULATE PLUG OFF OLD FORMATION PERFORATE NEW FORMATION
 CONVERT PLUG & ABANDON CLEAN OUT & REPLUG OTHER CHANGE (SPECIFY)
 TARGET FORMATION: MARCELLUS ESTIMATED DEPTH: 5,762' TVD 12,502.7' TMD

WELL OPERATOR: SWN PRODUCTION COMPANY, LLC DESIGNATED AGENT: BRITTANY WOODY
 ADDRESS: P.O. BOX 1300 ADDRESS: P.O. BOX 1300
 CITY: JANE LEW STATE: WV ZIP CODE: 26378 CITY: JANE LEW STATE: WV ZIP CODE: 26378

| LEGEND: | REVISIONS: | DATE: |
|---------------------------------------|---------------------|----------------------|
| ○ PROPOSED SURFACE HOLE / BOTTOM HOLE | — SURVEYED BOUNDARY | 09-12-2018 |
| ⊙ EXISTING / PRODUCING WELLHEAD | — DRILLING UNIT | |
| LPL* LANDING POINT LOCATION | --- LEASE BOUNDARY | DRAWN BY: D. REED |
| ⊙ EXISTING WATER WELL | — PROPOSED PATH | SCALE: 1" = 2000' |
| ⊙ EXISTING SPRING | | DRAWING NO: 2017-541 |
| | | WELL LOCATION PLAT |

- NOTES ON SURVEY**
- COORDINATE SYSTEM IS UTM NAD 83 DATUM, ZONE 17, U.S. FOOT AND WELL COORDINATES ESTABLISHED USING SURVEY GRADE GPS.
 - SURFACE AND ROYALTY OWNER INFORMATION AND THEIR BOUNDARIES SHOWN HEREON WERE PLOTTED FROM DEEDS AND/OR TAX PARCEL MAPS PROVIDED BY CLIENT AND/OR FIELD LOCATIONS.
 - THIS PLAT DOES NOT REPRESENT A BOUNDARY SURVEY OF THE PARCELS SHOWN HEREON.
 - NO DWELLINGS OR BUILDINGS WITHIN 625 FEET OF PROPOSED CENTER OF PAD
 - NO PERENNIAL STREAMS, LAKES, PONDS, RESERVOIRS OR WETLANDS WITHIN 100 FEET OF THE LIMITS OF DISTURBANCE.
 - NO NATURALLY PRODUCING TROUT STREAM WITHIN 300 FEET OF THE LIMITS OF DISTURBANCE.
 - NO WATER WELLS OR DEVELOPED SPRINGS WITHIN 250 FEET OF PROPOSED WELL.

09/28/2018

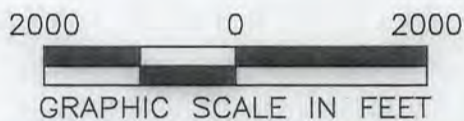
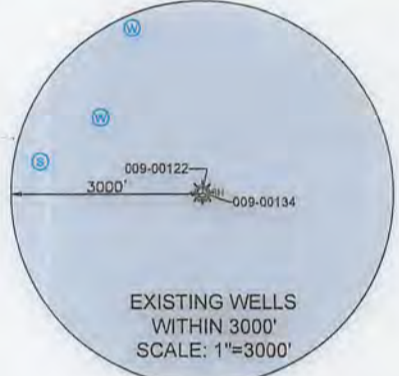

09/28/2018

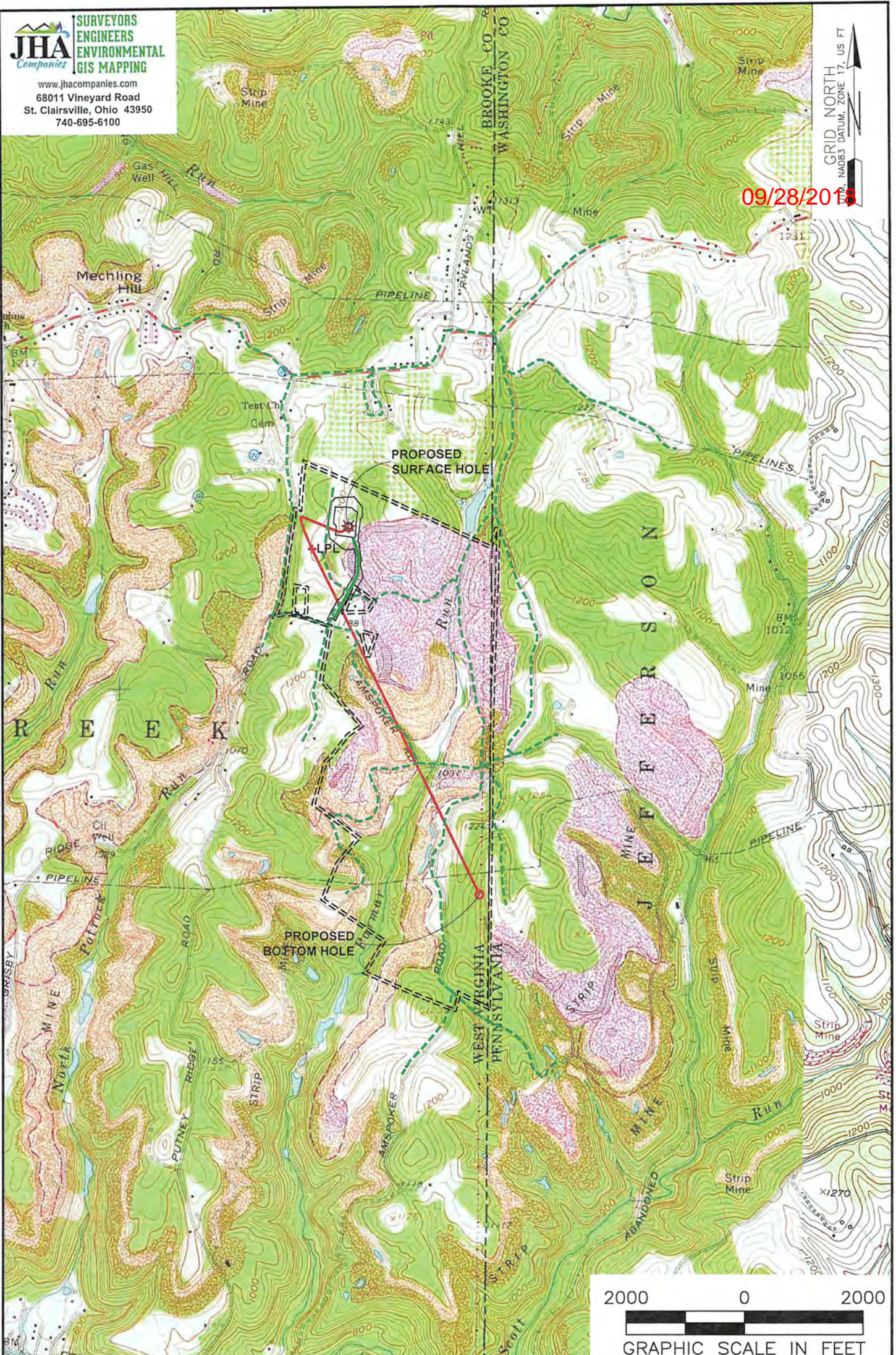

NOTES ON SURVEY

1. SURFACE AND ROYALTY OWNER INFORMATION AND THEIR BOUNDARIES SHOWN HEREON WERE PLOTTED FROM DEEDS AND/OR TAX PARCEL MAPS PROVIDED BY CLIENT AND/OR FIELD LOCATIONS.
2. THIS PLAT DOES NOT REPRESENT A BOUNDARY SURVEY OF THE PARCELS SHOWN HEREON.
3. ALL INSETS ARE GRID NORTH UNLESS OTHERWISE DEPICTED.

LEGEND:

- PROPOSED SURFACE HOLE / BOTTOM HOLE
- EXISTING / PRODUCING WELLHEAD
- LPL* LANDING POINT LOCATION
- FLOOD PLAIN
- ACCESS ROAD
- PUBLIC ROAD
- ACCESS ROAD TO PREV. SITE
- LEASE BOUNDARY
- PROPOSED PATH

9-00247 M00

| | | | |
|---|--|--------------------------|------------------|
| WELL OPERATOR: SWN PRODUCTION COMPANY, LLC | WELL (FARM) NAME: STATE OF WV DNR B | WELL # 6H | SERIAL # XXXX |
| ADDRESS: P.O. BOX 1300 JANE LEW, WV 26378 | COUNTY - CODE BROOKE - 009 | DISTRICT: CROSS CREEK | |
| SURFACE OWNER: STATE OF WEST VIRGINIA, BUREAU OF COMMERCE, DNR | USGS 7 1/2 QUADRANGLE MAP NAME: STUEBENVILLE EAST | | |