



www.jhacompanies.com
68011 Vineyard Road
St. Clairsville, Ohio 43950
740-695-6100

GRID NORTH
UTM, NAD83 DATUM, ZONE 17, US FT

PROPOSED SURFACE HOLE

009-00147
008-00125

SHL

LPL

2019122° E

16005.11'

2019122° E

16005.11'

2019122° E

16005.11'

2019122° E

16005.11'

2019122° E

16005.11'

2019122° E

16005.11'

2019122° E

16005.11'

2019122° E

16005.11'

2019122° E

16005.11'

2019122° E

16005.11'

2019122° E

16005.11'

2019122° E

16005.11'

2019122° E

16005.11'

2019122° E

16005.11'

2019122° E

16005.11'

2019122° E

16005.11'

2019122° E

16005.11'

2019122° E

16005.11'

2019122° E

16005.11'

2019122° E

16005.11'

2019122° E

16005.11'

2019122° E

16005.11'

2019122° E

16005.11'

2019122° E

16005.11'

2019122° E

16005.11'

2019122° E

16005.11'

2019122° E

16005.11'

2019122° E

16005.11'

2019122° E

16005.11'

2019122° E

16005.11'

2019122° E

NOTES ON SURVEY

- COORDINATE SYSTEM IS UTM NAD 83 DATUM, ZONE 17, U.S. FOOT AND WELL COORDINATES ESTABLISHED USING SURVEY GRADE GPS.
- SURFACE AND ROYALTY OWNER INFORMATION AND THEIR BOUNDARIES SHOWN HEREON WERE PLOTTED FROM DEEDS AND/OR TAX PARCEL MAPS PROVIDED BY CLIENT AND/OR FIELD LOCATIONS.
- THIS PLAT DOES NOT REPRESENT A BOUNDARY SURVEY OF THE PARCELS SHOWN HEREON.
- NO DWELLINGS OR BUILDINGS WITHIN 825 FEET OF PROPOSED CENTER OF PAD
- NO PERENNIAL STREAMS, LAKES, PONDS, RESERVOIRS OR WETLANDS WITHIN 100 FEET OF THE LIMITS OF DISTURBANCE.
- NO NATURALLY PRODUCING TROUT STREAM WITHIN 300 FEET OF THE LIMITS OF DISTURBANCE.
- NO WATER WELLS OR DEVELOPED SPRINGS WITHIN 250 FEET OF PROPOSED WELL.

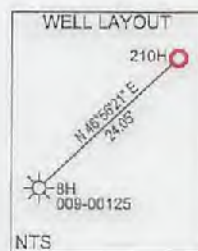
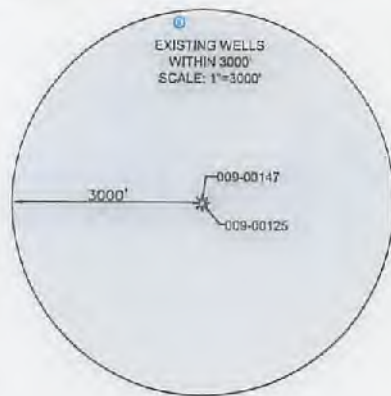

LINE	BEARING	DISTANCE
L1	N 29°41'00" W	1535.52'
L2	N 17°26'27" E	1407.40'

SURFACE HOLE LOCATION (SHL):
UTM (NAD83, ZONE 17, METERS):
NORTHING: 4453498.74
EASTING: 539503.62

LANDING POINT LOCATION (LPL):
UTM (NAD83, ZONE 17, METERS):
NORTHING: 4463650.45
EASTING: 540146.90

BOTTOM HOLE LOCATION (BHL):
UTM (NAD83, ZONE 17, METERS):
NORTHING: 4461945.43
EASTING: 540811.10

I, THE UNDERSIGNED, HEREBY CERTIFY THAT THIS PLAT IS CORRECT TO THE BEST OF MY KNOWLEDGE AND BELIEF AND SHOWS ALL THE INFORMATION REQUIRED BY LAW AND REGULATIONS ISSUED AND PRESCRIBED BY THE DEPARTMENT OF ENVIRONMENTAL PROTECTION.

P.S. 2041

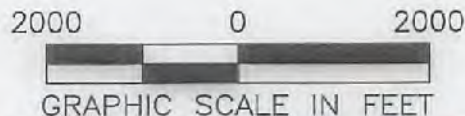

SWN Production Company, LLC **SWN** Production Company™

(+) DENOTES LOCATION OF WELL ON UNITED STATES TOPOGRAPHIC MAPS

WVDEP
OFFICE OF OIL & GAS
601 57TH STREET
CHARLESTON, WV 25034

MINIMUM DEGREE OF ACCURACY: 1/200

PROVEN SURVEY SOURCE OF GRADE GPS ELEVATION: (NAVD 88, US FT)

STATE OF WV DNR A
OPERATOR'S WELL #: BRK 210H

API WELL #: 47 009 00240

STATE COUNTY PERMIT

WELL TYPE: OIL WASTE DISPOSAL PRODUCTION DEEP GAS LIQUID INJECTION STORAGE SHALLOW

WATERSHED: UPPER OHIO NORTH ELEVATION: 1,139.8'-STAKED

DISTRICT: CROSS CREEK COUNTY: BROOKE QUADRANGLE: STEUBENVILLE EAST, OH

SURFACE OWNER: STATE OF WEST VIRGINIA, BUREAU OF COMMERCE, DNR ACREAGE: ±97.50

OIL & GAS ROYALTY OWNER: STATE OF WEST VIRGINIA, BUREAU OF COMMERCE, DNR ACREAGE: ±97.50

DRILL DRILL DEEPER REDRILL FRACTURE OR STIMULATE PLUG OFF OLD FORMATION PERFORATE NEW FORMATION

CONVERT PLUG & ABANDON CLEAN OUT & REPLUG OTHER CHANGE (SPECIFY)

TARGET FORMATION: MARCELLUS ESTIMATED DEPTH: 5,793'

WELL OPERATOR: SWN PRODUCTION COMPANY, LLC DESIGNATED AGENT: DEE SOUTHALL

ADDRESS: P.O. BOX 1300 ADDRESS: P.O. BOX 1300

CITY: JANE LEW STATE: WV ZIP CODE: 26378 CITY: JANE LEW STATE: WV ZIP CODE: 26378

LEGEND:

- PROPOSED SURFACE HOLE / BOTTOM HOLE
- EXISTING / PRODUCING WELLHEAD
- LPL* LANDING POINT LOCATION
- EXISTING WATER WELL
- EXISTING SPRING
- SURVEYED BOUNDARY
- DRILLING UNIT
- LEASE BOUNDARY
- PROPOSED PATH

REVISIONS: DATE: 06-15-2018

DRAWN BY: D. REED
SCALE: 1" = 2000'
DRAWING NO: 2018-245
WELL LOCATION PLAT

08/31/2018

JHA
Companies
SURVEYORS
ENGINEERS
ENVIRONMENTAL
GIS MAPPING
www.jhacompanies.com
68011 Vineyard Road
St. Clairsville, Ohio 43950
740-695-6100

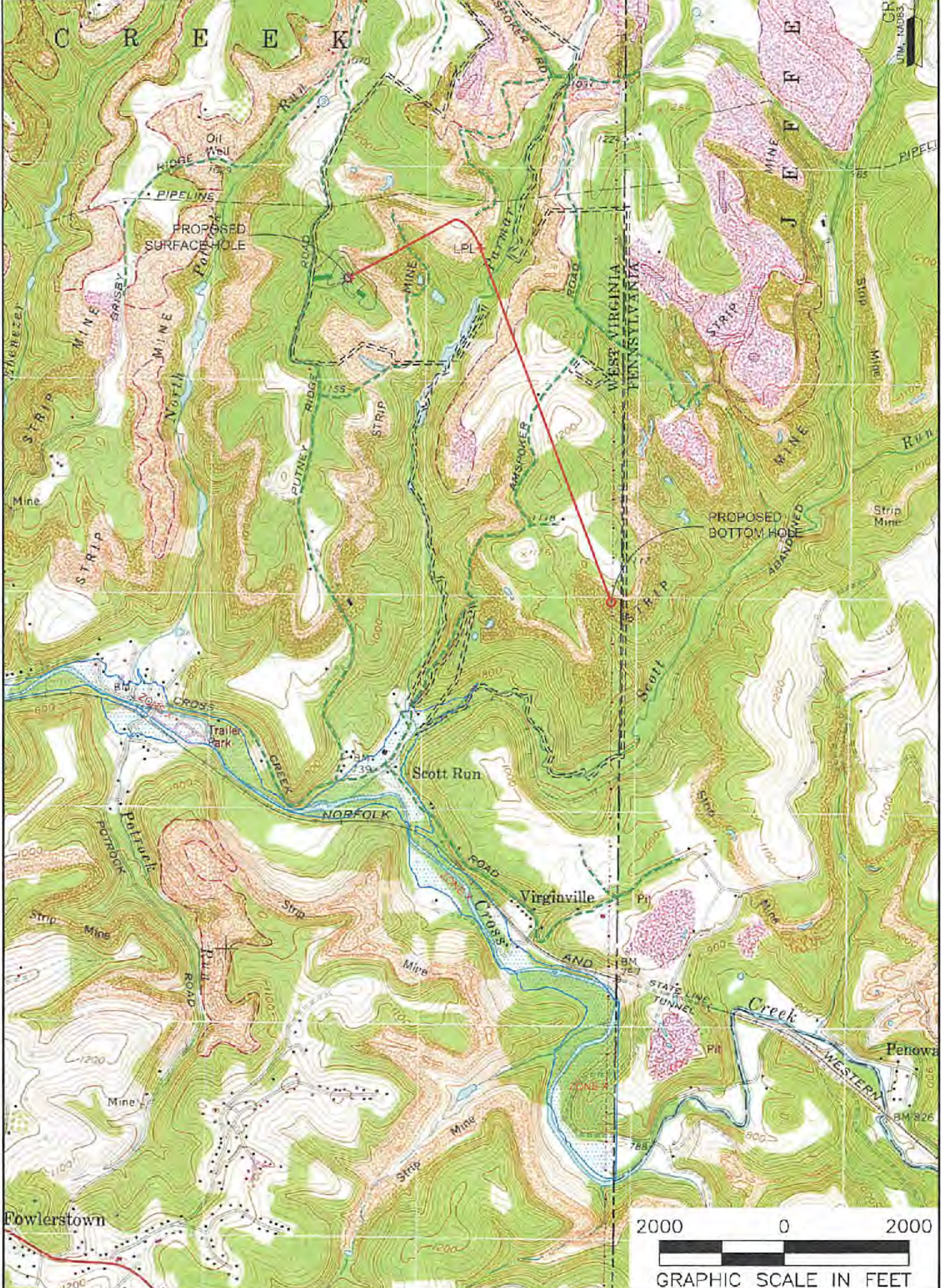

NOTES ON SURVEY

1. SURFACE AND ROYALTY OWNER INFORMATION AND THEIR BOUNDARIES SHOWN HEREON WERE PLOTTED FROM DEEDS AND/OR TAX PARCEL MAPS PROVIDED BY CLIENT AND/OR FIELD LOCATIONS.
2. THIS PLAT DOES NOT REPRESENT A BOUNDARY SURVEY OF THE PARCELS SHOWN HEREON.
3. ALL INSETS ARE GRID NORTH UNLESS OTHERWISE DEPICTED.

LEGEND:

- PROPOSED SURFACE HOLE / BOTTOM HOLE
- EXISTING / PRODUCING WELLHEAD
- LPL* LANDING POINT LOCATION
- FLOOD PLAIN
- ACCESS ROAD
- PUBLIC ROAD
- ACCESS ROAD TO PREV. SITE
- LEASE BOUNDARY
- PROPOSED PATH

08/31/2018

WELL OPERATOR: SWN PRODUCTION COMPANY, LLC	WELL (FARM) NAME: STATE OF WV DNR A	WELL # 210H	SERIAL # XXXX
ADDRESS: P.O. BOX 1300 JANE LEW, WV 26378	COUNTY - CODE BROOKE - 009	DISTRICT; CROSS CREEK	
SURFACE OWNER: STATE OF WEST VIRGINIA, BUREAU OF COMMERCE, DNR	USGS 7 1/2 QUADRANGLE MAP NAME STEBENVILLE EAST, OH		