

Location: Brooke County, WV  
Field: Brooke  
Facility: Worthley BRK Pad

Slot: 5H  
Well: Worthley BRK 5H  
Wellbore: Worthley BRK 5H AWB

Plot reference wellpath is Worthley BRK 5H awp Proj: 18803	Grid System: NAD83 / UTM Zone 17 North, US feet
True vertical depths are referenced to SDC 501 (KB)	North Reference: Grid north
Reference wellpath measured depths are referenced to SDC 501 (KB)	Scale: True distance
SDC 501 (KB) to Mean Sea Level: 1183.4 feet	Coordinates are in feet referenced to Slot
Mean Sea Level to Ground level (At Slot: 5H): -1157.4 feet	Depths are in feet
Offset wellpath MDs are referenced to each path's default MD datum	Created by: tranlam on 2024-06-13; Database: WA_MPL_EASTERNUS_Defn

### Location Information

Facility Name			Grid East (US ft)	Grid North (US ft)	Latitude	Longitude
Worthley BRK Pad			1764646,294	14605439,176	40°12'55,0140"N	80°33'18,0130"W
Slot	Local N (ft)	Local E (ft)	Grid East (US ft)	Grid North (US ft)	Latitude	Longitude
5H	45,53	-33,18	1764613,130	14605484,690	40°12'55,4656"N	80°33'18,4377"W
SDC 501 (KB) to Ground level (At Slot: 5H)					26ft	
Mean Sea Level to Ground level (At Slot: 5H)					-1157.4ft	
SDC 501 (KB) to Mean Sea Level					1183.4ft	

### Bottom Hole Location

MD (ft)	Inc (°)	Az (°)	TVD (ft)	Local N (ft)	Local E (ft)	Grid East (US ft)	Grid North (US ft)	Latitude	Longitude
18803.00	90.520	353,490	5882,79	12108,03	-2984,93	1761629,34	14617588,07	40°14'55,2610"N	80°33'56,1494"W

API: 47009003400000  
BH JOB: 112262724  
DURATION: 06.10.2024 to 06.12.2024  
RIG: SDC 501

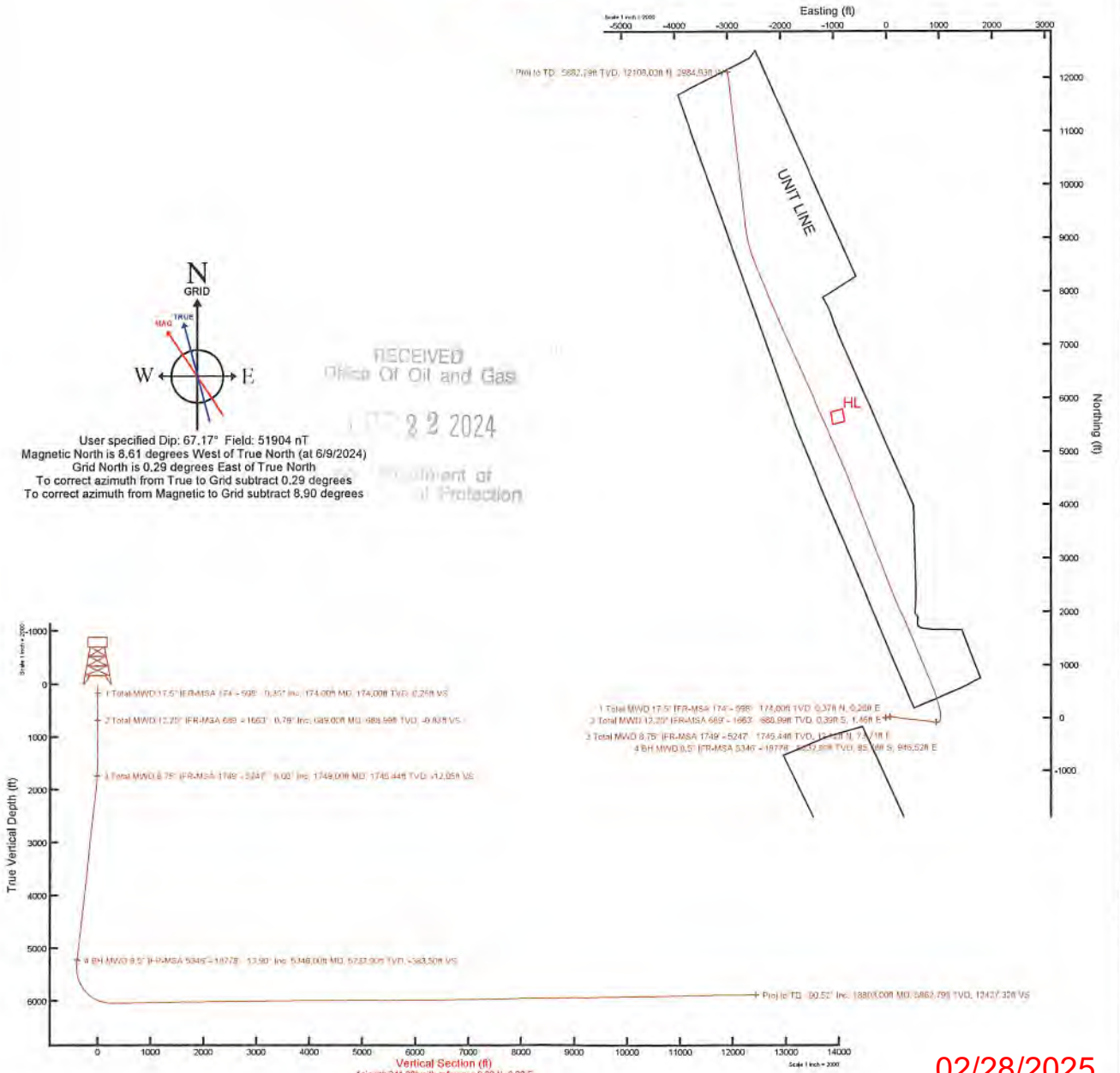

02/28/2025

REFERENCE WELLPATH IDENTIFICATION			
Operator	SWN PRODUCTION COMPANY, LLC	Well	Worthley BRK 5H
Field	Brooke	API	47009003400000
Facility	Worthley BRK Pad	Wellbore	Worthley BRK 5H AWB
Slot	5H		

REPORT SETUP INFORMATION			
Projection System	NAD83 / UTM Zone 17 North, US feet	Software System	WellArchitect® 6.0
North Reference	Grid	User	Tranlam
Scale	0.999618	Report Generated	6/13/2024 at 1:57:01 PM
Convergence at slot	0.29° East	Database	WA_MPL_EASTERNUS_Defn

WELLPATH LOCATION						
	Local coordinates		Grid coordinates		Geographic coordinates	
	North[ft]	East[ft]	Easting[US ft]	Northing[US ft]	Latitude	Longitude
Slot Location	45.53	-33.18	1764613.13	14605484.69	40°12'55.4656"N	80°33'18.4377"W
Facility Reference Pt			1764646.29	14605439.18	40°12'55.0140"N	80°33'18.0130"W
Field Reference Pt			0.00	0.00	0°00'0.0000"	85°29'19.4780"W

WELLPATH DATUM			
Calculation method	Minimum curvature	SDC 501 (KB) to Facility Vertical Datum	1183.40ft
Horizontal Reference Pt	Slot	SDC 501 (KB) to Mean Sea Level	1183.40ft
Vertical Reference Pt	SDC 501 (KB)	SDC 501 (KB) to Ground Level at Slot (5H)	26.00ft
MD Reference Pt	SDC 501 (KB)	Section Origin	N 0.00, E 0.00 ft
Field Vertical Reference	Mean Sea Level	Section Azimuth	341.38°

RECEIVED  
Office Of Oil and Gas  
OCT 22 2024  
WV Department of  
Environmental Protection

RECEIVED  
Office of Oil and Gas  
JUL 22 2024  
Department of  
Natural Resources

### REFERENCE WELLPATH IDENTIFICATION

Operator	SWN PRODUCTION COMPANY, LLC	Well	Worthley BRK 5H
Field	Brooke	API	47009003400000
Facility	Worthley BRK Pad	Wellbore	Worthley BRK 5H AWB
Slot	5H		

### WELLPATH DATA (210 stations) † = interpolated, ‡ = extrapolated station

MD [ft]	Inclination [°]	Azimuth [°]	TVD [ft]	Vert Sect [ft]	North [ft]	East [ft]	Grid East [US ft]	Grid North [US ft]	Latitude	Longitude	Closure Dist [ft]	Closure Dir [°]	DLS [°/100ft]
0.00†	0.000	35.590	0.00	0.00	0.00	0.00	1764613.13	14605484.69	40°12'55.4656"N	80°33'18.4377"W	0.00	0.000	0.00
26.00	0.000	35.590	26.00	0.00	0.00	0.00	1764613.13	14605484.69	40°12'55.4656"N	80°33'18.4377"W	0.00	0.000	0.00
174.00	0.350	35.590	174.00	0.26	0.37	0.26	1764613.39	14605485.06	40°12'55.4692"N	80°33'18.4343"W	0.45	35.590	0.24
234.00	0.160	38.050	234.00	0.42	0.58	0.42	1764613.55	14605485.27	40°12'55.4713"N	80°33'18.4322"W	0.72	35.877	0.32
324.00	0.150	64.140	324.00	0.50	0.73	0.60	1764613.73	14605485.42	40°12'55.4728"N	80°33'18.4299"W	0.95	39.530	0.08
415.00	0.240	87.440	415.00	0.46	0.79	0.90	1764614.03	14605485.48	40°12'55.4734"N	80°33'18.4260"W	1.20	48.678	0.13
506.00	0.040	99.660	506.00	0.40	0.80	1.12	1764614.25	14605485.49	40°12'55.4734"N	80°33'18.4232"W	1.38	54.678	0.22
543.00	0.100	122.380	543.00	0.36	0.78	1.16	1764614.29	14605485.47	40°12'55.4732"N	80°33'18.4227"W	1.40	56.274	0.18
598.00	0.450	153.070	598.00	0.11	0.56	1.30	1764614.43	14605485.25	40°12'55.4710"N	80°33'18.4209"W	1.42	66.777	0.67
689.00	0.790	180.780	688.99	-0.83	-0.39	1.46	1764614.59	14605484.30	40°12'55.4617"N	80°33'18.4190"W	1.51	104.888	0.49
779.00	0.600	117.050	778.99	-1.75	-1.22	1.87	1764615.00	14605483.47	40°12'55.4534"N	80°33'18.4137"W	2.23	123.199	0.83
869.00	1.250	92.780	868.97	-2.45	-1.48	3.27	1764616.40	14605483.21	40°12'55.4508"N	80°33'18.3957"W	3.59	114.422	0.83
961.00	2.080	87.470	960.93	-3.28	-1.46	5.94	1764619.07	14605483.23	40°12'55.4509"N	80°33'18.3613"W	6.11	103.802	0.92
1052.00	2.550	74.700	1051.86	-3.85	-0.85	9.54	1764622.67	14605483.84	40°12'55.4567"N	80°33'18.3148"W	9.58	95.101	0.76
1142.00	3.580	66.770	1141.73	-3.74	0.79	14.05	1764627.18	14605485.47	40°12'55.4726"N	80°33'18.2565"W	14.08	86.802	1.23
1235.00	4.530	62.240	1234.50	-2.93	3.64	19.97	1764633.09	14605488.33	40°12'55.5006"N	80°33'18.1800"W	20.30	79.668	1.08
1326.00	4.630	73.580	1325.21	-2.50	6.35	26.67	1764639.79	14605491.04	40°12'55.5270"N	80°33'18.0935"W	27.42	76.604	1.00
1416.00	5.220	78.840	1414.88	-3.17	8.17	34.18	1764647.29	14605492.86	40°12'55.5446"N	80°33'17.9966"W	35.14	76.552	0.82
1507.00	5.820	84.350	1505.45	-4.74	9.43	42.83	1764655.94	14605494.11	40°12'55.5566"N	80°33'17.8850"W	43.85	77.586	0.88
1597.00	7.050	85.960	1594.89	-7.16	10.27	52.88	1764665.99	14605494.95	40°12'55.5644"N	80°33'17.7554"W	53.87	79.013	1.38
1663.00	7.890	84.530	1660.33	-9.21	10.98	61.43	1764674.54	14605495.67	40°12'55.5711"N	80°33'17.6452"W	62.40	79.863	1.30
1749.00	8.600	84.910	1745.44	-12.05	12.12	73.71	1764686.81	14605496.80	40°12'55.5817"N	80°33'17.4868"W	74.70	80.665	0.83
1798.00	8.930	85.390	1793.86	-13.83	12.75	81.15	1764694.25	14605497.43	40°12'55.5875"N	80°33'17.3909"W	82.14	81.073	0.69
1889.00	13.150	91.940	1883.16	-19.18	12.96	98.54	1764711.64	14605497.65	40°12'55.5888"N	80°33'17.1666"W	99.39	82.505	4.83
1979.00	15.230	91.340	1970.41	-26.81	12.34	120.60	1764733.68	14605497.03	40°12'55.5816"N	80°33'16.8824"W	121.23	84.157	2.32
2068.00	15.180	95.250	2056.30	-35.52	11.00	143.89	1764756.96	14605495.69	40°12'55.5672"N	80°33'16.5823"W	144.31	85.628	1.15
2159.00	14.300	101.110	2144.31	-45.91	7.75	166.78	1764779.85	14605492.43	40°12'55.5339"N	80°33'16.2874"W	166.96	87.341	1.90
2250.00	14.660	101.000	2232.42	-57.18	3.38	189.11	1764802.17	14605488.07	40°12'55.4896"N	80°33'15.9998"W	189.14	88.975	0.40
2340.00	14.130	99.420	2319.59	-67.97	-0.59	211.13	1764824.18	14605484.10	40°12'55.4493"N	80°33'15.7163"W	211.13	90.160	0.73
2431.00	14.310	98.280	2407.80	-78.28	-4.03	233.22	1764846.26	14605480.67	40°12'55.4142"N	80°33'15.4318"W	233.25	90.989	0.37

RECEIVED  
Office Of Oil and Gas  
OCT 22 2024  
WV Department of  
Environmental Protection

REFERENCE WELLPATH IDENTIFICATION			
Operator	SWN PRODUCTION COMPANY, LLC	Well	Worthley BRK 5H
Field	Brooke	API	47009003400000
Facility	Worthley BRK Pad	Wellbore	Worthley BRK 5H AWB
Slot	5H		

### WELLPATH DATA (210 stations)

MD [ft]	Inclination [°]	Azimuth [°]	TVD [ft]	Vert Sect [ft]	North [ft]	East [ft]	Grid East [US ft]	Grid North [US ft]	Latitude	Longitude	Closure Dist [ft]	Closure Dir [°]	DLS [°/100ft]
2522.00	14.020	99.060	2496.04	-88.49	-7.38	255.23	1764868.26	14605477.31	40°12'55.3800"N	80°33'15.1482"W	255.34	91.656	0.38
2612.00	14.270	98.940	2583.31	-98.68	-10.82	276.95	1764889.98	14605473.87	40°12'55.3449"N	80°33'14.8685"W	277.16	92.238	0.28
2705.00	14.090	99.620	2673.47	-109.34	-14.49	299.44	1764912.45	14605470.20	40°12'55.3075"N	80°33'14.5789"W	299.79	92.771	0.26
2796.00	14.480	97.790	2761.66	-119.64	-17.89	321.63	1764934.64	14605466.81	40°12'55.2729"N	80°33'14.2930"W	322.13	93.183	0.66
2887.00	13.920	95.700	2849.88	-129.21	-20.52	343.79	1764956.79	14605464.18	40°12'55.2458"N	80°33'14.0075"W	344.41	93.415	0.83
2978.00	14.080	93.840	2938.18	-137.95	-22.35	365.73	1764978.72	14605462.35	40°12'55.2266"N	80°33'13.7249"W	366.41	93.496	0.52
3069.00	13.470	95.820	3026.56	-146.56	-24.16	387.32	1765000.30	14605460.54	40°12'55.2076"N	80°33'13.4467"W	388.07	93.570	0.85
3159.00	13.570	95.750	3114.07	-155.26	-26.28	408.25	1765021.23	14605458.42	40°12'55.1856"N	80°33'13.1770"W	409.10	93.683	0.11
3252.00	13.930	94.130	3204.40	-164.09	-28.18	430.27	1765043.24	14605456.52	40°12'55.1657"N	80°33'12.8933"W	431.20	93.747	0.57
3342.00	14.000	95.740	3291.74	-172.77	-30.05	451.91	1765064.87	14605454.65	40°12'55.1462"N	80°33'12.6145"W	452.91	93.804	0.44
3433.00	14.120	94.990	3380.02	-181.75	-32.12	473.92	1765086.87	14605452.59	40°12'55.1247"N	80°33'12.3309"W	475.01	93.877	0.24
3524.00	14.110	92.360	3468.27	-190.17	-33.54	496.06	1765109.00	14605451.16	40°12'55.1095"N	80°33'12.0456"W	497.19	93.868	0.70
3617.00	14.480	95.710	3558.39	-199.02	-35.16	518.96	1765131.89	14605449.54	40°12'55.0923"N	80°33'11.7506"W	520.15	93.876	0.97
3707.00	14.310	94.930	3645.57	-208.10	-37.24	541.23	1765154.16	14605447.47	40°12'55.0707"N	80°33'11.4636"W	542.51	93.936	0.29
3798.00	14.370	97.460	3733.73	-217.56	-39.67	563.64	1765176.55	14605445.03	40°12'55.0456"N	80°33'11.1750"W	565.03	94.026	0.69
3888.00	14.520	95.970	3820.89	-227.16	-42.29	585.93	1765198.84	14605442.41	40°12'55.0185"N	80°33'10.8878"W	587.46	94.129	0.45
3979.00	14.800	98.200	3908.92	-237.15	-45.14	608.78	1765221.68	14605439.57	40°12'54.9893"N	80°33'10.5934"W	610.45	94.240	0.69
4069.00	14.490	96.190	3996.00	-247.06	-47.99	631.35	1765244.24	14605436.72	40°12'54.9600"N	80°33'10.3026"W	633.17	94.347	0.66
4160.00	14.670	97.020	4084.07	-256.83	-50.63	654.11	1765266.99	14605434.08	40°12'54.9328"N	80°33'10.0095"W	656.06	94.426	0.30
4251.00	14.730	96.410	4172.09	-266.71	-53.33	677.04	1765289.91	14605431.38	40°12'54.9050"N	80°33'9.7141"W	679.14	94.504	0.18
4341.00	14.620	96.990	4259.16	-276.46	-55.99	699.69	1765312.55	14605428.72	40°12'54.8776"N	80°33'9.4224"W	701.92	94.575	0.20
4433.00	14.410	95.110	4348.22	-286.08	-58.42	722.61	1765335.46	14605426.29	40°12'54.8524"N	80°33'9.1270"W	724.97	94.622	0.56
4526.00	14.510	97.560	4438.27	-295.88	-60.98	745.69	1765358.53	14605423.73	40°12'54.8259"N	80°33'8.8297"W	748.18	94.675	0.67
4616.00	14.280	96.770	4525.45	-305.62	-63.78	767.89	1765380.72	14605420.94	40°12'54.7972"N	80°33'8.5437"W	770.53	94.748	0.34
4706.00	14.140	98.120	4612.70	-315.32	-66.64	789.79	1765402.62	14605418.08	40°12'54.7678"N	80°33'8.2616"W	792.60	94.823	0.40
4798.00	14.050	97.580	4701.93	-325.31	-69.70	811.99	1765424.80	14605415.02	40°12'54.7365"N	80°33'7.9757"W	814.97	94.906	0.17
4888.00	14.540	98.300	4789.14	-335.25	-72.77	833.99	1765446.80	14605411.95	40°12'54.7050"N	80°33'7.6922"W	837.16	94.987	0.58
4975.00	14.550	95.940	4873.35	-344.73	-75.48	855.67	1765468.47	14605409.24	40°12'54.6772"N	80°33'7.4130"W	858.99	95.041	0.68
5066.00	14.500	97.490	4961.44	-354.50	-78.14	878.34	1765491.13	14605406.58	40°12'54.6497"N	80°33'7.1210"W	881.80	95.084	0.43
5156.00	14.150	96.150	5048.65	-364.07	-80.79	900.44	1765513.23	14605403.93	40°12'54.6224"N	80°33'6.8362"W	904.06	95.127	0.54

RECEIVED  
Office Of Oil And Gas  
OCT 22 2024  
WV Department of  
Environmental Protection

REFERENCE WELLPATH IDENTIFICATION			
Operator	SWN PRODUCTION COMPANY, LLC	Well	Worthley BRK 5H
Field	Brooke	API	47009003400000
Facility	Worthley BRK Pad	Wellbore	Worthley BRK 5H AWB
Slot	5H		

### WELLPATH DATA (210 stations)

MD [ft]	Inclination [°]	Azimuth [°]	TVD [ft]	Vert Sect [ft]	North [ft]	East [ft]	Grid East [US ft]	Grid North [US ft]	Latitude	Longitude	Closure Dist [ft]	Closure Dir [°]	DLS [°/100ft]
5247.00	14.220	96.690	5136.87	-373.50	-83.29	922.60	1765535.38	14605401.44	40°12'54.5967"N	80°33'6.5507"W	926.36	95.158	0.16
5346.00	13.900	95.200	5232.90	-383.50	-85.78	946.52	1765559.29	14605398.94	40°12'54.5708"N	80°33'6.2426"W	950.40	95.178	0.49
5438.00	14.410	88.660	5322.12	-391.37	-86.51	968.97	1765581.73	14605398.21	40°12'54.5625"N	80°33'5.9532"W	972.83	95.102	1.82
5529.00	14.020	61.220	5410.43	-392.79	-80.94	989.98	1765602.73	14605403.79	40°12'54.6165"N	80°33'5.6821"W	993.28	94.674	7.35
5619.00	16.990	34.730	5497.25	-383.00	-64.86	1007.05	1765619.79	14605419.86	40°12'54.7746"N	80°33'5.4610"W	1009.14	93.685	8.44
5710.00	20.970	17.260	5583.36	-361.85	-38.35	1019.47	1765632.21	14605446.36	40°12'55.0359"N	80°33'5.2992"W	1020.19	92.154	7.58
5801.00	27.190	4.060	5666.46	-329.42	-2.00	1025.79	1765638.52	14605482.69	40°12'55.3948"N	80°33'5.2154"W	1025.79	90.112	9.00
5893.00	33.960	356.960	5745.65	-285.20	44.70	1025.91	1765638.65	14605529.37	40°12'55.8563"N	80°33'5.2107"W	1026.88	87.505	8.33
5988.00	42.350	350.890	5820.31	-227.96	102.92	1019.42	1765632.16	14605587.57	40°12'56.4319"N	80°33'5.2906"W	1024.61	84.235	9.66
6079.00	48.930	347.020	5883.91	-163.51	166.69	1006.85	1765619.59	14605651.32	40°12'57.0627"N	80°33'5.4485"W	1020.55	80.600	7.84
6171.00	57.610	343.150	5938.89	-90.02	237.81	987.76	1765600.51	14605722.41	40°12'57.7665"N	80°33'5.6899"W	1015.98	76.463	10.02
6263.00	65.900	344.250	5982.39	-9.11	315.54	965.06	1765577.82	14605800.11	40°12'58.5357"N	80°33'5.9774"W	1015.34	71.894	9.07
6354.00	75.240	343.630	6012.63	76.53	397.91	941.33	1765554.10	14605882.45	40°12'59.3509"N	80°33'6.2779"W	1021.98	67.086	10.28
6446.00	83.240	340.740	6029.80	166.82	483.87	913.68	1765526.46	14605968.38	40°13'0.2017"N	80°33'6.6288"W	1033.90	62.095	9.23
6538.00	90.620	338.070	6034.72	258.56	569.80	881.38	1765494.17	14606054.27	40°13'1.0524"N	80°33'7.0395"W	1049.53	57.118	8.53
6629.00	89.720	337.220	6034.45	349.36	653.96	846.77	1765459.58	14606138.40	40°13'1.8858"N	80°33'7.4802"W	1069.90	52.321	1.36
6721.00	89.970	337.670	6034.70	441.14	738.92	811.48	1765424.30	14606223.33	40°13'2.7271"N	80°33'7.9296"W	1097.50	47.680	0.56
6813.00	90.030	337.580	6034.70	532.95	823.99	776.46	1765389.29	14606308.37	40°13'3.5696"N	80°33'8.3755"W	1132.19	43.299	0.12
6904.00	90.580	337.610	6034.22	623.75	908.12	741.78	1765354.62	14606392.46	40°13'4.4026"N	80°33'8.8171"W	1172.57	39.243	0.61
6996.00	90.680	337.910	6033.20	715.56	993.27	706.96	1765319.82	14606477.58	40°13'5.2458"N	80°33'9.2604"W	1219.17	35.441	0.34
7088.00	90.680	337.510	6032.11	807.36	1078.39	672.07	1765284.94	14606562.67	40°13'6.0887"N	80°33'9.7046"W	1270.67	31.932	0.43
7180.00	90.650	337.400	6031.04	899.14	1163.36	636.80	1765249.68	14606647.60	40°13'6.9300"N	80°33'10.1538"W	1326.24	28.695	0.12
7272.00	90.520	337.340	6030.10	990.91	1248.27	601.40	1765214.30	14606732.48	40°13'7.7709"N	80°33'10.6046"W	1385.59	25.724	0.16
7363.00	90.800	337.170	6029.06	1081.67	1332.19	566.22	1765179.13	14606816.36	40°13'8.6019"N	80°33'11.0526"W	1447.52	23.027	0.36
7455.00	90.710	337.600	6027.84	1173.44	1417.10	530.84	1765143.77	14606901.25	40°13'9.4428"N	80°33'11.5031"W	1513.27	20.536	0.48
7547.00	90.830	337.740	6026.61	1265.24	1502.20	495.89	1765108.83	14606986.31	40°13'10.2854"N	80°33'11.9482"W	1581.93	18.269	0.20
7639.00	91.600	336.840	6024.66	1356.98	1587.04	460.38	1765073.33	14607071.12	40°13'11.1256"N	80°33'12.4004"W	1652.47	16.177	1.29
7730.00	90.920	336.880	6022.66	1447.67	1670.70	424.63	1765037.60	14607154.75	40°13'11.9541"N	80°33'12.8559"W	1723.82	14.260	0.75
7822.00	91.020	337.870	6021.10	1539.43	1755.61	389.24	1765002.22	14607239.62	40°13'12.7949"N	80°33'13.3065"W	1798.24	12.501	1.08
7914.00	90.580	335.220	6019.81	1631.09	1839.99	352.63	1764965.63	14607323.97	40°13'13.6306"N	80°33'13.7730"W	1873.48	10.849	2.92

Approved by: [Signature]  
Date: 11/17/2024

REFERENCE WELLPATH IDENTIFICATION			
Operator	SWN PRODUCTION COMPANY, LLC	Well	Worthley BRK 5H
Field	Brooke	API	47009003400000
Facility	Worthley BRK Pad	Wellbore	Worthley BRK 5H AWB
Slot	5H		

### WELLPATH DATA (210 stations)

MD [ft]	Inclination [°]	Azimuth [°]	TVD [ft]	Vert Sect [ft]	North [ft]	East [ft]	Grid East [US ft]	Grid North [US ft]	Latitude	Longitude	Closure Dist [ft]	Closure Dir [°]	DLS [°/100ft]
8005.00	90.740	334.260	6018.77	1721.47	1922.28	313.80	1764926.81	14607406.24	40°13'14.4457"N	80°33'14.2682"W	1947.73	9.271	1.07
8097.00	90.740	333.390	6017.58	1812.66	2004.84	273.22	1764886.25	14607488.76	40°13'15.2635"N	80°33'14.7860"W	2023.37	7.761	0.95
8189.00	90.860	337.090	6016.29	1904.11	2088.36	234.70	1764847.74	14607572.25	40°13'16.0908"N	80°33'15.2771"W	2101.51	6.412	4.02
8281.00	90.920	337.690	6014.86	1995.88	2173.28	199.34	1764812.39	14607657.13	40°13'16.9317"N	80°33'15.7275"W	2182.40	5.241	0.66
8372.00	91.350	338.890	6013.06	2086.73	2257.81	165.68	1764778.75	14607741.63	40°13'17.7686"N	80°33'16.1559"W	2263.88	4.197	1.40
8464.00	89.850	335.130	6012.10	2178.43	2342.48	129.76	1764742.84	14607826.27	40°13'18.6071"N	80°33'16.6135"W	2346.07	3.171	4.40
8555.00	90.550	338.880	6011.78	2269.15	2426.23	94.22	1764707.31	14607909.99	40°13'19.4365"N	80°33'17.0663"W	2428.06	2.224	4.19
8647.00	90.590	339.220	6010.86	2361.07	2512.14	61.32	1764674.43	14607995.87	40°13'20.2871"N	80°33'17.4848"W	2512.89	1.398	0.37
8739.00	90.740	338.840	6009.80	2452.99	2598.04	28.40	1764641.52	14608081.74	40°13'21.1376"N	80°33'17.9037"W	2598.20	0.626	0.44
8831.00	90.710	338.980	6008.63	2544.89	2683.88	-4.70	1764608.43	14608167.53	40°13'21.9874"N	80°33'18.3248"W	2683.88	359.900	0.16
8922.00	90.890	338.870	6007.36	2635.80	2768.78	-37.42	1764575.72	14608252.41	40°13'22.8280"N	80°33'18.7412"W	2769.03	359.226	0.23
9014.00	91.140	338.330	6005.73	2727.68	2854.42	-70.98	1764542.17	14608338.02	40°13'23.6760"N	80°33'19.1683"W	2855.31	358.575	0.65
9106.00	90.340	338.480	6004.54	2819.55	2939.96	-104.84	1764508.33	14608423.52	40°13'24.5229"N	80°33'19.5992"W	2941.83	357.958	0.88
9197.00	91.140	338.370	6003.37	2910.42	3024.57	-138.30	1764474.88	14608508.10	40°13'25.3607"N	80°33'20.0251"W	3027.73	357.382	0.89
9289.00	90.460	337.120	6002.08	3002.22	3109.71	-173.14	1764440.06	14608593.21	40°13'26.2038"N	80°33'20.4688"W	3114.53	356.813	1.55
9381.00	90.340	337.720	6001.44	3094.00	3194.66	-208.46	1764404.75	14608678.12	40°13'27.0449"N	80°33'20.9187"W	3201.45	356.267	0.67
9472.00	91.110	341.060	6000.29	3184.92	3279.81	-240.49	1764372.73	14608763.24	40°13'27.8880"N	80°33'21.3260"W	3288.62	355.806	3.77
9564.00	90.920	338.430	5998.66	3276.86	3366.10	-272.33	1764340.90	14608849.50	40°13'28.7423"N	80°33'21.7310"W	3377.10	355.375	2.87
9656.00	90.340	338.460	5997.65	3368.74	3451.66	-306.13	1764307.12	14608935.03	40°13'29.5894"N	80°33'22.1612"W	3465.21	354.932	0.63
9747.00	90.460	338.730	5997.01	3459.63	3536.38	-339.34	1764273.92	14609019.71	40°13'30.4283"N	80°33'22.5839"W	3552.63	354.519	0.32
9839.00	90.580	338.660	5996.18	3551.52	3622.09	-372.77	1764240.51	14609105.39	40°13'31.2769"N	80°33'23.0092"W	3641.22	354.124	0.15
9931.00	90.830	340.070	5995.05	3643.46	3708.18	-405.18	1764208.10	14609191.45	40°13'32.1292"N	80°33'23.4216"W	3730.25	353.764	1.56
10023.00	91.390	337.540	5993.26	3735.34	3793.93	-438.44	1764174.86	14609277.17	40°13'32.9782"N	80°33'23.8448"W	3819.18	353.408	2.82
10114.00	90.180	338.420	5992.02	3826.17	3878.29	-472.55	1764140.76	14609361.49	40°13'33.8135"N	80°33'24.2792"W	3906.97	353.053	1.64
10206.00	90.000	338.880	5991.87	3918.06	3963.97	-506.04	1764107.28	14609447.14	40°13'34.6519"N	80°33'24.7055"W	3996.14	352.725	0.54
10298.00	90.710	340.050	5991.30	4010.01	4050.12	-538.32	1764075.02	14609533.26	40°13'35.5148"N	80°33'25.1160"W	4085.74	352.429	1.49
10390.00	90.250	338.830	5990.53	4101.95	4136.26	-570.62	1764042.73	14609619.36	40°13'36.3675"N	80°33'25.5269"W	4175.43	352.145	1.42
10481.00	90.460	340.630	5989.97	4192.90	4221.62	-602.15	1764011.21	14609704.68	40°13'37.2126"N	80°33'25.9279"W	4264.34	351.882	1.99
10573.00	90.710	341.020	5989.03	4284.90	4308.51	-632.36	1763981.01	14609791.54	40°13'38.0727"N	80°33'26.3118"W	4354.67	351.650	0.50
10665.00	89.940	338.610	5988.51	4376.85	4394.85	-664.11	1763949.28	14609877.85	40°13'38.9275"N	80°33'26.7155"W	4444.74	351.407	2.75

REFERENCE WELLPATH IDENTIFICATION			
Operator	SWN PRODUCTION COMPANY, LLC	Well	Worthley BRK 5H
Field	Brooke	API	47009003400000
Facility	Worthley BRK Pad	Wellbore	Worthley BRK 5H AWB
Slot	5H		

### WELLPATH DATA (210 stations)

MD [ft]	Inclination [°]	Azimuth [°]	TVD [ft]	Vert Sect [ft]	North [ft]	East [ft]	Grid East [US ft]	Grid North [US ft]	Latitude	Longitude	Closure Dist [ft]	Closure Dir [°]	DLS [°/100ft]
10757.00	89.850	336.720	5988.68	4468.65	4479.94	-699.07	1763914.33	14609962.91	40°13'39.7701"N	80°33'27.1607"W	4534.16	351.131	2.06
10849.00	90.030	337.260	5988.77	4560.38	4564.62	-735.03	1763878.39	14610047.56	40°13'40.6087"N	80°33'27.6189"W	4623.42	350.852	0.62
10940.00	90.770	337.090	5988.14	4651.14	4648.49	-770.33	1763843.10	14610131.40	40°13'41.4392"N	80°33'28.0686"W	4711.89	350.591	0.83
11032.00	90.980	337.270	5986.73	4742.88	4733.28	-806.00	1763807.44	14610216.15	40°13'42.2788"N	80°33'28.5232"W	4801.42	350.336	0.30
11124.00	89.910	336.660	5986.02	4834.60	4817.94	-842.00	1763771.45	14610300.78	40°13'43.1172"N	80°33'28.9818"W	4890.97	350.087	1.34
11215.00	90.550	336.690	5985.65	4925.29	4901.51	-878.03	1763735.44	14610384.31	40°13'43.9447"N	80°33'29.4410"W	4979.53	349.844	0.70
11307.00	90.860	336.710	5984.52	5016.98	4986.00	-914.42	1763699.06	14610468.77	40°13'44.7814"N	80°33'29.9047"W	5069.15	349.608	0.34
11399.00	89.850	336.780	5983.95	5108.68	5070.52	-950.74	1763662.75	14610553.26	40°13'45.6185"N	80°33'30.3676"W	5158.88	349.380	1.10
11491.00	88.770	336.000	5985.06	5200.32	5154.81	-997.58	1763625.92	14610637.52	40°13'46.4532"N	80°33'30.8372"W	5248.56	349.154	1.45
11582.00	88.800	336.290	5986.99	5290.92	5238.02	-1024.38	1763589.14	14610720.69	40°13'47.2773"N	80°33'31.3062"W	5337.24	348.935	0.32
11674.00	90.860	336.700	5987.26	5382.58	5322.38	-1061.07	1763552.47	14610805.02	40°13'48.1127"N	80°33'31.7738"W	5427.12	348.725	2.28
11766.00	90.490	336.920	5986.18	5474.28	5406.94	-1097.29	1763516.26	14610889.55	40°13'48.9501"N	80°33'32.2355"W	5517.16	348.528	0.47
11857.00	90.490	336.500	5985.40	5564.97	5490.52	-1133.27	1763480.29	14610973.10	40°13'49.7778"N	80°33'32.6940"W	5606.26	348.338	0.46
11949.00	90.400	335.680	5984.68	5656.58	5574.62	-1170.56	1763443.02	14611057.17	40°13'50.6107"N	80°33'33.1693"W	5696.19	348.141	0.90
12041.00	90.370	335.560	5984.07	5748.11	5658.42	-1208.53	1763405.06	14611140.93	40°13'51.4406"N	80°33'33.6536"W	5786.04	347.944	0.13
12132.00	90.370	335.480	5983.48	5838.63	5741.23	-1246.24	1763367.37	14611223.72	40°13'52.2609"N	80°33'34.1344"W	5874.94	347.753	0.09
12224.00	90.460	335.600	5982.81	5930.15	5824.98	-1284.33	1763329.29	14611307.43	40°13'53.0902"N	80°33'34.6202"W	5964.88	347.566	0.16
12316.00	90.490	335.910	5982.05	6021.71	5908.86	-1322.11	1763291.53	14611391.28	40°13'53.9210"N	80°33'35.1019"W	6054.96	347.388	0.34
12408.00	90.490	335.830	5981.26	6113.28	5992.82	-1359.72	1763253.93	14611475.20	40°13'54.7525"N	80°33'35.5814"W	6145.13	347.216	0.09
12499.00	90.400	335.450	5980.55	6203.82	6075.71	-1397.25	1763216.41	14611558.07	40°13'55.5735"N	80°33'36.0600"W	6234.31	347.049	0.43
12591.00	90.310	335.400	5979.98	6295.32	6159.38	-1435.51	1763178.17	14611641.70	40°13'56.4021"N	80°33'36.5480"W	6324.45	346.881	0.11
12682.00	90.430	336.200	5979.40	6385.89	6242.38	-1472.82	1763140.88	14611724.67	40°13'57.2242"N	80°33'37.0236"W	6413.77	346.725	0.89
12774.00	90.830	335.460	5978.39	6477.45	6326.31	-1510.48	1763103.23	14611808.56	40°13'58.0554"N	80°33'37.5039"W	6504.13	346.571	0.91
12866.00	90.890	335.140	5977.00	6568.92	6409.88	-1548.92	1763064.80	14611892.11	40°13'58.8831"N	80°33'37.9942"W	6594.37	346.415	0.35
12958.00	90.950	335.710	5975.53	6660.41	6493.53	-1587.18	1763026.56	14611975.73	40°13'59.7117"N	80°33'38.4821"W	6684.69	346.265	0.62
13050.00	90.980	335.410	5973.98	6751.93	6577.28	-1625.24	1762988.52	14612059.44	40°14'0.5411"N	80°33'38.9675"W	6775.10	346.120	0.33
13141.00	91.080	335.400	5972.34	6842.42	6660.01	-1663.11	1762950.66	14612142.14	40°14'1.3604"N	80°33'39.4504"W	6864.52	345.979	0.11
13233.00	90.830	335.570	5970.81	6933.92	6743.70	-1701.27	1762912.51	14612225.80	40°14'2.1894"N	80°33'39.9372"W	6954.99	345.841	0.33
13325.00	90.830	335.340	5969.48	7025.42	6827.38	-1739.49	1762874.31	14612309.45	40°14'3.0181"N	80°33'40.4246"W	7045.49	345.706	0.25
13416.00	90.950	335.610	5968.06	7115.92	6910.16	-1777.26	1762836.56	14612392.20	40°14'3.8380"N	80°33'40.9063"W	7135.05	345.576	0.32

### REFERENCE WELLPATH IDENTIFICATION

Operator	SWN PRODUCTION COMPANY, LLC	Well	Worthley BRK 5H
Field	Brooke	API	47009003400000
Facility	Worthley BRK Pad	Wellbore	Worthley BRK 5H AWB
Slot	5H		

### WELLPATH DATA (210 stations)

MD [ft]	Inclination [°]	Azimuth [°]	TVD [ft]	Vert Sect [ft]	North [ft]	East [ft]	Grid East [US ft]	Grid North [US ft]	Latitude	Longitude	Closure Dist [ft]	Closure Dir [°]	DLS [°/100ft]
13508.00	90.890	335.510	5966.59	7207.44	6993.91	-1815.32	1762798.51	14612475.91	40°14'4.6674"N	80°33'41.3917"W	7225.66	345.450	0.13
13600.00	91.020	335.520	5965.05	7298.94	7077.62	-1853.44	1762760.40	14612559.59	40°14'5.4965"N	80°33'41.8779"W	7316.28	345.325	0.14
13691.00	90.950	335.490	5963.49	7389.45	7160.42	-1891.16	1762722.69	14612642.36	40°14'6.3165"N	80°33'42.3590"W	7405.95	345.205	0.08
13783.00	90.800	335.800	5962.08	7480.98	7244.22	-1929.10	1762684.77	14612726.13	40°14'7.1465"N	80°33'42.8428"W	7496.68	345.088	0.37
13875.00	90.990	335.670	5960.65	7572.52	7328.08	-1966.90	1762646.98	14612809.96	40°14'7.9771"N	80°33'43.3249"W	7587.45	344.976	0.25
13967.00	90.860	336.760	5959.16	7664.14	7412.26	-2004.00	1762609.90	14612894.10	40°14'8.8107"N	80°33'43.7979"W	7678.38	344.871	1.19
14058.00	90.860	336.460	5957.79	7754.81	7495.77	-2040.12	1762573.79	14612977.58	40°14'9.6377"N	80°33'44.2584"W	7768.44	344.775	0.33
14150.00	91.050	336.670	5956.26	7846.47	7580.17	-2076.71	1762537.22	14613061.95	40°14'10.4735"N	80°33'44.7247"W	7859.50	344.679	0.31
14242.00	91.020	336.780	5954.60	7938.15	7664.67	-2113.05	1762500.89	14613146.41	40°14'11.3103"N	80°33'45.1880"W	7950.61	344.587	0.12
14334.00	90.800	336.310	5953.14	8029.82	7749.06	-2149.67	1762464.29	14613230.77	40°14'12.1459"N	80°33'45.6547"W	8041.70	344.495	0.56
14425.00	90.830	336.770	5951.84	8120.48	7832.53	-2185.89	1762428.08	14613314.20	40°14'12.9725"N	80°33'46.1165"W	8131.82	344.407	0.51
14517.00	90.770	336.950	5950.56	8212.19	7917.12	-2222.04	1762391.94	14613398.76	40°14'13.8102"N	80°33'46.5773"W	8223.03	344.323	0.21
14609.00	91.260	337.780	5948.93	8303.94	8002.01	-2257.44	1762356.55	14613483.63	40°14'14.6509"N	80°33'47.0283"W	8314.34	344.246	1.05
14700.00	91.350	337.940	5946.86	8394.75	8086.28	-2291.73	1762322.28	14613567.86	40°14'15.4853"N	80°33'47.4651"W	8404.76	344.177	0.20
14792.00	91.140	337.070	5944.86	8486.52	8171.26	-2326.92	1762287.10	14613652.81	40°14'16.3267"N	80°33'47.9135"W	8496.12	344.105	0.97
14884.00	90.860	337.180	5943.25	8578.25	8256.01	-2362.88	1762251.36	14613737.53	40°14'17.1660"N	80°33'48.3691"W	8587.43	344.030	0.33
14975.00	91.050	337.770	5941.74	8669.02	8340.06	-2397.53	1762216.52	14613821.54	40°14'17.9982"N	80°33'48.8133"W	8677.83	343.962	0.68
15067.00	91.110	337.980	5940.00	8760.84	8425.27	-2432.18	1762181.89	14613906.72	40°14'18.8419"N	80°33'49.2546"W	8769.30	343.898	0.24
15158.00	91.020	337.690	5938.31	8851.65	8509.53	-2466.50	1762147.57	14613990.95	40°14'19.6762"N	80°33'49.6918"W	8859.78	343.836	0.33
15250.00	90.950	338.160	5936.73	8943.47	8594.77	-2501.07	1762113.02	14614076.16	40°14'20.5202"N	80°33'50.1322"W	8951.28	343.775	0.52
15341.00	90.980	341.080	5935.20	9034.40	8680.06	-2532.76	1762081.35	14614161.41	40°14'21.3645"N	80°33'50.5353"W	9042.03	343.733	3.21
15433.00	91.020	342.840	5933.59	9126.38	8767.52	-2561.24	1762052.87	14614248.84	40°14'22.2302"N	80°33'50.9971"W	9133.96	343.715	1.91
15525.00	91.050	345.210	5931.93	9218.26	8855.94	-2586.56	1762027.57	14614337.23	40°14'23.1052"N	80°33'51.2179"W	9225.94	343.718	2.58
15616.00	91.110	347.210	5930.21	9308.91	8944.30	-2608.24	1762005.89	14614425.55	40°14'23.9794"N	80°33'51.4919"W	9316.84	343.743	2.20
15708.00	91.080	349.320	5928.45	9400.23	9034.35	-2626.95	1761987.19	14614515.57	40°14'24.8702"N	80°33'51.7275"W	9408.53	343.787	2.29
15800.00	90.990	351.680	5926.79	9491.04	9125.07	-2642.13	1761972.02	14614606.25	40°14'25.7674"N	80°33'51.9175"W	9499.88	343.852	2.57
15891.00	91.050	353.580	5925.17	9580.28	9215.30	-2653.80	1761960.35	14614696.45	40°14'26.6596"N	80°33'52.0622"W	9589.81	343.935	2.09
15983.00	90.890	353.320	5923.61	9670.23	9306.69	-2664.29	1761949.86	14614787.80	40°14'27.5632"N	80°33'52.1918"W	9680.54	344.025	0.33
16075.00	90.990	353.350	5922.11	9760.22	9398.05	-2674.97	1761939.19	14614879.13	40°14'28.4665"N	80°33'52.3236"W	9771.33	344.112	0.11
16166.00	91.110	353.590	5920.44	9849.19	9488.45	-2685.32	1761928.84	14614969.49	40°14'29.3603"N	80°33'52.4514"W	9861.11	344.198	0.29



11/2/2024

REFERENCE WELLPATH IDENTIFICATION			
Operator	SWN PRODUCTION COMPANY, LLC	Well	Worthley BRK 5H
Field	Brooke	API	47009003400000
Facility	Worthley BRK Pad	Wellbore	Worthley BRK 5H AWB
Slot	5H		

WELLPATH DATA (210 stations) † = interpolated, ‡ = extrapolated station													
MD [ft]	Inclination [°]	Azimuth [°]	TVD [ft]	Vert Sect [ft]	North [ft]	East [ft]	Grid East [US ft]	Grid North [US ft]	Latitude	Longitude	Closure Dist [ft]	Closure Dir [°]	DLS ["/100ft]
16258.00	90.800	353.450	5918.90	9939.12	9579.85	-2695.70	1761918.47	14615060.86	40°14'30.2640"N	80°33'52.5794"W	9951.90	344.284	0.37
16350.00	90.770	353.490	5917.64	10029.07	9671.24	-2706.16	1761908.01	14615152.21	40°14'31.1677"N	80°33'52.7086"W	10042.72	344.368	0.05
16441.00	90.770	353.440	5916.42	10118.05	9781.64	-2716.52	1761897.66	14615242.58	40°14'32.0615"N	80°33'52.8364"W	10132.58	344.449	0.05
16533.00	90.860	353.510	5915.11	10207.99	9853.04	-2726.97	1761887.21	14615333.94	40°14'32.9651"N	80°33'52.9654"W	10223.44	344.530	0.12
16625.00	90.800	353.280	5913.78	10297.97	9944.42	-2737.55	1761876.63	14615425.28	40°14'33.8686"N	80°33'53.0960"W	10314.34	344.609	0.26
16716.00	90.620	353.210	5912.65	10387.02	10034.78	-2748.25	1761865.93	14615515.61	40°14'34.7621"N	80°33'53.2283"W	10404.31	344.684	0.21
16808.00	90.890	353.670	5911.44	10476.98	10126.17	-2758.76	1761855.43	14615606.97	40°14'35.6657"N	80°33'53.3581"W	10495.24	344.760	0.58
16900.00	90.770	353.650	5910.11	10566.87	10217.60	-2768.92	1761845.27	14615698.36	40°14'36.5696"N	80°33'53.4833"W	10586.13	344.837	0.13
16992.00	90.740	353.600	5908.90	10656.76	10309.02	-2779.14	1761835.06	14615789.75	40°14'37.4736"N	80°33'53.6092"W	10677.05	344.913	0.06
17084.00	90.990	353.470	5907.51	10746.69	10400.42	-2789.49	1761824.71	14615881.12	40°14'38.3773"N	80°33'53.7370"W	10768.01	344.986	0.31
17175.00	90.950	353.130	5905.97	10835.72	10490.79	-2800.11	1761814.10	14615971.45	40°14'39.2708"N	80°33'53.8682"W	10858.05	345.056	0.38
17267.00	91.450	353.500	5904.04	10925.71	10582.14	-2810.82	1761803.39	14616062.77	40°14'40.1741"N	80°33'54.0005"W	10949.08	345.125	0.68
17358.00	91.420	353.540	5901.76	11014.64	10672.53	-2821.08	1761793.13	14616153.12	40°14'41.0678"N	80°33'54.1272"W	11039.09	345.194	0.05
17450.00	91.420	353.610	5899.48	11104.54	10763.93	-2831.37	1761782.84	14616244.48	40°14'41.9714"N	80°33'54.2541"W	11130.09	345.263	0.08
17542.00	91.020	353.250	5897.52	11194.49	10855.30	-2841.90	1761772.32	14616335.82	40°14'42.8749"N	80°33'54.3840"W	11221.14	345.329	0.58
17634.00	90.920	353.350	5895.96	11284.50	10946.66	-2852.63	1761761.60	14616427.14	40°14'43.7782"N	80°33'54.5167"W	11312.24	345.394	0.15
17725.00	90.860	352.530	5894.55	11373.64	11036.96	-2863.81	1761750.42	14616517.41	40°14'44.6710"N	80°33'54.6552"W	11402.45	345.454	0.90
17817.00	91.050	355.430	5893.02	11463.40	11128.43	-2873.46	1761740.77	14616608.84	40°14'45.5754"N	80°33'54.7738"W	11493.42	345.522	3.16
17909.00	90.830	353.250	5891.51	11553.04	11219.96	-2882.53	1761731.71	14616700.34	40°14'46.4803"N	80°33'54.8850"W	11584.32	345.592	2.38
18001.00	90.800	353.270	5890.20	11643.06	11311.32	-2893.33	1761720.91	14616791.66	40°14'47.3836"N	80°33'55.0184"W	11675.50	345.652	0.04
18092.00	90.580	353.580	5889.10	11732.05	11401.71	-2903.75	1761710.50	14616882.02	40°14'48.2774"N	80°33'55.1471"W	11766.66	345.712	0.42
18184.00	90.400	353.460	5888.32	11821.99	11493.12	-2914.13	1761700.12	14616973.39	40°14'49.1812"N	80°33'55.2752"W	11856.81	345.772	0.24
18276.00	90.490	353.400	5887.60	11911.96	11584.51	-2924.66	1761689.60	14617064.75	40°14'50.0848"N	80°33'55.4052"W	11947.99	345.831	0.12
18368.00	90.580	353.560	5886.74	12001.91	11675.91	-2935.10	1761679.16	14617156.12	40°14'50.9885"N	80°33'55.5341"W	12039.18	345.889	0.20
18459.00	90.490	353.390	5885.89	12090.89	11766.32	-2945.44	1761668.82	14617246.49	40°14'51.8824"N	80°33'55.6618"W	12129.38	345.946	0.21
18551.00	90.550	353.340	5885.06	12180.88	11857.70	-2956.07	1761658.19	14617337.83	40°14'52.7859"N	80°33'55.7931"W	12220.62	346.002	0.08
18643.00	90.490	353.360	5884.22	12270.87	11949.08	-2966.73	1761647.54	14617429.18	40°14'53.6894"N	80°33'55.9247"W	12311.86	346.057	0.07
18734.00	90.520	353.520	5883.42	12359.86	12039.48	-2977.12	1761637.15	14617519.54	40°14'54.5832"N	80°33'56.0530"W	12402.11	346.111	0.18
18778.00	90.520	353.490	5883.02	12402.88	12083.20	-2982.10	1761632.18	14617563.24	40°14'55.0154"N	80°33'56.1145"W	12445.74	346.137	0.07
18803.00	90.520	353.480	5882.78	12427.32	12108.03	-2984.93	1761629.34	14617588.07	40°14'55.2610"N	80°33'56.1494"W	12470.54	346.151	0.00

**HOLE & CASING SECTIONS - Ref Wellbore: Worthley BRK 5H AWB Ref Wellpath: Worthley BRK 5H awp Proj: 18803'**

String/Diameter	Start MD [ft]	End MD [ft]	Interval [ft]	Start TVD [ft]	End TVD [ft]	Start N/S [ft]	Start E/W [ft]	End N/S [ft]	End E/W [ft]
13.375in Casing	26.00	600.00	574.00	26.00	600.00	0.00	0.00	0.54	1.31
9.625in Casing	26.00	1735.00	1709.00	26.00	1731.59	0.00	0.00	11.93	71.64
5.5in Casing	26.00	18803.00	18777.00	26.00	5882.79	0.00	0.00	12108.03	-2984.93

**TARGETS**

Name	TVD [ft]	North [ft]	East [ft]	Grid East [US ft]	Grid North [US ft]	Latitude	Longitude	Shape
Worthley BRK 5H BHL Rev 3	5882.10	12107.08	-2991.12	1761623.16	14617587.12	40°14'55.2519"N	80°33'56.2293"W	point
Worthley BRK 5H wp3	5927.15	8506.52	-2453.03	1762161.04	14613987.94	40°14'19.6458"N	80°33'49.5183"W	point
Worthley BRK 5H wp2	5945.92	7144.09	-1865.95	1762747.90	14612626.03	40°14'6.1539"N	80°33'42.0349"W	point
Worthley BRK 5H wp1	5983.20	4444.09	-686.70	1763926.69	14609927.07	40°13'39.4152"N	80°33'27.0037"W	point
Worthley BRK 5H LP Rev 5	6035.00	573.61	893.50	1765506.29	14606058.08	40°13'1.0895"N	80°33'6.8831"W	point

RECEIVED  
Office Of Oil and Gas  
OCT 23 2024  
WV Department of  
Environmental Protection

REFERENCE WELLPATH IDENTIFICATION			
Operator	SWN PRODUCTION COMPANY, LLC	Well	Worthley BRK 5H
Field	Brooke	API	47009003400000
Facility	Worthley BRK Pad	Wellbore	Worthley BRK 5H AWB
Slot	5H		

WELLPATH COMPOSITION - Ref Wellbore: Worthley BRK 5H AWB Ref Wellpath: Worthley BRK 5H awp Proj: 18803'					
Start MD [ft]	End MD [ft]	Positional Uncertainty Model	Log Name/Comment	Wellbore	Survey Date
26.00	598.00	OWSG MWD rev2 + IFR1 + Multi-Station Correction	1 Total MWD 17.5" IFR-MSA 174' - 598'	Worthley BRK 5H AWB	6/9/2024
598.00	1663.00	OWSG MWD rev2 + IFR1 + Multi-Station Correction	2 Total MWD 12.25" IFR-MSA 689' - 1663'	Worthley BRK 5H AWB	6/9/2024
1663.00	5247.00	OWSG MWD rev2 + IFR1 + Multi-Station Correction	3 Total MWD 8.75" IFR-MSA 1749' - 5247'	Worthley BRK 5H AWB	6/9/2024
5247.00	18803.00	OWSG MWD rev2 + IFR1 + Multi-Station Correction	4 BH MWD 8.5" IFR-MSA 5346' - 18778'	Worthley BRK 5H AWB	6/9/2024

RECEIVED  
Office Of Oil and Gas  
OCT 22 2024  
WV Department of  
Environmental Protection