

LATITUDE: 40°15'00" SURFACE HOLE (2000' SCALE) | 3,825'

BHL LATITUDE: 40°15'00" BOTTOM HOLE (2000' SCALE) | 6,756'



68011 Vineyard Road
St. Clairsville, Ohio 43950
740-695-6100

NOTES ON SURVEY

1. COORDINATE SYSTEM IS UTM NAD 83 DATUM, ZONE 17, U.S. FOOT AND WELL COORDINATES ESTABLISHED USING SURVEY GRADE GPS.
2. SURFACE AND ROYALTY OWNER INFORMATION AND THEIR BOUNDARIES SHOWN HEREON WERE PLOTTED FROM DEEDS AND/OR TAX PARCEL MAPS PROVIDED BY CLIENT AND/OR FIELD LOCATIONS.
3. THIS PLAT DOES NOT REPRESENT A BOUNDARY SURVEY OF THE PARCELS SHOWN HEREON.
4. NO DWELLINGS OR BUILDINGS WITHIN 625 FEET OF PROPOSED CENTER OF PAD.
5. NO PERENNIAL STREAMS, LAKES, PONDS, RESERVOIRS OR WETLANDS WITHIN 100 FEET OF THE LIMITS OF DISTURBANCE.
6. NO NATURALLY PRODUCING TROUT STREAM WITHIN 300 FEET OF THE LIMITS OF DISTURBANCE.
7. NO WATER WELLS OR DEVELOPED SPRINGS WITHIN 250 FEET OF PROPOSED WELL.

LINE	BEARING	DISTANCE
L1	N67°48'17"W	1,747.56'
L2	N16°55'58"W	713.48'

SURFACE HOLE LOCATION (SHL): UTM (NAD83, ZONE 17, METERS): NORTHING: 4451760.59 EASTING: 537855.20
LANDING POINT LOCATION (LPL): UTM (NAD83, ZONE 17, METERS): NORTHING: 4451935.41 EASTING: 538127.39
BOTTOM HOLE LOCATION (BHL): UTM (NAD83, ZONE 17, METERS): NORTHING: 4455449.47 EASTING: 536943.81

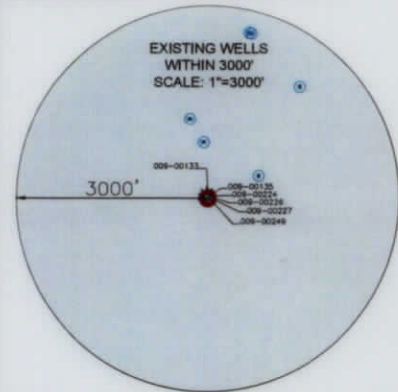

GRID NORTH
UTM, NAD83 DATUM, ZONE 17, US FT



I, THE UNDERSIGNED, HEREBY CERTIFY THAT THIS PLAT IS CORRECT TO THE BEST OF MY KNOWLEDGE AND BELIEF AND SHOWS ALL THE INFORMATION REQUIRED BY LAW AND REGULATIONS ISSUED AND PRESCRIBED BY THE DEPARTMENT OF ENVIRONMENTAL PROTECTION.

P.S. 2450

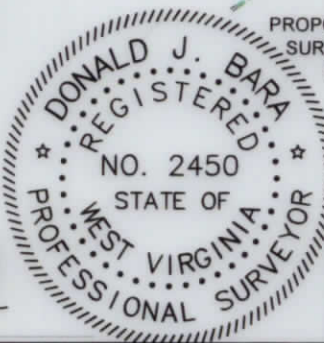

COMPANY: **SWN** Production Company, LLC

(+) DENOTES LOCATION OF WELL ON UNITED STATES TOPOGRAPHIC MAPS

WVDEP
OFFICE OF OIL & GAS
601 57TH STREET
CHARLESTON, WV 25034

MINIMUM DEGREE OF ACCURACY: 1/200

PROVEN SOURCE OF ELEVATION: SURVEY GRADE GPS (NAVD 88, US FT)

WORTHLEY BRK

OPERATOR'S WELL #: 5H

API WELL #: 47 STATE 009 COUNTY 00340 PERMIT

WELL TYPE: OIL WASTE DISPOSAL PRODUCTION DEEP GAS LIQUID INJECTION STORAGE SHALLOW

WATERSHED: UPPER OHIO SOUTH ELEVATION: 1156.9'

DISTRICT: BUFFALO COUNTY: BROOKE QUADRANGLE: BETHANY, WV

SURFACE OWNER: KIMBERLY CARMAN WORTHLEY ACREAGE: ±40.0

OIL & GAS ROYALTY OWNER: COLONIAL CORP, A NEVADA CORP, & KIMBERLY J. CARMAN AKA KIMBERLY J. WORTHLEY, A MARRIED WOMAN DEALING IN HER SASP ACREAGE: ±40.0

DRILL DRILL DEEPER REDRILL FRACTURE OR STIMULATE PLUG OFF OLD FORMATION PERFORATE NEW FORMATION

CONVERT PLUG & ABANDON CLEAN OUT & REPLUG OTHER CHANGE (SPECIFY)

TARGET FORMATION: MARCELLUS ESTIMATED DEPTH: 6,035' TVD 18,807' TMD

WELL OPERATOR: SWN PRODUCTION COMPANY, LLC DESIGNATED AGENT: BRITTANY WOODY

ADDRESS: 1300 FORT PIERPONT DRIVE, SUITE 201 ADDRESS: 1300 FORT PIERPONT DRIVE, SUITE 201

CITY: MORGANTOWN STATE: WV ZIP CODE: 26508 CITY: MORGANTOWN STATE: WV ZIP CODE: 26508

LEGEND:	REVISIONS:	DATE: 03-08-2024
○ PROPOSED SURFACE HOLE / BOTTOM HOLE		API NO: 47-009-XXXXX
⊛ EXISTING / PRODUCING WELLHEAD	— NATURAL WATERWAY	DRAWN BY: Z. WOOD
LPL* LANDING POINT LOCATION	— SURVEYED BOUNDARY	SCALE: 1" = 2000'
⊙ EXISTING WATER WELL	== LEASE BOUNDARY	DRAWING NO: 2023-1649
⊙ EXISTING SPRING	— PROPOSED PATH	WELL LOCATION PLAT
	— PUBLIC ROAD	

LONGITUDE: 80°32'30" BOTTOM HOLE (2000' SCALE) 503'

LONGITUDE: 80°32'30" SURFACE HOLE (2000' SCALE) 1,2,624'

WELL BORE TABLE FOR SURFACE/ROYALTY OWNERS		
TRACT	SURFACE OWNER (S) / ROYALTY OWNER (R)	TAX PARCEL
1	WORTHLEY KIMBERLY CARMAN (S) COLONIAL CORP, A NEVADA CORP, & KIMBERLY J. CARMAN AKA KIMBERLY J. WORTHLEY, A MARRIED WOMAN DEALING IN HER SASP(R)	3-B38-27
TRACT	SURFACE OWNER	TAX PARCEL
2	WORTHLY KIMBERLY CARMEN; JEFFREY W HENSLEY (LC)	3-B38-25
	STATE OF WEST VIRGINIA, DIVISION OF HIGHWAYS	BETHANY PIKE
3	HENSLEY JEFFREY W	3-B38-27.1
4	HENSLEY JEFFREY W	3-B38-28
5	SPORTSMANS FARMERS ASSN	3-B38-17
6	SPORTSMANS & FARMERS ASSN	3-B33-100
7	HUKILL TAMARA J	3-B33-97.2
8	KOSCEVIC MICHAEL THOMAS & SHERYL ANN (SURV)	3-B33-97.3
	STATE OF WEST VIRGINIA, DIVISION OF HIGHWAYS	MCADOO RIDGE ROAD
9	LANCASTER DELMAS O & ELFRIEDE	3-B33-95
10	YANO MICHAEL JAMES & JENNIFER LYNN (SURV)	3-B33-43
11	HENNIS FLOYD; LAROCHE LEONA; DISHER TANA	3-B33-38
	STATE OF WEST VIRGINIA, DIVISION OF HIGHWAYS	PIERCE RUN ROAD
12	WELLS GIST LAND CO., LLC	3-B33-40
13	WELLS GIST LAND CO., LLC	3-B33-29
14	WELLS GIST LAND CO., LLC	3-B33-23

ADJOINING OWNERS TABLE		
TRACT	SURFACE OWNER	TAX PARCEL
AS	SMITH JON T & MARLENA L	3-B33-37
AT	CULBERTSON MELVIN & DORIS	3-B33-96
AU	EDGELL SCOTT L	3-B33-99
AV	LONG BRIAN T & JACINDA D	3-B33-98
AW	LONG BRIAN T & JACINDA D (SURV)	3-B33-97.4
AX	TANNER GEORGE A; SWEET BARBARA B (SURV)	3-B33-97.1
AY	CORBIN CHARLES R JR (TOD)	3-B33-102
AZ	SPORTSMANS FARMERS ASSN	3-B33-101
BA	OWEN MARK WEAVER & KREUTZ; VIRGINIA BEALL	3-B38-19
BB	STEWART KEVIN SCOTT & LISA KAY	3-B38-20
BC	OWEN MARK WEAVER & KREUTZ; VIRGINIA BEALL	3-B38-19
BD	ELSON LANCE M	3-B38-21
BE	VANCAMP NOLTE&GLADYS AS TRUS; OF 11/4/02 VANCAMP FAMILY TR	3-B38-23
BF	OWEN MARK W 1/2 INT: KRUEZT VIRGINIA BEALL 1/2 INT:	3-B38-24
BG	BETHANY COLLEGE	3-B43-66
BH	BETHANY COLLEGE	2-B43C-127
BI	HENNIS FLOYD;LAROCHE LEONA; DISHER TANA	3-B33-39
BJ	SIDERICH EVAN JTWS	3-B33-42
BK	SPORTSMAN & FARMERS ASSN	3-B38-16
BL	HENSLEY JEFFREY WILLIAM	3-B38-29
BM	BROWN CHARLES F & DONNA	3-B38-30
BN	HENSLEY JEFFREY	3-B38-26

*HIGHLIGHTED PARCELS MAY BE IMPACTED BY DRILLING ACTIVITY

ADJOINING OWNERS TABLE		
TRACT	SURFACE OWNER	TAX PARCEL
A	BETHANY COLLEGE	3-B38-31
B	FEDAK MARK A & GEORGIA M (SURV)	3-B38-14
C	SPORTSMAN & FARMERS ASSN	3-B38-15
D	HUKILL DALE C JR & DELVIRA	3-B33-85
E	HUKILL TAMARA J	3-B33-116
F	HUKILL TAMARA J	3-B33-115
G	HUKILL TAMARA J	3-B33-85.1
H	HUKILL TAMARA J	3-B33-83
I	FRANCIS JOHN R	3-B33-82.1
J	FRANCIS NADINE NKA; NADINE RICHARDS	3-B33-82
K	FRANCIS NADINE	3-B33-81
L	ADAMS RICHARD L & CINDY L	3-B33-80
M	CHILCOTE DIANA DARLENE	3-B33-79
N	BERTELLI CARRIE A	3-B33-77.4
O	YANO MICHAEL J & JENNIFER	3-B33-78
P	KOPKO KEVIN P & GERRI L (SURV)	3-B33-78.1
Q	KOPKO KEVIN P & GERRI L (SURV)	3-B33-43.1
R	PELAEZ DEBRA KAY	3-B33-71
S	PELUCLETTE FAMILY TRUST	3-B33-53
T	PELUCLETTE FAMILY TRUST	3-B33-52
U	DEGARMO CARL & SOPHIA SURV	3-B33-49
V	MCLAUGHLIN LAWRENCE II (L EST-GROVER LEE HAUGHT)	3-B33-48
W	WELLS GIST LAND CO. LLC	3-B33-47
X	WELLS GIST LAND CO., LLC	3-B33-46
Y	CROSS NICKOLAS J & AMY L (SURV)	3-B33-45
Z	SNODGRASS STEVEN	3-B33-44
AA	WELLS GIST LAND CO., LLC	3-B33-35
AB	STARVAGGI IND	3-B33-41
AC	DEGARMO PATRICK	3-B33-20
AD	SULLIVAN DONNA M	3-B33-22
AE	WELLS GIST LAND CO., LLC	3-B33-24
AF	GRAHAM PATRICIA	3-B28-43
AG	STARVAGGI IND	3-B33-25
AH	STARVAGGI INDUSTRIES INC	3-B33-26
AI	MERWICK STELLA	3-B33-27
AJ	EATON THEODORE EDWIN	3-B33-28
AK	STEWART JAMES H & PAMELA JO	3-B33-31
AL	CUNNINGHAM SHARON A	3-B33-32
AM	CUNNINGHAM SHARON A	3-B33-33.1
AN	KEARNS SHAWN	3-B33-33
AO	CUNNINGHAM SHARON	3-B33-30
AP	WELLS GIST LAND CO., LLC	3-B33-34
AQ	WELLS GIST LAND CO., LLC	3-B33-35
AR	STONE CHAPEL CHURCH	3-B33-36

04/26/2024

REVISIONS:	COMPANY: SWN Production Company, LLC		SWN ^{R-V+} Production Company™	
	OPERATOR'S: WORTHLEY BRK		DATE: 03-08-2024	
	WELL #: 5H		API NO: 47-009-XXXX	
	DISTRICT: BUFFALO	COUNTY: BROOKE	STATE: WV	DRAWN BY: Z. WOOD
				SCALE: N/A
				DRAWING NO: 2023-1649
				WELL LOCATION PLAT

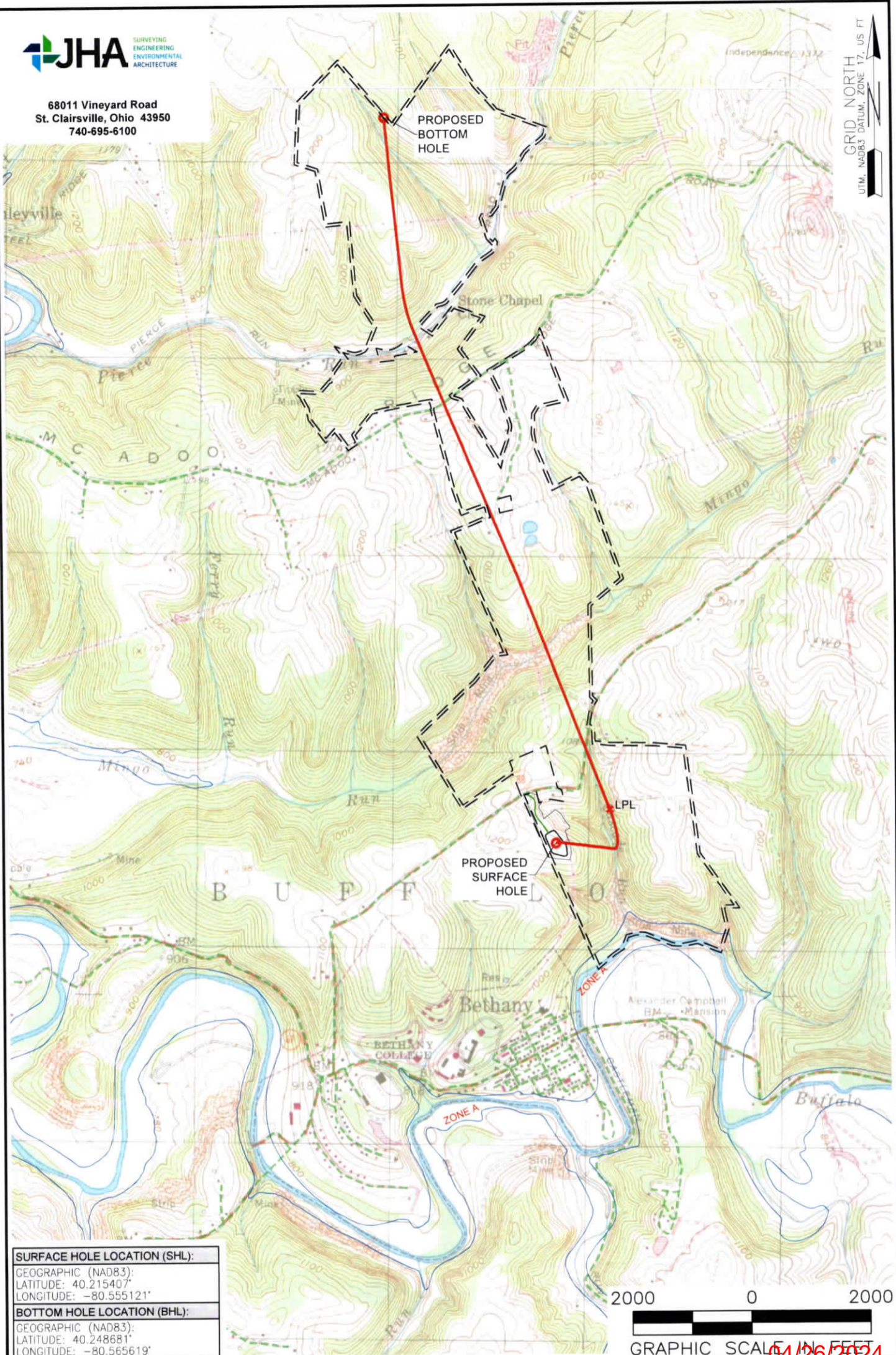

SURFACE HOLE LOCATION (SHL):
GEOGRAPHIC (NAD83):
LATITUDE: 40.215407°
LONGITUDE: -80.555121°
BOTTOM HOLE LOCATION (BHL):
GEOGRAPHIC (NAD83):
LATITUDE: 40.248681°
LONGITUDE: -80.565619°

NOTES ON SURVEY

1. SURFACE AND ROYALTY OWNER INFORMATION AND THEIR BOUNDARIES SHOWN HEREON WERE PLOTTED FROM DEEDS AND/OR TAX PARCEL MAPS PROVIDED BY CLIENT AND/OR FIELD LOCATIONS.
2. THIS PLAT DOES NOT REPRESENT A BOUNDARY SURVEY OF THE PARCELS SHOWN HEREON.
3. ALL INSETS ARE GRID NORTH UNLESS OTHERWISE DEPICTED.

LEGEND:	PROPOSED SURFACE HOLE / BOTTOM HOLE	NATURAL WATERWAY
EXISTING / PRODUCING WELLHEAD	ACCESS ROAD	PUBLIC ROAD
LANDING POINT LOCATION	ACCESS ROAD TO PREV. SITE	LEASE BOUNDARY
FLOOD PLAIN	PROPOSED PATH	

WELL OPERATOR: SWN PRODUCTION COMPANY, LLC	WELL (FARM) NAME: WORTHLEY BRK	WELL # 5H	SERIAL # XXXX
ADDRESS: 1300 FORT PIERPONT DRIVE, SUITE 201, MORGANTOWN, WV 26508	COUNTY: BROOKE	CODE: 009	DISTRICT: BUFFALO
SURFACE OWNER: KIMBERLY CARMAN WORTHLEY	USGS 7 1/2 QUADRANGLE MAP NAME: BETHANY; STEUBENVILLE EAST, WV		