



Latitude 40° 25'

Longitude 80° 35'

JAMES ARCHER

LESTER BATES

JOHN McKIM

WHEELING STEEL CORPORATION  
Formerly Cyrus Ferguson 823 Acs

WHEELING STEEL CORPORATION

J. J. WALKER

RIVER  
OHIO

STATE ROUTE NO. 2  
MAHANS RUN

ELDERSVILLE ROAD

Follansbee Corporation Line

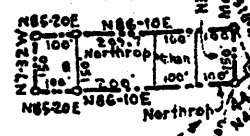

FARM NO.

Dwelling

School

+ 42A

5.1952  
6 LAW

Wheeling Steel # 35

20  
009-15A

(Faint handwritten notes and markings at the bottom of the page)

*M*

Cross Creek District, Brooke County, W. Va. *BRO-20A*  
By Wheeling Steel Corp., Wheeling, W. Va.  
On 585 acres, along State Highway No. 2 and Ohio River; surface and  
minerals owned by Wheeling Steel Corp., Wheeling, W. Va.  
Elevation, 653' L.  
12½" steel pipe, 60'; 10" casing, 200'; 8¼", 630'; 6⅝", 930'.  
Wall packer, 6⅝", at bottom of 6⅝" pipe.  
Casing not perforated. No liner used.  
Coal was encountered at 184½-88, and 224½-229½'.  
Abandonment reported to Dept. of Mines Sept. 25, 1936.  
No record of shot. No record of water.  
Oil well. Record to RCT from D.G. Courtney (Dept. of Mines) 5-5-37.

This well was drilled about thirty (30) years ago and no log or drilling record is available. The following information has been secured from sources, considered reliable:

Depth of hole is 1275 ft.; casing used as per data sheet No. 1; three oil sands penetrated; viz, Salt, Big Injun, and Berea. Oil is found in Berea. Salt Sand is about 50 ft. in thickness; Big Injun about 300 ft., and Berea averages 25 ft. Berea Sand light brown, soft, and friable - other sands are darker in color and harder.

Upper and Lower Freeport Coal measures are penetrated at depth points from surface of about 184 ft. and 224 ft., respectively. This coal is not being mined.

Field is pressured with air - 35# to 40# and producing wells are vacuum pumped with gauge registering about 25 in.

Cross Creek District, Brooke County, W. Va.  
By Wheeling Steel Corp., Wheeling, W. Va.  
On 585 acres, along State Highway No. 2 and Ohio River; surface and  
minerals owned by Wheeling Steel Corp., Wheeling, W. Va.  
Elevation, 653' L.  
12½" steel pipe, 60'; 10" casing, 200'; 8¼", 630'; 6⅝", 930'.  
Wall packer, 6⅝", at bottom of 6⅝" pipe.  
Casing not perforated. No liner used.  
Coal was encountered at 184½-88, and 224½-229½'.  
Abandonment reported to Dept. of Mines Sept. 25, 1936.  
No record of shot. No record of water.  
Oil well. Record to RCF from D.G. Courtney (Dept. of Mines) 5-5-37.

This well was drilled about thirty (30) years ago and no log or drilling record is available. The following information has been secured from sources, considered reliable:

Depth of hole is 1275 ft.; casing used as per data sheet No. 1; three oil sands penetrated; viz, Salt, Big Injun, and Berea. Oil is found in Berea. Salt Sand is about 50 ft. in thickness; Big Injun about 300 ft., and Berea averages 25 ft. Berea Sand light brown, soft, and friable - other sands are darker in color and harder.

Upper and Lower Freeport Coal measures are penetrated at depth points from surface of about 184 ft. and 224 ft., respectively. This coal is not being mined.

Field is pressured with air - 35# to 40# and producing wells are vacuum pumped with gauge registering about 25 in.