

40°25'00"

Latitude

80°32'30"

Longitude



**Topo Location**

7.5' Loc. \_\_\_\_\_ 15' Loc. \_\_\_\_\_  
 \_\_\_\_\_ (calc.) \_\_\_\_\_

Company D.F. Couch

Farm James McWha #7

15' Quad \_\_\_\_\_  
(sec.)

7.5' Quad Winton

District Cross Creek

**WELL LOCATION PLAT**

County 009 Permit 30028

W

Latitude 40° 30'

Longitude 80° 30'

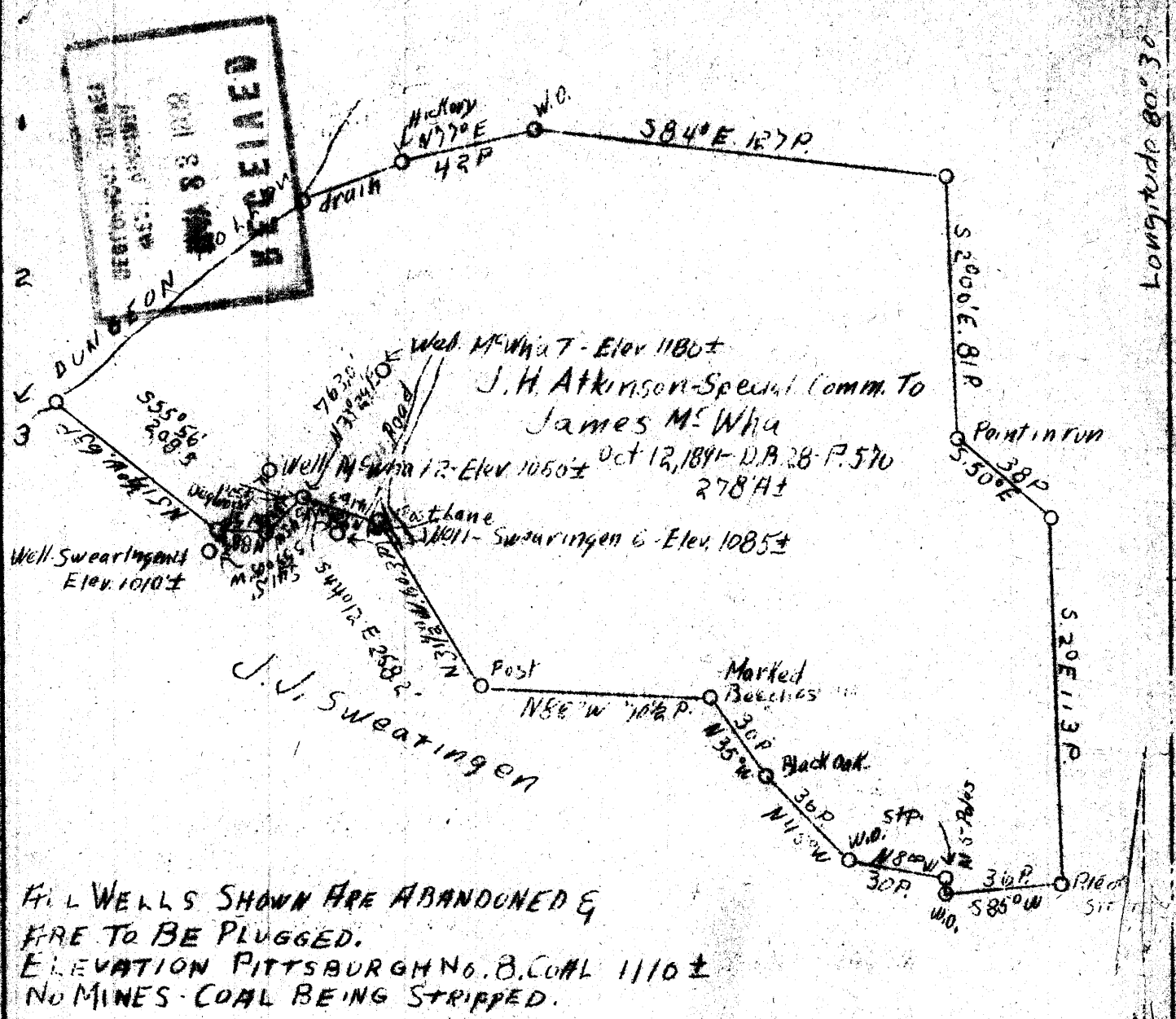

ALL WELLS SHOWN ARE ABANDONED &  
 FREE TO BE PLUGGED.  
 ELEVATION PITTSBURGH No. 8. COAL 1110±  
 NO MINES - COAL BEING STRIPPED.

+ WELL 7 - McWha

Company	D.G. Crouch
Address	No. 3 Pike St., Wheeling, W. Va.
Farm	James McWha, & J.J. Sweatingen
Tract	Acres Lease No.
Well (Farm) No.	4 86 SW, Serial No.
Quadrangle	Steubenville N.E.
County	Brooke
District	Cross Creek
Engineer	Walter W. Stogman
Engineer's Registration No.	394
File No.	O.W. Drawing No.
Date	May 9, 1938 Scale 1"=500'

STATE OF WEST VIRGINIA  
 Department of Mines  
 OIL AND GAS DIVISION  
 CHARLESTON

WELL LOCATION MAP

File No. Bro-28-29-30-31-A

Denotes location of well on United States Topographic Maps, scale 1 to 62,500, latitude and longitude lines being represented by border lines as shown.

Denotes one inch spaces on border line of original tracing.

X  
 Cross Creek District, Brooke County, W. Va.  
 South Penn Oil Co.  
 Hollidays Cove Field.

WELL NO.	TOP OF BEREA.	BOTTOM OF BEREA.
1	.....	.....
2	1506	1522
3	1519	1538
4	1517	1535
5	1539	1556
6	1533	1548
7	1503	1518
8	1599	1615
9	1591	1605
10	1442	1456
11	1475	1502
12	1635	1650
13	1627	1642
14	1527	1542