

Latitude 38° 30'

Longitude 82° 15'

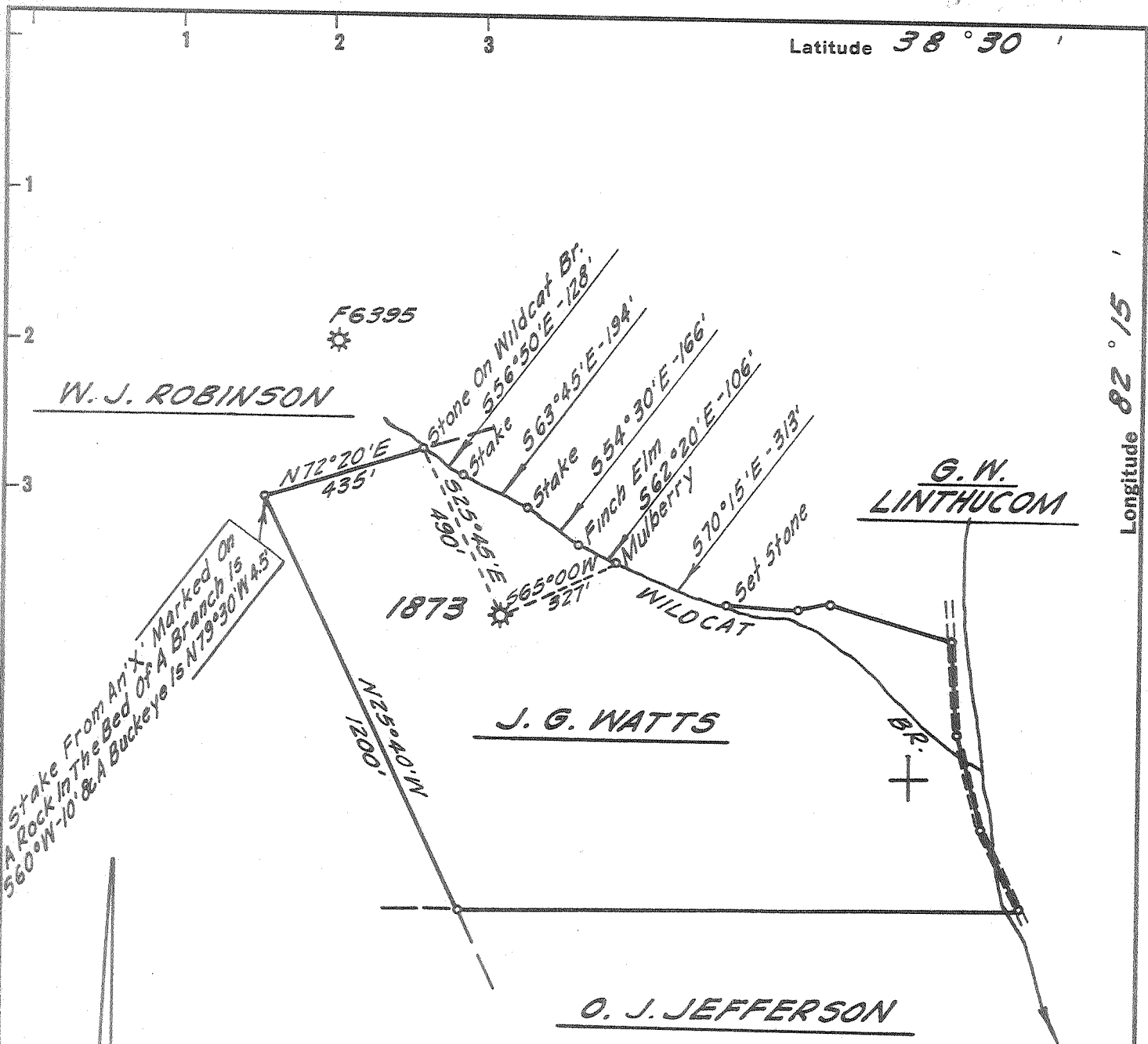

**BENCH MARK DESCRIPTION**  
 Plate On West Edge Of South Abutment Of The  
 C. & O. R. R. Bridge Across W. Va. U.S. Route No. 60 &  
 Mud River. Elev. 572.00'

**DEGREE OF ACCURACY**  
 One Part In 200

I, the undersigned, hereby certify that this map is correct to the best of my knowledge and belief and shows all the information required by Paragraph 6 of the rules and regulations of the oil and gas section of the department of West Virginia.

*Seibert R. Jewell*

- New Location
- Drill Deeper
- Abandonment

Company UNITED FUEL GAS CO.  
 Address CHARLESTON, W. VA.  
 Farm J. G. WATTS  
 Tract \_\_\_\_\_ Acres 34 Lease No. 20949  
 Well (Farm) No. \_\_\_\_\_ Serial No. 1873  
 Elevation (Spirit Level) 686.33'  
 Quadrangle GUYANDOT - NE  
 County CABELL District BARBOURSVILLE E  
 Engineer Seibert R. Jewell  
 Engineer's Registration No. 2529  
 File No. 26-63 Drawing No. \_\_\_\_\_  
 Date SEPT. 21, '65 Scale 1" = 400'

STATE OF WEST VIRGINIA  
 DEPARTMENT OF MINES  
 OIL AND GAS DIVISION  
 CHARLESTON

WELL LOCATION MAP  
 FILE NO. CAB-106-A

- + Denotes location of well on United States Topographic Maps, scale 1 to 62,500, latitude and longitude lines being represented by border lines as shown.
- Denotes one inch spaces on border line of original tracing.