

Latitude 39° 00'

Longitude 81° 00'

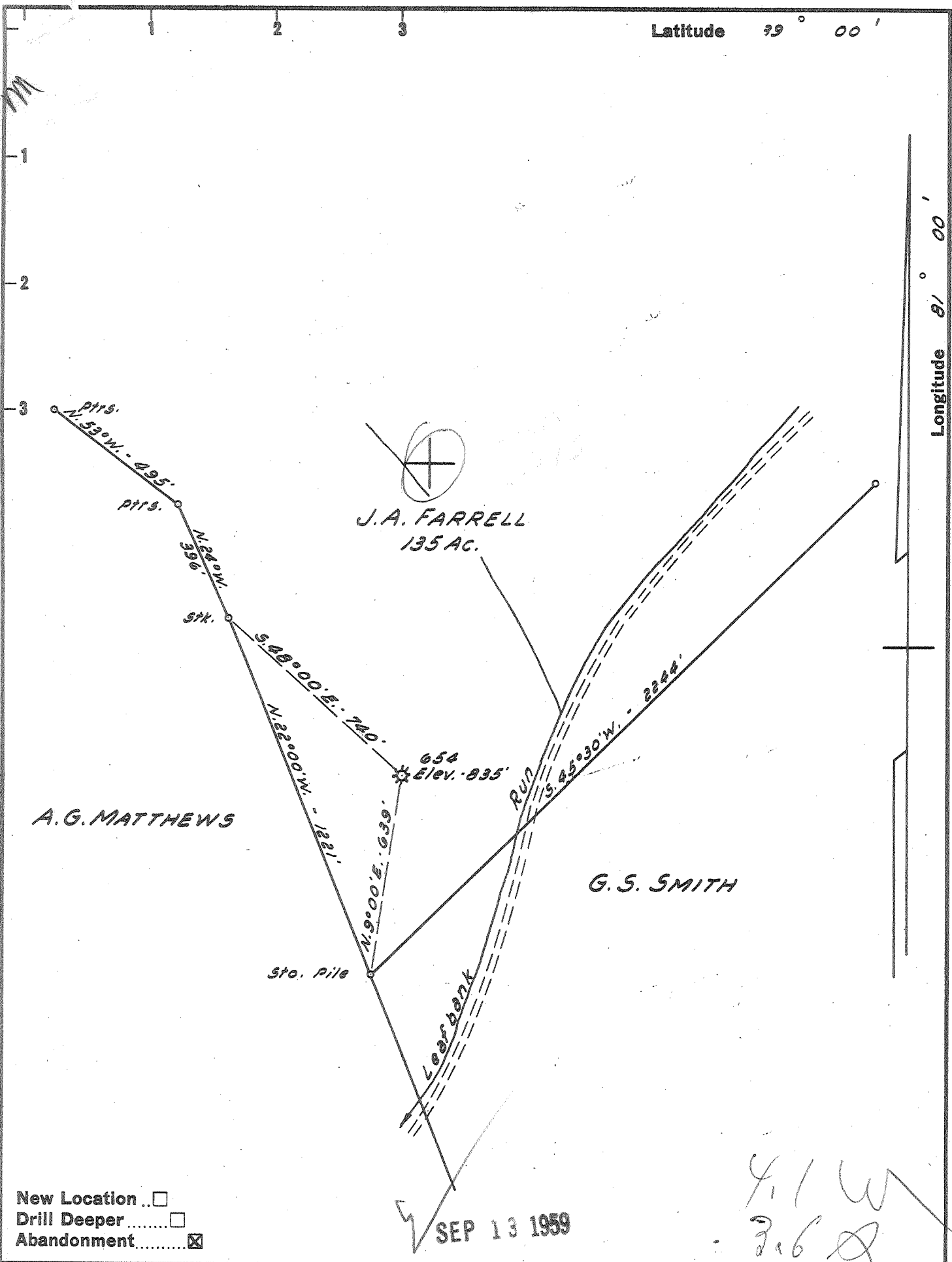

New Location   
 Drill Deeper   
 Abandonment

Company	SOUTHEASTERN GAS CO.		
Address	UNION BLDG. CHARLESTON, W. VA.		
Farm	J.A. FERRELL		
Tract	Acres 135	Lease No.	2256
Well (Farm) No.	2	Serial No.	654
Elevation (Spirit Level)	835'		
Quadrangle	ARNOLDSBURG		
County	CALHOUN	District	CENTER
Engineer	JOHN W. HAMILTON		
Engineer's Registration No.	2274		
File No.	Drawing No.		
Date	8-20-59	Scale	1" = 400'

STATE OF WEST VIRGINIA  
 DEPARTMENT OF MINES  
 OIL AND GAS DIVISION  
 CHARLESTON

WELL LOCATION MAP

FILE NO. CAL-367-A

+ Denotes location of well on United States Topographic Maps, scale 1 to 62,500, latitude and longitude lines being represented by border lines as shown.

- Denotes one inch spaces on border line of original tracing.

J.A. FERRELL No. 2 (654) - SOUTHEASTERN GAS CO. - CAL-367-A



WELL NO. 654  
LEASE NO. 2256

278

STATE OF WEST VIRGINIA  
DEPARTMENT OF MINES  
OIL AND GAS DIVISION

Quadrangle Amoldshing  
Permit No. 367-A

WELL RECORD

Oil or Gas Well Gas  
(KIND)

Company Southeastern Gas Company  
Address Box 2317, Charleston, West Virginia  
Farm James A. Ferrell Acres 135  
Location (waters) Leaf Bank  
Well No. 654 Elev. 835  
District Center County Calhoun  
The surface of tract is owned in fee by \_\_\_\_\_  
Address \_\_\_\_\_  
Mineral rights are owned by Godfrey L. Cabot  
Box 1473, Address Charleston, W. Va.  
Drilling commenced \_\_\_\_\_  
Drilling completed \_\_\_\_\_  
Date Shot \_\_\_\_\_ From \_\_\_\_\_ To \_\_\_\_\_  
With \_\_\_\_\_  
Open Flow \_\_\_\_\_ /10ths Water in \_\_\_\_\_ Inch  
\_\_\_\_\_ /10ths Merc. in \_\_\_\_\_ Inch  
Volume \_\_\_\_\_ Cu. Ft.  
Rock Pressure \_\_\_\_\_ lbs. \_\_\_\_\_ hrs.  
Oil \_\_\_\_\_ bbls., 1st 24 hrs.  
WELL ACIDIZED \_\_\_\_\_  
WELL FRACTURED \_\_\_\_\_

Casing and Tubing	Used in Drilling	Left in Well	Packers
Size			Kind of Packer
16			
13			
10			Size of
8 3/4			
6 3/8	1710'	1710'	Depth set 1725'
5 3/16			
3	1770'		Perf. top
2	1880'	1880'	Perf. bottom
Liners Used			Perf. top
			Perf. bottom

CASING CEMENTED \_\_\_\_\_ SIZE \_\_\_\_\_ No. Ft. \_\_\_\_\_ Date \_\_\_\_\_  
COAL WAS ENCOUNTERED AT \_\_\_\_\_ FEET \_\_\_\_\_ INCHES  
\_\_\_\_\_ FEET \_\_\_\_\_ INCHES FEET \_\_\_\_\_ INCHES  
\_\_\_\_\_ FEET \_\_\_\_\_ INCHES FEET \_\_\_\_\_ INCHES

RESULT AFTER TREATMENT \_\_\_\_\_

ROCK PRESSURE AFTER TREATMENT \_\_\_\_\_

Fresh Water \_\_\_\_\_ Feet Salt Water \_\_\_\_\_ Feet

Formation	Color	Hard or Soft	Top	Bottom	Oil, Gas or Water	Depth	Remarks
Surface			0	12			
Not Logged			12	789			
Little Dunkard			789	889			
Big Dunkard			889	-			
Maxton Sand			1580	1610			
Little Lime			1686	1696			
Pencil Cave			1696	1708			
Big Lime			1708	1801			
Keener			1801	1810			
Big Injun			1810	1880			
Total Depth				1880			

NO LOG OF THIS WELL; USED LOG OF WELL NEAR (NO. 653).

MAR 26 1960

