

5900

LATITUDE 38° 55'

LONGITUDE 81° 00'

23,200'

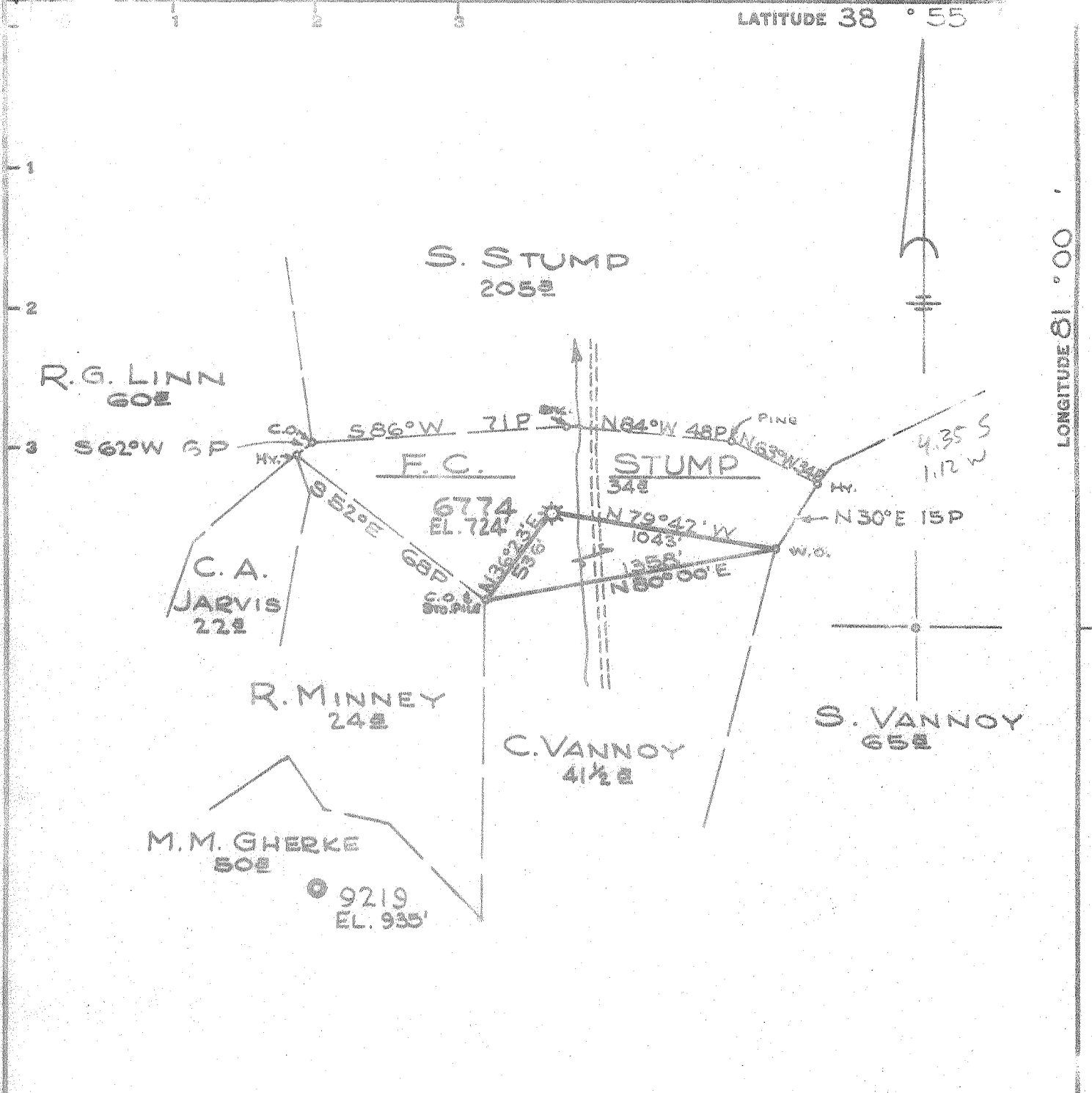

Minimum Error of Closure 1' IN 200'

Source of Elevation LEVELS FROM ROAD FORKS - MOUTH OF WOLEE RUN TO CONSOLIDATED GAS SUPPLY CORP. WELL 6774 - EL. 691'

"I, the undersigned, hereby certify that this map is correct to the best of my knowledge and belief and shows all the information required by paragraph 8 of the rules and regulations of the oil and gas section of the mining laws of West Virginia."

New Location.....
 Drill Deeper.....
 Abandonment.....

MAP SHEET 96 S41-W24 FB. 1405 Pg. 38-40

Company CONSOLIDATED GAS SUPPLY CORP.
 Address CLARKSBURG, W.VA.
 Farm F.C. STUMP
 Tract _____ Acres 34± Lease No. 28803
 Well (Farm) No. _____ Serial No. 6774
 Elevation (Spirit Level) 724'
 Quadrangle ARNOLDSBURG F.C.
 County CALHOUN District CENTER
 Engineer Jackson M. Jarvis
 Engineer's Registration No. 2397
 File No. _____ Drawing No. _____
 Date DEC. 8, 1966 Scale 1" = 40 P

STATE OF WEST VIRGINIA
 DEPARTMENT OF MINES
 OIL AND GAS DIVISION
 CHARLESTON

WELL LOCATION MAP
 FILE NO. CAL-391-A

+ Denotes location of well on United States Topographic Maps, scale 1 to 62,500, latitude and longitude lines being represented by border lines as shown.

- Denotes one inch spaces on border line of original tracing.

STATE OF WEST VIRGINIA
DEPARTMENT OF MINES
OIL AND GAS DIVISION

AFFIDAVIT OF PLUGGING AND FILLING WELL

AFFIDAVIT SHOULD BE MADE IN TRIPPLICATE. ONE COPY MAILED TO THE DEPARTMENT, ONE COPY TO BE RETAINED BY THE WELL OPERATOR AND THE THIRD COPY (AND EXTRA COPIES IF REQUIRED) SHOULD BE MAILED TO EACH COAL OPERATOR AT THEIR RESPECTIVE ADDRESSES.

Coal Operator or Owner	Consolidated Gas Supply Corporation
ADDRESS	Clarksburg, W. Va.
Coal Operator or Owner	NAME OF WELL OPERATOR
ADDRESS	COMPLETE ADDRESS
Coal Operator or Owner	WELL AND LOCATION
ADDRESS	District
Coal Operator or Owner	County
ADDRESS	Well No. 6771
Coal Operator or Owner	Farm
ADDRESS	Harry Holliday

STATE INSPECTOR SUPERVISING PLUGGING Harry Holliday

AFFIDAVIT

STATE OF WEST VIRGINIA,

County of CALHOUN

ss:

Dallas Stump

and Emanuel Hersman

being first duly sworn according to law depose and say that they are experienced in the work of plugging and filling oil and gas wells and were employed by C.R. Morris, Contractor, well operator, and participated in the work of plugging and filling the above well, that said work was commenced on the 27th day of June, 1967, and that the well was plugged and filled in the following manner:

SAND OR ZONE RECORD	FILLING MATERIAL	PLUGS USED	CASING	
			CSG PULLED	CSG LEFT IN
FORMATION		SIZE & KIND		
- Pulled 2" Tubing, removed packer			1830	-0-
- Ran 2" Tubing back, circulated & gelled hole				
- Pulled 5" Casing			1661	-0-
- Ran cement plug at 1692'		10'-Cement		
- Ran cement plug at 1606'		10'-Cement		
- Ran cement plug at 1345'		10'-Cement		
- Tried to pull 7" Casing, could not pull				
- Ran cement plug at 925'		10'-Cement		
- Ripped 7" Casing at 560', pulled 7"			560	427
- Ran cement plug at 560'		10'-Cement		
- Bridged hole at 125', ran cement plug		10'-Cement		
- Filled to 10' with clay				
- Erected marker				
COAL BEAMS	DESCRIPTION OF MONUMENT			
(NAME)	7" pipe extending from 10' below surface to 30" above,			
(NAME)	with nameplate marked "#6771",			
(NAME)	cemented inside & out to surface			
(NAME)				

and that the work of plugging and filling said well was completed on the 7th day of July, 1967.

And further deponents saith not.

Sworn to and subscribed before me this 10th day of July, 1967.

My commission expires:

February 1, 1967

Dallas Stump
Emanuel Hersman

Charles D. ...
Notary Public.

Permit No. CAL-391-P

