

1500389P

WW-7
8-30-06



West Virginia Department of Environmental Protection
Office of Oil and Gas
WELL LOCATION FORM: GPS

API: 47-015-00389 WELL NO.: ERC&L 7976

FARM NAME: Elk River Coal

RESPONSIBLE PARTY NAME: Range Resources – Pine Mountain, Inc.

COUNTY: Clay, DISTRICT: Buffalo

QUADRANGLE: Swandale 7.5'

SURFACE OWNER: Allegheny Rural NMTC Forestlands, LLC

ROYALTY OWNER: Range Resources – Pine Mountain, Inc.

UTM GPS NORTHING: 4257570

UTM GPS EASTING: 503230 GPS ELEVATION: 262 m (860 ft)

The Responsible Party named above has chosen to submit GPS coordinates in lieu of preparing a new well location plat for a plugging permit or assigned API number on the above well. The Office of Oil and Gas will not accept GPS coordinates that do not meet the following requirements:

- Datum: NAD 1983, Zone: 17 North, Coordinate Units: meters, Altitude: height above mean sea level (MSL) – meters.
- Accuracy to Datum – 3.05 meters
- Data Collection Method:
Survey grade GPS : Post Processed Differential
Real-Time Differential
Mapping Grade GPS : Post Processed Differential
Real-Time Differential

Received
Office of Oil & Gas

OCT 31 2014

4. Letter size copy of the topography map showing the well location.

I the undersigned, hereby certify this data is correct to the best of my knowledge and belief and shows all the information required by law and the regulations issued and prescribed by the Office of Oil and Gas.

Signature

PS# 2180
Title

7/16/14
Date

1500389P

Topo Quad: Swandale 7.5'

Scale: 1" = 2000'

County: Clay

Date: June 26, 2014

District: Buffalo

Project No: 170-04-B-14

API # 47-015-00389 (ERC&L 7976)

Topo

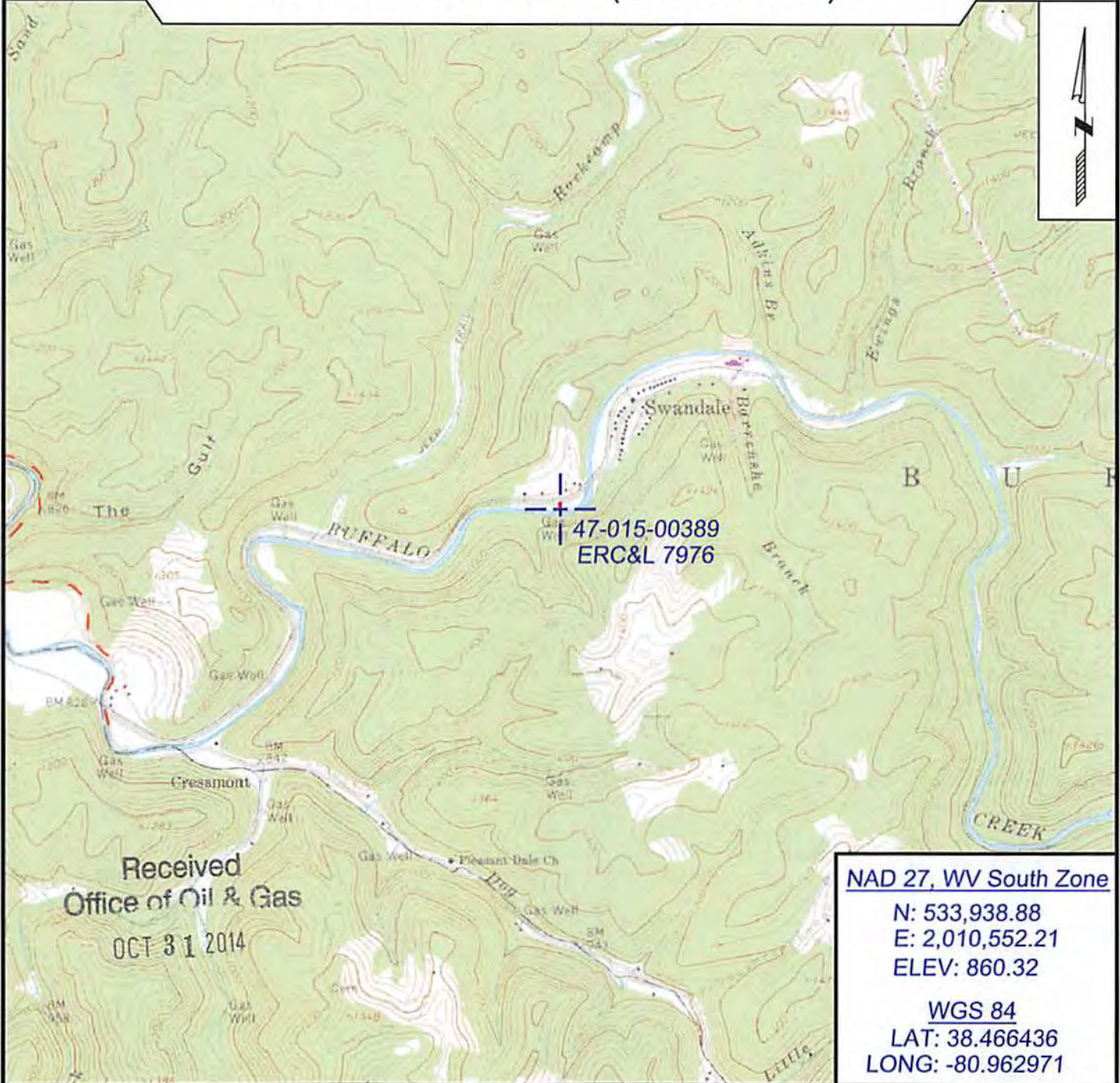

SURVEYING AND MAPPING SERVICES PERFORMED BY:
ALLEGHENY SURVEYS, INC.
 1-800-482-8606
 237 Birch River Road
 Birch River, WV 26610
 PH: (304) 649-8606
 FAX: (304) 649-8608

PREPARED FOR:
Range Resources - Pine Mountain, Inc.
 406 West Main Street
 Abingdon, VA 24210