



Revised

West Virginia Department of Environmental Protection
Office of Oil and Gas
WELL LOCATION FORM: GPS

API: 47-015-02312 WELL NO.: Elk River Coal & Lumber 42

FARM NAME: _____

RESPONSIBLE PARTY NAME: Range Resources-Pine Mountain, Inc.

COUNTY: Clay DISTRICT: Henry

QUADRANGLE: Swandale 7.5'

SURFACE OWNER: Allegheny Rural NMTC Forestlands, LLC

ROYALTY OWNER: Range Resources-Pine Mountain, Inc.

UTM GPS NORTHING: 4250.840

UTM GPS EASTING: 504.290 GPS ELEVATION: 473 m (1552 ft)

The Responsible Party named above has chosen to submit GPS coordinates in lieu of preparing a new well location plat for a plugging permit or assigned API number on the above well. The Office of Oil and Gas will not accept GPS coordinates that do not meet the following requirements:

1. Datum: NAD 1983, Zone: 17 North, Coordinate Units: meters, Altitude: height above mean sea level (MSL) - meters.
2. Accuracy to Datum - 3.05 meters
3. Data Collection Method:
Survey grade GPS _____ : Post Processed Differential _____
Real-Time Differential _____
Mapping Grade GPS X : Post Processed Differential X
Real-Time Differential _____

4. Letter size copy of the topography map showing the well location.

I the undersigned, hereby certify this data is correct to the best of my knowledge and belief and shows all the information required by law and the regulations issued and prescribed by the Office of Oil and Gas.

Ben A. Saylor
Signature

P.S. 2092
Title

12-7-11
Date

Topo Quad: Swandale 7.5'

Scale: 1" = 2000'

County: Clay

Date: June 29, 2011

District: Henry

Project No: 137-04-B-11

47-015-02312 (Elk River Coal & Lumber 42)

Topo

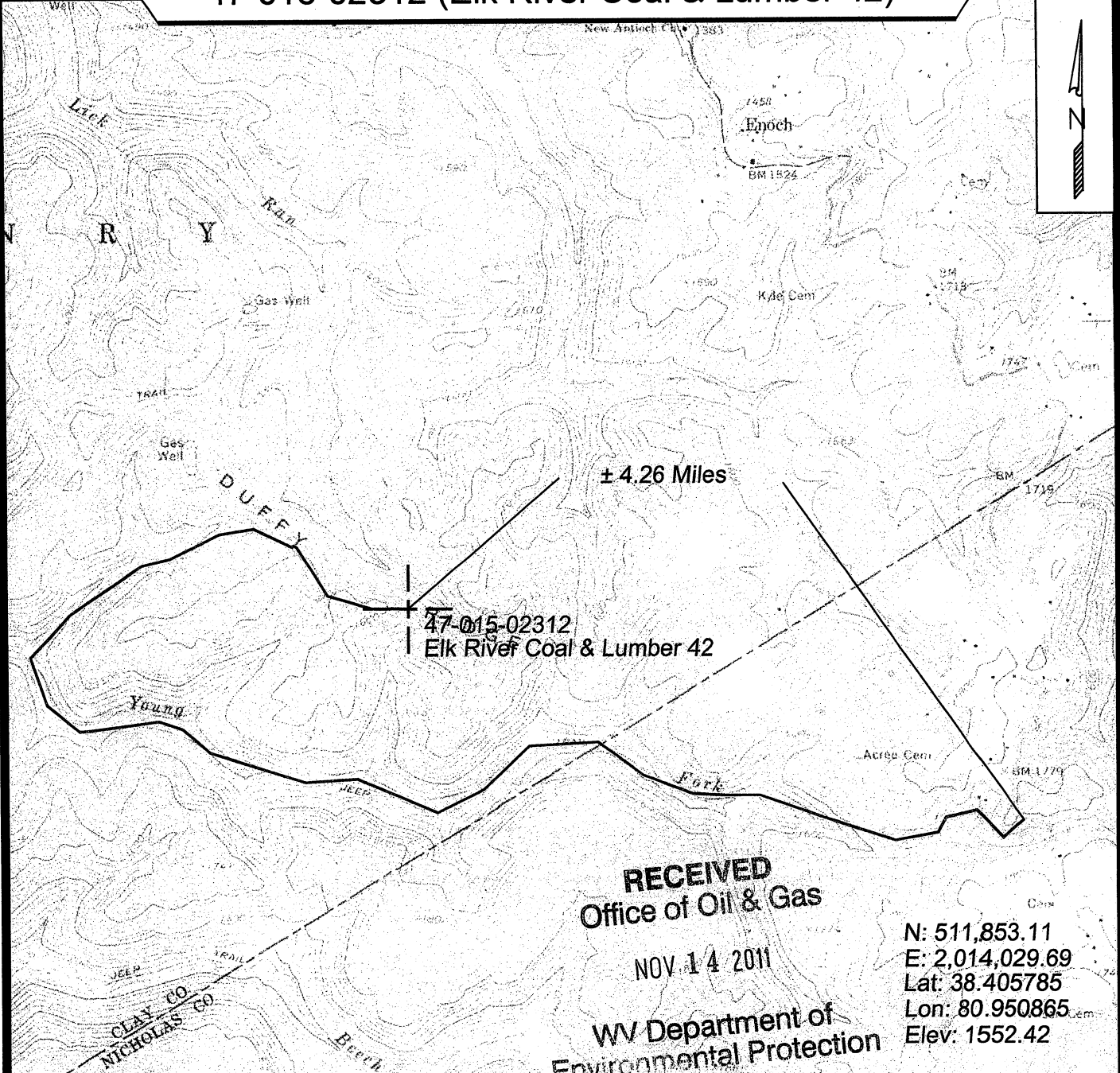

SURVEYING AND MAPPING SERVICES PERFORMED BY:
ALLEGHENY SURVEYS, INC.
 1-800-482-8606
 P.O. BOX 438
 BIRCH RIVER, WV 26610
 PH: (304) 649-8606
 FAX: (304) 649-8608

PREPARED FOR:
Range Resources-Pine Mountain, Inc.
 P.O. Box 2136
 Abingdon, VA 24212