

Notes:
 Well site coordinates are
 N: 519,223
 E: 2,007,813
 West Virginia
 Coordinate System of 1927, South Zone
 based upon
 Differential GPS Measurements.
 Plat orientation and corner and well
 references are based upon the grid
 north meridian.
 Well location references are based upon
 the magnetic meridian.

- Legend**
- Gas well existing or proposed
 - ⊕ CBM gas well existing or proposed
 - Found corner, as noted
 - Surface boundary (approximate)
- (⊕) Denotes location of well on United States topographic maps

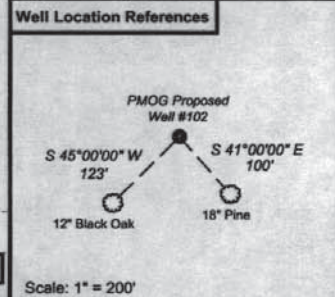

I, the undersigned, hereby certify that this plat is correct to the best of my knowledge and belief and shows all the information required by law and the regulations issued and prescribed by the Department of Mines.

Ben R. Singleton
 P.S. 2092



FILE NO: 02-04-B-07
 DRAWING NO: 0204B07 PMOG102.dwg
 SCALE: 1" = 2000'
 MINIMUM DEGREE OF ACCURACY: 1:2500
 PROVEN SOURCE OF ELEVATION: NGS HARN DEP Base Station Kanawha City

STATE OF WEST VIRGINIA
 DEPARTMENT OF MINES
 OIL AND GAS DIVISION

DATE: January 26 20 07
 OPERATOR'S WELL NO. PMOG #102
 API WELL NO: _____
 47 - 015 - 02793
 STATE COUNTY PERMIT

WELL TYPE: OIL GAS LIQUID INJECTION WASTE DISPOSAL CANCELLED
 (IF GAS) PRODUCTION: STORAGE DEEP SHALLOW
 LOCATION: ELEVATION: 1435' WATERSHED Lick Run of Hickory Fork of Wallowhole Fork of Buffalo Creek
 QUADRANGLE: Swandale DISTRICT: Henry COUNTY: Clay
 SURFACE OWNER: Paul B. Barringer II, et al. ACREAGE: 28,456.57 Ac.
 OIL AND GAS ROYALTY OWNER: Pine Mountain Oil and Gas LEASE NO: _____ ACREAGE: 28,456.57 Ac.
 PROPOSED WORK: DRILL CONVERT DRILL DEEPER FRACTURE OR STIMULATE PLUG OFF OLD FORMATION
 PERFORATE NEW FORMATION OTHER PHYSICAL CHANGE IN WELL (SPECIFY) _____
 PLUG AND ABANDON CLEAN OUT AND REPLUG TARGET FORMATION: Big Lime ESTIMATED DEPTH: 2450'
 WELL OPERATOR: Pine Mountain Oil and Gas DESIGNATED AGENT: Thomas H. Young
 ADDRESS: P.O. Box 2136 ADDRESS: 529 Poca Road
 Abingdon, VA 24212 Looneyville, WV 25259