

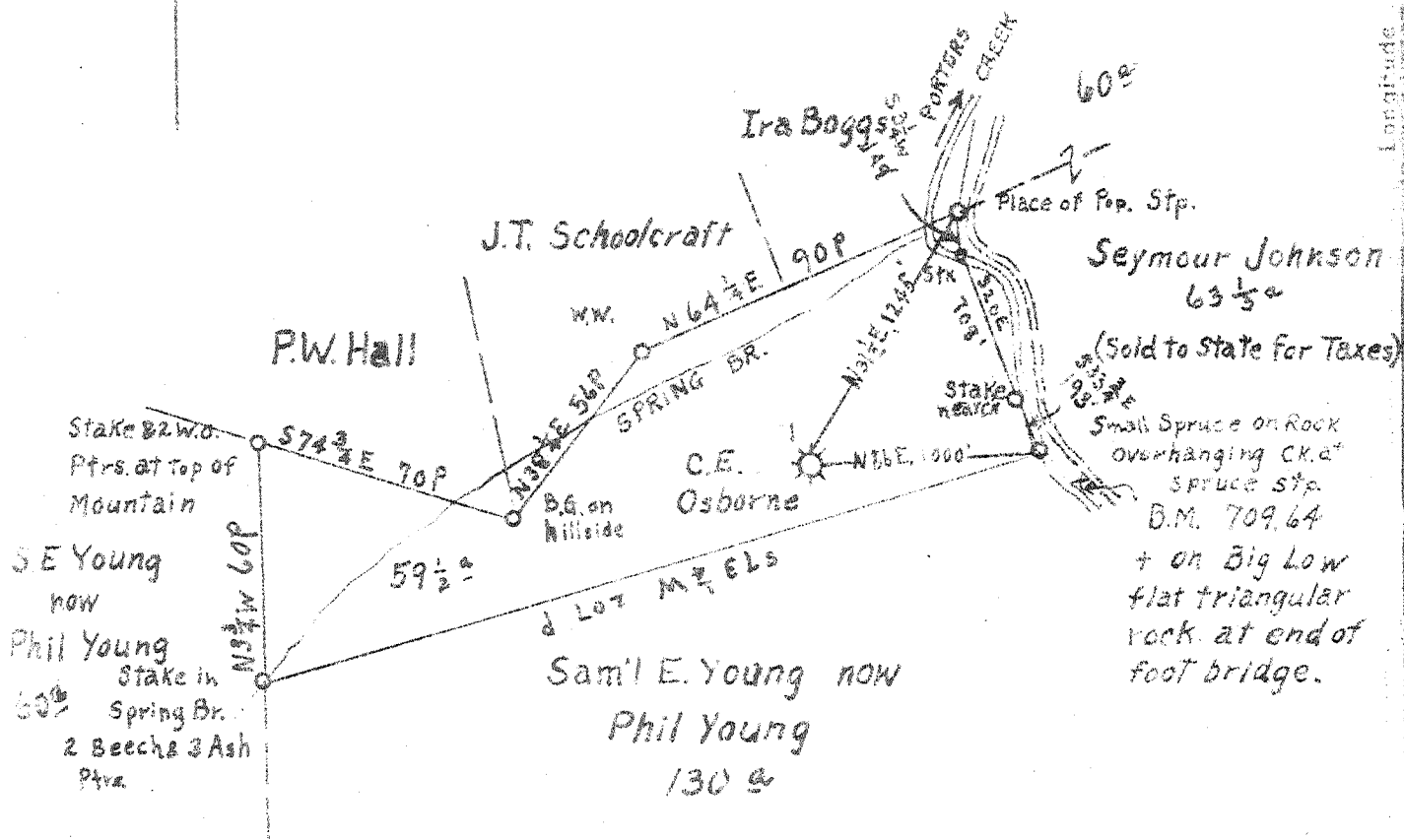

2.09
2.50
+



COAL & SURFACE OWNED BY:
C. E. OSBORNE
CLENDENIN, W. VA.

Abund.
11-6-44
ack

View Location
Soil Deeper
Conditionment

MAP 92 Sqs. S67 W37

Company EMPIRE PETROLEUM CO.
 Address PARKERSBURG, W.VA.
 From C.E. OSBORNE
 Sect. Acres 59 Lease No. 5
 Well (Farm) No. 1 Serial No. _____
 Elevation (Spirit Level) 1158
 Quadrangle CLAY NW
 County CLAY District UNION
 Engineer E.C. TABLER
 Engineer's Registration No. _____
 File No. _____ Drawing No. _____
 Date 8-24-44 Scale 1" = 800'

STATE OF WEST VIRGINIA
 DEPARTMENT OF MINES
 OIL AND GAS DIVISION
 CHARLESTON
WELL LOCATION MAP
 FILE NO. CLA-32-4

+ Denotes location of well on United States Topographic Maps, scale 1 to 62,500, latitude and longitude lines being represented by border lines as shown.
 - Denotes one inch spaces on border line of original tracing



STATE OF WEST VIRGINIA
DEPARTMENT OF MINES
OIL AND GAS DIVISION

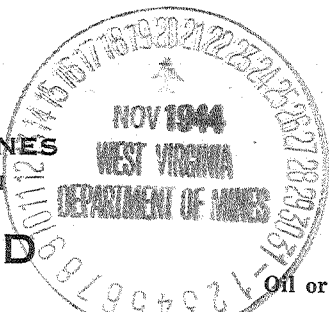

266

Permit No. 321A

WELL RECORD

Oil or Gas Well GAS
(KIND)

Company Empire Petroleum Company
 Address Union Trust Bldg. Parkersburg, W. Va.
 Farm C. E. Osborne Acres 59
 Location (waters) Porters Creek
 Well No. 1 Elev. 1158.
 District Union County Clay
 The surface of tract is owned in fee by C. E. Osborne
 Address Clendenin, W. Va.
 Mineral rights are owned by C. E. Osborne,
 Address Clendenin, W. Va.
 Drilling commenced Feb. 5, 1926
 Drilling completed April 9, 1926
 Date Shot -- From -- To --
 With _____
 Open Flow 14 /10ths Water in _____ Inch
2 /10ths Merc. in _____ Inch
 Volume _____ 582 M Cu. Ft.
 Rock Pressure _____ lbs. _____ hrs.
 Oil _____ bbls., 1st 24 hrs.
 Fresh water _____ feet _____ feet
 Salt water 1210 feet _____ feet

Casing and Tubing	Used in Drilling	Left in Well	Packers
Size			
16			Kind of Packer -
13			-
10	<u>14</u>		Size of -
8 1/4	<u>450' (Pulled)</u>		-
6 5/8	<u>1751'</u>		Depth set <u>1822'</u>
5 3/16			-
3			Perf. top -
2			Perf. bottom -
Liners Used			Perf. top -
			Perf. bottom -

CASING CEMENTED - SIZE - No. Ft. - Date

COAL WAS ENCOUNTERED AT 475 FEET 60 INCHES
525 FEET 60 INCHES - FEET - INCHES
 - FEET - INCHES - FEET - INCHES

Formation	Color	Hard or Soft	Top	Bottom	Oil, Gas or Water	Depth Found	Remarks
Soil			0	3			
Sand			3	200			
Slate			200	260			
Sand			260	275			
Slate			275	300			
Sand			300	475			
Coal			475	480			
Slate			480	500			
Sand			500	525			
Coal			525	530			
Slate			530	540			
Sand			540	570			
Slate			570	605			
Sand Shells			605	695			
Slate			695	705			
Sand			705	750			
Slate			750	765			
Sand			765	810			
Slate			810	930			
Sand			930	960			
Slate			960	965			
Sand			965	1062			
Slate			1062	1065	Show Gas	970	
Sand			1065	1105			
Slate			1105	1130	Water	1070	To drill with
Salt Sand			1130	1535			
Slate			1535	1540	Water	1210	Hole full
Red Rock			1540	1565			
Slate			1565	1635			
Maxon Sand			1635	1690			
Little Lime			1690	1718			

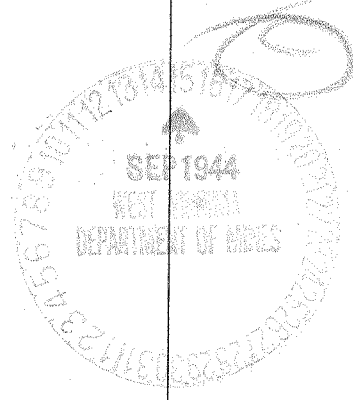

Formation	Color	Hard or Soft	Top	Bottom	Oil, Gas or Water	Depth Found	Remarks
Cont'd.							
First Pencil Cave			1718	1731			
Gritty Lime			1731	1742			
Pencil Cave			1742	1747			
Big Lime			1747	1850			
Keener Sand			1850	1885	Show Gas	1760	
					Show Gas	1860	
					Gas	1879	12/10M 2"
					Gas	1885	12/10M 2"
Big Injun							
Slate			1885	1899			
Big Injun			1899	1935			
					Gas	1935	14/10M 2"
Red Rock & Slate			1935	1950			
Gray Slate			1950	1995			
Dark Slate & Shells			1995	2026			
Total Depth				2026			

Date Sept. 12, 1944., 194

APPROVED EMPIRE PETROLEUM COMPANY, Owner

By Eaton E. Young Land Agent.
(Title)