

Latitude 38° 30'

Longitude 81° 15'

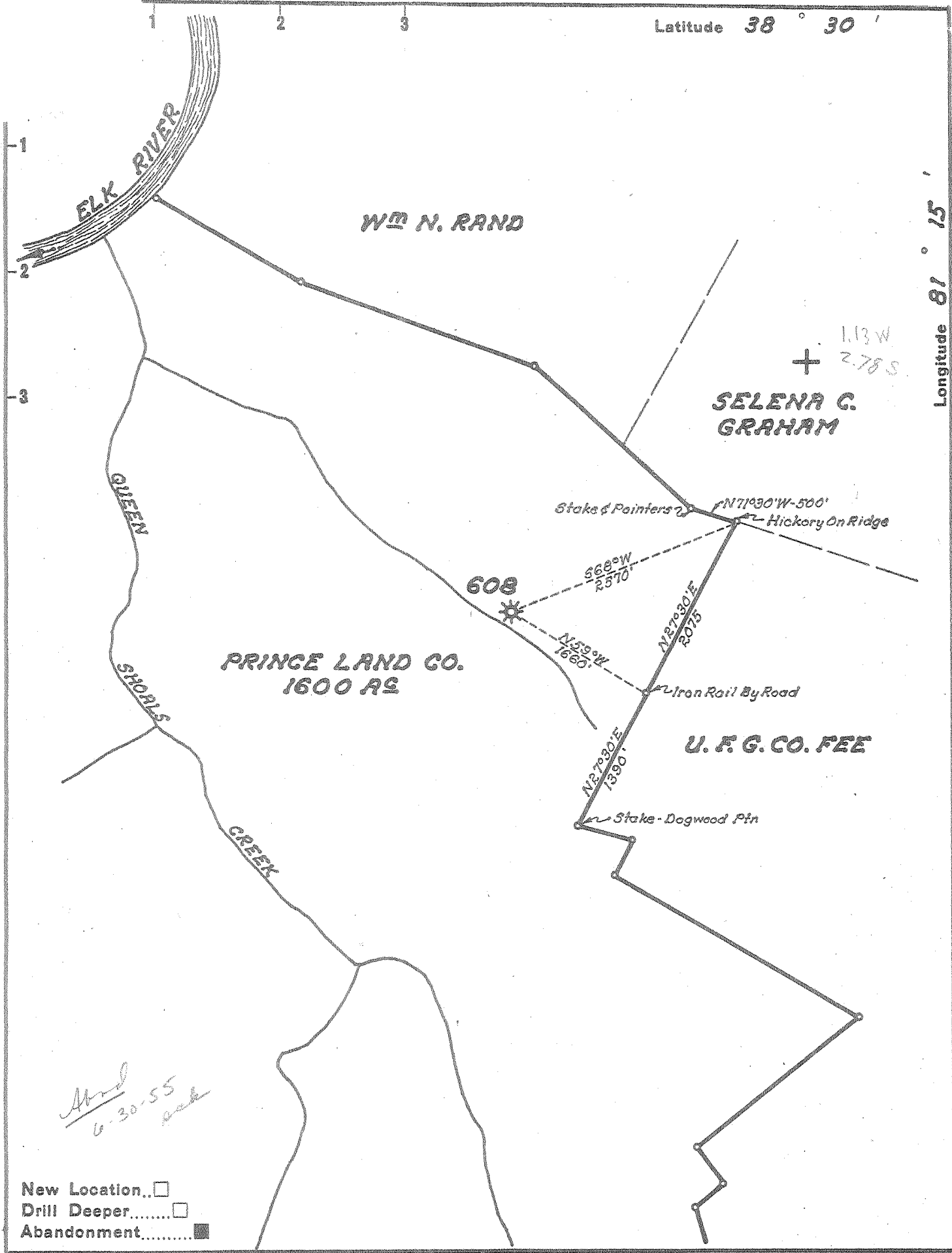

Handwritten note:
 6-30-55
 [unclear]

New Location...
 Drill Deeper.....
 Abandonment.....

Company	<u>UNITED FUEL GAS CO.</u>
Address	<u>CHARLESTON, W. VA.</u>
Farm	<u>PRINCE LAND CO.</u>
Tract	Acres <u>1600</u> Lease No. <u>4591</u>
Well (Farm) No.	Serial No. <u>608</u>
Elevation (Spirit Level)	<u>888.6</u>
Quadrangle	<u>CLENDENIN</u>
County	<u>CLAY</u> District <u>UNION</u>
Engineer	<u>Paul E. Badolante</u>
Engineer's Registration No.	<u>669</u>
File No.	<u>80-65</u> Drawing No. _____
Date	<u>3-4-55</u> Scale <u>1"=1320'</u>

STATE OF WEST VIRGINIA
 DEPARTMENT OF MINES
 OIL AND GAS DIVISION
 CHARLESTON

WELL LOCATION MAP
 FILE NO. CLAY-86-A

+ Denotes location of well on United States Topographic Maps, scale 1 to 62,500, latitude and longitude lines being represented by border lines as shown.

- Denotes one inch spaces on border line of original tracing.

Handwritten note:
 66 (1320')



STATE OF WEST VIRGINIA
DEPARTMENT OF MINES
OIL AND GAS DIVISION

339

Quadrangle Clendenin
Permit No. 86-A

WELL RECORD

Oil or Gas Well Gas
(KIND)

Company UNITED FUEL GAS COMPANY
Address P.O. Box 1273, Charleston 25, W. Va.
Farm Prince Land Co. Acres 1600
Location (waters) Queen Shoals Creek
Well No. 608 Elev. 888.6'
District Union County Clay
The surface of tract is owned in fee by _____
Address _____
Mineral rights are owned by Estate of J. A. Holley, et al
% Charleston Nat. Bank Address Charleston, W. Va.
Drilling commenced 3-12-14
Drilling completed 5-5-14
Date Shot _____ From _____ To _____
With _____

Casing and Tubing	Used in Drilling	Left in Well	Packers
Size			
16		16'	Kind of Packer
18			<u>Larkin</u>
10			Size of
8 1/4		579'	<u>2x6-5/8x16</u>
6 5/8		1440'	Depth set
5 3/16			<u>2242'</u>
3			Perf. top
2		1617'	Perf. bottom
Liners Used			Perf. top
			Perf. bottom

Open Flow 70 /10ths Water in _____ 2 Inch
/10ths Merc. in _____ Inch
Volume 578,000 Cu. Ft.
Rock Pressure 160 lbs. _____ hrs.
Oil _____ bbls., 1st 24 hrs.
Fresh water 315' feet _____ feet
Salt water 890 feet 1025-1090' feet

CASING CEMENTED _____ SIZE _____ No. Ft. _____ Date _____
COAL WAS ENCOUNTERED AT 70 FEET 60 INCHES
170 FEET 60 INCHES 220 FEET 60 INCHES
270 FEET 60 INCHES 500 FEET 36 INCHES

Formation	Color	Hard or Soft	Top	Bottom	Oil, Gas or Water	Depth Found	Remarks
Conductor			0	16			
Sand & Shells			16	18			
Sand			18	70			
Coal			70	75			
Slate			75	85			
Sand			85	170			
Coal			170	175			
Slate			175	200			
Lime			200	215			
Slate			215	220			
Coal			220	225			
Slate & Lime			225	255			
Slate			255	270			
Coal			270	275			
Lime			275	285			
Slate & Shells			285	310			
Sand			310	325			
Slate & Shells			325	350			
Sand			350	500			
Coal			500	503			
Slate & Lime			503	630			
Sand			630	640			
Slate			640	660			
Sand			660	750			
Break			750	755			
Sand			755	805			
Slate			805	807			
Salt Sand			807	1295			
Lime			1295	1300			
Red Rock			1300	1306			
Lime			1306	1312			
Maxon Sand			1312	1398			
Little Lime			1398	1418			
Pencil Slate			1418	1420			
Shell			1420	1436			
Pencil Slate			1436	1438			
Big Lime			1438	1561			
Injun Sand			1561	1591			
Slate			1591	1596			

Show of oil 817'
Water 890', 1025 to 1090

Gas 1525 show, 1550 show.
Gas 1573-1585

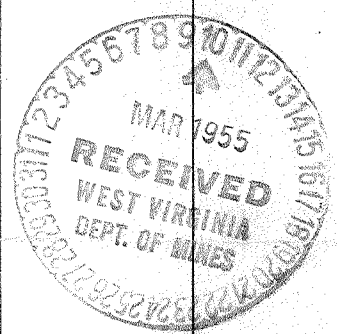

AUG 12 1955

Formation	Color	Hard or Soft	Top	Bottom	Oil, Gas or Water	Depth Found	Remarks
Red Rock			1596	1601	Gas 1573-1585'		
Sand			1601	1620			
Red Rock			1620	1630			
Slate			1630	1636			
Red Rock			1636	1665			
Lime			1665	1685			
Sand			1685	1700			
Slate			1700	1750			
Lime			1750	1780			
Slate & Shells			1780	2375			
Total depth			2375'				
Hole filled up to			1612'				

Date March 9, 19 55

APPROVED UNITED FUEL GAS COMPANY, Owner

By S. R. Furell
(Title)

Mgr. Civil Engineering Dept.