

LATITUDE 38° 30' (15')

(15') 01° 18'

LONGITUDE

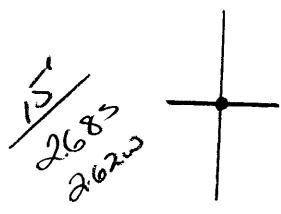

7'5 OGIS topo location

7.5' loc _____ 15' loc _____
 _____ (calc.) _____

on map # of 1917 Co Rest

Company _____

Farm _____

Quad Clay (15') NW

County _____

District Union

WELL LOCATION MAP

File No. 015-90011