

Minimum Error of Closure 1 in 200

Source of Elevation Elev. Well No. 1 - 878'

- Fracture.....
- New Location.....
- Drill Deeper.....
- Abandonment.....

I, the undersigned, hereby certify that this map is correct to the best of my knowledge and belief and shows all the information required by paragraph 6 of the rules and regulations of the oil and gas section of the mining laws of West Virginia.

Map No. \_\_\_\_\_

Signed: [Signature]  
 Squares: N S E W

Company RAMCO OIL & GAS CORP.  
 Address P.O. Box 99, Salsport, Ohio.  
 Farm Elizabeth Seckman  
 Tract \_\_\_\_\_ Acres 120 Lease No. \_\_\_\_\_  
 Well (Farm) No. Two Serial No. \_\_\_\_\_  
 Elevation (Spirit Level) 1158  
 Quadrangle Centerpoint  
 County Doddridge District McGellan  
 Engineer [Signature]  
 Engineer's Registration No. 1237  
 File No. \_\_\_\_\_ Drawing No. \_\_\_\_\_  
 Date Oct 24, 1972 Scale 1" = 400' = 660'

STATE OF WEST VIRGINIA  
 DEPARTMENT OF MINES  
 OIL AND GAS DIVISION  
 CHARLESTON

WELL LOCATION MAP

FILE NO. Doch-1703

Drilling Canceled 5-9-73  
 + Denotes location of well on United States Topographic Maps, scale 1 to 62,500, latitude and longitude lines being represented by border lines as shown.

- Denotes one inch spaces on border line of original tracing.

47-017

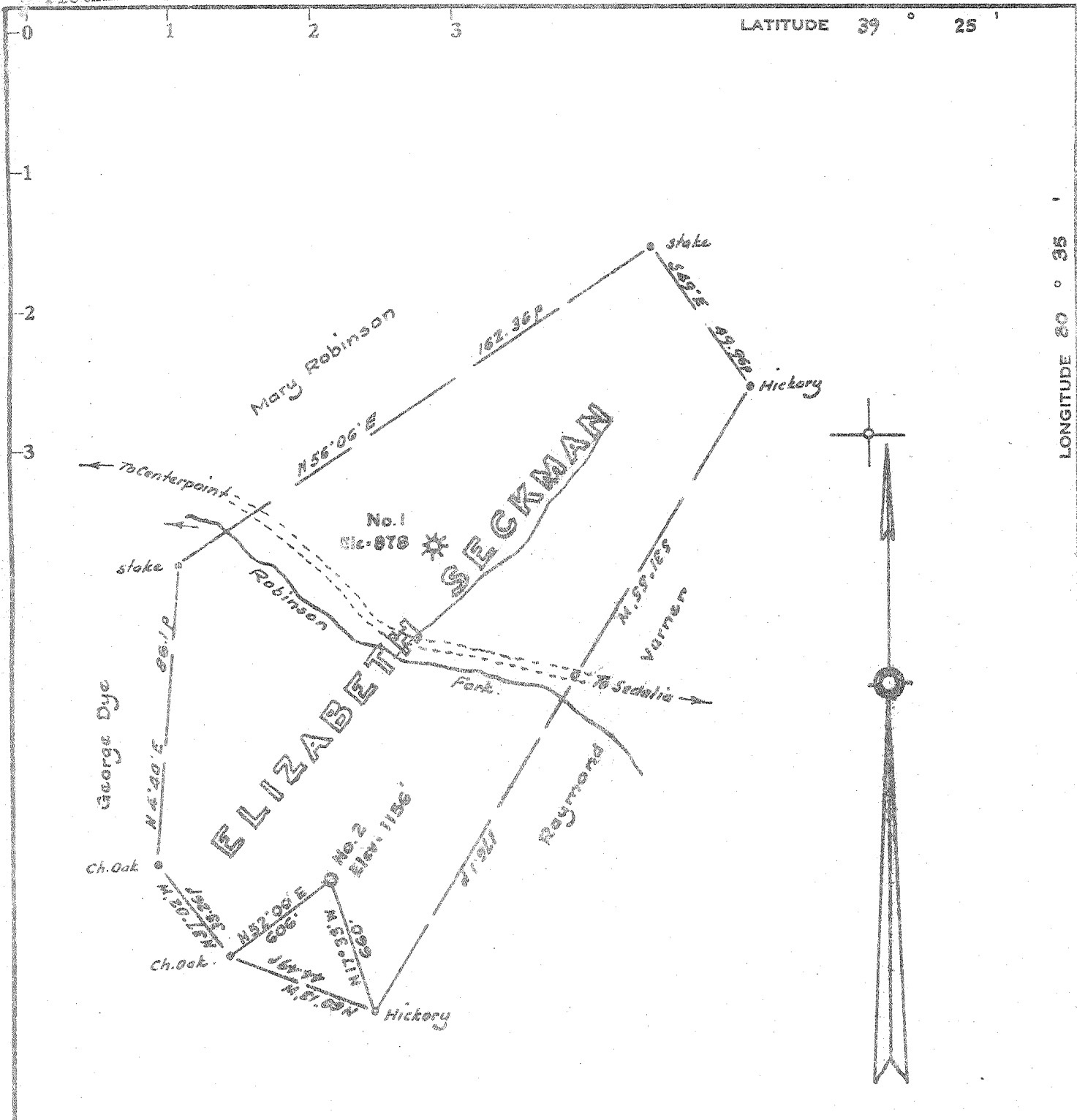

LONGITUDE 80 ° 35'

Minimum Error of Closure 1 in 200

Source of Elevation Elev. Well No. 1 = 870'

- Fracture.....
- New Location.....
- Drill Deeper.....
- Abandonment.....

I, the undersigned, hereby certify that this map is correct to the best of my knowledge and belief and shows all the information required by paragraph 6 of the rules and regulations of the oil and gas section of the mining laws of West Virginia.

Signed: [Signature]  
 Squares: N S E W

Company RAMCO OIL & GAS CORP.  
 Address P.O. Box 99, Eslora, Ohio.  
 Farm Elizabeth Seckman  
 Tract \_\_\_\_\_ Acres 120 Lease No. \_\_\_\_\_  
 Well (Farm) No. Two Serial No. \_\_\_\_\_  
 Elevation (Spirit Level) 1186  
 Quadrangle Centerpoint  
 County Doddridge District McClellan  
 Engineer [Signature]  
 Engineer's Registration No. 1227  
 File No. \_\_\_\_\_ Drawing No. \_\_\_\_\_  
 Date Oct 24, 1972 Scale 1" = 400' = 660'

STATE OF WEST VIRGINIA  
 DEPARTMENT OF MINES  
 OIL AND GAS DIVISION  
 CHARLESTON

**WELL LOCATION MAP**

FILE NO. Deed-1703

+ Denotes location of well on United States Topographic Maps, scale 1 to 62,500, latitude and longitude lines being represented by border lines as shown.

— Denotes one inch spaces on border line of original tracing.



STATE OF WEST VIRGINIA  
DEPARTMENT OF MINES

RECEIVED

NOV 3 1972

OIL & GAS DIVISION  
DEPT. OF MINES

Oil and Gas Division

OIL AND GAS WELL PERMIT APPLICATION

TO THE DEPARTMENT OF MINES,  
Charleston, W. Va.

DATE November 3, 1972

Surface Owner Elizabeth Seckman et al  
Address Centerpoint, W. Va.  
Mineral Owner Elizabeth Seckman et al  
Address Centerpoint, W. Va.  
Coal Owner Fee  
Address \_\_\_\_\_  
Coal Operator None - no coal is being mined  
Address in this area.

Company RAMCO Oil & Gas Corp.  
Address P.O. Box 99, Belpre, Ohio 45714  
Farm Elizabeth Seckman Acres 120  
Location (waters) Robinson Fork  
Well No. 2 Elevation 1156'  
District McClellan County Doddridge  
Quadrangle Centerpoint

INSPECTOR TO BE NOTIFIED Mr. Wm. Blosser  
Box 1857 PH: Fairmont  
Calfax, W. Va. 363-9105  
24566

THIS PERMIT MUST BE POSTED AT THE WELL SITE

All provisions being in accordance with Chapter 22, of the W. Va. Code, the location is hereby approved for drilling. This permit shall expire if operations have not commenced by 3-3-73

Robert L. Todd  
Deputy Director - Oil & Gas Division

GENTLEMEN:

The undersigned well operator is entitled to drill upon the above named farm or tract of land for oil and gas, having fee title thereto, (or as the case may be) under grant or lease dated February 10, 1972 by James F. Scott made to RAMCO Oil & Gas Corp. and recorded on the 18th day of February 1972, in Doddridge County, Book 95 Page 619

NEW WELL \_\_\_\_\_ DRILL DEEPER \_\_\_\_\_ REDRILL \_\_\_\_\_ FRACTURE OR STIMULATE  
\_\_\_\_\_ OIL AND GAS WELL ORIGINALLY DRILLED BEFORE JUNE 5, 1969.

The enclosed plat was prepared by a registered engineer or licensed land surveyor and all coal owners and/or operators have been notified as of the above date.

The above named coal owners and/or operator are hereby notified that any objection they wish to make, or are required to make by Section 3 of the Code, must be received by, or filed with the Department of Mines within ten (10) days. \*

Copies of this notice and the enclosed plat were mailed by registered mail, or delivered to the above named coal operators or coal owners at their above shown respective address \_\_\_\_\_ day \_\_\_\_\_ before, or on the same day with the mailing or delivery of this copy to the Department of Mines at Charleston, West Virginia.

Very truly yours,  
(Sign Name) by: RAMCO Oil & Gas Corp.  
Randall V. Koton Asst. Supt.  
Well Operator  
P. O. Box 99  
Street  
Belpre  
City or Town  
Ohio 45714  
State

Address  
of  
Well Operator

\*SECTION 3 . . . If no objections are filed or found by the Department of mines, within said period of ten days from the receipt of notice and plat by the department of mines, to said proposed location, the department shall forthwith issue to the well operator a permit reciting the filing of such plat, that no objections have been made by the coal operators or found thereto by the department and that the same is approved and the well operator authorized to proceed.

BOVD DRILL

Road-1703 PERMIT NUMBER \_\_\_\_\_

**THIS IS AN ESTIMATE ONLY**  
**ACTUAL INFORMATION WILL BE SUBMITTED ON OG-10 UPON COMPLETION**

PROPOSED WORK ORDER TO  DRILL \_\_\_\_\_ DEEPEN \_\_\_\_\_ FRACTURE-STIMULATE \_\_\_\_\_  
DRILLING CONTRACTOR: (If Known) \_\_\_\_\_ RESPONSIBLE AGENT: \_\_\_\_\_  
NAME Hank Snow \_\_\_\_\_ NAME Brad Crouse \_\_\_\_\_  
ADDRESS Salem, W. Va. \_\_\_\_\_ ADDRESS Rt. 1, Box 174, Grantsville, W. Va. \_\_\_\_\_  
TELEPHONE (304) 782-1366 \_\_\_\_\_ TELEPHONE (304) 354-7657 \_\_\_\_\_  
ESTIMATED DEPTH OF COMPLETED WELL: 2289' \_\_\_\_\_ ROTARY  CABLE TOOLS \_\_\_\_\_  
PROPOSED GEOLOGICAL FORMATION: Big Injun \_\_\_\_\_  
TYPE OF WELL: OIL \_\_\_\_\_ GAS  COMB. \_\_\_\_\_ STORAGE \_\_\_\_\_ DISPOSAL \_\_\_\_\_  
RECYCLING \_\_\_\_\_ WATER FLOOD \_\_\_\_\_ OTHER \_\_\_\_\_

TENTATIVE CASING PROGRAM:

CASING AND TUBING SIZE	USED FOR DRILLING	LEFT IN WELL	CEMENT FILL UP OR SACKS - CUBIC FT.
20 - 16			
13 - 10			
9 - 5/8			
8 - 5/8	200'	200'	200'
7			
5 ½			
4 ½		2289'	350'
3			Perf. Top
2			Perf. Bottom
Liners			Perf. Top
			Perf. Bottom

APPROXIMATE FRESH WATER DEPTHS 50 FEET \_\_\_\_\_ SALT WATER \_\_\_\_\_ FEET \_\_\_\_\_  
APPROXIMATE COAL DEPTHS none \_\_\_\_\_, \_\_\_\_\_  
IS COAL BEING MINED IN THE AREA? no \_\_\_\_\_ BY WHOM? \_\_\_\_\_

**TO DRILL:**  
SUBMIT FIVE (5) COPIES OF OG - 1, \$100.00 PERMIT FEE, PERFORMANCE BOND AND PERMANENT COPY OF PLAT.

**TO DRILL DEEPER OR REDRILL:**  
SUBMIT FIVE (5) COPIES OF OG - 1, SHOWING ORIGINAL PERMIT NUMBER AND PERFORMANCE BOND. ON WELLS DRILLED PRIOR TO 1929, A PERMANENT COPY OF THE PLAT AND THE ORIGINAL WELL RECORD MUST ALSO BE SUBMITTED.

**TO FRACTURE - STIMULATE:**  
OIL AND/OR GAS WELL ORIGINALLY DRILLED BEFORE JUNE 5, 1929, FIVE (5) COPIES OG - 1, PERFORMANCE BOND, PERMANENT PLAT AND ORIGINAL WELL RECORD.  
OIL AND/OR GAS WELL ORIGINALLY DRILLED ON AND/OR AFTER JUNE 5, 1929, FIVE COPIES OG - 1, SHOWING ORIGINAL PERMIT NUMBER, AND PERFORMANCE BOND.  
Required forms must be filed within ninety (90) days of completion for bond release. Inspector to be notified twenty-four (24) hours in advance.

The following waiver must be completed by the coal operator if the permit is to be issued within ten days of receipt thereof.

WAIVER: I the undersigned, Agent for \_\_\_\_\_ Coal Company, Owner or Operator of the coal under this lease have examined and place on our mine maps this proposed well location.  
We the \_\_\_\_\_ Coal Company have no objections to said well being drilled at this location, providing operator has complied with all rules and regulations in Articles 4, 5, and 7, Chapter 22 of the West Virginia Code.

\_\_\_\_\_  
For Coal Company  
Official Title \_\_\_\_\_