

98 3/10/88

LATITUDE 39° 15' 00" 5690'

LONGITUDE 80° 32' 30" 5725'

TIE LINES:  
'A' - S52°47'E, 122.93'  
'B' - S66°38'W, 490.08'  
'C' - N52°38'E, 442.86'

1.05  
329  
1.055  
1.050

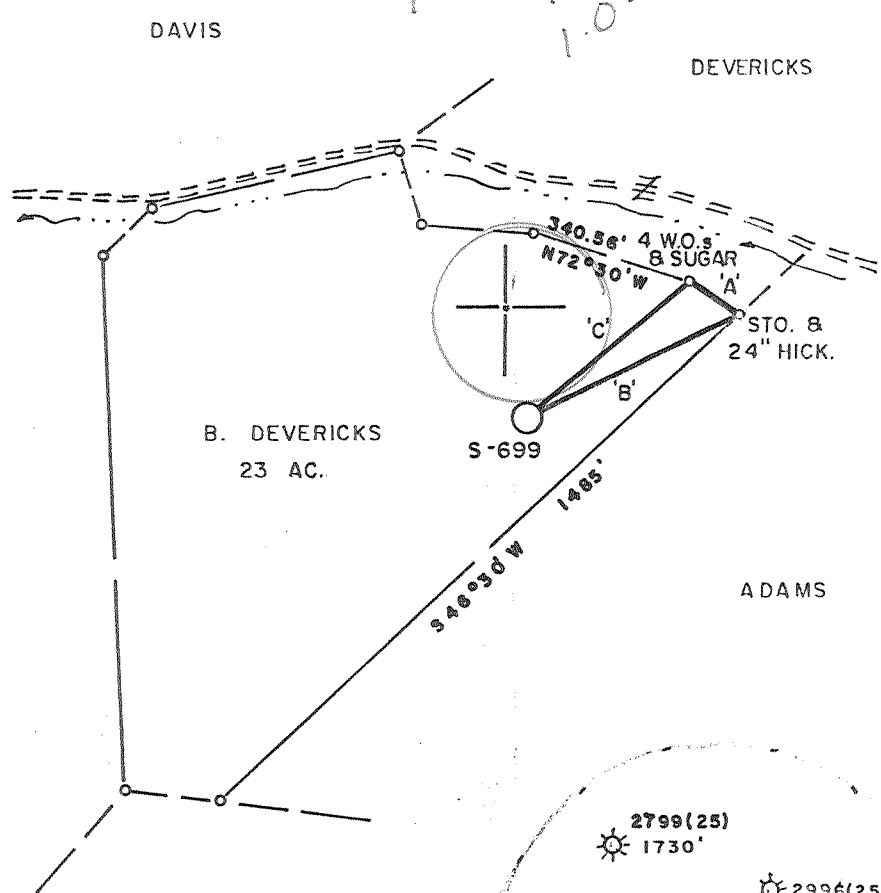

GOLDEN

B. DEVERICKS  
23 AC.

ADAMS

MORRIS

WELL REFERENCES:  
S50°W, 154.50' TO 3" BITT. HICK  
S86°15'E, 143' TO 5" MOCK. HICK.

LAND SURVEYING SERVICES  
21 CEDAR LANE  
BRIDGEPORT, WV 26330  
PHONE - 304-842-2018

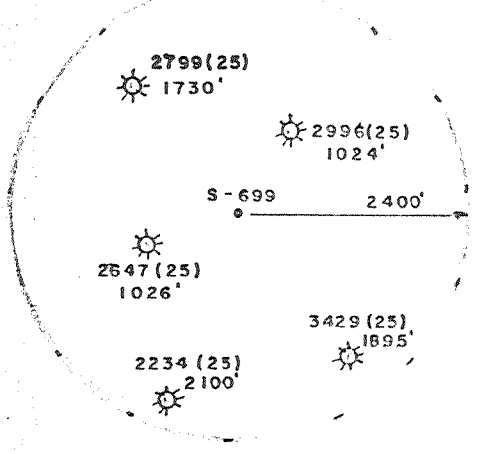

(+) DENOTES LOCATION OF WELL ON UNITED STATES TOPOGRAPHIC MAPS

FILE NO. \_\_\_\_\_  
DRAWING NO. \_\_\_\_\_  
SCALE 1" = 400'  
MINIMUM DEGREE OF ACCURACY 1 in 200  
PROVEN SOURCE OF ELEVATION BM 1850' W. OF LOCATION ELEV. - 992'

I THE UNDERSIGNED, HEREBY CERTIFY THAT THIS PLAT IS CORRECT TO THE BEST OF MY KNOWLEDGE AND BELIEF AND SHOWS ALL THE INFORMATION REQUIRED BY LAW AND THE REGULATIONS ISSUED AND PRESCRIBED BY THE DEPARTMENT OF ENERGY.  
(SIGNED) Stephen D. Losh  
R.P.E. \_\_\_\_\_ L.L.S. 674  
STEPHEN D. LOSH



STATE OF WEST VIRGINIA  
DEPARTMENT OF ENERGY  
OIL AND GAS DIVISION



DATE FEBRUARY 08, 19 88  
OPERATOR'S WELL NO. S-699  
API WELL NO. B. DEVERICKS 'A'  
47 017 3632  
STATE COUNTY PERMIT

WELL TYPE: OIL \_\_\_ GAS  LIQUID INJECTION \_\_\_ WASTE DISPOSAL \_\_\_  
(IF "GAS,") PRODUCTION  STORAGE \_\_\_ DEEP \_\_\_ SHALLOW   
LOCATION: ELEVATION 1194' WATERSHED TRAUGH FORK  
DISTRICT GREENBRIER 4 COUNTY DODDRIDGE  
QUADRANGLE BIG ISAAC 7.5 min. 252 123, VADISONE  
SURFACE OWNER BILLIE J. DEVERICKS ACREAGE 23  
OIL & GAS ROYALTY OWNER B. J. DEVERICKS LEASE ACREAGE 23  
LEASE NO. 2081  
PROPOSED WORK: DRILL  CONVERT \_\_\_ DRILL DEEPER \_\_\_ REDRILL \_\_\_ FRACTURE OR STIMULATE \_\_\_ PLUG OFF OLD FORMATION \_\_\_ PERFORATE NEW FORMATION \_\_\_ OTHER PHYSICAL CHANGE IN WELL (SPECIFY) \_\_\_\_\_

PLUG AND ABANDON \_\_\_ CLEAN OUT AND REPLUG \_\_\_  
TARGET FORMATION ALEXANDER ESTIMATED DEPTH 5500'  
WELL OPERATOR SCOTT OIL COMPANY DESIGNATED AGENT DARREL WRIGHT  
ADDRESS P.O. BOX 112 SALEM, WV 26426 ADDRESS P.O. BOX 112 SALEM, WV 26126

MAR 18 1988

6-6 Meathouse Fork - Bristol (646)

RECEIVED  
APR 11 1988



WR-35 DIVISION OF OIL & GAS  
DEPARTMENT OF ENERGY

State of West Virginia  
DEPARTMENT OF ENERGY  
Oil and Gas Division

Date April 7, 1988  
Operator's  
Well No. S-699  
Farm Billy Devericks "A"  
API No. 47 - 017 - 3632

WELL OPERATOR'S REPORT  
OF  
DRILLING, FRACTURING AND/OR STIMULATING, OR PHYSICAL CHANGE

WELL TYPE: Oil \_\_\_ / Gas x / Liquid Injection \_\_\_ / Waste Disposal \_\_\_ /  
(If "Gas," Production x / Underground Storage \_\_\_ / Deep \_\_\_ / Shallow \_\_\_ /)

LOCATION: Elevation: 1194 Watershed Traugh Fork  
District: Greenbrier County Doddridge Quadrangle Big Isaac

COMPANY Scott Oil Company  
ADDRESS P. O. Box 112, Salem, WV 26426  
DESIGNATED AGENT Darrel Wright  
ADDRESS P. O. Box 112, Salem, WV 26426  
SURFACE OWNER Billy Devericks  
ADDRESS Route 2, Bristol, WV  
MINERAL RIGHTS OWNER Same as above  
ADDRESS  
OIL AND GAS INSPECTOR FOR THIS WORK Mike  
Underwood ADDRESS Rt. 2, Salem  
PERMIT ISSUED 3/14/88  
DRILLING COMMENCED 3/24/88  
DRILLING COMPLETED 3/29/88  
IF APPLICABLE: PLUGGING OF DRY HOLE ON  
CONTINUOUS PROGRESSION FROM DRILLING OR  
REWORKING. VERBAL PERMISSION OBTAINED  
ON

Casing & Tubing	Used in Drilling	Left in Well	Cement fill up Cu. ft.
Size 20-16 Cond.			
13-10"	30		
9 5/8			
8 5/8		915	to surface
7			
5 1/2			
4 1/2		5510	635 sks
3			
2			
Liners used			

GEOLOGICAL TARGET FORMATION \_\_\_\_\_ Depth \_\_\_\_\_ feet  
Depth of completed well 5570 feet Rotary \_\_\_ / Cable Tools \_\_\_  
Water strata depth: Fresh 215 feet; Salt \_\_\_\_\_ feet  
Coal seam depths: 205-210, 478-482 Is coal being mined in the area? no

OPEN FLOW DATA

Producing formation Alexander, Benson, Gordon Pay zone depth \_\_\_\_\_ feet  
Gas: Initial open flow \_\_\_\_\_ Mcf/d Oil: Initial open flow \_\_\_\_\_ Bbl/d  
Final open flow 227 Mcf/d Final open flow \_\_\_\_\_ Bbl/d  
Time of open flow between initial and final tests \_\_\_\_\_ hours  
Static rock pressure 1176 psig (surface measurement) after \_\_\_\_\_ hours shut in  
(If applicable due to multiple completion--)  
Second producing formation \_\_\_\_\_ Pay zone depth \_\_\_\_\_ feet  
Gas: Initial open flow \_\_\_\_\_ Mcf/d Oil: Initial open flow \_\_\_\_\_ Bbl/d  
Final open flow \_\_\_\_\_ Mcf/d Oil: Final open flow \_\_\_\_\_ Bbl/d  
Time of open flow between initial and final tests \_\_\_\_\_ hours  
Static rock pressure \_\_\_\_\_ psig (surface measurement) after \_\_\_\_\_ hours shut in

DETAILS OF PERFORATED INTERVALS, FRACTURING OR STIMULATING, PHYSICAL CHANGE, ETC.

Alexander	5419-5425	20/40 sand 46,800# 80/100 5000#	15% HCL 500 gal
Benson	5055-5061		15% HCL 500 gal
Gordon	2873-2881	20/40 sand 10,000#	15% HCL 500 gal

WELL LOG

FORMATION	COLOR	HARD OR SOFT	TOP FEET	BOTTOM FEET	REMARKS Including indication of all fresh and salt water, coal, oil and gas
Fill			0	5	
Red Rock			5	25	
Shale			25	50	
Red Rodk & Shale			50	95	
Sand			95	205	
Coal			205	210	
Red Rock & Shale			210	385	
Sand			385	438	
Sand & Shale			438	478	
Coal			478	482	
Shale			482	495	
Sand & Shale			495	930	
Red Rock			930	961	
Sand & Shale			961	2115	
Big Lime			2115	2180	
Sand			2180	2260	
Sand & Shale			2260	2740	
Sand			2740	2760	
Sand & Shale			2760	2812	
Sand			2812	2878	
Sand & Shale			2878	5040	
Sand			5040	5052	
Sand & Shale			5052	5330	
Sand			5330	5450	
Sand & Shale ✓			5450	5570	
Gamma Ray					
Big Lime			2120	2180	
Big Injun			2180	2260	
Gordon sTray			2740	2760	
Gordon			2812	2878	
Benson			5040	5052	
✓ Alexander			5330	5450	

**RECEIVED**  
APR 11 1988

DIVISION OF OIL & GAS  
DEPARTMENT OF ENERGY

(Attach separate sheets as necessary)

Scott Oil Company

Well Operator

By:

Date: April 7, 1988

Note: Regulation 2.02(i) provides as follows:

"The term 'log' or 'well log' shall mean a systematic detailed geological record of all formations, including ..., encountered in the drilling of a well."

**RECEIVED**  
FEB 25 1988

- 1) Date: February 15, 1988
- 2) Operator's well number  
S-699 Billy Devericks "A"
- 3) API Well No: 47 - 017 - 3632  
State - County - Permit

DIVISION OF OIL & GAS  
DEPARTMENT OF ENERGY  
STATE OF WEST VIRGINIA  
DEPARTMENT OF ENERGY, DIVISION OF OIL AND GAS

NOTICE AND APPLICATION FOR A WELL WORK PERMIT

- 4) Surface Owner(s) to be served:
  - (a) Name Bill Devericks  
Address Route 2  
Bristol, WV 26332
  - (b) Name \_\_\_\_\_  
Address \_\_\_\_\_
  - (c) Name \_\_\_\_\_  
Address \_\_\_\_\_
- 6) Inspector Mike Underwood  
Address Route 2  
Salem, WV 26426  
Telephone (304)- 782-1043

- 5) (a) Coal Operator:
  - Name \_\_\_\_\_  
Address \_\_\_\_\_
  - (b) Coal Owner(s) with Declaration  
Name Willis G. Tetric  
Address Union National Center  
Clarksburg, WV 26301
  - Name \_\_\_\_\_  
Address \_\_\_\_\_
  - (c) Coal Lessee with Declaration  
Name Consolidation Coal Co.  
Address P. O. Box 1314  
Morgantown, WV 26505

TO THE PERSON(S) NAMED ABOVE TAKE NOTICE THAT:

\_\_\_\_\_ Included is the lease or leases or other continuing contract or contracts by which I hold the right to extract oil and gas OR  
 Included is the information required by Chapter 22B, Article 1, Section 8(d) of the Code of West Virginia (see page 2)

I certify that as required under Chapter 22B of the West Virginia Code I have served copies of this notice and application, a location plat, and accompanying documents pages 1 through \_\_\_\_\_ on the above named parties, by:

- \_\_\_\_\_ Personal Service (Affidavit attached)
- Certified Mail (Postmarked postal receipt attached)
- \_\_\_\_\_ Publication (Notice of Publication attached)

I have read and understand Chapter 22B and 38 CSR 11-18, and I agree to the terms and conditions of any permit issued under this application.

I certify under penalty of law that I have personally examined and am familiar with the information submitted on this application form and all attachments, and that based on my inquiry of those individuals immediately responsible for obtaining the information, I believe that the information is true, accurate, and complete.

I am aware that there are significant penalties for submitting false information, including the possibility of fine and imprisonment.

Well Operator Scott Oil Company  
 By: Daniel Wight  
 Its: Agent  
 Address P. O. Box 112  
Salem, WV 26426  
 Telephone 304-623-9600

Subscribed and sworn before me this 15th day of February, 1988

Roger Zim Notary Public  
 My commission expires April 23, 1993

017-3632 13

Issued 3/14/88  
Expires 3/14/90

FORM WW-2B

Page \_\_\_ of \_\_\_

STATE OF WEST VIRGINIA  
DEPARTMENT OF ENERGY, DIVISION OF OIL AND GAS  
WELL WORK PERMIT APPLICATION

- 1) Well Operator: 774 Scott Oil Company 44315, 4, 252
- 2) Operator's Well Number: S-699 3) Elevation: 1194
- 4) Well type: (a) Oil  or Gas  /  
(b) If Gas: Production  / Underground Storage   
Deep  Shallow
- 5) Proposed Target Formation(s): Alexander 439
- 6) Proposed Total Depth: 5500 feet
- 7) Approximate fresh water strata depths: 97, 827, 213, 420
- 8) Approximate salt water depths: \_\_\_\_\_
- 9) Approximate coal seam depths: 187-191', 210-215', 539-542', 1153' 1100'
- 10) Does land contain coal seams tributary to active mine? Yes  / No   
From 2647, 2799, 2996, 3429 Oxbridge
- 11) Proposed Well Work: Drill & Complete New Well
- 12)

RECEIVED  
FEB 26 1988

CASING AND TUBING PROGRAM

TYPE	SPECIFICATIONS			FOOTAGE INTERVALS		CEMENT
	Size	Grade	Weight per ft.	For drilling	Left in well	
Conductor	11 3/4			30'		
Fresh Water						
Coal						38CSR10-11.3
Intermediate	8 5/8			1190'	1190' 858	38CSR10-11.22 to surface
Production	4 1/2				5450	38CSR10-11.1 400 sks
Tubing						
Liners						

PACKERS : Kind \_\_\_\_\_  
Sizes \_\_\_\_\_  
Depths set \_\_\_\_\_

For Division of Oil and Gas Use Only

1200  
5  
Fee(s) paid:  Well Work Permit  Reclamation Fund  WPCP  
Plat  WW-9  WW-2B  Bond 500000 Agent

(Type)