

Par.	Tax Map 13 Owner	Bk/Pg	Acres
1	26 Pamela & Darrel Swisher	246/469	15.42
2	26.3 Deana & Gibson L. Clark III	245/236	18.98
3	31 Joseph E. & Sandra Gum	AP38/182	4.25
4	27 Michael B. Duffelmeyer, et al & Justine Paula Hyre, et al	WB42/316	15.50
5	26.2 Pamela E. Moore	209/293	0.75
6	26.1 Deana & Gibson L. Clark III	204/87	1.50

Notes:
 West Virginia Coordinate System of 1927, North Zone based upon Differential GPS Measurements.
 Well No. Honey Unit 1H Top Hole coordinates
 N: 258,838.64' Latitude: 39°12'17.75"
 E: 1,673,916.87' Longitude: 80°39'02.56"
 Bottom Hole coordinates
 N: 252,500.10' Latitude: 39°11'15.38"
 E: 1,676,100.57' Longitude: 80°38'33.79"
 UTM Zone 17, NAD 1983
 Top Hole Coordinates Bottom Hole Coordinates
 N: 4,339,586.264m N: 4,337,666.340m
 E: 530,173.530m E: 530,871.001m
 Plat orientation and corner and well references are based upon the grid north meridian.
 Well location references are based upon the magnetic meridian.

Line	Bearing	Dist.
L1	N 24°08' W	1,368.0'
L2	S 79°34' W	1,507.1'
L3	S 69°35' W	872.5'
L4	S 67°25' W	569.9'

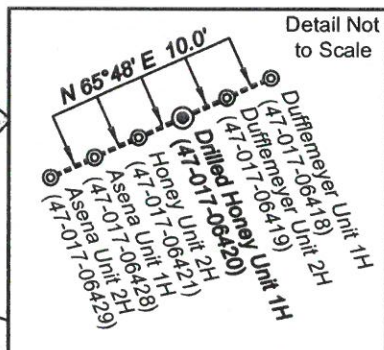
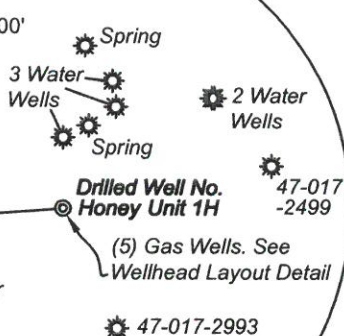

Legend

- Proposed gas well
- Found corner, as noted
- Creek or Drain
- Existing Road
- Surface boundary (approx.)
- Interior surface tracts (approx.)

Top Hole coordinates verified by survey grade GPS. As-drilled data and information was provided by Antero Resources Corporation. Allegheny Surveys, Inc. (ASI) is not certifying the data and information provided. ASI is not responsible for any errors or inaccuracies with the data and information that has been provided.

FILE NO: 69-30-NM-13
 DRAWING NO: Honey Unit 1H Well Plat As-Drill
 SCALE: 1" = 1000'
 MINIMUM DEGREE OF ACCURACY: Submeter
 PROVEN SOURCE OF ELEVATION: WVDOT, Bridgeport, WV

STATE OF WEST VIRGINIA
 DEPARTMENT OF ENVIRONMENTAL PROTECTION
OIL AND GAS DIVISION

DATE: March 30 2015
 OPERATOR'S WELL NO. Honey Unit 1H
 API WELL NO
 47 - 017 - 06420
 STATE COUNTY PERMIT

WELL TYPE: OIL GAS LIQUID INJECTION WASTE DISPOSAL
 (IF GAS) PRODUCTION: STORAGE DEEP SHALLOW
 LOCATION: ELEVATION: Existing Grade - 1081' Original Grade - 1112' WATERSHED: Headwaters Middle Island Creek QUADRANGLE: New Milton
 DISTRICT: New Milton COUNTY: Doddridge
 SURFACE OWNER: Michael B. Duffelmeyer, et al & Justine Paula Hyre, et al James D. Rogers, et al Charles Sherwood, et ux, et al
 ROYALTY OWNER: Joyce A. Shaw Nazelrod, et al; James D. Rooney, et al; French H. Cox, et al LEASE NO: 21054 22062 ACREAGE: 107 163.85
 PROPOSED WORK: DRILL CONVERT DRILL DEEPER FRACTURE OR STIMULATE PLUG OFF OLD FORMATION
 PERFORATE NEW FORMATION OTHER PHYSICAL CHANGE IN WELL (SPECIFY) As-Drilled
 PLUG AND ABANDON CLEAN OUT AND REPLUG TARGET FORMATION: Marcellus Shale DEPTH: 7,091' TVD 13,591' MD

WELL OPERATOR: Antero Resources Corporation DESIGNATED AGENT: Dianna Stamper - CT Corporation System
 ADDRESS: 1615 Wynkoop Street ADDRESS: 5400 D Big Tyler Road
 Denver, CO 80202 Charleston, WV 25313