

LATITUDE 39°20'00"

10,769'

121' TO BOTTOM HOLE  
LATITUDE 39°20'00"

609' TO BOTTOM HOLE

10,971'

LONGITUDE 80°45'00"

LONGITUDE 80°42'30"

COUNTY NAME

PERMIT

### Antero Resources Corporation Well No. Whitehill Unit 2H

- NOTE**
1. NO OCCUPIED DWELLINGS OR BUILDINGS TWO THOUSAND FIVE HUNDRED (2,500) SQUARE FEET OR LARGER USED TO HOUSE OR SHELTER DAIRY CATTLE OR POULTRY HUSBANDRY ARE LOCATED WITHIN SIX HUNDRED TWENTY-FIVE (625) FEET OF THE CENTER OF THE WELL PAD.
  2. TOP HOLE DATA SHOWN HEREON WAS PROVIDED BY ANTERO RESOURCES CORPORATION.
  3. AS DRILLED DATA WAS PROVIDED BY ANTERO RESOURCES CORPORATION.
  4. WLS IS NOT CERTIFYING THE DATA AND INFORMATION PROVIDED LISTED IN NOTES 2 AND 3, ONLY THE RELATIONSHIP TO THE DATA AND INFORMATION PROVIDED TO THE LEASE BOUNDARIES.
  5. WLS IS BY NO MEANS RESPONSIBLE FOR ANY ERRORS OR INACCURACIES WITH THE DATA AND INFORMATION THAT HAS BEEN PROVIDED.

API WELL # 47 - 017 - 06903  
STATE COUNTY PERMIT

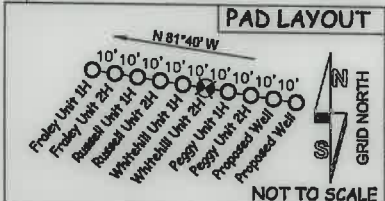

**NOTES:**  
2H BOTTOM HOLE  
WELL 2H TOP HOLE INFORMATION:  
N: 294,993ft E: 1,647,302ft  
LAT: 39°18'11.56" LON: 80°44'47.00"  
BOTTOM HOLE INFORMATION:  
N: 305,370ft E: 1,646,303ft  
LAT: 39°19'53.98" LON: 80°45'01.54"  
WEST VIRGINIA COORDINATE SYSTEM OF 1927 NORTH ZONE. ZONE WAS DERIVED FROM MEASUREMENTS TAKEN WITH TRIMBLE GEOXT SUBMETER MAPPING GRADE GPS UNIT. PLAT ORIENTATION, CORNER, AND WELL REFERENCE TIE LINES ARE BASED ON GRID NORTH.

(NAD) 83 (UTM) ZONE 17 COORDS:  
WELL 2H TOP HOLE INFORMATION:  
N: 4,350,465m E: 521,882m  
BOTTOM HOLE INFORMATION:  
N: 4,353,621m E: 521,525m

WELL 2H POINT OF ENTRY INFORMATION:  
N: 295,512ft E: 1,649,240ft  
LAT: 39°18'16.96" LON: 80°44'22.44"  
N: 4,350,633m E: 522,469m

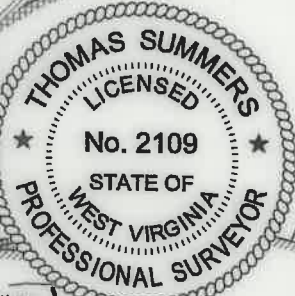

I THE UNDERSIGNED, HEREBY CERTIFY THAT THIS PLAT IS CORRECT TO THE BEST OF MY KNOWLEDGE AND BELIEF AND SHOWS ALL THE INFORMATION REQUIRED BY LAW AND THE RULES ISSUED AND PERSCRIBED BY THE DEPARTMENT OF ENVIRONMENTAL PROTECTION.



STATE OF WEST VIRGINIA, DIVISION OF ENVIRONMENTAL PROTECTION, OFFICE OF OIL AND GAS  
WILLOW LAND SURVEYING PLLC  
220 MASONIC AVE. PENNSBORO WEST VIRGINIA 26415

JOB # 19-036WA  
DRAWING # WHITEHILL2HAD  
SCALE 1" = 1000'  
MINIMUM DEGREE OF ACCURACY SUBMETER  
PROVEN SOURCE OF ELEV. SUBMETER MAPPING GRADE GPS  
STATE OF WEST VIRGINIA DEPARTMENT OF ENERGY DIVISION OF OIL AND GAS

**LEGEND**  
- - - Surface Owner Boundary Lines +/-  
- - - Interior Surface Tracts +/-  
○ Proposed Well Path  
⊗ As Drilled Well Path

THOMAS SUMMERS P.S. 2109  
DATE 08/03/21  
OPERATOR'S WELL# WHITEHILL UNIT #2H

WELL TYPE: OIL \_\_\_ GAS  LIQUID INJECTION \_\_\_ WASTE DISPOSAL \_\_\_  
(IF "GAS") PRODUCTION  STORAGE \_\_\_ DEEP \_\_\_ SHALLOW   
LOCATION: ELEVATION 1,275' - AS BUILT WATERSHED HEADWATERS MIDDLE ISLAND CREEK  
QUADRANGLE SH-SMITHBURG 7.5' BH-WEST UNION 7.5' DISTRICT WEST UNION COUNTY DODDRIDGE  
SURFACE OWNER SAMUEL AND PEGGY SMITH ACREAGE 28,956 ACRES +/-  
OIL & GAS ROYALTY OWNER ELAINE DEBOLT; R.L. BARNES ET UX; JAMES S. KISSEL

CHARLES N. WELCH ET AL; EQT PRODUCTION COMPANY; DIXIE J. CRAIG; PAMELA R. SCOTT; LEASE ACREAGE 84.8 ACRES +/- 222 ACRES +/- 17.01 ACRES +/-  
MICHAEL T. O'BRIEN ET UX; ED BROOME INC.; LENA E. CHRISTMAN; ELIZABETH WETZEL ROMINE 27 ACRES +/- 20 ACRES +/- 39 ACRES +/- 80 ACRES +/-  
PROPOSED WORK: DRILL \_\_\_ CONVERT \_\_\_ DRILL DEEPER \_\_\_ REDRILL \_\_\_ FRACTURE OR STIMULATE \_\_\_  
PLUG OFF OLD FORMATION \_\_\_ PERFORATE NEW FORMATION \_\_\_ OTHER PHYSICAL CHANGE IN WELL \_\_\_  
(SPECIFY) AS DRILLED PLUG & ABANDON \_\_\_ CLEAN OUT & REPLUG \_\_\_  
TARGET FORMATION MARCELLUS ESTIMATED DEPTH 7,082' TVD 17,967' MD  
WELL OPERATOR ANTERO RESOURCES CORP. DESIGNATED AGENT DIANNA STAMPER  
ADDRESS 1615 WYNKOOP STREET ADDRESS CT CORPORATION SYSTEM  
FORM WW-6 DENVER, CO 80202 ADDRESS 5400 D BIG TYLER ROAD  
CHARLESTON, WV 25313

10/01/2021