

Antero Resources
Well No. Dixie 2H
As-Drilled
Antero Resources Corporation



Top Hole Coordinates, As-drilled data, and information was provided by Antero Resources Corporation. Allegheny Surveys Inc. (ASI) is not certifying the data and information provided. ASI is not responsible for any errors or inaccuracies with the data and information that has been provided.

I, the undersigned, hereby certify that this plat is correct to the best of my knowledge and belief and shows all the information required by law and the rules issued and prescribed by the Department of Environmental Protection.

Bradley D. Miller

Bradley D. Miller, P.S. 2167



Note: 14 water wells and 2 springs were found within 2000' of proposed well. No occupied dwellings or buildings 2,500 square feet or larger used to house or shelter dairy cattle or poultry husbandry are located within 625' of the center of the well pad.

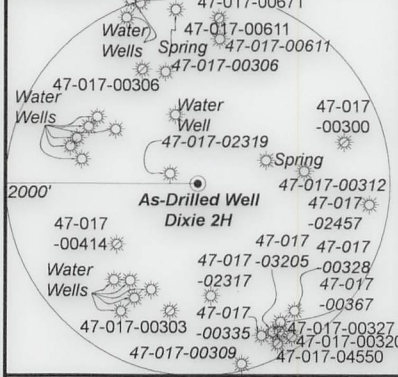

Bearing	Dist.
L1 S 76°20' E	1,209.8'
L2 S 41°20' E	1,801.6'
L3 S 79°12' W	1,087.5'
L4 N 33°13' E	1,546.6'

- Legend**
- Proposed gas well
 - ⊛ Monument, as noted
 - ⊙ Existing Well, as noted
 - ⊙ Digitized Well, as noted
 - Creek or Drain
 - Road
 - Surface boundary (approx.)
 - Interior surface tracts (approx.)
 - County Line

Sheet 1 of 5

9,015' to Top Hole

5,881' to Bottom Hole
TOP HOLE LATITUDE 39 - 20 - 00
BTM HOLE LATITUDE 39 - 17 - 30

Notes
 West Virginia Coordinate System of 1927, North Zone based upon Differential GPS Measurements.
 Well No. Dixie Unit 2H Top Hole coordinates are
 N: 295,239.55' Latitude: 39°18'12.61"
 E: 1,637,267.59' Longitude: 80°46'54.69"
 Bottom Hole coordinates are
 N: 286,832.42' Latitude: 39°16'49.94"
 E: 1,640,285.32' Longitude: 80°46'14.79"
 UTM Zone 17, NAD 1983
 Top Hole Coordinates Bottom Hole Coordinates
 N: 4,350,489.357m N: 4,347,943.475m
 E: 518,823.279m E: 519,785.349m
 Plat orientation and corner and well references are based upon the grid north meridian.
 Well location references are based upon the magnetic meridian.

Notes:
 Well No. Dixie Unit 2H As-Drilled POE Coordinates WV Coordinate System of 1927, North Zone
 N: 295,115.94'
 E: 1,637,745.47'
 Latitude: 39°18'11.45"
 Longitude: 80°46'48.59"
 UTM Zone 17, NAD 1983
 N: 4,350,454.132m
 E: 518,969.493m

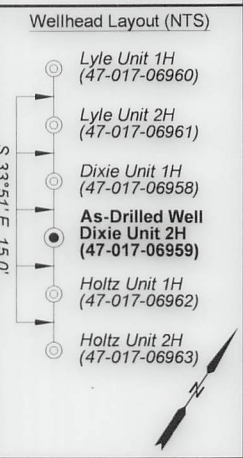

See Detail 1 (Page 2)

See Detail 2 (Page 3)

Top Hole 7.5' Spot

Dixie Unit 2H Bottom Hole

FILE NO: 58-30-WU-14
 DRAWING NO: Dixie Unit 2H As-Drilled Well Plat
 SCALE: 1" = 1500'
 MINIMUM DEGREE OF ACCURACY: Submeter
 PROVEN SOURCE OF ELEVATION: WVDOT, Harrisville, WV

STATE OF WEST VIRGINIA
 DEPARTMENT OF ENVIRONMENTAL PROTECTION
OIL AND GAS DIVISION

DATE: October 4 20 24
 OPERATOR'S WELL NO. Dixie Unit 2H
 API WELL NO
 47 - 017 - 06959
 STATE COUNTY PERMIT

WELL TYPE: OIL GAS LIQUID INJECTION WASTE DISPOSAL
 (IF GAS) PRODUCTION: STORAGE DEEP SHALLOW

LOCATION: ELEVATION: As-Built: 886' WATERSHED: Middle Island Creek QUADRANGLE: West Union
 DISTRICT: West Union Antero COUNTY: Doddridge
 SURFACE OWNER: Resources Corp. ACREAGE: 16.5
 ROYALTY OWNER: Claude F. Smith, et ux LEASE NO: ACREAGE: 90

PROPOSED WORK: DRILL CONVERT DRILL DEEPER FRACTURE OR STIMULATE PLUG OFF OLD FORMATION
 PERFORATE NEW FORMATION OTHER PHYSICAL CHANGE IN WELL (SPECIFY) As-Drilled
 PLUG AND ABANDON CLEAN OUT AND REPLUG TARGET FORMATION: Marcellus Shale ESTIMATED DEPTH: 6,525' TVD
 15,571' MD

WELL OPERATOR: Antero Resources Corporation DESIGNATED AGENT: Kevin Ellis
 ADDRESS: 1615 Wynkoop Street ADDRESS: 535 White Oaks Blvd.
 Denver, CO 80202 Bridgeport, WV 26330

WR-35



Detail 1
(NTS)



FILE NO: 58-30-WU-14
 DRAWING NO: Dixie Unit 2H As-Drilled Well Plat
 SCALE: 1" = 1500'
 MINIMUM DEGREE OF ACCURACY:
 Submeter
 PROVEN SOURCE OF ELEVATION:
 WVDOT, Harrisville, WV

STATE OF WEST VIRGINIA
 DEPARTMENT OF ENVIRONMENTAL PROTECTION
OIL AND GAS DIVISION

DATE: October 4 20 24
 OPERATOR'S WELL NO. Dixie Unit 2H
 API WELL NO
47 - 017 - 06959
 STATE COUNTY PERMIT

WELL TYPE: OIL GAS LIQUID INJECTION WASTE DISPOSAL
 (IF GAS) PRODUCTION: STORAGE DEEP SHALLOW
 LOCATION: ELEVATION: As-Built: 886' WATERSHED: Headwaters Middle Island Creek QUADRANGLE: West Union
 DISTRICT: West Union Antero COUNTY: Doddridge
 SURFACE OWNER: Resources Corp. ACREAGE: 16.5
 ROYALTY OWNER: Claude F. Smith, et ux LEASE NO: _____ ACREAGE: _____ 90
 PROPOSED WORK: DRILL CONVERT DRILL DEEPER FRACTURE OR STIMULATE PLUG OFF OLD FORMATION
 PERFORATE NEW FORMATION OTHER PHYSICAL CHANGE IN WELL (SPECIFY) As-Drilled
 PLUG AND ABANDON CLEAN OUT AND REPLUG TARGET FORMATION: Marcellus Shale ESTIMATED DEPTH: 6,525' TVD 15,571' MD

WELL OPERATOR: Antero Resources Corporation DESIGNATED AGENT: Kevin Ellis
 ADDRESS: 1615 Wynkoop Street ADDRESS: 535 White Oaks Blvd.
Denver, CO 80202 Bridgeport, WV 26330

Antero Resources
Well No. Dixie 2H
As-Drilled
Antero Resources Corporation

Sheet 3 of 5



Detail 2
(NTS)



FILE NO: 58-30-WU-14
 DRAWING NO: Dixie Unit 2H As-Drilled Well Plat
 SCALE: 1" = 1500'
 MINIMUM DEGREE OF ACCURACY:
Submeter
 PROVEN SOURCE OF ELEVATION:
WVDOT, Harrisville, WV

STATE OF WEST VIRGINIA
 DEPARTMENT OF ENVIRONMENTAL PROTECTION
OIL AND GAS DIVISION

DATE: October 4 20 24
 OPERATOR'S WELL NO. Dixie Unit 2H
 API WELL NO
47 - 017 - 06959
 STATE COUNTY PERMIT

WELL TYPE: OIL GAS LIQUID INJECTION WASTE DISPOSAL
 (IF GAS) PRODUCTION: STORAGE DEEP SHALLOW

LOCATION: ELEVATION: As-Built: 886' WATERSHED: Headwaters Middle Island Creek QUADRANGLE: West Union
 DISTRICT: West Union Antero COUNTY: Dodder
 SURFACE OWNER: Resources Corp. ACREAGE: 16.5
 ROYALTY OWNER: Claude F. Smith, et ux LEASE NO: _____ ACREAGE: _____ 90
 PROPOSED WORK: DRILL CONVERT DRILL DEEPER FRACTURE OR STIMULATE PLUG OFF OLD FORMATION
 PERFORATE NEW FORMATION OTHER PHYSICAL CHANGE IN WELL (SPECIFY) As-Drilled
 PLUG AND ABANDON CLEAN OUT AND REPLUG TARGET FORMATION: Marcellus Shale ESTIMATED DEPTH: 6,525' TVD 15,571' MD

WELL OPERATOR: Antero Resources Corporation DESIGNATED AGENT: Kevin Ellis
 ADDRESS: 1615 Wynkoop Street ADDRESS: 535 White Oaks Blvd.
Denver, CO 80202 Bridgeport, WV 26330

WR-35



Leases	
A	Claude F. Smith, et ux
B	Harret B. Jarvis, et al
C	WVDNR
D	J.M.L. Smith
E	Donald R. Dotson, Jr., et ux
F	Ronda Jean Adkins
G	Argil Waine Nicholson II, et ux
H	Stephen M. & Cathy Jo Ash
I	Shirley M. Smith
J	Sharon E. Walker & Ron Burns
K	300N, LLC
L	300N, LLC
M	Lorelei F. Phillips
N	Doris K. Sheets
O	Mary Jane Staats
P	Dorothy L. & F. Thomas Cross Jr.
Q	Gary Fox, et ux
R	West Union First Assembly of God
S	Webb & Sons Holdings, LLC
T	West Union First Assembly of God
U	CGP Development Co. Inc.
V	CGP Development Co. Inc.
W	Timothy C. Phillips
X	Doris J. Roberts-Gump
Y	Timothy C. Phillips
Z	Richard C. Beck, et al
AA	Doddridge County Senior Citizens, Inc.

Leases	
AB	James A. & Connie Jo Brannam
AC	WV State Rail Authority
AD	Francis J. Noll
AE	Mark Alan Willis
AF	300N, LLC
AG	300N, LLC
AH	West Union Baptist Church
AI	West Union Baptist Church
AJ	West Union Baptist Church
AK	Chad William Johnson
AL	Joseph R. Thorpe, et ux
AM	Linda McKinney
AN	United Hospital Center, Inc.
AO	Chad William Johnson
AP	United Hospital Center, Inc.
AQ	300N, LLC
AR	Howard D. Spurlock, II
AS	Elizabeth W. Romine
AT	Virginia L. Nicholson
AU	Emmanuel UM Church
AV	Emmanuel UM Church
AW	Emmanuel UM Church
AX	Volusia Ventures, LLC
AY	Lynn R. Ireland Sr.
AZ	Mary A. Stuart, et al
BA	Mary A. Stuart, et al
BB	Celia Schulte & Hazel B. Butler
BC	Joseph Cheuvront & W.S. Stuart

FILE NO: 58-30-WU-14
 DRAWING NO: Dixie Unit 2H As-Drilled Well Plat
 SCALE: 1" = 1500'
 MINIMUM DEGREE OF ACCURACY:
Submeter
 PROVEN SOURCE OF ELEVATION:
WVDOT, Harrisville, WV

STATE OF WEST VIRGINIA
 DEPARTMENT OF ENVIRONMENTAL PROTECTION
OIL AND GAS DIVISION

DATE: October 4 20 24
 OPERATOR'S WELL NO. Dixie Unit 2H
API WELL NO
47 - 017 - 06959
 STATE COUNTY PERMIT

WELL TYPE: OIL GAS LIQUID INJECTION WASTE DISPOSAL
 (IF GAS) PRODUCTION: STORAGE DEEP SHALLOW

LOCATION: ELEVATION: As-Built: 886' WATERSHED: Headwaters Middle Island Creek QUADRANGLE: West Union
 DISTRICT: West Union Antero COUNTY: Doddridge
 SURFACE OWNER: Resources Corp. ACREAGE: 16.5
 ROYALTY OWNER: Claude F. Smith, et ux LEASE NO: _____ ACREAGE: _____ 90
 PROPOSED WORK: DRILL CONVERT DRILL DEEPER FRACTURE OR STIMULATE PLUG OFF OLD FORMATION
 PERFORATE NEW FORMATION OTHER PHYSICAL CHANGE IN WELL (SPECIFY) As-Drilled
 PLUG AND ABANDON CLEAN OUT AND REPLUG TARGET FORMATION: Marcellus Shale ESTIMATED DEPTH: 15,571' MD 6,525' TVD

WELL OPERATOR: Antero Resources Corporation DESIGNATED AGENT: Kevin Ellis
 ADDRESS: 1615 Wynkoop Street ADDRESS: 535 White Oaks Blvd.
Denver, CO 80202 Bridgeport, WV 26330

12/13/2024



ID	TM-Par	Owner	Bk/Pg	Acres
1	11-3	Antero Resources Corp.	431/528	16.50
2	11-4	Paul D. & Sharon K. Weekley	186/743	17.30
3	11-4.1	Mary Lou Holland	286/313	9.55
4	11-13	Frank E. McGill	429/448	58.55
5	1-134	Donald R. Jr. & Teresa Dotson	406/122	0.31
6	1-136	Lena McAllister, et al	136/2	0.26
7	1-138	Argil Waine, II & Angela D. Nicholson	257/538	0.19
8	1-140	Argil Waine, II & Angela D. Nicholson	257/538	0.22
9	1-142.1	Stephen M. & Cathy Jo Ash	236/602	0.33
10	1-140.1	Argil Waine, II & Angela D. Nicholson	257/538	0.11
11	1-142	Shirley Ann Smith	306/75	0.09
12	3-7	Sharon E. Walker & Ron Burns	303/705	0.22
13	3-7.2	Guy Vespoint, III	510/440	0.11
14	3-7.1	Guy Vespoint, III	510/440	0.17
15	3-17	Lorelei S. Phillips	WB41/625	0.32
16	3-15	Doris Kay Sheets	431/439	0.17
17	3-16	Lorelei S. Phillips	WB41/625	0.32
18	3-24	Francis Noll	469/43	0.16
19	3-37.1	Floyd T. & Dorothy Lou Cross	215/53	0.09
20	3-37	Gary & Leona Fox	236/33	0.09
21	3-36	Dorothy L. & F. Thomas Cross Jr.	217/86	0.25
22	3-34	Dorothy L. & F. Thomas Cross Jr.	217/86	0.10
23	3-35.1	West Union First Assembly of God	380/494	0.04
24	3-35	Webb & Son Holdings, LLC	366/671	0.11
25	3-31	West Union First Assembly of God	197/656	0.22
26	3-33	William Clayce Spurlock, et al	209/295	0.11
27	3-32	West Union First Assembly of God	196/99	0.11
28	3-85	West Union First Assembly of God	197/656	0.07
29	3-87	West Union First Assembly of God	196/99	0.11
30	3-86	CGP Development Co. Inc.	232/403	0.20
31	3-132	CGP Development Inc.	237/383	0.11
32	3-88	Timothy C. & Lorelei F. Phillips	WB62/610	0.15
33	3-133	Doris J. Roberts-Gump	357/67	0.05
34	3-134	CGP Development Co. Inc.	245/668	0.17
35	3-135	Timothy C. Phillips	428/266	0.10
36	3-136	Richard C. Beck	232/145	0.05
37	3-137	Doddridge County Senior Citizens, Inc.	267/51	0.10
38	3-140.1	James A. & Connie Jo Brannam	318/654	0.25
39	3-139	Doddridge County Senior Citizens, Inc.	267/51	0.10
40	3-192	Doddridge Co. Sr. Citizens Inc	179/158	0.19
41	3-193	Doddridge County Senior Citizens, Inc	272/725	0.23
42	3-194.1	David E. Bowyer	524/454	0.08
43	3-196	Doddridge County Senior Citizens, Inc.	272/725	0.06
44	3-197	Doddridge County Senior Citizens, Inc.	272/725	0.07
45	3-198	James R. & Jane Ellen Merritt	357/15	0.10
46	3-195.4	John J. & Nancy Droppleman	154/98	0.04
47	3-195.2	John J. & Nancy Droppleman	168/360	0.08
48	3-191.1	West Union Baptist Church	161/190	0.34
49	3-199	Baptist Church	---/---	0.20
50	3-200	West Union Baptist Church Trustees	294/652	0.06
51	3-201	Joseph R. & Myla S. Thorpe	512/275	0.13
52	3-203	Joseph R. & Myla Thorpe	400/498	0.26
53	3-202	Linda McKinney	235/84	0.04
54	3-235	United Hospital Center Inc.	375/718	0.27
55	3-234	Julie A. Smith	512/273	0.05
56	3-237	United Hospital Center Inc.	375/718	0.22
57	3-239	Andrew J. Menendez	332/560	0.19
58	3-246	Marian E. Spurlock	465/727	0.08

ID	TM-Par	Owner	Bk/Pg	Acres
59	3-248	Elizabeth W. Romine	301/639	0.49
60	3-249	William S. Heflin, et al	444/128	0.31
61	3-264	B.H. Maulsby Trustee	---/---	0.23
62	3-280	Emmanuel United Methodist Church	173/758	0.31
63	3-261	Emmanuel United Methodist Church Trustees	276/486	0.16
64	3-282.2	Emmanuel United Methodist Church	519/314	0.25
65	3-282.1	John D. & Tina MarieTowner	445/323	0.14
66	3-288	Mary Farr Secrist	WB36/52	0.56
67	3-288.1	Mary Farr Secrist	WB36/52	0.14
68	3-289	Mary Farr Secrist	WB36/52	0.20
69	3-309	Mary Farr Secrist	WB36/52	0.22
70	3-300.1	Steven R. Chipps & Shawna Chipps	447/719	0.24
71	3-302	David R. Lipscomb & Haley A. Stephenson	469/171	0.13
72	4-80	David R. Lipscomb & Haley A. Stephenson	469/171	0.16
73	4-81	Paulene B. Roush Estate	WB26/57	0.12
74	4-82	Joshua B. Baldwin	405/682	0.13
75	4-84	Hunter C. Stansberry	WB106/719	0.16
76	4-85.1	Hunter C. Stansberry	WB106/719	0.16
77	4-85	Richard C. McMillian	WB118/285	0.32
78	31-14	Donald H. & Helen Michels	WB32/156	0.37
79	31-16	Kimberly L. & Dennis H. Powell II	285/614	0.17
80	4-98	George J. Buff, III & J. Charles Buff	377/517	0.14
81	31-17	Powell Family Trust	304/363	0.16
82	31-115	George J. Buff, III & J. Charles Buff	377/517	0.14
83	31-113	Powell Family Trust	304/363	0.16
84	3-116	George J. Buff, III & J. Charles Buff	377/517	0.14
85	31-112	Powell Family Trust	304/363	0.16
86	31-117	George J. Buff, III & J. Charles Buff	377/517	0.14
87	31-118	George J. Buff, III & J. Charles Buff	377/517	0.14
88	31-141	George J. Buff, III & J. Charles Buff	377/517	0.15
89	31-119	George J. Buff, III & J. Charles Buff	377/517	0.14
90	31-140	George J. Buff, III & J. Charles Buff	377/517	0.15
91	31-120	George J. Buff, III & J. Charles Buff	377/517	0.14
92	31-139	George J. Buff, III & J. Charles Buff	377/517	0.16
93	31-121	George J. Buff, III & J. Charles Buff	377/517	0.14
94	31-138	George J. Buff, III & J. Charles Buff	377/517	0.16
95	31-137	George J. Buff, III & J. Charles Buff	377/517	0.17
96	31-136	George J. Buff, III & J. Charles Buff	377/517	0.17
97	31-41	Leland M. Hickman	74 / 299	0.54
98	31-134	George J. Buff, III & J. Charles Buff	377/517	---
99	31-133	George J. Buff, III & J. Charles Buff	377/517	---
100	31-132	George J. Buff, III & J. Charles Buff	377/517	0.21
101	31-163	George J. Buff, III & J. Charles Buff	377/517	0.16
102	31-164	George J. Buff, III & J. Charles Buff	377/517	0.16
103	31-165	George J. Buff, III & J. Charles Buff	377/517	0.23
104	31-173	George J. Buff, III & J. Charles Buff	377/517	0.16
105	31-174	George J. Buff, III & J. Charles Buff	377/517	0.18
106	31-228	George J. Buff, III & J. Charles Buff	377/517	0.22
107	31-229	George J. Buff, III & J. Charles Buff	377/517	0.24
108	31-230	George J. Buff, III & J. Charles Buff	377/517	0.25
109	31-224	George J. Buff, III & J. Charles Buff	377/517	---
110	31-231	George J. Buff, III & J. Charles Buff	377/517	0.26
111	31-232	George J. Buff, III & J. Charles Buff	377/517	0.26
112	31-233	George J. Buff, III & J. Charles Buff	377/517	0.24
113	11-71	Lyle K. Baker	177/304	8.29
114	11-73	Key Oil Company	265/540	11.84
115	15-3	E Properties LTD	201/396	186.86
116	15-4	E Properties LTD	201/396	115.03

FILE NO: 58-30-WU-14
 DRAWING NO: Dixie Unit 2H As-Drilled Well Plat
 SCALE: 1" = 1500'
 MINIMUM DEGREE OF ACCURACY:
Submeter
 PROVEN SOURCE OF ELEVATION:
WVDOT, Harrisville, WV

STATE OF WEST VIRGINIA
 DEPARTMENT OF ENVIRONMENTAL PROTECTION
OIL AND GAS DIVISION

DATE: October 4 20 24
 OPERATOR'S WELL NO. Dixie Unit 2H
API WELL NO
47 - 017 - 06959
 STATE COUNTY PERMIT

WELL TYPE: OIL GAS LIQUID INJECTION WASTE DISPOSAL
 (IF GAS) PRODUCTION: STORAGE DEEP SHALLOW

LOCATION: ELEVATION: As-Built: 886' WATERSHED: Middle Island Creek QUADRANGLE: West Union
 DISTRICT: West Union Antero COUNTY: Doddridge
 SURFACE OWNER: Resources Corp. ACREAGE: 16.5
 ROYALTY OWNER: Claude F. Smith, et ux LEASE NO: _____ ACREAGE: _____ 90
 PROPOSED WORK: DRILL CONVERT DRILL DEEPER FRACTURE OR STIMULATE PLUG OFF OLD FORMATION
 PERFORATE NEW FORMATION OTHER PHYSICAL CHANGE IN WELL (SPECIFY) As-Drilled
 PLUG AND ABANDON CLEAN OUT AND REPLUG TARGET FORMATION: Marcellus Shale ESTIMATED DEPTH: 15,571' MD 6,525' TVD

WELL OPERATOR: Antero Resources Corporation DESIGNATED AGENT: Kevin Ellis
 ADDRESS: 1615 Wynkoop Street ADDRESS: 535 White Oaks Blvd.
Denver, CO 80202 Bridgeport, WV 26330