

Latitude 39° 25'

Longitude 80° 40'

W.H. Hoskins



No. 6  
Elev. 843.

No. 3  
Elev. 809

J.E. Kirey

J.D. Mc Reynolds

Fay Underwood

New Location   
 Drill Deeper   
 Abandonment

# 3 S 3.60 W 3.82 # 6 S 3.58 W 4.07

Survey A.K. Westfall.

Company Broadwater, Welch & Travis  
 Address Pennsboro, W.Va.  
 Farm Archie A. Smith  
 Tract \_\_\_\_\_ Acres 100 Lease No. \_\_\_\_\_  
 Well (Farm) No. 3-6 Serial No. \_\_\_\_\_  
 Elevation (Spirit Level) 809-843  
 Quadrangle Centerpoint  
 County Doddridge District Grant  
 Engineer B. Hinehart  
 Engineer's Registration No. 648  
 File No. \_\_\_\_\_ Drawing No. \_\_\_\_\_  
 Date Nov 15, 1948 Scale 1" = 40 Poles

STATE OF WEST VIRGINIA  
 DEPARTMENT OF MINES  
 OIL AND GAS DIVISION  
 CHARLESTON

WELL LOCATION MAP  
 DOD-819-A-3  
 FILE NO. DOD-820-A-6

+ Denotes location of well on United States Topographic Maps, scale 1 to 62,500, latitude and longitude lines being represented by border lines as shown.  
 - Denotes one inch spaces on border line of original tracing.

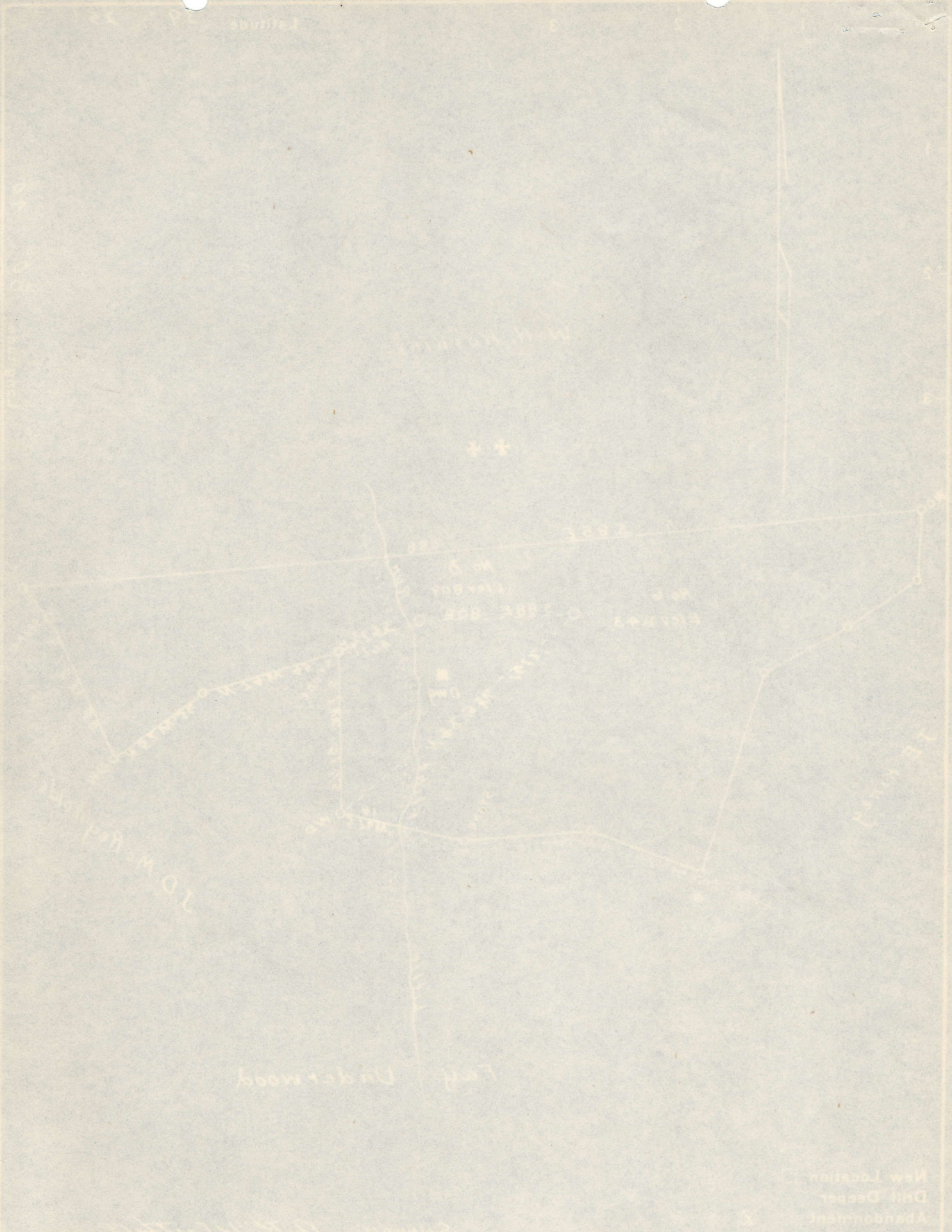

819A #3 (was 01772949)

7.5' loc

0.62S 39 22 30

1.44W 80 42 30

15' loc calc

3.50S

3.67W

*bla*  
9/24/88

820 A #6

7.5' loc

0.65S 39 22 30

1.61W 80 42 30

15' loc calc

3.53S

3.84W

70017

819A

Grant District, Doddridge County, W. Va.  
 By Broadwater, Welch & Travis, West Union or Pennington, W. Va.  
 Abandoned under permit 1ed-.....-A7  
 On 100 acres, on Little Flint Run.  
 Elevation, 809' L.  
 No record of date of completion, etc.  
 Shot Nov. 27, 1906, wt 1931', with 60 qts.  
 10" casing, 283' (pulled); 8 1/2", 1042' (pulled); 6 1/2", 1337'; 5 1/2", 1307'  
 (pulled); 2" tubing, 1949' (pulled).  
 Coal was encountered at 485'.  
 Oil well. Record to Dept. of Mines dated Jan. 3, 1949. Stamped 4-22-50.  
 Record to BGT from Mrs. Griffith Sept. 9, 1950. Old File No. 714.

	Top.	Bottom.
Coal	485	- ...
Big Injun Sand (oil, 1934')	1854	- ....
Total depth		1953



STATE OF WEST VIRGINIA  
DEPARTMENT OF MINES  
OIL AND GAS DIVISION

714

WELL RECORD

Permit No. 819-A

Oil or Gas Well Oil  
(KIND)

Company Broadwater, Welch, & Travis  
 Address West Union, or Pennsboro, W. Va.  
 Farm Silas Ash Smith Acres 100  
 Location (waters) Little Flint Run  
 Well No. 3 Elev. 809  
 District Grant County Dodd  
 The surface of tract is owned in fee by Archie A. Smith  
West Union, W. Va. Address (plot)  
 Mineral rights are owned by \_\_\_\_\_  
 Address \_\_\_\_\_  
 Drilling commenced no record  
 Drilling completed " "  
 Date Shot 11-27-06 From 1931 To \_\_\_\_\_  
 With 60 qts.  
 Open Flow /10ths Water in no record Inch  
 /10ths Merc. in " " Inch  
 Volume " " Cu. Ft.  
 Rock Pressure lbs. hrs.  
 Oil bbls., 1st 24 hrs.  
 Fresh water feet feet  
 Salt water feet feet

Casing and Tubing	Used in Drilling	Left in Well	Packers
Size			Kind of Packer
16			
13			
10	283	pulled	Size of
8 1/4	1042	"	Depth set
6 5/8	1837	1837	
5 3/16	1307	pulled	
3			Perf. top
2	1949	"	Perf. bottom
Liners Used			Perf. top
			Perf. bottom

CASING CEMENTED \_\_\_\_\_ SIZE \_\_\_\_\_ No. Ft. \_\_\_\_\_ Date \_\_\_\_\_  
 COAL WAS ENCOUNTERED AT 485 FEET \_\_\_\_\_ INCHES  
 \_\_\_\_\_ FEET \_\_\_\_\_ INCHES FEET \_\_\_\_\_ INCHES  
 \_\_\_\_\_ FEET \_\_\_\_\_ INCHES FEET \_\_\_\_\_ INCHES

Formation	Color	Hard or Soft	Top	Bottom	Oil, Gas or Water	Depth Found	Remarks
<u>Coal</u> Big Ingun			<u>485</u> 1854				
Oil			1934				
Total Depth			1953				



(Over) SEP - 9 1950

