

Fay Underwood

New Location  # 3 S 3.60 # 6 S 3.58  
 Drill Deeper  W 3.82 W 4.07  
 Abandonment

Survey *A.R. Westfall*

Company *Broadwater, Welch & Travis*  
 Address *Pennsboro, W.Va.*  
 Farm *Archie A. Smith*  
 Tract \_\_\_\_\_ Acres *100* Lease No. \_\_\_\_\_  
 Well (Farm) No. *3-6* Serial No. \_\_\_\_\_  
 Elevation (Spirit Level) *809-843*  
 Quadrangle *Centerpoint*  
 County *Doddridge* District *Grant*  
 Engineer *B. Flinchart*  
 Engineer's Registration No. *648*  
 File No. \_\_\_\_\_ Drawing No. \_\_\_\_\_  
 Date *Nov 15, 1948* Scale *1" = 40 Poles*

STATE OF WEST VIRGINIA  
 DEPARTMENT OF MINES  
 OIL AND GAS DIVISION  
 CHARLESTON

**WELL LOCATION MAP**  
 DOD-819-A-3  
 FILE NO. DOD-820-A-6

+ Denotes location of well on United States Topographic Maps, scale 1 to 62,500, latitude and longitude lines being represented by border lines as shown.

- Denotes one inch spaces on border line of original tracing.

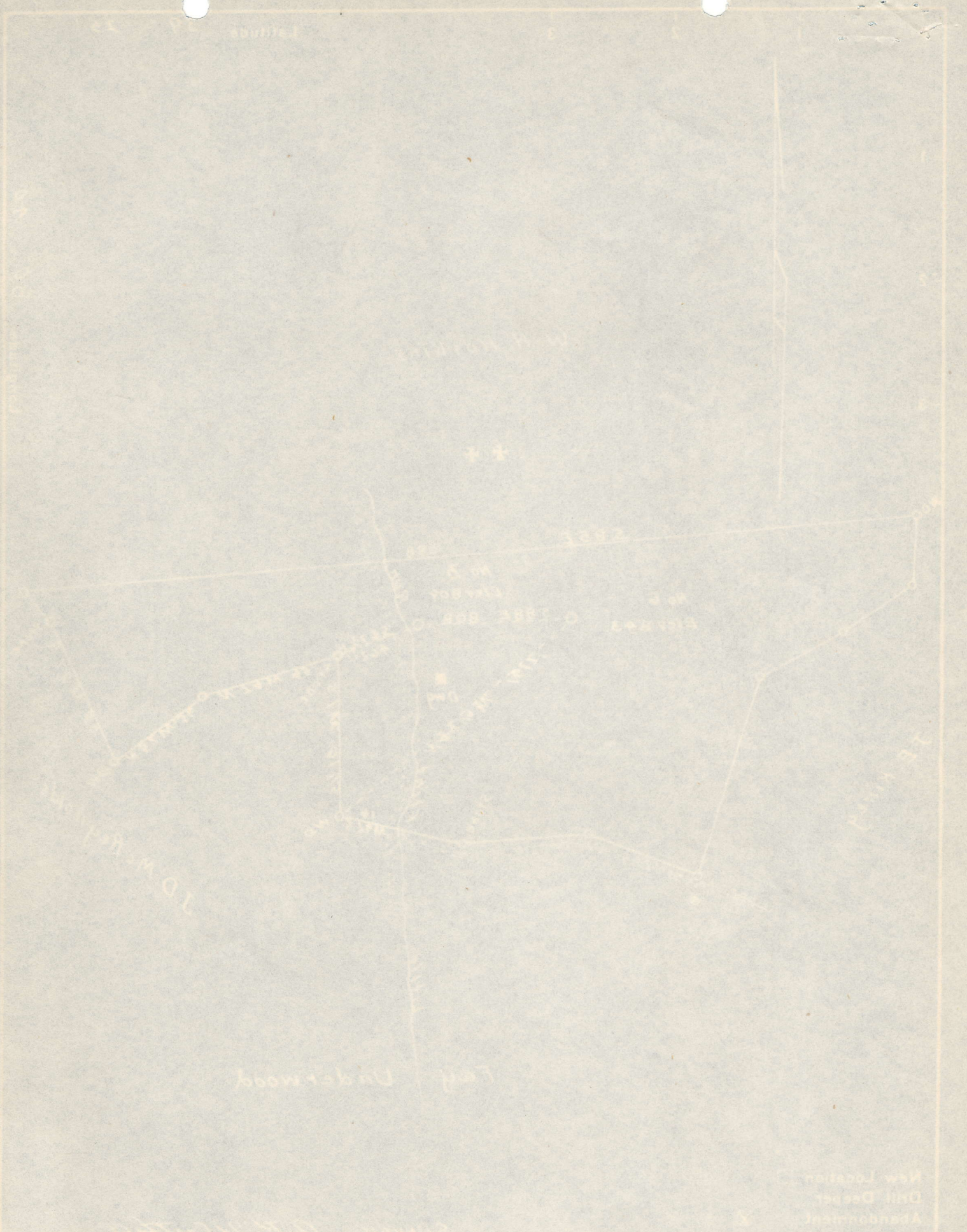

819A #3 (was 01772949)

7.5' loc

0.62S 39 22 30

1.44W 80 42 30

15' loc calc

3.50S

3.67W

*bla*  
9/24/88

820 A #6

7.5' loc

0.65S 39 22 30

1.61W 80 42 30

15' loc calc

3.53S

3.84W

70018

820A

Grant District, Doddridge County, W. Va.  
 By Broadwater, Welch & Travis, West Union or Pennsboro, W. Va.  
 Abandoned under permit Dod-.....-A?  
 On 100 acres, on Little Flint Run.  
 Elevation, 843' L.  
 Surface owned by Archie A. Smith, West Union, W. Va.  
 No record of date of completion, etc.  
 Shot Nov. 25, 1907, at 1976', with 40 qts.  
 No record of open flow, oil, or water.  
 10" casing, 335' (pulled); 8 1/2", 1150' (pulled); 6 3/8", 1928'; 5 1/8", 245'  
 (pulled); 2" tubing, 1994' (pulled).  
 Coal was encountered at 540'.  
 Oil well. Record to Dept. of Mines dated Jan. 3, 1949. Stamped 4-22-50.  
 Record to ROT from Mrs. Griffith Sept. 9, 1950. Old File No. 715.

	Top.	Bottom.
Coal	540 -	...
Big Injun Sand (oil, 1978')	1900 -	....
Total depth		1998



STATE OF WEST VIRGINIA  
DEPARTMENT OF MINES  
OIL AND GAS DIVISION

715

WELL RECORD

Permit No.

Oil or Gas Well Oil

(KIND)

Company Broadwater, Welch, & Travis  
Address West Union or Pennsboro, W. Va.  
Farm Silas Ash Acres 100  
Location (waters) Little Flint Run  
Well No. 6 Elev. 843  
District Grant County Dodd  
The surface of tract is owned in fee by Archie A. Smith  
West Union, W. Va. Address (Plot)  
Mineral rights are owned by \_\_\_\_\_  
Address \_\_\_\_\_

Drilling commenced no record  
Drilling completed " "  
Date Shot 11-25-07 From 1976 To \_\_\_\_\_  
With 40 qts.  
Open Flow /10ths Water in no record Inch  
/10ths Merc. in " " Inch  
Volume " " Cu. Ft.  
Rock Pressure " " lbs. hrs.  
Oil no record bbls., 1st 24 hrs.  
Fresh water " " feet  
Salt water " " feet

Casing and Tubing	Used in Drilling	Left in Well	Packers
Size			Kind of Packer
16			
13			
10	335	pulled	Size of
8 1/4	1150	"	
6 5/8	1928	1928	Depth set
5 3/16	245	pulled	
3			Perf. top
2	1994	pulled	Perf. bottom
Liners Used			Perf. top
			Perf. bottom

CASING CEMENTED \_\_\_\_\_ SIZE \_\_\_\_\_ No. Ft. \_\_\_\_\_ Date \_\_\_\_\_

COAL WAS ENCOUNTERED AT 540 FEET \_\_\_\_\_ INCHES  
\_\_\_\_\_ FEET \_\_\_\_\_ INCHES FEET \_\_\_\_\_ INCHES  
\_\_\_\_\_ FEET \_\_\_\_\_ INCHES FEET \_\_\_\_\_ INCHES

Formation	Color	Hard or Soft	Top	Bottom	Oil, Gas or Water	Depth Found	Remarks
<u>Coal</u>			<u>715</u>				
Big Ingun			1900				
Oil			1978				
Total Depth			1998				



