

1900083P

WW-7
8-30-06



West Virginia Department of Environmental Protection
Office of Oil and Gas
WELL LOCATION FORM: GPS

API: 47-019-00083 WELL NO.: WV 461221 Brown 9763

FARM NAME: Brown

RESPONSIBLE PARTY NAME: EQT Production Company

COUNTY: Fayette DISTRICT: Valley

QUADRANGLE: Gauley Bridge 7.5'

SURFACE OWNER: Big Creek Land Company

ROYALTY OWNER: Big Creek Land Company

UTM GPS NORTHING: 4226973

UTM GPS EASTING: 483110 GPS ELEVATION: 249 m (817 ft)

The Responsible Party named above has chosen to submit GPS coordinates in lieu of preparing a new well location plat for a plugging permit or assigned API number on the above well. The Office of Oil and Gas will not accept GPS coordinates that do not meet the following requirements:

- Datum: NAD 1983, Zone: 17 North, Coordinate Units: meters, Altitude: height above mean sea level (MSL) – meters.
- Accuracy to Datum – 3.05 meters
- Data Collection Method:
Survey grade GPS : Post Processed Differential
Real-Time Differential
Mapping Grade GPS X: Post Processed Differential X
Real-Time Differential

4. **Letter size copy of the topography map showing the well location.**

I the undersigned, hereby certify this data is correct to the best of my knowledge and belief and shows all the information required by law and the regulations issued and prescribed by the Office of Oil and Gas.

Ben A. Saylor
Signature

P.S. 2092
Title

3-7-13
Date

RECEIVED
Office of Oil and Gas

Department of Environmental Protection
05/03/2013

Topo Quad: Gauley Bridge 7.5' Scale: 1" = 2000'
 County: Fayette Date: February 26, 2013
 District: Valley Project No: 57-05-00-07

WV 461221 Brown 9763

Topo

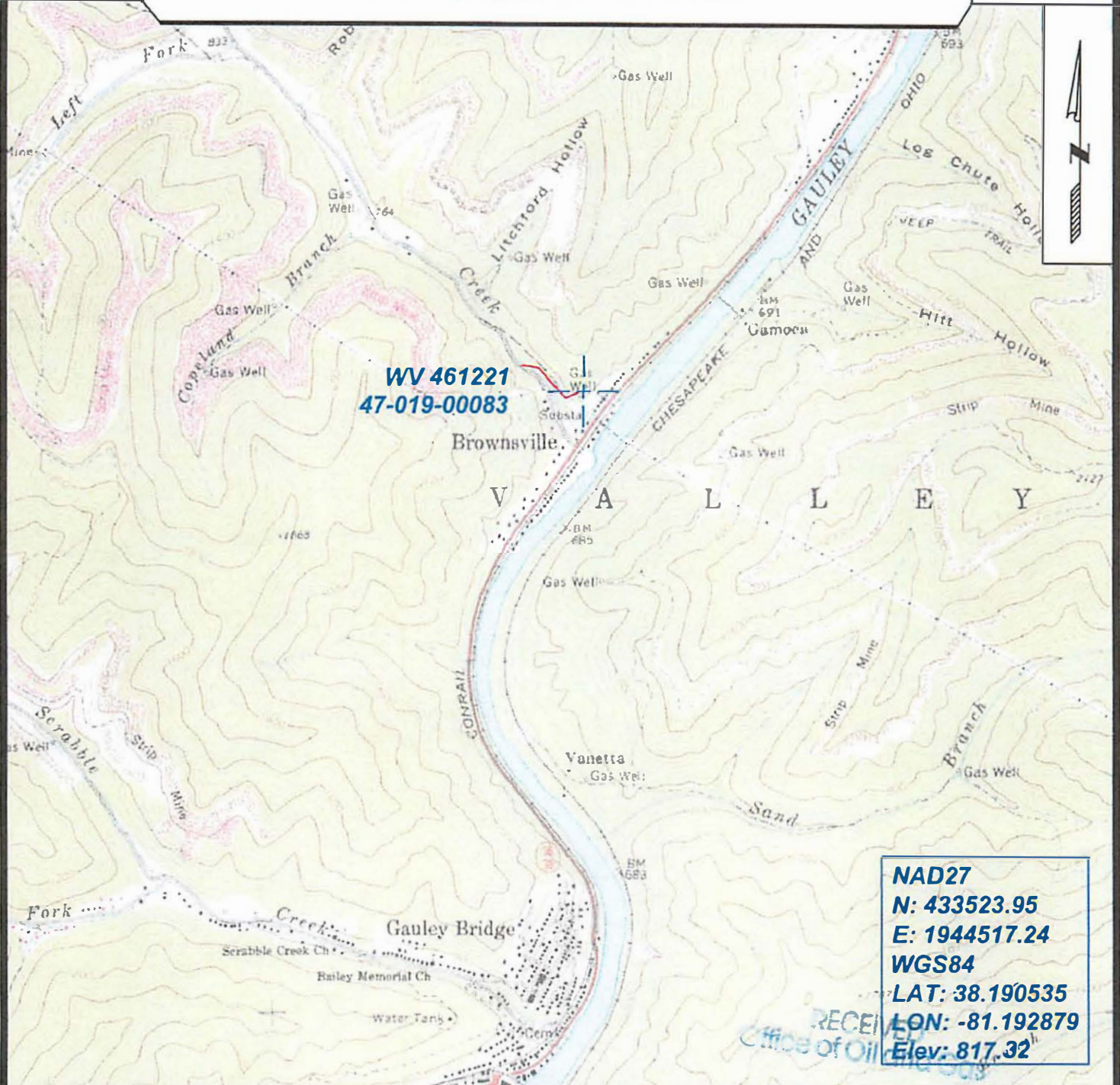

WV 461221
47-019-00083

NAD27
N: 433523.95
E: 1944517.24
WGS84
LAT: 38.190535
LON: -81.192879
Elev: 817.32'



SURVEYING AND MAPPING SERVICES PERFORMED BY:
ALLEGHENY SURVEYS, INC.
 1-800-482-8606
 P.O. BOX 438
 BIRCH RIVER, WV 26610
 PH: (304) 649-8606
 FAX: (304) 649-8608

PREPARED FOR: ADD 1 5 2013
EQT Production Co. Inc.
 1710 Pennsylvania Ave.
 Charleston, WV 25302