

LATITUDE 39° 00' 00"

LONGITUDE 100° 55' 08"

2.34a
1.05w

7'5 OGIS topo location

7.5' loc _____ 15' loc _____
(calc.) _____

Company _____

Farm _____

Quad TANNER 7'2

County Gilmer

District Detalb

WELL LOCATION MAP

File No. 021-30015

WM. BENTLEY VILL. N. 1 - DEKALA DISTRICT, STICLER COUNTY, WEST VIRGINIA.

ENGINEER'S CERTIFICATE

I, the undersigned, hereby certify that this map is correct and shows all the information to the best of my knowledge and belief as required by the oil and gas section of the mining laws of West Virginia.

Paul Johnson
Engineer

Acknowledged before me a Notary Public this 18th day of February, 1931.
My commission expires on the 30th day of March, 1931.

John F. Wiseman
Notary Public
JOHN F. WISEMAN, NOTARY PUBLIC,
MY COMMISSION EXPIRES MAR. 30, 1931

Plot 15-A

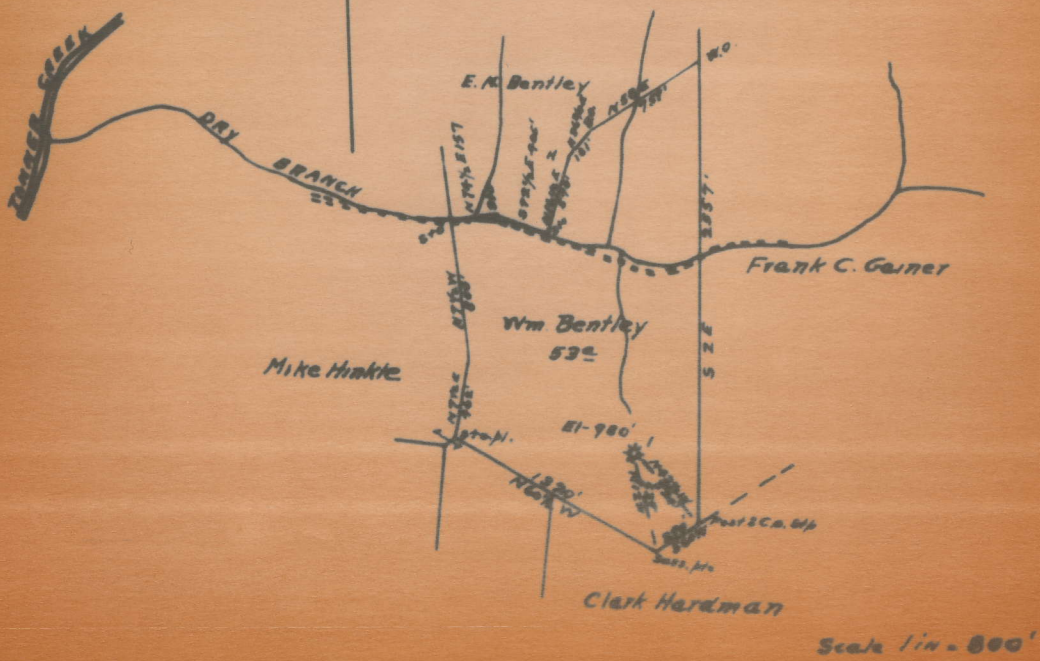

DeKalb District, Gilmer County, W. Va. 15A
 South Penn Oil Co., P. O. Drawer 1255, Pittsburgh, Pa.
 On 53 acres, surface and mineral rights owned by Francis Gainer,
 R. F. D. No. 4, Clarksburg, W. Va., and ~~mineral rights owned by~~
 Vincent Gainer, Tunnelton, W. Va.

Elevation, 980' L.

14' conductor; 10" casing, 165'; 8 $\frac{1}{4}$ " casing, 890'; 6-5/8" casing, 1796'.

Packer, 2 x 6-5/8 x 16, set at 1771'.

Packer, 2 x 6-5/8 x 16, set at 1788'.

No coal was encountered.

Abandonment reported to Dept. of Mines Feb. 27, 1931.

Well was not shot.

	Top.	Bottom.
Conductor	0	14
(10" casing, 165')		
Slate and shells	300	314
Red rock	314	494
Slate	494	777
Slate	777	782
Slate	782	795
Sand	795	800
Slate	800	870
Dunkard Sand (8 $\frac{1}{4}$ " casing, 880')	870	887
Slate and shells	887	980
Gas Sand	980	1066
Slate and red rock	1066	1131
1st Salt Sand	1131	1228
Slate	1228	1375
2nd Salt Sand	1375	1425
Slate	1425	1500
3rd Salt Sand	1500	1550
Slate	1550	1645
Maxton Sand (oil show, 1655-1665')	1645	1725
Slate and shells	1725	1775
Big Lime (6-5/8" casing, 1778')	1775	1870
(gas, 1822-1825')		
Big Injun Sand (gas, 1870-1873')	1870	1880
Total depth		1898

WM. BENTLEY WELL NO. 1 - DEKALB DISTRICT, GILMER COUNTY, W. VA.

SOUTH PENN OIL COMPANY

Company

COMPLETION DATA SHEET

P. O. DRAWER 1255

Address

NO. 2

PITTSBURGH, PA.

W. A.

FORMATION RECORD

Name	Color	Character	Oil, Gas or Water	Top	Bottom	Thickness	Total Depth	Remarks
Conductor							14	
10" Casing							165	
Slate & Shells				300			314	
Red Rock				314	494		494	
Slate				494	777		777	
Slate				777	785		785	
Slate				785	795		795	
Sand				795	830		830	
Slate				830	870		870	
Dunkard Sand				870	907		907	
8 1/2" Casing							940	
Slate & Shells				907	940		940	
Gas Sand				940	1080		1080	
Slate & Red Rock				1080	1100		1100	
1st. Salt Sand				1100	1080		1080	
Slate				1080	1074		1074	
2nd. Salt Sand				1074	1054		1054	
Slate				1054	1033		1033	
3rd. Salt Sand				1033	1100		1100	
Slate				1100	1080		1080	
Maxon Sand				1080	1040		1040	
			Oil above	1040	1040		1040	
Slate & Shells				1040	1040		1040	
Big Lime				1040	1040		1040	
6 5/8" Casing				1040	1040		1040	
			Gas	1040	1040		1040	
Big Injun				1040	1040		1040	
			Gas	1040	1040		1040	
TOTAL DEPTH							1040	

Well was shut down at _____ Date well was shut at _____

By _____ Date _____

AFFIDAVIT IN TRIPPLICATE TO TIME AND MANNER OF PLUGGING AND FILLING WELL

(REQUIRED BY SECTION 9, CHAPTER 26, ACTS 1935)

WEST VIRGINIA DEPARTMENT OF MINES OIL AND GAS SECTION

oil 15 A

WELL RECORD OF THIS WELL SHOWS NO COAL

SOUTH PENN OIL COMPANY

COAL OPERATOR

NAME OF WELL OPERATOR

P. O. Drawer 1255, Pittsburgh, Pa.

ADDRESS

COMPLETE ADDRESS

May 20, 19 31

COAL OPERATOR

WELL AND LOCATION

ADDRESS

Dekalb District

Gilmer County

COAL OPERATOR

Well No. 1

ADDRESS

E. M. Bentley Farm

AFFIDAVIT TO BE MADE IN TRIPPLICATE AND ONE COPY TO BE FILED BY DEPARTMENT OF MINES AND GEOLOGICAL SURVEY TO BE RETURNED BY THE WELL OPERATOR AND THE OTHER COPY TO BE KEPT BY DEPARTMENT OF MINES AND GEOLOGICAL SURVEY TO BE FILED IN EACH COAL OPERATOR'S BOOKS AT THEIR RESPECTIVE OFFICES

AFFIDAVIT

STATE OF WEST VIRGINIA

COUNTY OF Roane

John Starkey

ss

ss

being first duly sworn according to law do depose and say that they are experienced in the work of plugging

and filling oil and gas wells and were employed by SOUTH PENN OIL COMPANY well operator and participated in the work of plugging and filling the above well, that said work was commenced on the

day of 19 31 and that the well was plugged and filled in the following manner:

Manner in which well was plugged. Total depth of well 2015'. Filled up with non-porous sediment to 1940'. Drove 5 3/16" x 3' Common Wood Dry Hole Plug to 1945'. Filled up with iron to 1944'. Shut 2" Niles shut-off Valve on 140' 2" Line Pipe and 5 3/16" x 2" Gas Anchor Packer. Packer set at 1937'. Niles valve set at 1930'. Filled up on top of Packer with 25' cement. Let cement set 24 hours. Shut Niles valve. Filled up with non-porous sediment to 1700'. Drove 4 5/8" x 3' Common Wood Dry Hole Plug to 1700'. Filled up to 1700' with non-porous sediment. Gave 24 hr. fire test and showed no gas. Pulled 4 5/8"

Manner in which well was plugged. Casing. Drove 4 1/2" x 3' Common Wood Dry Hole Plug to 1125'. Filled with non-porous sediment to 950'. Pulled 4 1/2" casing. Drove 10" x 3' Common Wood Dry Hole Plug to 417'. Filled up with non-porous sediment to within 9 feet of top of hole.

Description of monument. Placed piece of 4 1/2" casing 14 ft. long in hole for marker. Filled up with rock inside of casing to within 1 foot of top and rock around casing to top of ground. One foot cement placed in top of marker.

and that the work of plugging and filling said well was completed on the 1st day of May

210

WEST VIRGINIA DEPARTMENT OF MINES

Oil and Gas Section

PRELIMINARY DATA SHEET NO. 1

File No.

Oil - 5-A

Well No. **1**

SOUTH PEN OIL

Company of **P. O. DRAVER 1255, PITTSBURGH, PA.**

on the **Wm. Bentley** Farm

containing **53** acres Location

Dekalb

District, in

Gilmer

County, West Virginia.

Francis Gainer
Vincent Gainer

The surface of the above tract is owned in fee by
R. F. D. #4, Clarksburg, W. Va.
of **Tunnelton, W. Va.**

Francis Gainer
Vincent Gainer

address, and the mineral rights are owned by
R. F. D. #4, Clarksburg, W. Va.
Tunnelton, W. Va.

The oil and gas privileges held under lease by the above named company, and this well is drilled under permit No. _____ issued by the West Virginia Department of Mines, Oil and Gas Section,

19_____

Elevation of surface at top of well,

980

Spirit
Barometric.

The number of feet of the different sized casings used in the well.

14

feet

size. Wood conductor

165

feet

10"

size, casing

feet

sized casing

690

feet

8 1/2"

size, casing

feet

sized casing

1796

feet

5/8"

size, casing

feet

sized casing

packer of **2" x 5/8 x 16**

size, set at

1771

packer of **2" x 5/8 x 16**

size, set at

1786

Casing perforated at

feet to

feet

Casing perforated at

feet to

feet

Coal was encountered at

725

feet; thickness

inches, and at

feet; thickness

inches; and at

feet; thickness

inches

Liners were used as follows: (Give details)