

**USGS LOCATION MAP**

PREPARED FOR

WC Halterman Estate 1

GRANT COUNTY, WEST VIRGINIA  
BLACKBIRD KNOB USGS QUAD

PROJECT -	WC Halterman Estate 1
DATE -	1/23/2024
SCALE -	1" = 2,000'
DRAWN -	JKANE
FILE -	WC_HALTERMAN_ESTATE_1_USGS_LOCATION_MAP.mxd



(844) 542-4757  
**04/19/2024**



STATE PLANE  
GRID NORTH  
NAD 83

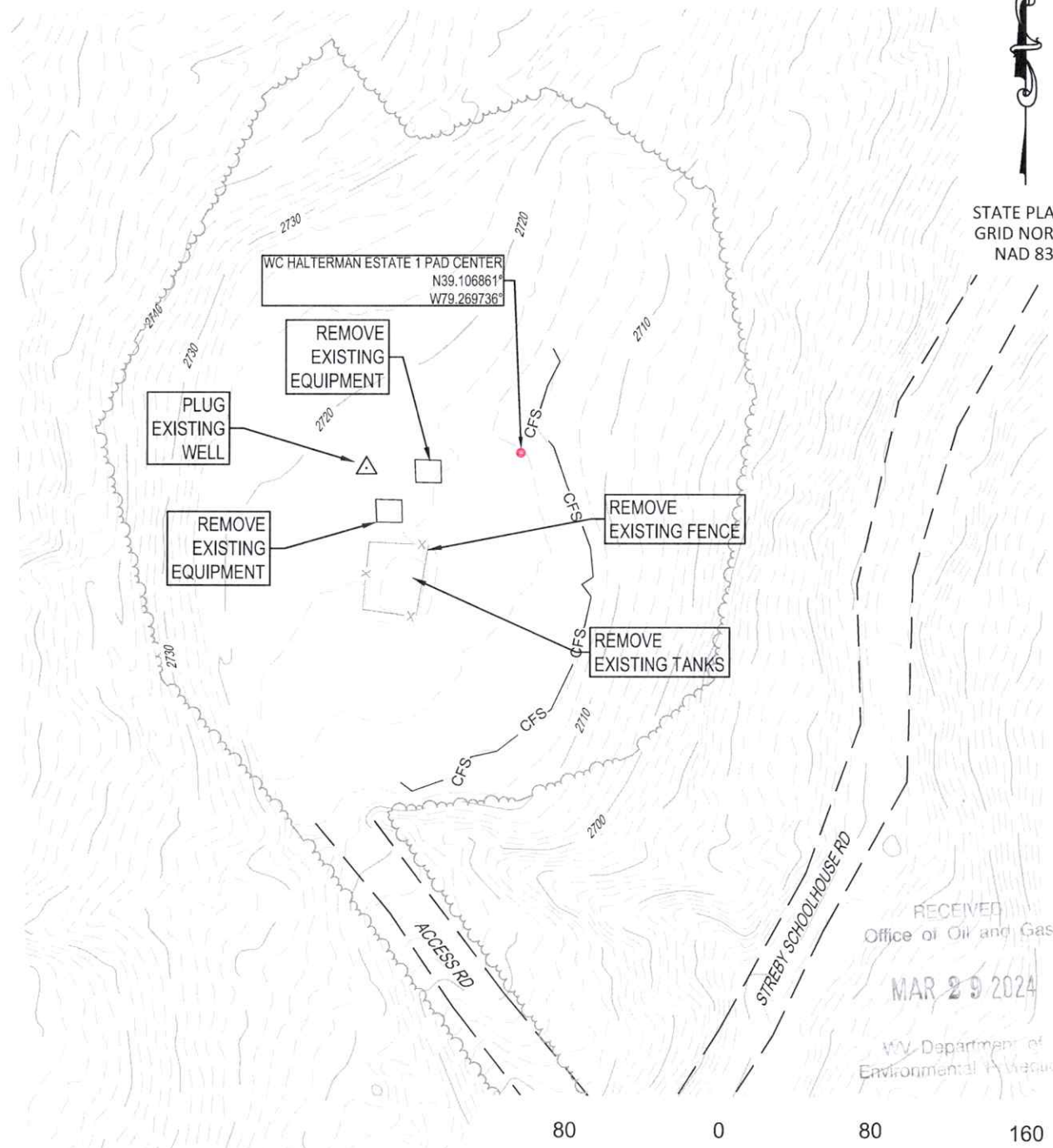

RECEIVED  
Office of Oil and Gas  
MAR 29 2024  
WV Department of  
Environmental Protection



SCALE IN FEET

NOTE: ALL PRODUCTION FACILITIES  
WILL BE REMOVED UPON COMPLETION  
OF THE PLUGGING OPERATIONS.

WC HALTERMAN ESTATE 1  
SITE RECLAMATION API# 47-023-00023  
FOR  
CHESAPEAKE ENERGY  
LOCATED IN  
GRANT COUNTY, WEST VIRGINIA  
UNION DISTRICT  
SOUTH BRANCH POTOMAC (2070001) WATERSHED

SITE PLAN

LEGEND

- EXISTING CONTOUR
- EXISTING TREE LINE
- EXISTING PRIVATE ROAD EDGE
- WELLHEAD
- COMPOSITE FILTER SOCK



WWW.JHACOMPANIES.COM  
844-542-4757  
466 SOUTH MAIN STREET  
MONTROSE, PA 18801  
PA • OH • NY • WV • VA • MD

PLAN NUMBER	DATE	NO.
FINAL	01/23/2024	1

04/19/2024

WW-7  
8-30-06



West Virginia Department of Environmental Protection  
Office of Oil and Gas  
**WELL LOCATION FORM: GPS**

API: 47-023-00023 WELL NO.: 821717

FARM NAME: WC HALTERMAN ESTATE

RESPONSIBLE PARTY NAME: CHESAPEAKE APPALACHIA LLC

COUNTY: GRANT DISTRICT: UNION

QUADRANGLE: BLACKBIRD KNOB

SURFACE OWNER: CARROLL B COOK AND DONNA T COOK

ROYALTY OWNER: CARROLL B COOK AND DONNA T COOK

UTM GPS NORTHING: 4330055.595

UTM GPS EASTING: 649589.161 GPS ELEVATION: 2720

The Responsible Party named above has chosen to submit GPS coordinates in lieu of preparing a new well location plat for a plugging permit or assigned API number on the above well. The Office of Oil and Gas will not accept GPS coordinates that do not meet the following requirements:

1. Datum: NAD 1983, Zone: 17 North, Coordinate Units: meters, Altitude: height above mean sea level (MSL) – meters.
2. Accuracy to Datum – 3.05 meters
3. Data Collection Method:

Survey grade GPS  : Post Processed Differential

Real-Time Differential

Mapping Grade GPS  : Post Processed Differential

Real-Time Differential

4. Letter size copy of the topography map showing the well location.

I the undersigned, hereby certify this data is correct to the best of my knowledge and belief and shows all the information required by law and the regulations issued and prescribed by the Office of Oil and Gas.

Keri Leno  
Signature

REGULATORY SPECIALIST  
Title

3/21/24  
Date

RECEIVED  
Office of Oil and Gas

MAR 29 2024

West Virginia Department of  
Environmental Protection

04/19/2024