

BOTTOM HOLE WELL NO. 1-H STATE PLANE COORDINATES NORTH ZONE (NAD'27)

N. 260,362 E. 2,074,370

LAT=(N) 39.21455 LONG=(W) 79.23753

UTM (NAD'83) N. 4,342,078 E. 652,179

JACK L. & WENDY C. COMP 10.14 ACRES±

ALLEGHENY MINING CORPORATION LEASE 141.08 of 4,851.69 ACRES±

LANDING POINT WELL NO. 1-H STATE PLANE COORDINATES NORTH ZONE (NAD'27)

N. 257,699 E. 2,075,639

LAT=(N) 39.20723 LONG=(W) 79.23308

UTM (NAD'83) N. 4,341,273 E. 652,579

WELL NO. 1-H

ROBERT P. GILBERT ET AL 20 ACRES±

ROBERT P. GILBERT ET AL 54.50 ACRES±

ROBERT P. GILBERT ET AL 54.5 ACRES±

ROY H. JONES 29.22 ACRES±

ROY H. & PRICILLA A. JONES 47.50 ACRES±

ROY H. & PRICILLA A. JONES 56.50 ACRES±

WELL NO. 1-H STATE PLANE COORDINATES NORTH ZONE (NAD'27)

N. 257,291 E. 2,075,079

LAT=(N) 39.20611 LONG=(W) 79.23506

UTM (NAD'83) N. 4,341,145 E. 652,410

RUBY K. ALLISON, TRUSTEE 278.39 ACRES±

RUBY K. ALLISON, TRUSTEE 141.08 ACRES±

COY E. CAMPBELL, JR., ET AL 4.04 ACRES±

REFERENCES

SPECIAL NOTE: THIS PROPOSED WELL DOES MEET THE STATE REQUIREMENTS FOR A DEEP WELL BEING 400' FROM THE LEASE AND/OR UNIT BOUNDARY...

NOTES ON SURVEY

- 1. TIES TO WELLS, CORNERS AND REFERENCES ARE BASED ON GRID NORTH FOR THE WV STATE PLANE COORDINATE SYSTEM NORTH ZONE NAD '27.
2. LEASE BOUNDARY SHOWN HEREON TAKEN FROM DEED BOOK 150 PAGE 422.
3. SURFACE OWNER AND ADJOINER INFORMATION TAKEN FROM THE ASSESSOR AND COUNTY CLERK RECORDS OF GRANT COUNTY IN JUNE 2010.
4. WELL LAT./LONG. (NAD'27) ESTABLISHED BY DGPS(SUBMETER MAPPING GRADE).
5. PROPOSED WELL ALLEGHENY MINING #1-H IS OVER 400' FROM ANY LEASE BOUNDARY.

THERE APPEAR TO BE NO KNOWN PERMITTED WELLS WITHIN 3,000'.

WELL NO. 1-H

3000'



I THE UNDERSIGNED, HEREBY CERTIFY THAT THIS PLAT IS CORRECT TO THE BEST OF MY KNOWLEDGE AND BELIEF AND SHOWS ALL THE INFORMATION REQUIRED BY LAW AND THE REGULATIONS ISSUED AND PRESCRIBED BY THE DIVISION OF ENVIRONMENTAL PROTECTION.

P.S. 677

Gregory A. Smith

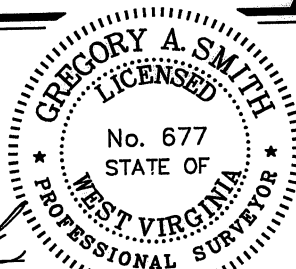

(+) DENOTES LOCATION OF WELL ON UNITED STATES TOPOGRAPHIC MAPS.

DATE JULY 27, 20 11

OPERATORS WELL NO. ALLEGHENY MINING CORPORATION #1-H

API WELL NO. 47 - 23 - 000354 STATE COUNTY PERMIT

MINIMUM DEGREE OF ACCURACY 1/2500 FILE NO. 7224Pwell1-HR2 (365-89) SCALE 1" = 1000' PROVEN SOURCE OF ELEVATION DGPS (SURVEY GRADE TIE CORS NETWORK)

STATE OF WEST VIRGINIA DIVISION OF ENVIRONMENTAL PROTECTION OFFICE OF OIL AND GAS

WELL TYPE: OIL GAS X LIQUID INJECTION WASTE DISPOSAL IF "GAS" PRODUCTION X STORAGE DEEP X SHALLOW

LOCATION: ELEVATION 3,204' GROUND/3,209' PROPOSED WATERSHED ABRAM CREEK DISTRICT UNION COUNTY GRANT QUADRANGLE GREENLAND GAP 7.5'

SURFACE OWNER RUBY K. ALLISON, TRUSTEE ACREAGE 141.08± ROYALTY OWNER ALLEGHENY MINING CORPORATION LEASE ACREAGE 141.08 of 4,851.69± LEASE NO.

PROPOSED WORK: DRILL X CONVERT DRILL DEEPER REDRILL FRACTURE OR STIMULATE X PLUG OFF OLD FORMATION PERFORATE NEW FORMATION PLUG AND ABANDON CLEAN OUT AND REPLUG OTHER

PHYSICAL CHANGE IN WELL (SPECIFY) TARGET FORMATION ORISKANY ESTIMATED DEPTH 11,500'+HORIZONTAL

WELL OPERATOR CARRIZO (MARCELLUS) WV, LLC. DESIGNATED AGENT CT CORPORATION ADDRESS 1000 LOUISIANA, SUITE 1500 HOUSTON, TX 77002 ADDRESS 5400 D BIG TYLER ROAD CHARLESTON, WV 25313

COUNTY NAME

PERMIT

ALLEGHENY MINING CORP. LEASE

WELL NO. 1-H

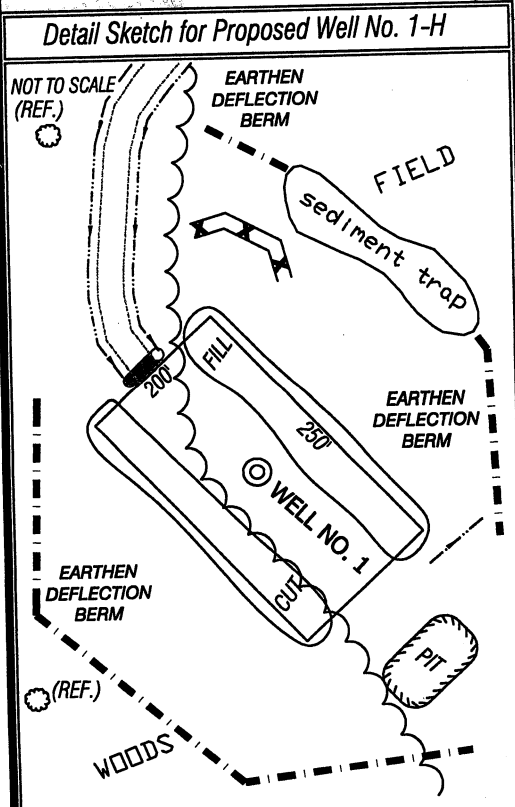
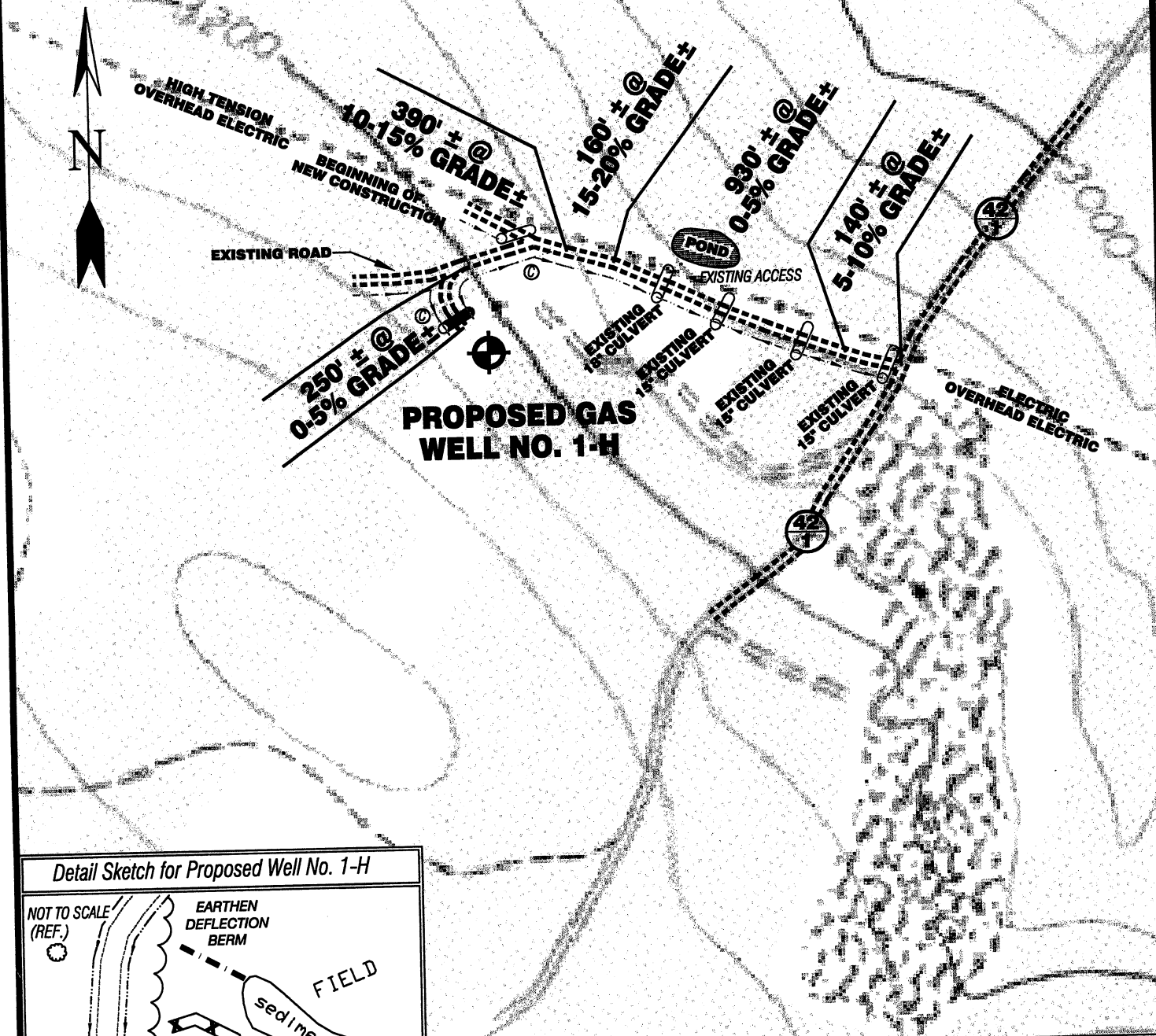

TOPO SECTION OF USGS GREENLAND GAP 7.5' QUADRANGLE

PROPOSED CULVERT INVENTORY (FOR BID PURPOSES ONLY)

15" (MINIMUM) CULVERTS	2 CUL.
------------------------	--------

ADDITIONAL CULVERTS AND/OR OTHER DRAINAGE STRUCTURES & SEDIMENT CONTROL DEVICES MAY BE REQUIRED BY THE WV D.E.P. OIL & GAS INSPECTOR. OPERATOR IS RESPONSIBLE FOR COORDINATION WITH CONTRACTOR AND SLS REGARDING ANY CHANGES OR ADDITIONS THE STATE MAY REQUIRE.

ALL ROADS SHOWN HEREON ARE EXISTING UNLESS OTHERWISE NOTED AND SHALL BE MAINTAINED IN ACCORDANCE WITH WV D.E.P. OIL AND GAS BMP MANUAL ENTRANCES AT COUNTY/STATE ROADS SHALL BE MAINTAINED IN ACCORDANCE WITH WV D.O.T. REGULATION. SEPARATE PERMITS MAY BE REQUIRED BY THE D.O.T.

SEDIMENT BASINS (TRAPS) AND APPROPRIATE EROSION CONTROL BARRIERS ARE TO BE CONSTRUCTED AT ALL CULVERT AND CROSS DRAIN INLETS AND OUTLETS AS REQUIRED IN THE WV D.E.P. OIL AND GAS BMP MANUAL. FIELD CONDITIONS (ROCK OUTCROPS AND BEDROCK) MAY PROHIBIT INLET TRAPS BEING INSTALLED. WHEN THESE CONDITIONS EXIST ADDITIONAL EROSION CONTROL MEASURES SHALL BE EVALUATED AND UTILIZED AS NEEDED.

EARTHWORK CONTRACTORS ARE RESPONSIBLE FOR NOTIFICATION TO THE OPERATOR AND INSPECTOR PRIOR TO ANY DEVIATION FROM THIS PLAN.

TEMPORARY SEED & MULCH ALL SLOPES AFTER CONSTRUCTION OF LOCATION.

CUT & STACK ALL MARKETABLE TIMBER.

STACKED BRUSH MAY BE USED FOR SEDIMENT CONTROL.

APPLICATIONS FOR SEPARATE PLC PERMITS ON THE ACCESS ROAD STREAM CROSSINGS HAVE BEEN PREPARED (IF APPLIES).

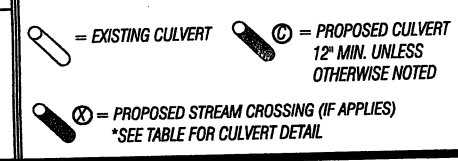

SLS

SMITH LAND SURVEYING, INC.
 P.O. BOX 150 GLENVILLE, WV. 26351
 PH: (304)462-5634 FAX: (304)462-5656 E-MAIL: sls@rtol.net

DRAWN BY	FILE NO.	DATE	CADD FILE:
D.L.P.	7224	08/18/09	7224REC1rev2.dwg