

Latitude 39° 15'

Longitude 80° 10'

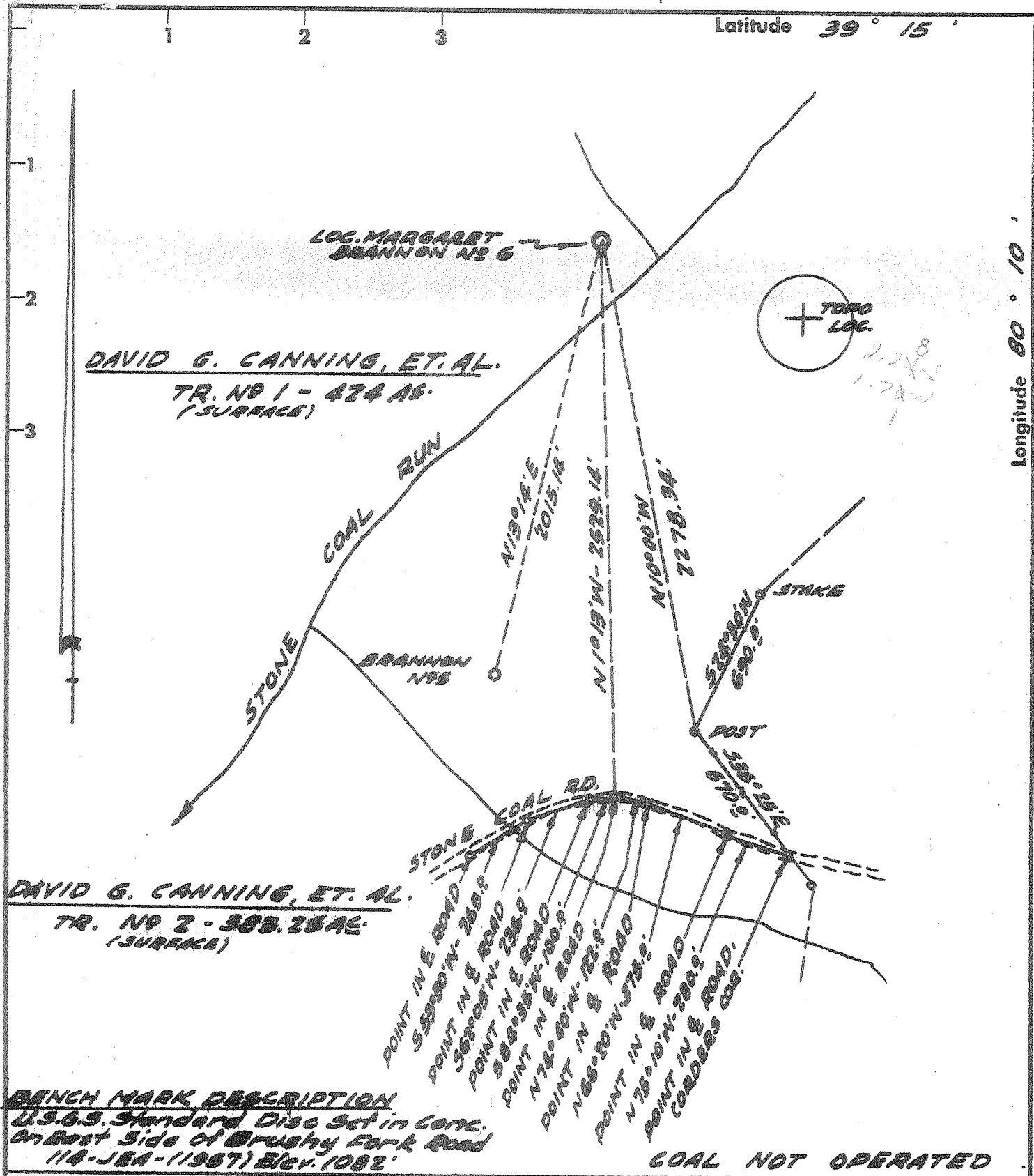

- Fracture Before 6/5/29
- New Location
- Drill Deeper
- Redrill
- Abandonment

I, the undersigned, hereby certify that this map is correct to the best of my knowledge and belief and shows all the information required by Paragraph 5 of the Rules and Regulations of the Oil and Gas Section of the Mining Laws of West Virginia.

The accuracy of this survey is within the limits and as prescribed in Paragraph 5 by the Oil and Gas Division of the Department of Mines Regulations.

Company **PATRICK PETROLEUM CORP.**

Address **CHARLESTON, W. VA.**

Farm **MARGARET BRANNON**

Tract 1 Acres **424** Lease No. \_\_\_\_\_

Well (Farm) No. 6 Serial No. \_\_\_\_\_

Elevation (Spirit Level) **1164.60'**

Quadrangle **PHILIPPI, W. VA. NW**

County **HARRISON** District **SIMPSON**

Surveyor **Jarvis A. Cledemius**

Surveyor's Registration No. **259**

File No. **4-19** Drawing No. \_\_\_\_\_

Date **MAY 14 '73** Scale **1" = 600'**

STATE OF WEST VIRGINIA  
DEPARTMENT OF MINES  
OIL AND GAS DIVISION  
CHARLESTON

**WELL LOCATION MAP**

FILE NO. **HAR-702**

+ Denotes location of well on United States Topographic Maps, scale 1 to 62,500 latitude and longitude lines being represented by border lines as shown.

- Denotes one inch spaces on border line of original tracing.

47033



STATE OF WEST VIRGINIA  
DEPARTMENT OF MINES  
**Oil and Gas Division**  
**WELL RECORD**

Quadrangle Phillipi

Permit No. Har-702

Rotary  Oil  
Cable \_\_\_\_\_ Gas   
Recycling \_\_\_\_\_ Comb. \_\_\_\_\_  
Water Flood \_\_\_\_\_ Storage \_\_\_\_\_  
Disposal \_\_\_\_\_ (Kind)

Company PATRICK PETROLEUM CORPORATION

Address 901 Nelson Bldg.

Farm Margaret Brannon Acres 424

Location (waters) Brushy Fork

Well No. 6 Elev. 1164.60

District Simpson County Harrison

The surface of tract is owned in fee by Margaret Brannon

Address Same

Mineral rights are owned by Same

Address \_\_\_\_\_

Drilling Commenced 6-19-73

Drilling Completed 6-24-73

Initial open flow 118,000 cu. ft. 1 3/4 OR

Final production 2,316,000 cu. ft. per day \_\_\_\_\_ bbls.

Well open 2 1/2 hrs. before test 1900 lbs

Well treatment details:

W/750 gal reg. 15% acid, 40,000 sd, Treatment water 640 bbls.

Attach copy of cementing record.

Treatment water 640 bbls.

Coal was encountered at \_\_\_\_\_ Feet \_\_\_\_\_ Inches  
Fresh water 35 & 120 Feet \_\_\_\_\_ Inches  
Producing Sand Benson Salt Water \_\_\_\_\_ Feet  
Depth 4294-4354

Formation	Color	Hard or Soft	Top Feet	Bottom Feet	Oil, Gas or Water	* Remarks
Top			0	20		
Sh & SD			20	1360		
<del>Lime - Biglime</del>			1382	1500		
<del>Injun</del>			1500	1556		
Sh & Sd			1556	1840		
<del>Gantz &amp; Fifty ft.</del>			1840	1896		
SD & SH			1896	2222		
<del>Fourth</del>			2222	2300		
Shale			2300	2340		
<del>Fifth</del>			2340	2380		
Sd & SH			2380	3036		
Shale			3036	4294		
<del>Benson</del>			4294	4354		
Shale			4354	-----		
TD			-----	4419		
				(410)		

Water 35' & 120

\* Indicates Electric Log tops in the remarks section.

(over)



STATE OF WEST VIRGINIA  
DEPARTMENT OF MINES

RECEIVED

JUN 8 1973

OIL & GAS DIVISION  
DEPT. OF MINES

Oil and Gas Division

OIL AND GAS WELL PERMIT APPLICATION

TO THE DEPARTMENT OF MINES,  
Charleston, W. Va.

Surface Owner Margaret Brannon  
Address Clarksburg, West Virginia  
Mineral Owner Same  
Address \_\_\_\_\_  
Coal Owner Same  
Address \_\_\_\_\_  
Coal Operator Same  
Address \_\_\_\_\_

DATE May 22, 1973  
Company PATRICK PETROLEUM CORPORATION  
Address Suite 901 Nelson Building  
Charleston, West Virginia  
Farm Margaret Brannon Acres 424  
Location (waters) Stone Coal Run of Brusky Fk.  
Well No. Six (6) Elevation 1164.60'  
District Simpson County Harrison  
Quadrangle Phillipi

Inspector to be notified:  
Bill Blosser  
Box 1857  
Colfax, West Virginia  
Tel: 363-9105 - Fairmont

THIS PERMIT MUST BE POSTED AT THE WELL SITE  
All provisions being in accordance with Chapter 22,  
of the W. Va. Code, the location is hereby approved  
for Drilling. This permit shall expire if  
operations have not commenced by 10-8-73.

Robert S. [Signature]  
Deputy Director - Oil & Gas Division

GENTLEMEN:

The undersigned well operator is entitled to drill upon the above named farm or tract of land for oil and gas, having fee title thereto, (or as the case may be) under grant or lease dated December 1 1925 by Margaret Coplin Brannon <sup>widow</sup> made to Grasselli Chemical Co. and recorded on the 24th day of Dec. 1925, in Harrison County, Book 363 Page 98  
 NEW WELL \_\_\_\_\_ DRILL DEEPER \_\_\_\_\_ REDRILL \_\_\_\_\_ FRACTURE OR STIMULATE  
\_\_\_\_\_ OIL AND GAS WELL ORIGINALLY DRILLED BEFORE JUNE 5, 1969.

The enclosed plat was prepared by a registered engineer or licensed land surveyor and all coal owners and/or operators have been notified as of the above date.

The above named coal owners and/or operator are hereby notified that any objection they wish to make, or are required to make by Section 3 of the Code, must be received by, or filed with the Department of Mines within ten (10) days. \*

Copies of this notice and the enclosed plat were mailed by registered mail, or delivered to the above named coal operators or coal owners at their above shown respective address \_\_\_\_\_ day \_\_\_\_\_ before, or on the same day with the mailing or delivery of this copy to the Department of Mines at Charleston, West Virginia.

Very truly yours, PATRICK PETROLEUM CORPORATION

(Sign Name) [Signature]  
Well Operator

Address  
of  
Well Operator

Suite 901 Nelson Building  
Street  
Charleston, West Virginia  
City or Town

State

\*SECTION 3 . . . . If no objections are filed or found by the Department of mines, within said period of ten days from the receipt of notice and plat by the department of mines, to said proposed location, the department shall forthwith issue to the well operator a permit reciting the filing of such plat, that no objections have been made by the coal operators or found thereto by the department and that the same is approved and the well operator authorized to proceed.

BLANKET BOND

HAR-702 PERMIT NUMBER

47 033

THIS IS AN ESTIMATE ONLY  
ACTUAL INFORMATION WILL BE SUBMITTED ON OG-10 UPON COMPLETION

PROPOSED WORK ORDER TO  DRILL \_\_\_\_\_ DEEPEN \_\_\_\_\_ FRACTURE-STIMULATE \_\_\_\_\_  
 DRILLING CONTRACTOR: (If Known) RESPONSIBLE AGENT:  
 NAME Burdette Drilling Company NAME Donald C. Supcoe  
 ADDRESS 7 1/2 Spring St. Charleston W. Va ADDRESS Charleston, West Virginia  
 TELEPHONE \_\_\_\_\_ TELEPHONE \_\_\_\_\_  
 ESTIMATED DEPTH OF COMPLETED WELL: 4500' ROTARY  CABLE TOOLS \_\_\_\_\_  
 PROPOSED GEOLOGICAL FORMATION: Benson  
 TYPE OF WELL: OIL \_\_\_\_\_ GAS \_\_\_\_\_ COMB. \_\_\_\_\_ STORAGE \_\_\_\_\_ DISPOSAL \_\_\_\_\_  
 RECYCLING \_\_\_\_\_ WATER FLOOD \_\_\_\_\_ OTHER \_\_\_\_\_

TENTATIVE CASING PROGRAM:

CASING AND TUBING SIZE	USED FOR DRILLING	LEFT IN WELL	CEMENT FILL UP OR SACKS - CUBIC FT.
20 - 16			
13 - 10 5/8"	60'	60'	Cmt. to surface
9 - 5/8			
8 - 5/8	1400'	1400'	Cmt. to surface
7			
5 1/2			
4 1/2	To be determined by logs		
3			Perf. Top
2			Perf. Bottom
Liners			Perf. Top
			Perf. Bottom

APPROXIMATE FRESH WATER DEPTHS \_\_\_\_\_ FEET SALT WATER \_\_\_\_\_ FEET  
 APPROXIMATE COAL DEPTHS \_\_\_\_\_  
 IS COAL BEING MINED IN THE AREA? Not Operated BY WHOM? \_\_\_\_\_

TO DRILL:

SUBMIT FIVE (5) COPIES OF OG - 1, \$100.00 PERMIT FEE, PERFORMANCE BOND AND PERMANENT COPY OF PLAT.

TO DRILL DEEPER OR REDRILL:

SUBMIT FIVE (5) COPIES OF OG - 1, SHOWING ORIGINAL PERMIT NUMBER AND PERFORMANCE BOND. ON WELLS DRILLED PRIOR TO 1929, A PERMANENT COPY OF THE PLAT AND THE ORIGINAL WELL RECORD MUST ALSO BE SUBMITTED.

TO FRACTURE - STIMULATE:

OIL AND/OR GAS WELL ORIGINALLY DRILLED BEFORE JUNE 5, 1929, FIVE (5) COPIES OG - 1, PERFORMANCE BOND, PERMANENT PLAT AND ORIGINAL WELL RECORD.

OIL AND/OR GAS WELL ORIGINALLY DRILLED ON AND/OR AFTER JUNE 5, 1929, FIVE COPIES OG - 1, SHOWING ORIGINAL PERMIT NUMBER, AND PERFORMANCE BOND.

Required forms must be filed within ninety (90) days of completion for bond release. Inspector to be notified twenty-four (24) hours in advance.

The following waiver must be completed by the coal operator if the permit is to be issued within ten days of receipt thereof.

WAIVER: I the undersigned, Agent for \_\_\_\_\_ Coal Company, Owner or Operator of the coal under this lease have examined and place on our mine maps this proposed well location.

We the \_\_\_\_\_ Coal Company have no objections to said well being drilled at this location, providing operator has complied with all rules and regulations in Articles 4, 5, and 7, Chapter 22 of the West Virginia Code.

\_\_\_\_\_  
For Coal Company

\_\_\_\_\_  
Official Title