

7

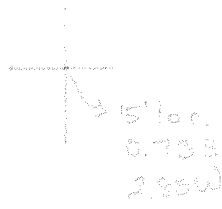

30' 15" 15'

10-55

Wolf Summit 7.5' quad

Harrison 1265

Clerksburg 15' sc

Elevation 1150' Topo est. (7.5)

6-6 Brown-Lumberport (104)

LOCATION FOR WELL No. 223

Buffalo DISTRICT.

On Joseph Hammond Farm, on waters of Lambert Run

Eagle District, Harrison County, West Virginia.

Lease No. 2138 Acres Range: N. S. 10 E. 13 W.

Scale 1" = 80' Made Dec 22nd 1909

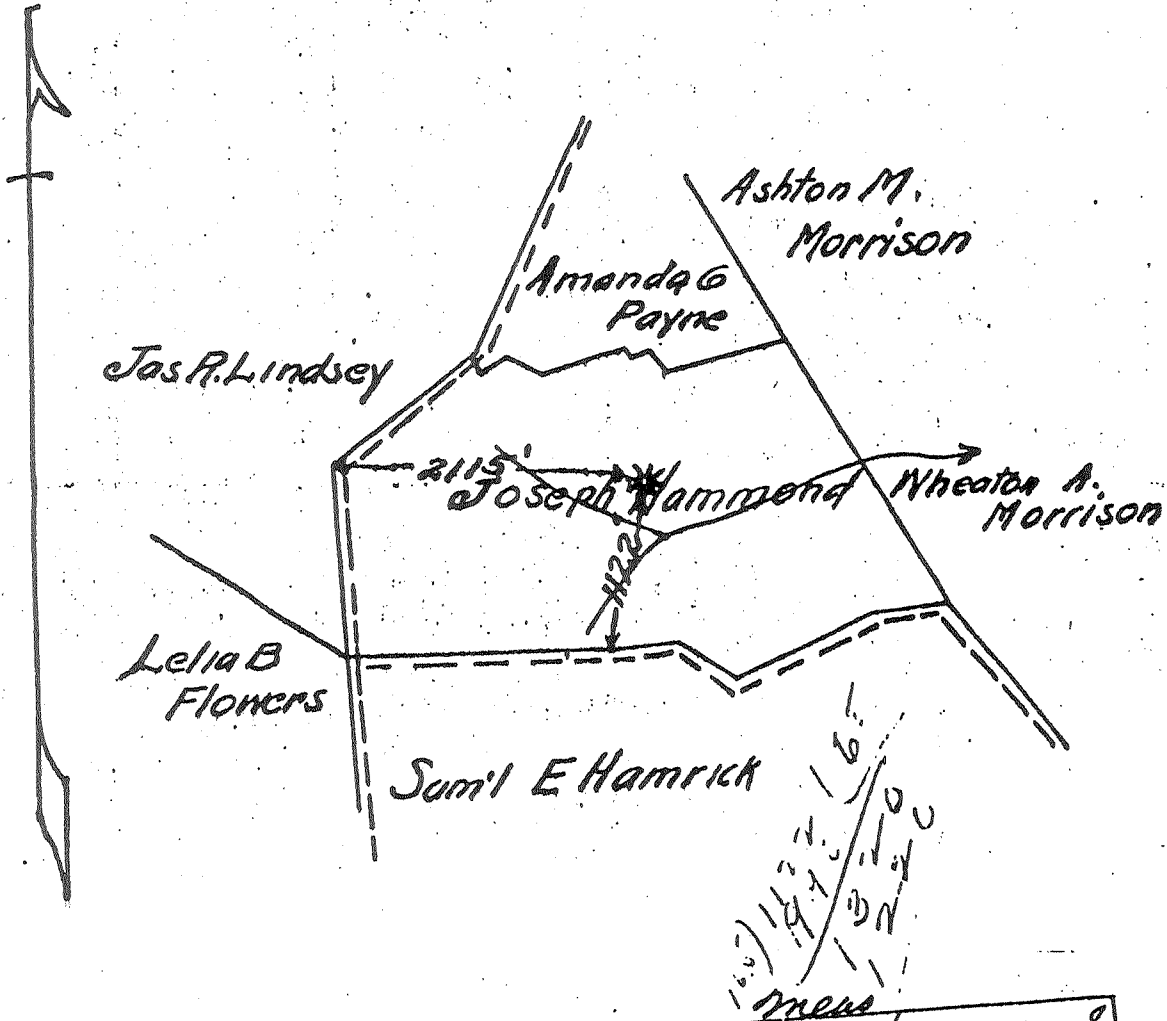

LOCATION MADE	Dec. 22. 1908.
BY	Richard Scott
As per plat. Except as noted	
On Field Map	19
Returned to Pittsburg	19

RESERVE:

SPECIAL INSTRUCTIONS:

033-1265

223

WELL RECORD.

Joseph Hammond Farm Acres
 Eagle District Harrison County Mo. State

Well No. (223)
 Rig Commenced June 16 1901 } W. H. Ross Co. Contractor.
 Rig Completed June 27 1901 }
 Drilling Commenced June 26 1901 } J. B. Barwell Contractor.
 Drilling Completed Sept 12 1901 }

ROCK FORMATION.	TOP	BOTTOM.	REMARKS.
Conductor		16	Started drilling
Dunkard Sand	500	750	at bottom of Pipe
Gas Sand	780	900	Coal
Salt Sand	900	1015	
Wagon Sand	1272	1530	
Loam	1297		
Big Limestone	1371	1425	
Big Limestone	1425	1525	
50 ft Sand	1955	1980	
Clay Sand	2060	2090	
Shale Sand	2137	2152	
11th Limestone	2185	2205	
5th Sand	2400	2400	
Depth		2490	

CASING RECORD.

Size.	Charged to Well.		Put in Well.		Pulled Out.		Left in Well.		Transferred Before Completion.		Left at Well, Not in Use.	
	Feet	In	Feet	In	Feet	In	Feet	In	Feet	In	Feet	In
10	581	2	520				520				61	2
8 1/4	1281	3	1055				1055				226	3
6 7/8	1716		1478				1478				238	

Production First 24 hours } 2.5 Bbls. Approved by J. P. [Signature] Supt.

NOTE.—Sum of three right hand columns equals First or "Charged to Well." Use as many sheets as necessary to make a complete record.