

HOPE NATURAL GAS COMPANY.

LOCATION FOR WELL No. 1291

Buffalo DISTRICT

Marion A. Tetrick Farm, on waters of *West Fork River*

Clay District, *Harrison* County, West Virginia.

Case No. *4640* Acres *66* N. S. *4* E. *17* W.

Scale, one inch equals *80 Poles* Sent to *N.Y.C. 6-7-1909*

Location to be *400 feet from Riley Cunningham farm*
line and 550 feet from Lucas Bros. farm line.

Shinnston 7.5-minute quadrangle
39.408578, -80.305797
39 25 .56 miles South
-80 17.5 .77 miles West

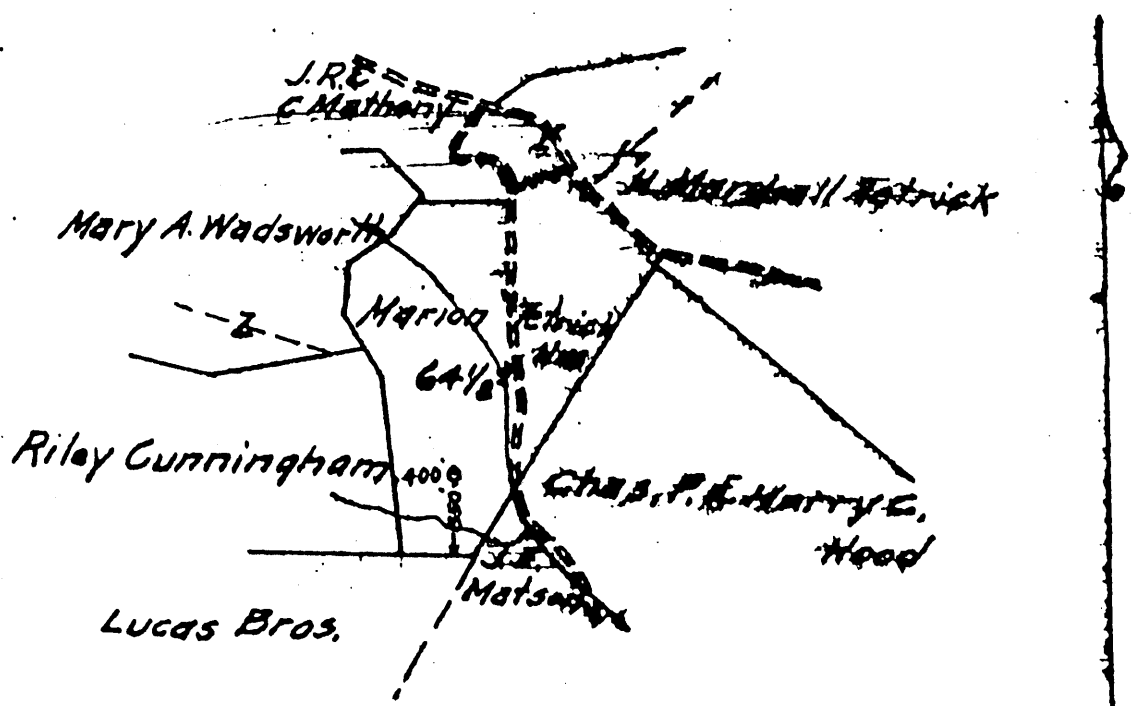

ENTERED
INDEXED
FILED
MAY 19 1909
U.S. DEPT. OF THE INTERIOR
GEOLOGICAL SURVEY

033-1296

ENTERED
LINE MAP
6-28-1909
C. R.

RESERVE *Two hundred feet around the*
well always

SPECIAL INSTRUCTIONS *Complete well work before*
Aug. 16. 1909

Location made *6-11-1909* by *J.P. McClintock* per plat, except as noted. On field map

6-11-09 Returned to Pittsburgh *1* 1909

Location changed on account of _____

Authorized by _____ Date _____ Signed _____

Well No. 1291 Lease No. Name MARION A. TETRIK District
 District Clay County HARRISON State

Location Made..... First Work Done.....
 Rig Commenced..... Rig Completed.....
 Drilling Commenced..... Drilling Completed OCT. 8, 1909
 Rig Contractor { Drilling Contractor }
 Drillers..... { If N. N. G. Co. Tools, String No. }
 Tool Dressers.....

FORMATION	Open or Close Hard or Soft	TOP	BOTTOM	Steel Line Measurements	Water Found Depth	Oil Found Depth	Gas Found Depth	REMARKS
Native Coal								
Pittsburgh Coal		212	219					
Dunkard		600	740					
Big Dunkard								
Gas Sand								
Salt		1010	1252					
Second Salt								
Third Salt								
Maxon		1315	1368					
Little Lime								
Pencil Cave								
Big Lime								
Keener								
Big Injun		1608	1702					
Squaw								
Weir								
Berea								
Gantz								
Fifty Foot		2080	2112					
Thirty Foot		2128	2235				2153	
Gordon Stray								
Gordon		2436	2466			2450-54		
Fourth								
Fifth		2583	2612				2586 2590 2593	
Total Depth			2595					
Trilled Pocket 5/23/05?			2654.5					
Total Depth								

SIZE	Charged to Well		Put in Well		Pulled Out		Left in Well		Transferred Before Completing		Left at Well Not in Use		Steel Line Measurement		If more than two strings of casing are left in hole, give reasons for leaving additional strings
	Foot	In.	Foot	In.	Foot	In.	Foot	In.	Foot	In.	Foot	In.	Foot	In.	
13" Csg.															
10" "															
8 1/4" "															
6 5/8" "															
5 1/8" "															
Tbg.															
"															

PACKER RECORD

SIZE	KIND	Amount Anchor	Amount Above Anchor	REMARKS

SHOOTING RECORD (If shot before or upon completion of well)

DATE	Quarts	Top of Shell	Bottom of Shell	Diameter	Sand	TEST BEFORE SHOT			TEST AFTER SHOT			Test Taken After Shot No. Hours	By Whom Shot
						Reading	Liquid	Opening	Reading	Liquid	Opening		

CEMENTING RECORD

Date Cemented..... Size Hole Cemented..... Size Casing Cemented.....
 Top Pittsburgh Coal..... Top Cementing..... Amount Cement Used.....
 Bottom Pittsburgh Coal..... Bottom Cementing..... Amount Sand Used.....
 Mr..... of..... Coal Company on ground when coal was cemented
 Remarks:..... Signature of persons who cemented well

Approved..... Foreman

WELL RECORD.

Harrison U. [unclear] Farm 6 1/2 Acres
 [unclear] District Harrison County W. Va. State
 Well No. 1291

Rig Commenced [unclear] 1909

Rig Completed [unclear] 1909

Drilling Commenced [unclear] 1909

Drilling Completed [unclear] 1909

G. H. Ross Contractor.

J. H. Williams Contractor.

ROCK FORMATION	TOP.	BOTTOM.	REMARKS.
Conductor		16	
Pittsburg Soil	212	219	10" casing left in well to protect Pittsburg bed.
13 in. [unclear]	700	740	10" casing limited through Pittsburg Soil.
Gas sand	862	1000	
First salt sand	1010	1090	Water 1080
Second salt sand	1150	1252	
Limestone	1315	1368	
Pittsburg	1524	1544	
Beal's Sand	1544	1556	
Big [unclear]	1556	1608	
Big [unclear]	1608	1702	Steel wire
Squaw	1706	1731	
Fifty feet	2080	2112	Steel pipe
Thirty feet	2128	2235	Steel wire
Gas	2153		" 7/8" opening
[unclear]	2436	2466	" "
[unclear]	2450	2452	" 1 1/2" opening
[unclear]	2593		
[unclear]	2586		
[unclear]	2590		
[unclear]	2593		
Total depth		2595	1/2 Murray in 5 7/8" casing pack not run steel line or cables. Cable measurement, used - 1 6 7/8" x 8 1/2" B.H. Ocular 1 5 7/8" x 6 7/8" " " 2500 lbs Cement

Drillers
 Sam Fitts
 Sidney Tennant
 Michael Stabler
 Homer Howard
 W. H. [unclear]

Tool Presses
 Clyde Martin
 Lillman Williams
 G. L. Slichterman

033-1296

CASING RECORD

Size.	Charged to Well.		Put in Well.		Pulled Out.		Left in Well.		Transferred Before Completion.		Left at Well, Not in Use.	
	Feet.	In.	Feet.	In.	Feet.	In.	Feet.	In.	Feet.	In.	Feet.	In.
10	281	7	257	-	-	-	257	-	19	7	5	-
8 1/4	1307	3	1227	-	1227	-	-	-	123	18	7	5
6 7/8	1730	9	1618	8	-	-	1618	8	-	-	112	7
5 7/8	2480	4	2453	3	-	-	2453	3	-	-	27	1

Production First 24 hours: 10 7/8 Murray 5 7/8 opening

Approved by [Signature]

REGISTERED
 WELL BOOK G.A.R. Nov. 8
 LEASE RECORD
 LEASE DOCKET
 WALL MAP
 MAP