

LATITUDE

39° 20' 00"

0.375

2.22W

39° 20' 00"

LONGITUDE

7.5 OGIS topo location

7.5' loc

15' loc 0.375
(calc.) 2.22W

Company Republic Natural Gas Co. 2687

Farm F. J. Drummond

Elev. 1230' 7.5 top

Quad Clarksburg / Clarksburg 5C

County Harwood

District Engle

WELL LOCATION MAP

File No. 033-1343

HOPE NATURAL GAS COMPANY

LOCATION FOR WELL, No. 2681

On Buffalo DISTRICT
J. J. Drummond Farm, on waters of Lamberts Run
Eggs District, Harrison County, West Virginia
 Plat No. 5742 Acres 58 N 9 E 13 W
 Scale, one inch equals 80 Poles Sent to N.Y.C. 7-16-1912
 Location to be 1000 feet from Omar W Swiger farm line and
400 feet from Jas F Allen farm line

44

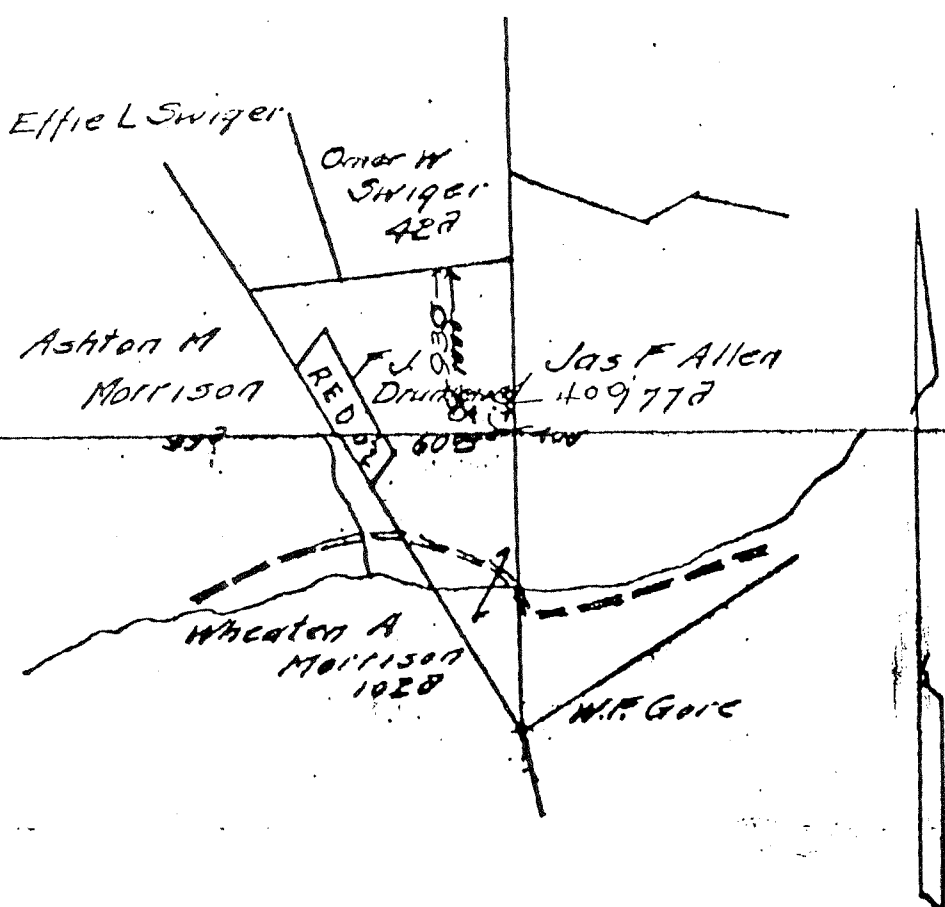

Good Title

033-1343

RESERVE Three acres around the buildings
 SPECIAL INSTRUCTIONS Same lease on which is location well No 1512 Cement 10" casing.
 Location made 7-25-12 by D.D. Long as per plat, except as noted. On field map.
7-27-12 Returned to Pittsburgh 7-29-12
 Location changed on account of rough ground
 Authorized by J.B. Anin Date 7-26-12 Signed by W.H. Brodley

72° 12' 0"

Record of *2681* Well No. *2681* Located on *Engle* District *Engle* County *Harrison* State *W. Va.* Company *Buffalo*

Location Made *7-25-12* First Work Done *11-1-12*
 Rig Commenced *8-22-12* Rig Completed *5-31-12*
 Drilling Commenced *9-21-12* Drilling Completed *11-1-12*
 Rig Contractor *J. H. & Co.* Drilling Contractor *Geo. L. Duffner*
 Drillers *J. O. Gairberton* *Michael Duffner*
 Tool Dressers *A. B. Hankins* *Upton Langston*

FORMATION	TOP	BOTTOM	Steel Line Measurements	Water Found Depth	Oil Found Depth	Gas Found Depth	REMARKS
Active Coal							
Pittsburg Coal	152	159					
Little Dunkard	540	560					
Big Dunkard	650						
Gas Sand	840	880					
First Salt	910	960		950			Salty
Second Salt	980	1190		1100			"
Maxon	1305	1340					
Little Lime	1470	1485					
Pencil Cave	1485	1505					
Big Lime	1505	1583					
Big Injun	1583	1688	1583				
Squaw							None
Berea	1880	1892					None 72Mct
Gantz							+6/10 Water 1" sp.
Fifty Foot	2082	2177	2082			2150	
Thirty Foot	2250	2266	2250				657Mct
Gordon Stray	2332	2350	2332		72		6/10 Water 5 3/4" sp.
Gordon	2365	2398	2365-52		585	2382	
Fourth	2402	2442	2402		19		
Fifth	2548	2558	2548			2550	10/10 " " 848Mct
Bayard			2550				
Total Depth		2580	2580				

SIZE	Charged to Well		Put in Well		Pulled Out		Left in Well		Transferred Before Completing		Left at Well Not in Use		If more than two strings of casing are left in hole, give reasons for leaving additional strings
	Foot	In.	Foot	In.	Foot	In.	Foot	In.	Foot	In.	Foot	In.	
13" Csg.													10" Csg. left in
10" "	306	8	219	-			219	0	93		78	5	protect 9 1/2" con
8 1/2" "	1299	5	1160		861	-	299	-	8		992	5	8 1/2" Csg. parts
6 5/8" "	1721	-	1595	1			1595	1	11	8	114	3	and 299 ft. left
5 3/16" "	2492	8	2344	-			2344	-			148	8	in by contractor
2 Tbg.	2735	3	2590	0			2590	7	145	3			

PACKER RECORD

SIZE	KIND	Amount Ancher	Amount Above Ancher	REMARKS
6 7/8 x 8 1/4	B. Jk.		1586	Set in Big Injun
5 7/16 x 6 7/8			2337	" " Stray
2 x 5 3/16		205	2375	" " Gordon

SHOOTING RECORD (If shot before or upon completion of well)

DATE	Quarts	Top of Shell	Bottom of Shell	Diameter	Sand	Test Before Shot			Test After Shot			Test Taken After Shot No. Hours	By Whom Shot	
						Reading	Liquid	Opening	Reading	Liquid	Opening			

CEMENTING RECORD

Date Cemented *9-26-12* Size Hole Cemented *1 1/4"* Size Casing Cemented *10"*
 Top Pittsburg Coal *152* Top Cementing *85* Amount Cement Used *300 P. #*
 Bottom Pittsburg Coal *159* Bottom Cementing *218* Amount Sand Used *600 P. #*
 Mr. *None* of *None* Coal Company on ground when coal was cemented
 Remarks: *10 x 15" 6-1/2" blanga used on bottom casing cementing through 2" testing*
 Signature of persons who cemented well *J. H. & Co.*

Well No. *Buffalo*
 District *S 9 E 13 W*

REPAIRS Completed *12-24-28*

CASING AND TUBING RECORD

Size	Before Repairs	Pull'd	Put in Well	After Repairs	Disposition of Amount Pulled
10	219			219	
8 1/4	299			299	
6 3/4	1595			1595	
5 3/16	2344	2344	2344	2344	Pulled & Run back in
2	2590	2590	3289	3289	Added 12/22/1928

SHOOTING RECORD

Date	Quarts	Top of Shell	Bottom of Shell	Diameter	Sand	TEST BEFORE SHOT			TEST AFTER SHOT			Test Taken After Shot No. Holes	By Whose Shot	
						R. Eng.	Liquid	Opening	R. Eng.	Liquid	Opening			
					710									

RECORD OF ANY DEEPER DRILLING

Formation	Top	Bottom
Commenced drilling at depth of	2580	
Bayard	2660	2673
Gas in Shell at	3175 ft	
Speckley	3222	3230
Gas	3224 to 3227	
Total Depth	3264	Line

Names of Drillers
John J. Correy
W. A. Swiger
J. J. Harbert
James L. Harmon
 Names of Tool Dressers
O. W. Drummond
B. F. Parks
E. C. Griffin
J. P. Dale
W. A. Reynolds

PACKER RECORD

Size	Kind	Anchor	Amount
5 3/16 x 6 3/8	B 1 1/2		733
5 3/16 x 2	Sand Bag	91	317
5 3/16 x 2	NW 4 Ave.	178	308

OIL AND GAS DISCOVERIES IN DEEPER DRILLING

Oil at _____ Ft. in
 Gas at *3224-3227* Ft. in *Speckley*

VOLUME AND PRESSURE REPORT

Reading	Liquid	Opening	Rock or Minute Pressure	Sands Gas From
13/10	Water	1 1/4 surface	Rock	Cor. & 5th
			42426	

VOLUME TEST

Date of Test	Opening	PITOT TUBE		OPEN FLOW	Sands Gas From
		Reading	Liquid Used		
12/22/1928	1/2 Casing	14/10	Water	7.044	5ft 7ft
	1/2 Tubing	22/10	Water	8.830	5ft 7ft
	1 1/2 Tubing	64/10	Water	135.513	Shell & Speckley

PRESSURE TEST

Date of Test	Opening	1 Min.	2 Min.	3 Min.	4 Min.	5 Min.	6 Min.	7 Min.	8 Min.	9 Min.	10 Min.	30 Min.	60 Min.
12/22/28	6 3/8 Casing	4	6	8	9	11	13	15	18	20	22	56	80
	5 3/16 Casing	2	2	2	4	4	4	6	6	6	6	12	18
	2" Tubing	32	50	70	86	100	118	135	150	164	182	400	575

OIL: From Sand
 Estimated Production Bbl per Day
 Remarks: *first Perf 3252 to 3264 sealed Perf 3223 to 3234*
1-2 RVL mpple first joint above packer
3061 ft. Bbl mud put in
Subsidiary Packer.
Gray G. Cor