

LOCATION FOR WELL No. 2744

DISTRICT

Wetzel
John J. Jones Farm, on waters of *Little Log Camp*
Cardia District, *Harrison* County, West Virginia.

Case No. *25653* Acres *85* N *5* S *5* E *8* W
Scale, one inch equals *80 Poles* Sent to *Charleston 9-27-12*

Location to be *Four hundred feet from W. J. Flanagan farm and
even hundred feet from Rachael A. Harbert farm.*

033-1348

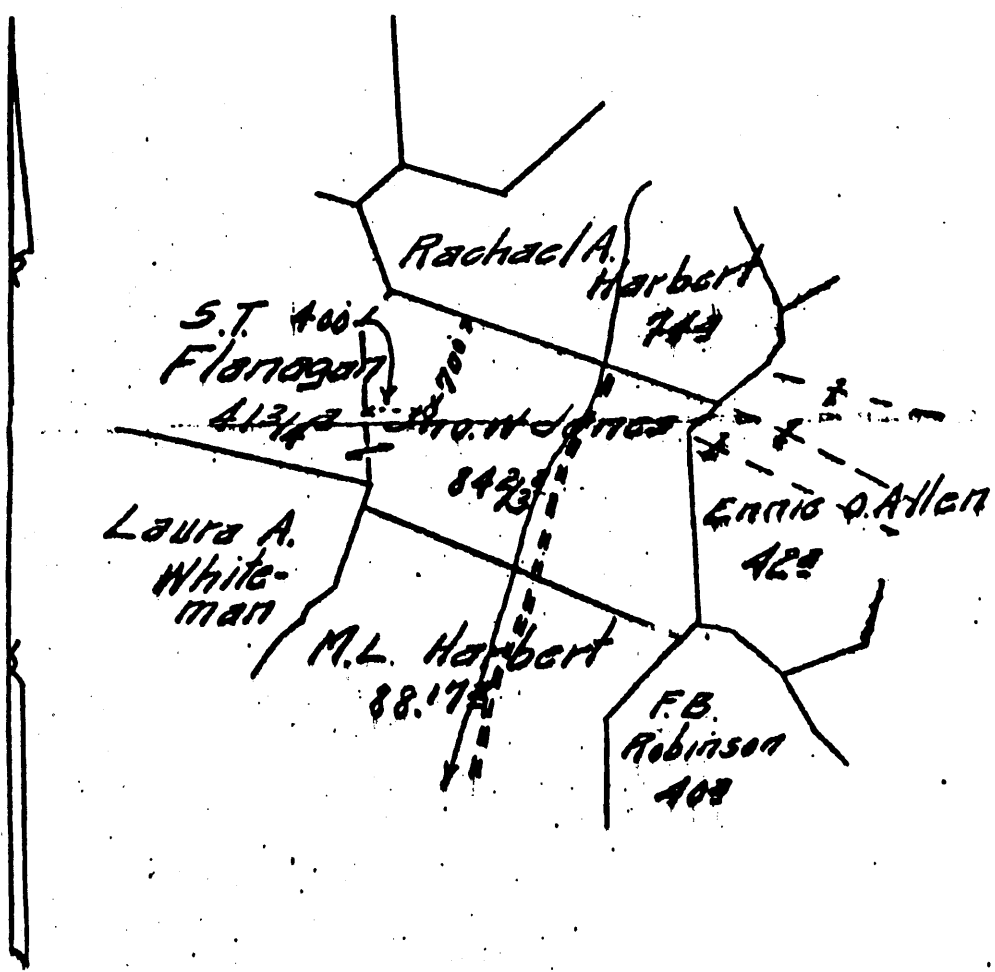

45

Good Title

RESERVE *Three hundred feet around
the dwelling house.*
SPECIAL INSTRUCTIONS

Location made *10-2-12* by *A.H. Bradley* as per plat, except as noted. On field map
10-3-12 Returned to Pittsburgh *10-3-12*

Location changed on account of _____
Authorized by _____ Date _____ Signed by _____

LATITUDE

39° 25' 00"

1

80° 27' 30"

LONGITUDE

○
2.61 S
1.31 W

7.5 OGIS topo location

7.5' loc ✓ 15' loc 2.61 S
(calc.) 3.54 W

Company Hope Natural Gas Co. 2744

Farm J. W. Jones

Elev. 1200' 7.5' tops

Quad Wallace / Clarkburg NC

County Harrison

District Sardis

WELL LOCATION MAP

File No. 033-1348

Well No. 2744 ✓
 Located on Sardis County Harrison State W. Va.
 District Sardis County Harrison State W. Va.

Location Made 10-2-12 First Work Done _____
 Rig Commenced 11-1-12 Rig Completed 11-19-12
 Drilling Commenced 11-18-12 Drilling Completed 2-11-13
 Rig Contractor John Craig Drilling Contractor Thompson & Fair
 Drillers C. A. Fair - Jess Muswain W. H. H. Co. Tools. String No. _____
 Tool Dressers Chas. Harsh - Jack Heman

FEB 25 1913 H.H.S.
 EXPANDED 1913 G.A.I.
 WELL BOOK
 LEASE RECORD REMARKS
 LEASE DOCKET
 WALL MAP FEB 24 1913 J.H.S.
 INDEX MAP FEB 25 1913 H.H.S.
 LOCATION BOOK
 COUNTY OFFICE PLAT

FORMATION	TOP	BOTTOM	Steel Line Measurements	Water Found Depth	Oil Found Depth	Gas Found Depth	REMARKS
Live Coal	270	272					
Pittsburg Coal	840	848	S.L.				
Little Dunkard	1247	1292					
Dunkard	1342	1362					
Sand	1675	1680					
Red Salt	1700	1760		1745			
Wood Salt	1780	1820					
Shale	2050	2075					
Blue Limestone	2080	2095					
Black Cave	2095	2100					
Blue Limestone	2100	2140					
Blue Limestone	2140	2245	S.L.			2150	Not enough to test
Blue Limestone	2260	2270					
Blue Limestone	2510	2535					
Blue Limestone	2400	2412					
Blue Limestone	2700	2720	S.L.				
Blue Limestone	2810	2830	S.L.			2816 to 2825	9/10 mercury through 2" 3/40 McF
Blue Limestone	2872	2912					
Blue Limestone	2922	2957	S.L.			2946-2950	4/10 water through 5 1/2"
Blue Limestone	3003	3018	S.L.				
Blue Limestone	3115	3117	S.L.				2425 McF
Total Depth		3120					

SIZE	Charged to Well		Put in Well		Packed Out		Left in Well		Transferred Before Completing		Left at Well Not in Use		If more than two strings of casing are left in hole, give reasons for leaving additional strings
	Feet	In.	Feet	In.	Feet	In.	Feet	In.	Feet	In.	Feet	In.	
1 1/2" Csg.													
10" "	403	6	950	-	850						403	6	
8 1/2" "	1404	11	1942				1342		219		41	2	
5 1/2" "	2242		2145	5			2145	5			96	7	
3 1/2" "	3001	10	2891	1			2891	1			110	9	
Tbg.													

SIZE	KIND	Amount Ancher	Amount Above Ancher	REMARKS
2 1/2"	B.H.			
2 1/2"	B.H.	1' 4"	2144'	
2 1/2"	One.	1' 4"	2144'	Steel shoe on bottom

DATE	Gauge	Top of Shot	Bottom of Shot	Diameter	Sand	Test Before Shot			Test After Shot			Test Taken After Shot No. Hours	By Whom Shot
						Reading	Liquid	Opening	Reading	Liquid	Opening		

CEMENTING RECORD

Date Cemented..... Size Hole Cemented..... Size Casing Cemented.....
 Top Pittsburg Coal..... Top Cementing..... Amount Cement Used.....
 Bottom Pittsburg Coal..... Bottom Cementing..... Amount Sand Used.....
 Mr..... of..... Coal Company on ground when coal was cemented
 Remarks:..... Signature of persons who cemented well

033-1348
 Approved by [Signature]
 Foreman