

39° 22' 30"

Latitude

80° 15' 00"

Longitude

7.5' ↑  
loc

Topo Location

7.5' Loc. 0.865 15' Loc. 3.745  
0.87W (calc.) 0.87W

Company H.N.G. Co # 3406  
Farm Charles Grey  
15' Quad Clksby (EC)  
(sec.)  
7.5' Quad Clksby  
District Clay

WELL LOCATION PLAT

County 033 Permit 1369

LOPPE NATURAL GAS CO.

LOCATION FOR WELL No. 3406

On Charles Gray Farm, on waters of Blunns Run  
Clay District, Barren County, West Virginia

Lease No. 8221 Acres 22 N. 7 E. 19 W.  
Scale, one inch equals 80 Paces Sent to Clarksburg Office Feb 17 1914

Location to be 300 feet from Lillie M. Davis farm line and 400 feet from C. G. Harmer farm line.  
2-17-14

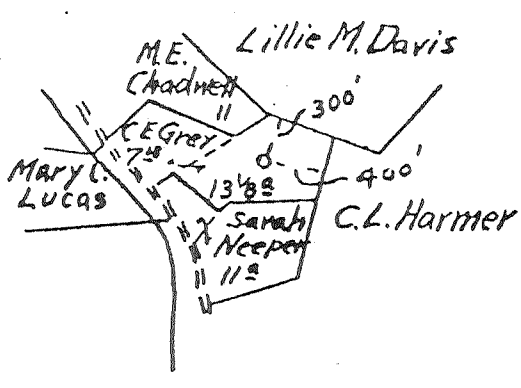

RPT.  
033-1369

41  
42

TITLE  
RESERVE Fifty feet around the buildings

SPECIAL INSTRUCTIONS: COMPLETE WELL ON OR BEFORE May 13, 1914  
Contract 10" casing  
Location made 2-20-14 by D.D. Lang As per plat, except as noted. On field map 2-23-14 Returned to Pittsburgh 2-23-14

Location changed on account of  
Authorized by \_\_\_\_\_ Date \_\_\_\_\_ Signed \_\_\_\_\_

Well No. 3166 Located on Chas. Gray District Clay County Warren State Ohio  
 Location Made 2-20-14 First Work Done 2-20-14  
 Rig Commenced 3-11-14 Rig Completed 11-11-14  
 Drilling Commenced 4-7-14 Drilling Completed 5-21-14  
 Rig Contractor Haystack Co. Drilling Contractor Haystack Drilling Co.  
 Drillers C. E. Bailey H. K. M. Co. Tools, String No. 212-Railroad  
 Tool Dressers C. E. Bailey

ENTERED  
 WELL BOOK  
 LEASE RECORD  
 LEASE DOCKET  
 WELL MAP  
 LINE MAP  
 LOCATION REMARKS  
 CONTRACTORS PLAT  
 CONTRACTOR  
 TITLE

FORMATION	TOP	BOTTOM	Steel Line Measurements	Water Found Depth	Oil Found Depth	Gas Found Depth
Native Coal	None					
Bituminous Coal	170	178				
Little Dunkard	175	185				
Big Dunkard	250	270				
Gas Sand	295	340				
First Salt	880	940				
Second Salt	970	1000				
Maxon	1140	1730				
Little Lime	1510	1540				
Pencil Cave	1570	1535				
Big Lime	1535	1597				
Big Injun	1597	1708				
Squaw	1712	1724			1630	38/10 Water 2"
Berea	None					
Gantz	None					
Fifty Foot	2075	2160				
Thirty Foot	2185	2277				
Gordon Stray	None					
Gordon	2474	2484 S.L.				
Fourth	2490	2517				
Fifth	2550	2569				
Sixth	2622	2647				
Total Depth	2662	2662 S.L.				2615 30/10 Water 2"

SIZE	Charged to Well		Put in Well		Pulled Out		Left in Well		Transferred Before Completing		Left at Well Not in Use		If more than two strings of casing are left in hole, give reasons for leaving additional strings
	Feet	In.	Feet	In.	Feet	In.	Feet	In.	Feet	In.	Feet	In.	
13" Csg.													
10" "	514	7	417		None		417		416		56	1	
8 1/2" "	1086	3	1040		None		1040		None		45	11	
6 5/8" "	1614	9	1621	6	None		1621	6	None		73	3	
5 3/16" "													
Tbg.													

ENTERED  
 WELL BOOK  
 LEASE RECORD  
 LEASE DOCKET  
 WELL MAP  
 LINE MAP  
 LOCATION REMARKS  
 CONTRACTORS PLAT  
 CONTRACTOR  
 TITLE  
 JUL 10 1914 H.U.S.

PACKER RECORD

SIZE	KIND	Amount Anchor	Amount Above Anchor
10 1/8" B.H.		None	None
3 1/2" V.C.	"	None	None

SHOOTING RECORD (If shot before or upon completion of well)

DATE	Quarts	Top of Shell	Bottom of Shell	Diameter	Sand	Test Before Shot			Test After Shot			Test Taken After Shot No. Hours	By Wh. a Shot
						Reading	Liquid	Opening	Reading	Liquid	Opening		
7-23-14	40	2615	2659	4 1/4	Bayard	30	Water	2	37/10	Water	2	3 1/2	M.P. Co.

CEMENTING RECORD

Date Cemented	4-18-14	Size Hole Cemented	11 1/2"	Size Casing Cemented	10"
Top Bituminous Coal	170	Top Cementing	85	Amount Cement Used	2800#
Bottom Bituminous Coal	178	Bottom Cementing	417	Amount Sand Used	5600#
Mr.	C. E. Bailey	of	Haystack	Coal Company on ground when coal was cemented	

Remarks: 10x5" Shas on bottom of 10" casing  
 Signature of persons who cemented well: C. E. Bailey  
 Approved by: H. J. ...  
 RT-033-1369

No. 3406

# REPAIR RECORD

N. S. 9 E. 19. W.

Name: Charles Gray

Repairs Completed: June 22, 1931

Repairs Commenced: June 22, 1931 (18-02-30)

## CASING AND TUBING RECORD

Size	Before Repairs	Pulled	Put in Well	After Repairs	Disposition of Amount Pulled
4 1/2"	407.3	None	None	407.3	
3 1/2"	1033	None	None	1033	
2 5/8"	1624.3	None	None	1624.3	
2"	1892.2	1892.2	None	None	
1 1/2"	None	None	2747.3	2747.3	

## SHOOTING RECORD

Date	Quarts	Top of Shell	Bottom of Shell	Diameter	Sand	TEST BEFORE SHOT			TEST AFTER SHOT			Time Taken After Shot No. Hours	By Whom Shot
						Reading	Liquid	Opening	Reading	Liquid	Opening		
23-14	40	2645	2659	1"	Bayard	2/10 W	2"	80/10 W	2"	McH...	McH...		McH...

## RECORD OF ANY DEEPER DRILLING

Formation	Top	Bottom	Names of Drillers	Time (Days)
			Harry Chambers	
			Ernest D. Dodd	

Formation	Top	Bottom	Names of Tool Dressers	Time (Days)
			Ernest D. Dodd	

Size	Kind	Anchor	Amount Above Anchor
10x8 1/2"	Bottom Hole	None	1033
8 1/2 x 6 5/8"	Bottom Hole	None	1824
6 3/4 x 16x3"	Seed Bag	116	2658
5 3/4 x 16x3"	Anchor	178	2597

OIL AND GAS DISCOVERIES IN DEEPER DRILLING

Oil at	Ft. in	Sand
Gas at	Ft. in	Sand

## VOLUME AND PRESSURE REPORT

### BEFORE REPAIRS

Reading	Liquid	Opening	Rock or Minute Pressure	Sands Gas From
44/10	Water	1-1/2" P.M.	272 11 x 389	Injun & Bayard

### AFTER REPAIRS

### VOLUME TEST

Date of Test	Opening	PILOT TUBE		OPEN FLOW	Sands Gas From	Tested by
		Reading	Liquid Used	Lbs.		
1-22-31	3/8" " Casing	18/10	Water	P.M.	Injun 4493	O. B. Prohard
1-22-31	1" " Tubing	14/10	Water	P.M.	Bayard 28277	

### PRESSURE TEST

Date of Test	Opening	1 Min.	2 Min.	3 Min.	4 Min.	5 Min.	6 Min.	7 Min.	8 Min.	9 Min.	10 Min.	30 Min.	60 Min.	Hrs.
1-22-31	6 5/8" Casing	0	0	0	0	0	0	0	0	0	0	0	10	24
1-22-31	3" Tubing	0	0	2	5	7	8	10	11	12	15	45	80	24

OIL: From Sand  
 Estimated Production: 70 Bbl. per Day  
 Remarks: 1st Perf. on bottom, 2nd perf. at 2645. Seed Bag Packer at 2655. 5 3/16 x 3" Anchor at 2597.

*C. O. Taylor*

API-03311369