

39° 15' 00"

Latitude

80° 17' 30"

Longitude

Topo Location

7.5' Loc. 2.625 15' Loc. 2.625  
1.30W (calc.) 3.53W

Company H. N. G. Co # 4333  
Farm A. C. Greynolds  
15' Quad Weston (NE)  
(sec.)  
7.5' Quad Mount Clare  
District Elk

WELL LOCATION PLAT

County 033 Permit 1407

# HOPE NATURAL GAS COMPANY

LOCATION FOR WELL No. 4333

Instructions

On *S. C. Greynolds* Farm, on waters of *Little Run*  
*Belz* District, *Clarksburg* County, West Virginia

Lease No. *15168* Acres *14* N. S. *17* E. *16* W.

Scale one inch equals *70 Feet* Location made in Pittsburgh *May 22 1916* Sent to Clarksburg *May 22 1916*

Location to be *600 feet from Susan Morris farm & equidistant from East & West lines of tract.*

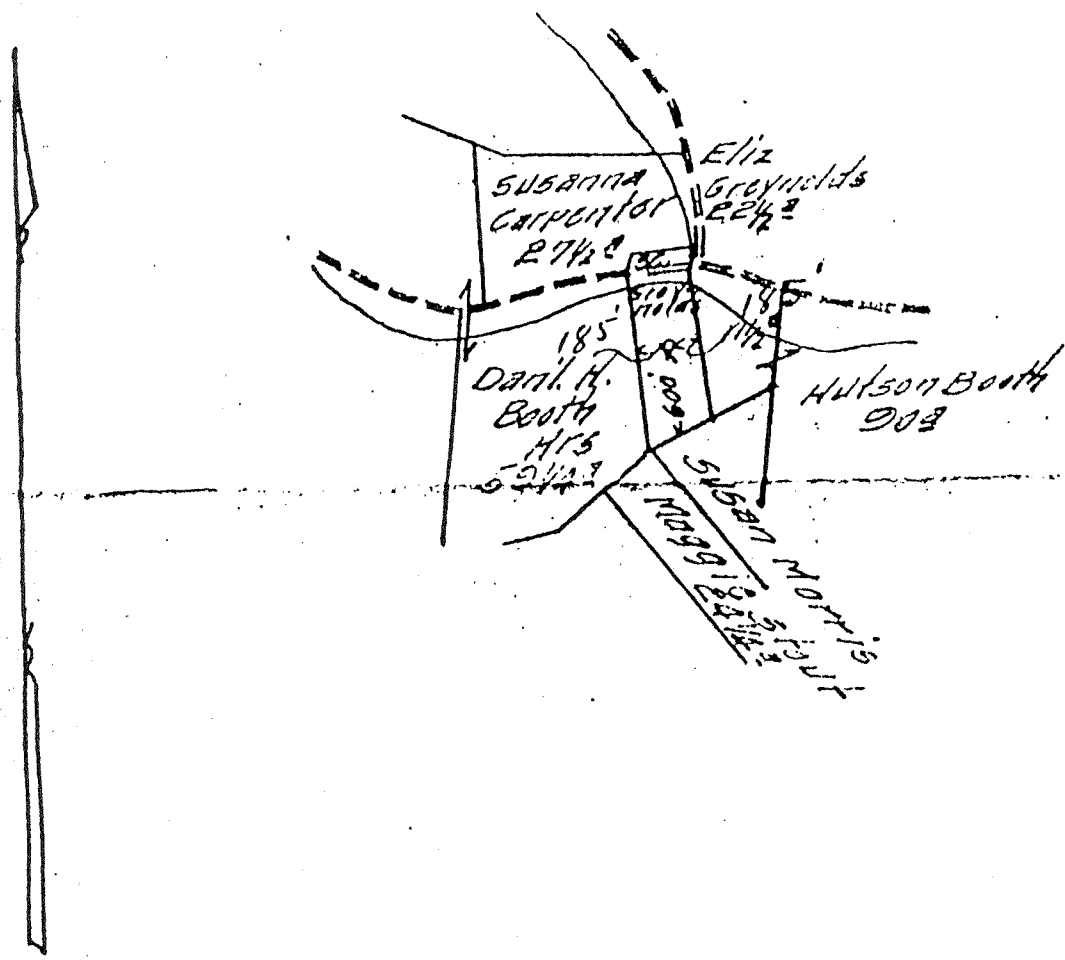

*13*  
*1156*

033-1407

TITLE RESERVE *One hundred feet*  
*around the buildings*

SPECIAL INSTRUCTIONS: COMPLETE WELL ON OR BEFORE \_\_\_\_\_

Same Lease on which Located Well No. \_\_\_\_\_

Location made *6-2-16* by *Geo. H. Bunningham* As per plat, ~~except as noted~~ On field map

*6-5-16* Returned to Pittsburgh *6-5-16*

Location changed on account of \_\_\_\_\_

Authorized by \_\_\_\_\_ Date \_\_\_\_\_ Signed *S. H. Bradley*

133-110  
 District Harrison  
 State Mo.  
 Location Made 6-2-16  
 Rig Commenced 6-15-16  
 Drilling Commenced June 28-16  
 Rig Contractor A. J. Jackson  
 Drillers Frank Kado  
 Tool Dressers  
 First Work Done 6-20-16  
 Rig Completed Aug. 6-1916  
 Drilling Completed  
 Drilling Contractor N. W. S. ...  
 H. N. B. Co. Tools. Sling No. Bu. Wells.  
 James Taylor.

FORMATION	TOP	BOTTOM	Steel Line Measurements	Water Found Depth	Oil Found Depth	Gas Found Depth	REMARKS
Native Coal							10' Gas S.L. 705
Pittsburg Coal							8 1/2' " 876
Little Dunkard	397	413					6 1/2' " 134
Big Dunkard							
Gas Sand	580	610					Hole full
First Salt	674	783		638			
Second Salt	788	860					
Maxon	1190	1210					
Little Lime	1265	1275					
Pencil Cave	1275	1279	1				
Big Lime	1279	1344	5 1/2				
Big Injun	1344	1438	"				
Squaw							
Berea							1703
Gantz	1700	1780	"				6' 10" to 2" off
Fifty Foot	1830	1905	"				
Thirty Foot	1977	1955	"				
Gordon Stray	2063	2078	"				
Gordon	2105	2125	"				
Fourth	2145	2165	"				2147 } 18' 10" to 2" off
Fifth	2238	2270	"				2240-2250 } Gantz 4' 10" + 10"
Bayard	2341	2350	"				
Total Depth	2406						Hole reduced 2069, filled up to 2298

SIZE	Charged to Well		Put in Well		Pulled Out		Left in Well		Transferred Before Completing		Left at Well Not in Use		REMARKS
	Feet	In.	Feet	In.	Feet	In.	Feet	In.	Feet	In.	Feet	In.	
13" Csg.	245	6	207	-	19	6	187	6	None		588		(H. reduced)
10" "	1463	3	883	-	None		883	-	470	6	99	9	
8 1/2" "	1387	10	1358	-	None		1358	-	None		29	10	
6.5-8" "													
5.3-16" "													
2 Tbg.	2516	2	2246	-	None		2246	-	None		270	2	
3 "	65	10	65	10	None		65	10					
3" Casing	6	-	6	-	None								

SIZE	KIND	Amount Anchor	Amount Above Anchor	REMARKS
10x8 1/2	B.T.H.			
8 1/2 x 6 1/2	B.N.			
5 1/2 x 4	A.M.C.	143	2155	

SHOOTING RECORD (If shot before or upon completion of well)													
DATE	Quarts	Top of Shell	Bottom of Shell	Diameter	Sands	Test Before Shot			Test After Shot			Test Taken After Shot No. Hours	By Wh.
						Reading	Liquid	Opening	Reading	Liquid	Opening		
8/8/16	600	2240	2262	4 1/4	5 1/2	13 1/10	None	2	9 1/10	None	7	74	77

CEMENTING RECORD

Date Cemented..... Size Hole Cemented..... Size Casing Cemented.....  
 Top Pittsburg Coal..... Top Cementing..... Amount Cement Used.....  
 Bottom Pittsburg Coal..... Bottom Cementing..... Amount Sand Used.....  
 Mr..... of..... Coal Company on ground when coal was cemented.....  
 Remarks:..... Signature of persons who cemented well.....  
 Well Book.....  
 Lease Book.....  
 Wall Map.....  
 Line Map SEP 18 1916 A.J.D.  
 Sheets SEP 18 1916 B.I.

Approved by.....  
 133-110