

WW-7
8-30-06



West Virginia Department of Environmental Protection
Office of Oil and Gas

WELL LOCATION FORM: GPS

API: 47-033-01997 WELL NO.: AE-42

FARM NAME: Gawthrop, A.

RESPONSIBLE PARTY NAME: XTO Energy, Inc.

COUNTY: Harrison DISTRICT: Clay

QUADRANGLE: Wolf Summit

SURFACE OWNER: Sandra C. Bailey, Sandra Sue Clemente & Judith Ann Jordan

ROYALTY OWNER: See attached list

UTM GPS NORTHING: 4347448.6

UTM GPS EASTING: 548829.2 GPS ELEVATION: 421 meters (1381')

The Responsible Party named above has chosen to submit GPS coordinates in lieu of preparing a new well location plat for a plugging permit or assigned API number on the above well. The Office of Oil and Gas will not accept GPS coordinates that do not meet the following requirements:

- Datum: NAD 1983, Zone: 17 North, Coordinate Units: meters, Altitude: height above mean sea level (MSL) – meters.
- Accuracy to Datum – 3.05 meters
- Data Collection Method:

Survey grade GPS : Post Processed Differential

Real-Time Differential

Mapping Grade GPS : Post Processed Differential

Real-Time Differential

- Letter size copy of the topography map showing the well location.

I the undersigned, hereby certify this data is correct to the best of my knowledge and belief and shows all the information required by law and the regulations issued and prescribed by the Office of Oil and Gas.

[Signature]
Signature

Project Manager
Title

June 30, 2015
Date
RECEIVED
Office of Oil and Gas
JUL 18 2015
Department of
Environmental Protection

08/26/2016

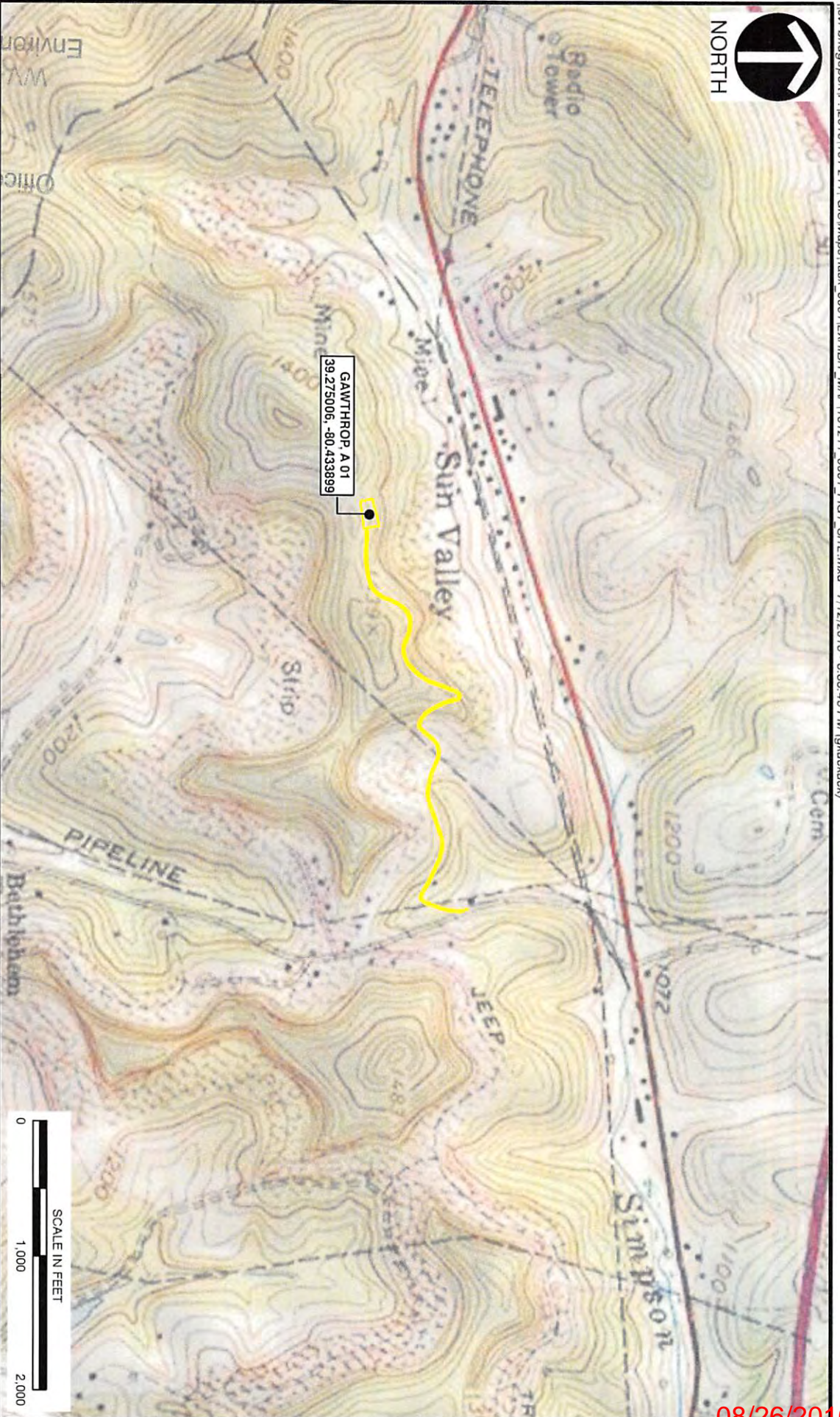

LEGEND
PROPOSED JOB

1. USGS TOPOGRAPHIC MAP / ARCGIS MAP SERVICE:
HTTP://GOTO.ARCGISONLINE.COM/MAPS/
USA_TOPO_MAPS, ACCESSED 7/12/2016
WOLF SUMMIT, WEST VIRGINIA QUAD



Civil & Environmental Consultants, Inc.
600 Marketplace Avenue, Suite 200 - Bridgeport, WV 26330-9121
Ph: 304-933-3119 • Toll: 855-488-9539 • Fax: 304-933-3327
www.cecinc.com

XTO ENERGY, INC.
GAWTHROP, A 01 WELL PLUGGING PROJECT
HARRISON COUNTY, WEST VIRGINIA

USGS SITE LOCATION MAP

| | | | | | | |
|-----------|------------|-------------|-------------|--------------|--------------|------------|
| DRAWN BY: | GSK | CHECKED BY: | JDK | APPROVED BY: | SAC | FIGURE NO: |
| DATE: | 07/12/2016 | SCALE: | 1" = 1,000' | PROJECT NO: | 161-211.0001 | 1 |

08/26/2016