



1) Date: May 17, 1985  
 2) Operator's Well No. 1829  
 3) API Well No. 47 -033-3222  
 State County Permit

STATE OF WEST VIRGINIA  
 DEPARTMENT OF MINES, OIL AND GAS DIVISION  
 APPLICATION FOR A WELL WORK PERMIT

- 4) WELL TYPE: A Oil  / Gas  /  
 B (If "Gas", Production  / Underground storage  / Deep  / Shallow  /)
- 5) LOCATION: Elevation: 1308 Watershed: Simpson Creek  
 District: Simpson 8 County: Harrison Quadrangle: Clarksburg 297
- 6) WELL OPERATOR CNG Development Company 7) DESIGNATED AGENT Gary Nicholas  
 Address c/o Paul W. Garrett, P.O. Box 15746 Address Crosswind Corporate Park  
Pittsburgh, PA 15244 10110 Rt. 2, Box 698, Bridgeport, WV 26330
- 8) OIL & GAS INSPECTOR TO BE NOTIFIED 9) DRILLING CONTRACTOR:  
 Name Stephen Casey Name Sam Jack Drilling Co.  
 Address Rt. 2, Box 232D Address P.O. Box 48  
Jane Lew, WV 26378 Buckhannon, WV 26201
- 10) PROPOSED WELL WORK: Drill  / Drill deeper  / Redrill  / Stimulate  /  
 Plug off old formation  / Perforate new formation  /  
 Other physical change in well (specify) \_\_\_\_\_
- 11) GEOLOGICAL TARGET FORMATION, Benson
- 12) Estimated depth of completed well, 4925 feet
- 13) Approximate trata depths: Fresh, 215, 300, 375, 520 feet; salt, \_\_\_\_\_ feet.
- 14) Approximate coal seam depths: 365, 740, 850 Is coal being mined in the area? Yes  / No  /
- 15) CASING AND TUBING PROGRAM

CASING OR TUBING TYPE	SPECIFICATIONS					FOOTAGE INTERVALS		CEMENT FILL-UP OR SACKS (Cubic feet)	PACKERS
	Size	Grade	Weight per ft.	New	Used	For drilling	Left in well		
Conductor									Kinds
Fresh water	<u>11-3/4</u>	<u>H-40</u>	<u>42</u>	<input checked="" type="checkbox"/>		<u>40</u>	<u>40</u>	<u>To Surface</u>	<u>By Rule 15.05</u>
Coal									Sizes
Intermediate	<u>8-5/8</u>	<u>X-42</u>	<u>23</u>	<input checked="" type="checkbox"/>		<u>950</u>	<u>950</u>	<u>To Surface</u>	<u>By Rule 15.05</u>
Production	<u>4-1/2</u>	<u>J-55</u>	<u>10.5</u>	<input checked="" type="checkbox"/>		<u>4925</u>	<u>4925</u>	<u>200-400</u>	Depths set
Tubing	<u>1-1/2</u>	<u>CN-55</u>	<u>2.75</u>	<input checked="" type="checkbox"/>					<u>By Rule 15.01</u>
Liners									Perforations:
									Top Bottom

OFFICE USE ONLY  
 DRILLING PERMIT

Permit number 47-033-3222 Date June 28 19 85

This permit covering the well operator and well location shown below is evidence of permission granted to drill in accordance with the pertinent legal requirements subject to the conditions contained herein and on the reverse hereof. **Notification must be given to the District Oil and Gas Inspector, (Refer to No. 8) Prior to the construction of roads, locations and pits for any permitted work.** In addition, the well operator or his contractor shall notify the proper district oil and gas inspector 24 hours before actual permitted work has commenced.)

The permitted work is as described in the Notice and Application, plat, and reclamation plan, subject to any modifications and conditions specified on the reverse hereof.

Permit expires June 28, 1987 unless well work is commenced prior to that date and prosecuted with due diligence.

Bond: <u>28</u>	Agent: <u>AKB</u>	Plat: <u>MU</u>	Casing: <u>MN</u>	Fee: <u>8449</u>
-----------------	-------------------	-----------------	-------------------	------------------

*Margaret J. Hass*  
 Administrator, Office of Oil and Gas

NOTE: Keep one copy of this permit posted at the drilling location.

See the reverse side of the APPLICANT'S COPY for instructions to the well operator.

File





OFFICE USE ONLY

PERMIT MODIFICATIONS AND CONDITIONS (IF ANY) TO THE PROPOSED WELL WORK

Administrative information including permit number, applicant name, address, and contact details.

Table with columns for well identification, depth, and other technical specifications.

OFFICE USE ONLY

This part of Form IV-2(b) is to record the dates of certain occurrences and any follow-up inspections.

Table for recording key events: Application received, Well work started, Completion of the drilling process, Well Record received, Reclamation completed.

OTHER INSPECTIONS

Reason: [Handwritten signature and notes]

Small table with handwritten entries, possibly for inspection dates or results.



INSTRUCTIONS TO APPLICANT

CONCERNING THE LEASE ITEMS:

- 1) Date of Notice.
- 2) Your well name and number.
- 3) To be filled out by the Office of Oil & Gas.
- 4) & 5) Use separate sheet if necessary.
- 4) Surface owner(s) of record to be served with Notice and Application. However, see also Code § 22-4-1b(b) if "more than three tenants in common or other co-owners of interest described in subsection (a) of this section hold interests in such lands".
- 5(i) "Coal Operator" means any person, firm, partnership, partnership association or corporation that proposes to or does operate a coal mine.
- 5(ii, iii) See Code § 22-4-20.
- 6) See Code § 22-4-11(c). However, in lieu of filing the lease(s) or other continuing contract(s), the Applicant may fill out the information in the space provided below.
- 7) See Code § § 22-4-11(d, e).

CONCERNING THE REQUIRED COPIES FOR FILING AND SERVICE:

Filing. Code § 22-4-1k and Regulation 7.02 provide that the original and required copies of the Notice and Application must be filed with the Administrator, accompanied by (i) a plat in the form prescribed by Regulation 11, (ii) a bond in one of the forms prescribed by Regulation 12, or in lieu thereof the other security allowed by Code § 22-4-1k(d) and the reclamation required by Code § 22-4-12b and Regulation 23, (iv) unless previously paid on the same well, the fees required by Code § 22-4-1a(c) and 22-3-12a, and (v) if applicable, the consent required by Code § 22-4-8a from the owner of any water well on dwelling within 200 feet of the proposed well.

Service. In addition, service must be made on the surface owner(s) and the person(s) with an interest in the coal. See Code § § 22-4-1m, 22-4-2, 22-4-2a, and 22-4-2b.

INFORMATION SUPPLIED UNDER CODE § 22-4-11(d)  
IN LIEU OF FILING LEASE(S) AND OTHER CONTINUING CONTRACT(S)

Under the oath required to make the verification on the obverse side of this Notice, I depose and say that I am the person who signed the Notice for the Applicant, and that--

- (1) the tract of land is the same tract described in the Application to which this Notice applies, partly or wholly depicted in the accompanying plat, and described in the Construction and Reclamation Plan;
- (2) the parties and recordation data (if recorded) for lease(s) or other continuing contract(s) by which the Applicant claims the right to extract, produce or market the oil or gas are as follows:

<u>Grantor, lessor, etc.</u>	<u>Grantee, lessee, etc.</u>	<u>Royalty</u>	<u>Book Page</u>
Joseph Sutton Heirs	South Penn Oil Co.	\$75 Qtr/Gas	426 446
to	Hope Natural Gas Co.	1/8 Oil	
to	Consolidated Gas Supply	1/8	
to	Consolidated Gas Trans.	1/8	

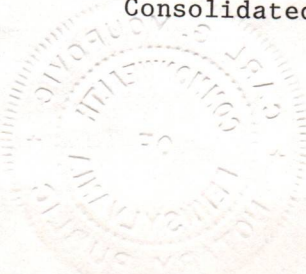



1) Date: May 17, 1985  
2) Operator's Well No. 1829  
3) API Well No. 47 033-3222  
State County Permit

STATE OF WEST VIRGINIA  
DEPARTMENT OF MINES, OFFICE OF OIL & GAS  
NOTICE OF APPLICATION FOR A WELL WORK PERMIT

4) SURFACE OWNER(S) OF RECORD TO BE SERVED

5(i) COAL OPERATOR

(i) Name Vandilla Fetty Heirs  
Address c/o James R. Ice  
Box 56

Address \_\_\_\_\_

(ii) Name Barrackville, WV 26559  
Address \_\_\_\_\_

5(ii) COAL OWNER(S) WITH DECLARATION ON RECORD

Name James D. LaRosa  
Address 420 Buckhannon Pike  
Clarksburg, WV 26301

(iii) Name \_\_\_\_\_  
Address \_\_\_\_\_

Name Fresa Construction Co.  
Address Box 187  
Bridgeport, WV 26330

~~\*\*\*\*\*COAL LESSEE WITH DECLARATION ON RECORD\*\*\*\*\*~~

Name James Joseph LaRosa  
Address 2 Club View Drive  
Bridgeport, WV 26330

TO THE PERSON(S) NAMED ABOVE: You should have received this Form and the following documents:

- (1) The Application for a Well Work Permit on Form IV-2(B) (or Form IV-4 if the well is to be plugged, which sets out the parties involved in the drilling or other work, and describes the well and its location and, if applicable, the proposed casing and cementing program;
- (2) The plat (surveyor's map) showing the well location on Form IV-6; and
- (3) The Construction and Reclamation Plan on Form IV-9 (unless the well work is only to plug a well), which sets out the plan for erosion and sediment control and for reclamation for the site and access road.

THE REASON YOU RECEIVED THESE DOCUMENTS IS THAT YOU HAVE RIGHTS REGARDING THE APPLICATION WHICH ARE SUMMARIZED IN THE "INSTRUCTIONS" ON THE REVERSE SIDE OF THE COPY OF THE APPLICATION (FORM IV-2(B) OR FORM 4, DESIGNATED FOR YOU. HOWEVER, YOU ARE NOT REQUIRED TO TAKE ANY ACTION AT ALL.

Take notice that under Chapter 22 of the West Virginia Code, the undersigned well operator proposes to file or has filed this Notice and Application and accompanying documents for a Well Work Permit with the Administrator of the Office of Oil and Gas, West Virginia Department of Mines, with respect to a well at the location described on attached Application and depicted on attached Form IV-6. Copies of this Notice, the Application, the plat, and the Construction and Reclamation Plan have been mailed by registered or certified mail or delivered by hand to the person(s) named above (or by publication in certain circumstances) on or before the day of mailing or delivery to the Administrator.

6) EXTRACTION RIGHTS

Check and provide one of the following:

- Included in the lease or leases or other continuing contract or contracts by which I hold the right to extract oil or gas.
- The requirement of Code 22-4-1-(c) (1) through (4). (See reverse side for specifics.)

7) ROYALTY PROVISIONS

Is the right to extract, produce or market the oil or gas based upon a lease or leases or other contract or contracts providing for flat well royalty or any similar provision for compensation to the owner of the oil or gas in place which is not inherently related to the volume of oil or gas so extracted, produced or marketed? Yes No

If the answer above is No, nothing additional is needed. If the answer is Yes, you may use Affidavit Form IV-60.

See the reverse side for line item instructions, and for instructions concerning the required copies of the Notice and Application, plat, and Construction and Reclamation Plan.

RECEIVED  
JUN 06 1985  
OIL & GAS DIVISION  
DEPT. OF MINES

The truth of the information on the Notice and Application is verified and sworn to and the Notice is signed on behalf of the Well Operator in my County and State by

WELL OPERATOR CNG Development Company

By Paul W. Garrett  
Its Manager, Well Programs  
Address P.O. Box 15746  
Pittsburgh, PA 15244  
Telephone (412) 787-4090

Paul W. Garrett,  
this 17 day of May, 1985.  
My commission expires 12/19, 1988.

Carl J. Mariani  
Notary Public, Allegheny County,  
State of Pennsylvania



ATTACH OR PHOTOCOPY SECTION OF INVOLVED TOPOGRAPHIC MAP. QUADRANGLE CLARKSBURG 7.5 MIN.

**LEGEND**

Well Site 



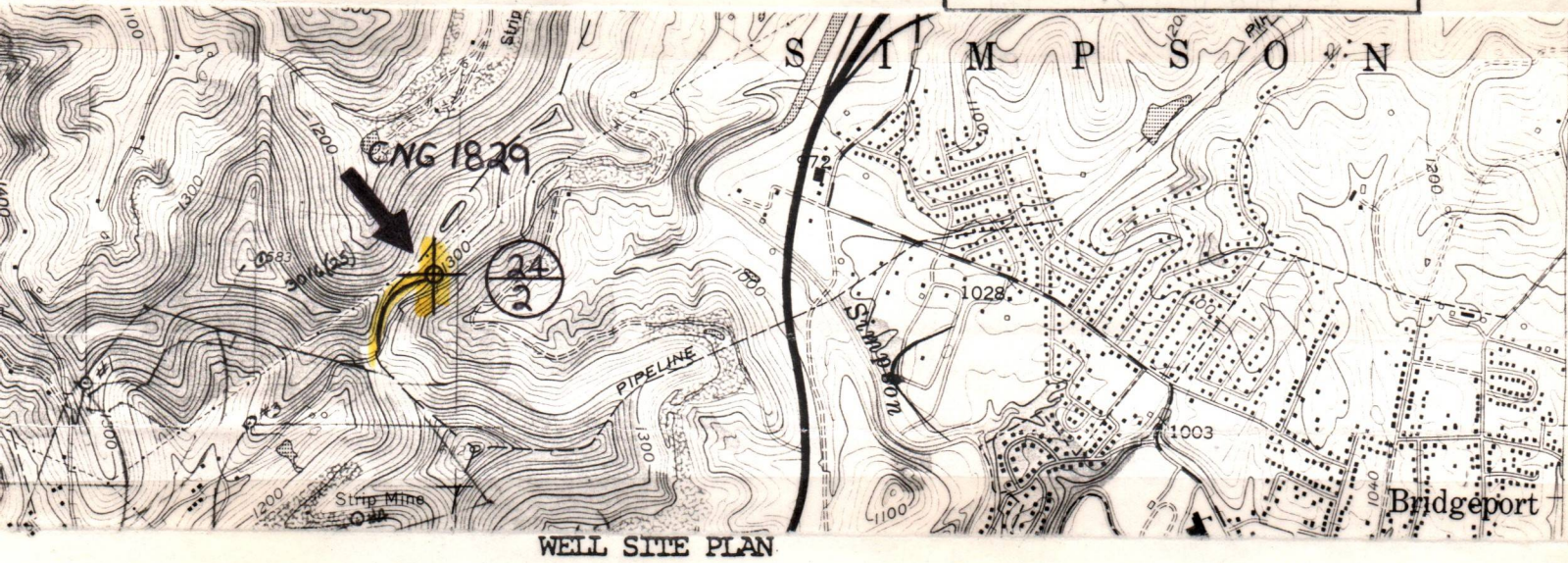









Access Road 



**WELL SITE PLAN**

Sketch to include well location, existing access road, roads to be constructed, wellsite, drilling pits and necessary structures numbered or lettered to correspond with the first part of this plan. Include all natural drainage.

**LEGEND**

Property boundary 	Diversion 
Road 	Spring 
Existing fence 	Wet spot 
Planned fence 	Building 
Stream 	Drain pipe 
Open ditch 	Waterway 

This location is on a wooded bench below a power line on the Joseph Sutton Heirs lease no. 8764. The pit will be either beyond the location or below towards Harrison Co. Rt. 24/2. The access road will gently climb up to the power line and then utilize existing CGSC well access road to run out nearly level to meet route 24/2 in the low gap.

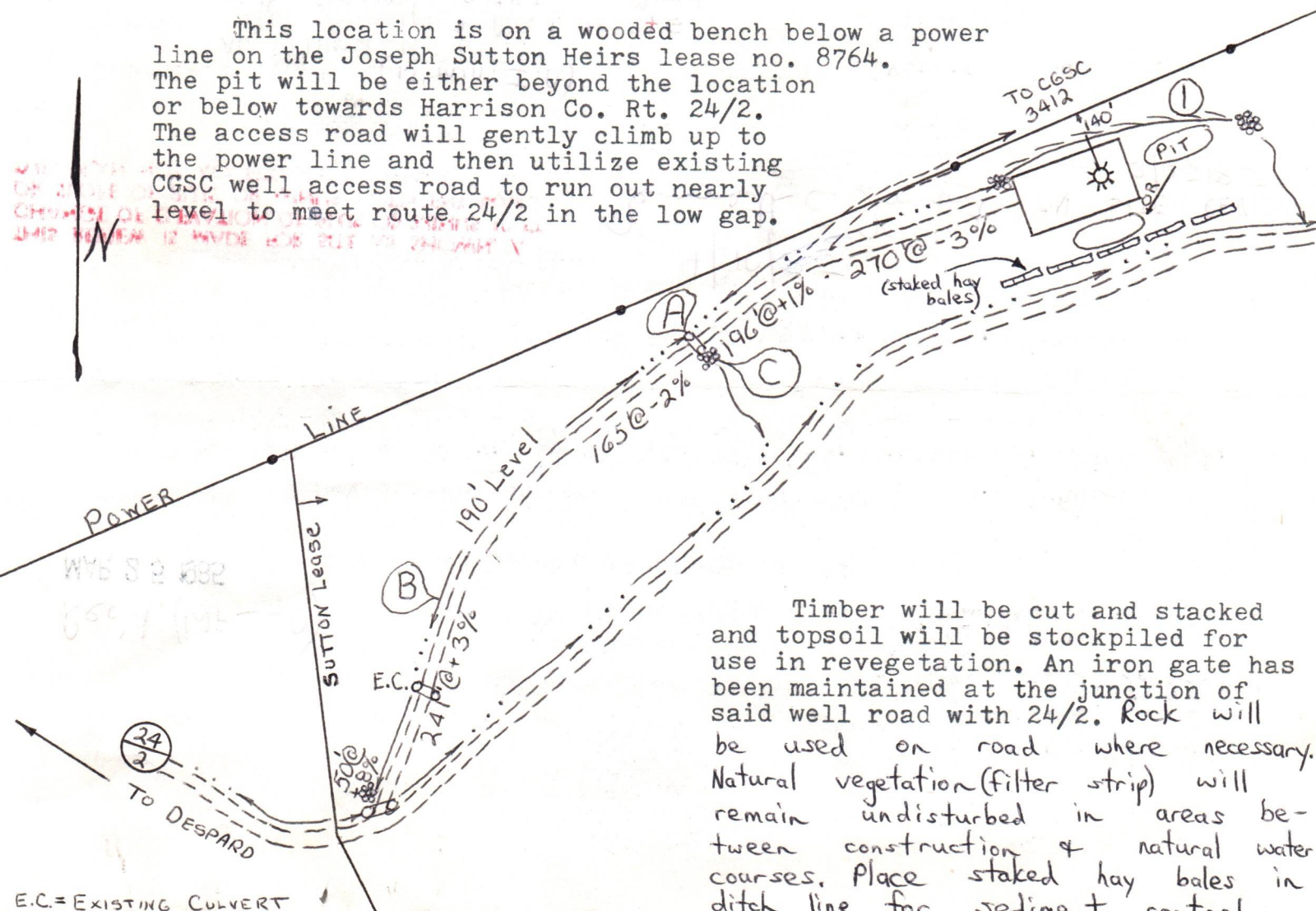

Timber will be cut and stacked and topsoil will be stockpiled for use in revegetation. An iron gate has been maintained at the junction of said well road with 24/2. Rock will be used on road where necessary. Natural vegetation (filter strip) will remain undisturbed in areas between construction & natural water courses. Place staked hay bales in ditch line for sediment control.

E.C.=EXISTING CULVERT



Rec'd. (WFSO) MAR 25 1985



State of West Virginia

Department of Mines  
Oil and Gas Division

CONSTRUCTION AND RECLAMATION PLAN

DATE March 25, 1985

WELL NO. CNGD# 1829

API NO. 047 - -033 -3222

DESIGNATED AGENT Gary A. Nicholas

Address 1 Park Ridge Ctr., Pittsburgh, PA 15244  
Address Rt. 2, Box 698, Bridgeport, WV 26330  
Telephone 412-429-2390  
Telephone 304-623-8840

SOIL CONS. DISTRICT West Fork

Revegetation to be carried out by CNG Development Co., Gary A. Nicholas (Agent)

This plan has been reviewed by West Fork SCD. All corrections

and additions become a part of this plan:

Gary A. Nicholas  
(Date) 4/10/85  
(SCD Agent)

ON SITE REVIEW 3/25/85

ACCESS ROAD

(A) Structure Culvert (15" min. I.D.)

As illustrated at natural drains & accord. to O&G Manual with riprapped outlet

Page Ref. Manual 2-7

(B) Structure Drainage Ditch

As illustrated on upper road cuts

Page Ref. Manual 2-12

(C) Structure Rip Rap

Material Stone or Timber

Page Ref. Manual 2-9

All structures should be inspected regularly and repaired if necessary. All commercial timber is to be cut and stacked and all brush and small timber to be cut and removed from the site before dirt work begins.

REVEGETATION

Treatment Area I  
Lime As determined by pH test  
Tons/acre or correct to pH 6.5

Fertilizer 600 lbs/acre

Mulch Hay or Straw 2 Tons/acre

Seed\* Kentucky 31 Rescue 3 lbs/acre

Birdsfoot Trefoil 10 lbs/acre

Domestic Rye 10 lbs/acre

\*Inoculate all legumes such as vetch, trefoil and clovers with the proper bacterium. Inoculate with 3X recommended amount.

Treatment Area II  
Lime As determined by pH test  
Tons/acre or correct to pH 6.5

Fertilizer 600 lbs/acre

Mulch Hay or Straw 2 Tons/acre

Seed\* Kentucky 31 Rescue 3 lbs/acre

Birdsfoot Trefoil 10 lbs/acre

Domestic Rye 10 lbs/acre

\*Inoculate all legumes such as vetch, trefoil and clovers with the proper bacterium.

PLAN PREPARED BY LAND SURVEYING SERVICES

ADDRESS 1412 N. 18th Street

Clarksburg, WV 26301

PHONE NO. 304-623-1214

NOTES: Please request landowner cooperation to protect new seeding for one growing season. Attach separate sheets as necessary for comments.

LOCATION	Structure	Material	Page Ref. Manual
(1) Diversion Ditch	Barthen	Material	Page Ref. Manual 2-12
(2) None	Structure None	Material	Page Ref. Manual
(C) Rip Rap	Structure None	Material	Page Ref. Manual 2-9

DEPT. OF MINES  
MUN 06 1985  
GARY A. NICHOLAS





DATE: May 17, 1985  
OPERATOR'S  
WELL NO.: 1829

API NO: 47 - 033 - 3222  
State County Permit

State of West Virginia

OFFICE OF OIL AND GAS  
DEPARTMENT OF MINES

A F F I D A V I T

State of Pennsylvania

County of Allegheny

I, Paul W. Garrett (the designated owner or operator, or authorized representative thereof), after being duly sworn, do depose and say that the undersigned is authorized by the owner of the working interest in the well permit application to which this affidavit is attached do state that (he, she, or it) shall tender to the owner of the oil and gas in place not less than one-eighth of the total amount paid to or received by or allowed to the owner of the working interest at the wellhead for the oil or gas so extracted, produced, or marketed before deducting the amount to be paid or set aside for the owner of the oil or gas in place, or all such oil or gas to be extracted, produced, or marketed from the well. West Virginia Code 22-4-11(e) (1982).

Signed: Paul W. Garrett

Taken, Subscribed, and sworn to before me this 17th day of May, 19 85.

Notary: Carl D. Mounane

My Commission Expires: December 19, 1988



RECEIVED

JUN 06 1985

OIL & GAS DIVISION  
DEPT. OF MINES





# CNG DEVELOPMENT COMPANY

ONE PARK RIDGE CENTER • P.O. BOX 15746 • PITTSBURGH, PENNSYLVANIA 15244 • (412) 787-3550

June 5, 1985

Office of Oil and Gas  
West Virginia Department of Mines  
307 Jefferson Street  
Charleston, WV 25311

Re: CNGD Well No. 1829  
Joseph Sutton Heirs  
Harrison County, WV

Gentlemen:

Enclosed is our Draft in the amount of \$350.00, Notice of Application For A Well Work Permit, Application For A Well Work Permit, Location Plat and Construction and Reclamation Plan for the above noted well.

Also enclosed are the receipts of the certified mail to the surface and coal owners.

Yours truly,

Paul W. Garrett  
Manager, Well Programs

PWG:slm

Enclosures

RECEIVED

JUN 06 1985

OIL & GAS DIVISION  
DEPT. OF MINES



PS Form 3811, July 1983 447-945

**SENDER: Complete items 1, 2, 3 and 4.**

Put your address in the "RETURN TO" space on the reverse side. Failure to do this will prevent this card from being returned to you. The return receipt fee will provide you the name of the person delivered to and the date of delivery. For additional fees the following services are available. Consult postmaster for fees and check box(es) for service(s) requested.

- 1.  Show to whom, date and address of delivery.
- 2.  Restricted Delivery.

**3. Article Addressed to:**

Vandella Betty Hines  
c/o James R. Hines  
Box 56  
Barracksville, WVA 26009

**4. Type of Service:**

- Registered
- Certified
- Express Mail
- Insured
- COD

**Article Number**

P041011073

Always obtain signature of addressee or agent and **DATE DELIVERED.**

**5. Signature - Addressee**

X *[Signature]*

**6. Signature - Agent**

X

**7. Date of Delivery**

**8. Addressee's Address (ONLY if requested and fee paid)**



UGD 1829

PS Form 3811, July 1983 447-945

**SENDER: Complete items 1, 2, 3 and 4.**

Put your address in the "RETURN TO" space on the reverse side. Failure to do this will prevent this card from being returned to you. The return receipt fee will provide you the name of the person delivered to and the date of delivery. For additional fees the following services are available. Consult postmaster for fees and check box(es) for service(s) requested.

- 1.  Show to whom, date and address of delivery.
- 2.  Restricted Delivery.

**3. Article Addressed to:**

James D La Rosa  
420 Buckhannon Pike  
Clarksburg WV 26301

**4. Type of Service:**

- Registered
- Certified
- Express Mail
- Insured
- COD

**Article Number**

P041011076

Always obtain signature of addressee or agent and **DATE DELIVERED.**

**5. Signature - Addressee**

X *[Signature]*

**6. Signature - Agent**

X

**7. Date of Delivery**

5/29/85

**8. Addressee's Address (ONLY if requested and fee paid)**



UGD 1829

PS Form 3811, July 1983 447-945

**SENDER: Complete items 1, 2, 3 and 4.**

Put your address in the "RETURN TO" space on the reverse side. Failure to do this will prevent this card from being returned to you. The return receipt fee will provide you the name of the person delivered to and the date of delivery. For additional fees the following services are available. Consult postmaster for fees and check box(es) for service(s) requested.

- 1.  Show to whom, date and address of delivery.
- 2.  Restricted Delivery.

**3. Article Addressed to:**

Fresa Construction Company  
Box 187  
Bridgeport, WV 26330

**4. Type of Service:**

- Registered
- Certified
- Express Mail
- Insured
- COD

**Article Number**

P041011075

Always obtain signature of addressee or agent and **DATE DELIVERED.**

**5. Signature - Addressee**

X *[Signature]*

**6. Signature - Agent**

X

**7. Date of Delivery**

**8. Addressee's Address (ONLY if requested and fee paid)**



UGD 1829

PS Form 3811, July 1983 447-945

**SENDER: Complete items 1, 2, 3 and 4.**

Put your address in the "RETURN TO" space on the reverse side. Failure to do this will prevent this card from being returned to you. The return receipt fee will provide you the name of the person delivered to and the date of delivery. For additional fees the following services are available. Consult postmaster for fees and check box(es) for service(s) requested.

- 1.  Show to whom, date and address of delivery.
- 2.  Restricted Delivery.

**3. Article Addressed to:**

James Joseph La Rosa  
3 Club View Drive  
Bridgeport, WV 26330

**4. Type of Service:**

- Registered
- Certified
- Express Mail
- Insured
- COD

**Article Number**

P041011074

Always obtain signature of addressee or agent and **DATE DELIVERED.**

**5. Signature - Addressee**

X *[Signature]*

**6. Signature - Agent**

X

**7. Date of Delivery**

**8. Addressee's Address (ONLY if requested and fee paid)**



UGD 1829

DOMESTIC RETURN RECEIPT

DOMESTIC RETURN RECEIPT



~ ~

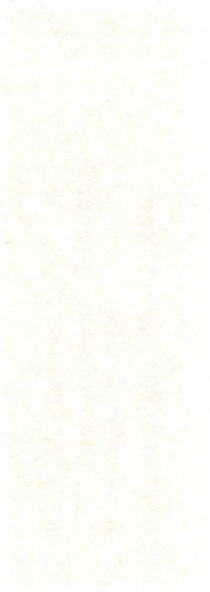

~ ~

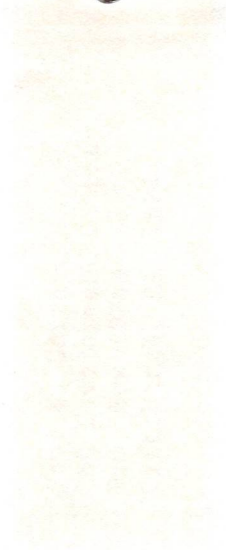

~  
~

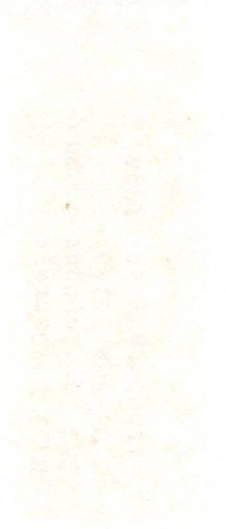

~  
~

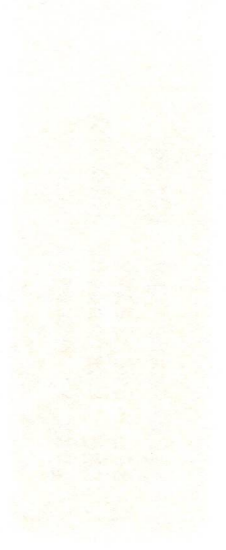

~ ~

~ ~



DETAILS OF PERFORATED INTERVALS, FRACTURING OR STIMULATING, PHYSICAL CHANGE, ETC.

Superior Wireline Perforated Benson 4712-4781; 12 holes; .39  
 Speechley 3362-3462; 12 holes; .39  
 Halliburton 75-Q Foam 1st stage - Gel System 20, Break 3850, Ave. HHP 2, Ave. Rate 16,  
 Ave. Pres. 2800, Max. Tr. Pres. 3460, 500 gal 15% FE Acid, 50,000# 20/40 Sand,  
 640 BBL Total Fluid, ISIP 2020, 503,000 Total Nitrogen (SCF)  
 2nd stage - Gel System 20, Break 4000, Ave. HHP 2, Ave. Rate 20,  
 Ave. Pres. 2700, Max. Tr. Pres. 3160, 500 gal 15% FE Acid, 40,000# 20/40 Sand,  
 326 BBL Total Fluid, ISIP 1600, 5 min SIP 1400, 375,000 Total Nitrogen (SCF)

WELL LOG

FORMATION	COLOR	HARD OR SOFT	TOP FEET	BOTTOM FEET	REMARKS Including indication of all fresh and salt water, coal, oil and gas
Dirt			0	15	Hole Damp @ 1210'
Sand & Shale			15	260	
Open Hole			260	280	
Sand, Shale & RR			280	785	
Coal			785	790	
Sand, Shale & RR			790	1700	
Lime & Shale			1700	1730	
Lime			1730	1790	
Sand & Shale			1790	4932	
<u>LOG TOPS</u>					
Big Lime/B. Injun			1715	1898	
Gantz A			2240	2282	
50 Foot			2292	2402	
4th Sand			2600	2662	
5th Sand			2746	2793	
U. Speechley/Speechley			3335	3468	
Balltown			3567	3810	
Bradford			4044	4120	
Riley			4500	4686	
Benson			4716	4784	

(Attach separate sheets as necessary)

CNG DEVELOPMENT COMPANY

Well Operator

By: Sary A. Nelson

Date: August 1, 1985

Note: Regulation 2.02(i) provides as follows:  
 "The term 'log' or 'well log' shall mean a systematic  
 detailed geological record of all formations, including  
 those encountered in the drilling of a well."



IV-35  
(Rev 8-81)



**RECEIVED**  
AUG 15 1985  
DIVISION OF OIL & GAS  
DEPARTMENT OF ENERGY

State of West Virginia  
Department of Mines  
Oil and Gas Division

Date August 1, 1985  
Operator's  
Well No. CNGD WN 1829  
Farm Joseph Sutton Heirs  
API No. 47 - 033 - 3222

WELL OPERATOR'S REPORT  
OF  
DRILLING, FRACTURING AND/OR STIMULATING, OR PHYSICAL CHANGE

WELL TYPE: Oil      / Gas X / Liquid Injection      / Waste Disposal      /  
(If "Gas," Production X / Underground Storage      / Deep      / Shallow X /)

LOCATION: Elevation: 1308 Watershed Simpson Creek  
District: Simpson County Harrison Quadrangle Clarksburg

COMPANY CNG Development Company

ADDRESS P. O. Box 15746  
Pittsburgh, PA 15244

DESIGNATED AGENT Gary A. Nicholas

ADDRESS Rt. 2 Box 698  
Bridgeport, WV 26330

SURFACE OWNER Vandilla Fetty

ADDRESS c/o James R. Ice, Sr., Box 56,  
Barrackville, WV 26559

MINERAL RIGHTS OWNER Joseph Sutton Heirs

ADDRESS Catherine E. Warner - life estate  
Rt. 2 Box 18A, Bristol, WV 26332

OIL AND GAS INSPECTOR FOR THIS WORK

Stephen Casey ADDRESS Rt. 2 Box 232D  
Jane Lew, WV 26378

PERMIT ISSUED June 28, 1985

DRILLING COMMENCED July 11, 1985

DRILLING COMPLETED July 19, 1985

IF APPLICABLE: PLUGGING OF DRY HOLE ON  
CONTINUOUS PROGRESSION FROM DRILLING OR  
REWORKING. VERBAL PERMISSION OBTAINED  
ON     

Casing Tubing Size	Used in Drilling	Left in Well	Cement fill up Cu. ft.
20-16 Cord.			
13-10"	317	317	To Surf
9 5/8			
8 5/8	966	966	To Surf
7			
5 1/2			
4 1/2	4868	4868	410 sks
3			
2			
Liners used			

GEOLOGICAL TARGET FORMATION Benson Depth 4925 feet

Depth of completed well 4932 feet Rotary X / Cable Tools     

Water strata depth: Fresh Damp <sup>1210</sup> feet; Salt      feet

Coal seam depths: 785 - 790 Is coal being mined in the area? No

OPEN FLOW DATA

Producing formation Benson Speechley Pay zone depth 4712 - 4781  
3362 - 3462 feet

Gas: Initial open flow      Mcf/d Oil: Initial open flow      Bbl/d

Final open flow 919 Mcf/d Final open flow      Bbl/d

Time of open flow between initial and final tests 4 hours

Static rock pressure 350 psig (surface measurement) after 1 hours shut in

(If applicable due to multiple completion--)

Second producing formation      Pay zone depth      feet

Gas: Initial open flow      Mcf/d Oil: Initial open flow      Bbl/d

Final open flow      Mcf/d Oil: Final open flow      Bbl/d

Time of open flow between initial and final tests      hours

Static rock pressure      psig (surface measurement) after      hours shut in

(Continue on reverse side)



STATE OF WEST VIRGINIA  
DEPARTMENT OF MINES  
OIL AND GAS WELLS DIVISION

RECEIVED

JUL 16 1985

INSPECTOR'S WELL REPORT OIL & GAS DIVISION

DEPT. OF MINES  
Oil or Gas Well  
(KIND)

Permit No. 33-3222

Company CNG Drilling

Address \_\_\_\_\_

Farm V Fatty

Well No. 1829

District Simpson County Harr.

Drilling commenced 7-12-85

Drilling completed \_\_\_\_\_ Total depth \_\_\_\_\_

Date shot \_\_\_\_\_ Depth of shot \_\_\_\_\_

Initial open flow \_\_\_\_\_ /10ths Water in \_\_\_\_\_ Inch

Open flow after tubing \_\_\_\_\_ /10ths Merc. in \_\_\_\_\_ Inch

Volume \_\_\_\_\_ Cu. Ft.

Rock pressure \_\_\_\_\_ lbs. \_\_\_\_\_ hrs.

Oil \_\_\_\_\_ bbls., 1st 24 hrs.

Fresh water \_\_\_\_\_ feet \_\_\_\_\_ feet

Salt water \_\_\_\_\_ feet \_\_\_\_\_ feet

CASING AND TUBING	USED IN DRILLING	LEFT IN WELL	PACKERS
Size			
16			Kind of Packer _____
13			
10			Size of _____
8 1/4			
6 5/8			Depth set _____
5 3/16			
3			Perf. top _____
2			Perf. bottom _____
Liners Used			Perf. top _____
			Perf. bottom _____

CASING CEMENTED \_\_\_\_\_ SIZE \_\_\_\_\_ No. FT. \_\_\_\_\_ Date \_\_\_\_\_

NAME OF SERVICE COMPANY \_\_\_\_\_

COAL WAS ENCOUNTERED AT \_\_\_\_\_ FEET \_\_\_\_\_ INCHES

\_\_\_\_\_ FEET \_\_\_\_\_ INCHES \_\_\_\_\_ FEET \_\_\_\_\_ INCHES

\_\_\_\_\_ FEET \_\_\_\_\_ INCHES \_\_\_\_\_ FEET \_\_\_\_\_ INCHES

Drillers' Names SWJ 19

Remarks: open shaft 260 to 280'  
11 3/4' 318' 150 sacks Halliburton

7-12-85  
DATE

Steve Casey  
DISTRICT WELL INSPECTOR



STATE OF WEST VIRGINIA  
DEPARTMENT OF MINES  
OIL AND GAS WELLS DIVISION

**INSPECTOR'S PLUGGING REPORT**

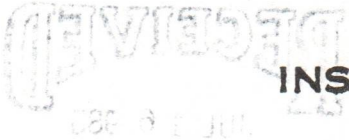

Permit No. \_\_\_\_\_ Well No. \_\_\_\_\_

COMPANY \_\_\_\_\_ ADDRESS \_\_\_\_\_

FARM \_\_\_\_\_ DISTRICT \_\_\_\_\_ COUNTY \_\_\_\_\_

Filling Material Used \_\_\_\_\_

Liner	Location	Amount	Packer	Location		
PLUGS USED AND DEPTH PLACED			BRIDGES	CASING AND TUBING		
CEMENT-THICKNESS	WOOD-SIZE	LEAD	CONSTRUCTION-LOCATION	RECOVERED	SIZE	LOST

Drillers' Names \_\_\_\_\_

Remarks:

\_\_\_\_\_ I hereby certify I visited the above well on this date.  
DATE

\_\_\_\_\_ DISTRICT WELL INSPECTOR



STATE OF WEST VIRGINIA  
DEPARTMENT OF MINES  
OIL AND GAS WELLS DIVISION

**RECEIVED**  
JUL 23 1985  
OIL & GAS DIVISION  
DEPT. OF MINES

INSPECTOR'S WELL REPORT

Permit No. 33-3222

Oil or Gas Well \_\_\_\_\_  
(KIND)

Company <u>CN G Devel.</u>	CASING AND TUBING	USED IN DRILLING	LEFT IN WELL	PACKERS
Address _____	Size			
Farm <u>Fetty</u>	16			Kind of Packer _____
Well No. <u>1329</u>	13			
District <u>Simpson</u> County <u>Harr.</u>	10			Size of _____
Drilling commenced _____	8 1/4			
Drilling completed _____ Total depth _____	6 5/8			Depth set _____
Date shot _____ Depth of shot _____	5 3/16			
Initial open flow _____ /10ths Water in _____ Inch	3			Perf. top _____
Open flow after tubing _____ /10ths Merc. in _____ Inch	2			Perf. bottom _____
Volume _____ Cu. Ft.	Liners Used _____			Perf. top _____
Rock pressure _____ lbs. _____ hrs.				Perf. bottom _____
Oil _____ bbls., 1st 24 hrs.	CASING CEMENTED <u>8 5/8</u> SIZE <u>966'</u> No. FT. <u>200</u> st. Date _____			
Fresh water _____ feet _____ feet	NAME OF SERVICE COMPANY <u>Halliburton</u>			
Salt water _____ feet _____ feet	COAL WAS ENCOUNTERED AT <u>785</u> FEET <u>60</u> INCHES			
	FEET	INCHES	FEET	INCHES
	FEET	INCHES	FEET	INCHES

Drillers' Names 3 WJ 19

Remarks: dr. 2830'

7-18-85  
DATE

Steve Casey  
DISTRICT WELL INSPECTOR







NIR-20  
Obverse  
7-85

21-Aug-85

1 OCT 05 12:46

REC'D - CHAS.

STATE OF WEST VIRGINIA  
DEPARTMENT OF ENERGY  
OIL AND GAS DIVISION  
CHARLESTON 25305  
FINAL INSPECTION REPORT  
INSPECTOR'S COMPLIANCE REPORT

Company: CNG DEVELOPMENT COMPANY  
Perm: FETTY, VANDILLA Well: 1829

Permit No: 47-33-3222 (6-28-85)  
County: HARRISON

Rule	Description	In Compliance	
		Yes	No
23.06	Notification prior to starting work		
25.04	Prepared before drilling to prevent waste		
25.03	High pressure drilling		
16.01	Required permits at well site		
15.03	Adequate Fresh Water Casing		
15.02	Adequate Coal Casing		
15.01	Adequate Production Casing		
15.04	Adequate Cement Strength		
15.05	Cement Type		
23.02	Maintained Access Roads		
25.01	Necessary Equipment to Prevent Waste		
23.04	Reclaimed Drilling Pits		
23.05	No Surface or Underground Pollution		
23.07	Requirements for Production & Gathering Pipelines		
6.01	Well Records on Site		
6.02	Well Records Filed		
7.05	Identification Markings		

I HAVE INSPECTED THE ABOVE CAPTIONED WELL AND RECOMMEND THAT IT BE RELEASED:

SIGNED: *Steve Casey*  
DATE: *9-24-85*

Your well record was received and reclamation requirements approved. In accordance with Chapter 22B, Article 1, Section 26, the above well will remain under bond coverage for the life of the well.

10110  
CNG DEVELOPMENT COMPANY  
P.O. BOX 10746  
PITTSBURGH, PA 15244-0000

*T.H. r. Bb*  
Director-Oil and Gas Division

October 9, 1985  
Date



MU 6-27-85

LATITUDE 39° 20' 00"

WELL REFERENCES:

N33°30'E, 151.50' TO 2" RED MAPLE  
N29°W, 73' TO 9" WHITE ASH

SHAW

CALOCCIA

SHAW

LONGITUDE 80° 17' 30"

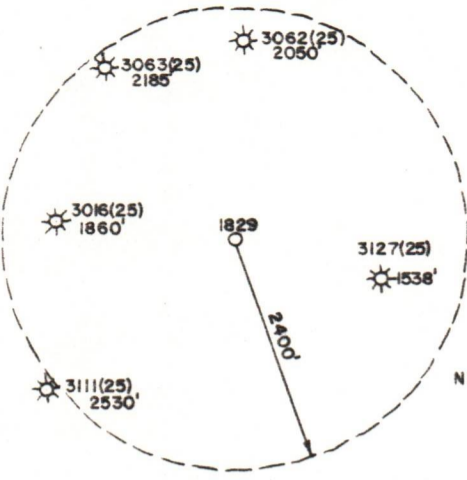

WINTER

JOSEPH SUTTON, HEIRS  
400 AC SURF, O-G.  
PART. PLAT-D.B. 335/95

WACOWSKI

N51°30'E, 4008'

LOT NO. 7  
245 AC.

CNGD  
1829

N38°21'E  
1049.45'

SPIKE  
IN G

STONE

NORTH

SUTTON

BLAKE  
S59°20'W, 584'  
S72°30'W, 263'

BLAKE

SIMPSON

CREEK

S66°45'W, 867'

FEOPPEL

LAROSA

7.5 MIN.

- A) S33°E, 300'
- B) S9°E, 107'
- C) S22°30'E, 240'
- D) S10°E, 161'
- E) S19°E, 227'
- F) S31°45'E, 217'
- G) S57°E, 157'
- H) S77°30'E, 115'
- I) N79°30'E, 195'
- J) N75°30'E, 521'

- K) N79°E, 190'
- L) N80°30'E, 187'
- M) N83°30'E, 147'
- N) S88°15'E, 199'
- O) S71°30'E, 148.50'
- P) S55°E, 129.50'
- Q) S46°E, 134'
- R) S30°45'E, 127'
- S) S20°30'E, 168'
- T) S3°E, 166'

- U) S8°45'W, 331'
- V) S15°W, 269'
- W) S6°45'E, 161.50'
- X) S14°30'E, 374.50'
- Y) S11°30'W, 147'
- Z) S32°W, 74'

- 1) S81°30'W, 154'
- 2) N78°W, 235'
- 3) S76°W, 182'

LAND SURVEYING SERVICES  
1412 NORTH 18 TH ST.  
CLARKSBURG, WV 26301  
PHONE: 304-623-1214

L.R.H. 5-10-85

(+) DENOTES LOCATION OF WELL ON UNITED STATES TOPOGRAPHIC MAPS

FILE NO. \_\_\_\_\_  
DRAWING NO. \_\_\_\_\_  
SCALE 1" = 1,000'  
MINIMUM DEGREE OF ACCURACY 1 in 2500  
PROVEN SOURCE OF ELEVATION TOP OF KNOB 1985' WEST OF LOCATION ELEVATION 1583'

I THE UNDERSIGNED, HEREBY CERTIFY THAT THIS PLAT IS CORRECT TO THE BEST OF MY KNOWLEDGE AND BELIEF AND SHOWS ALL THE INFORMATION REQUIRED BY LAW AND THE REGULATIONS ISSUED AND PRESCRIBED BY THE DEPARTMENT OF MINES.  
(SIGNED) *Stephen D. Losh*  
R.P.E. \_\_\_\_\_ L.L.S. NO. 674  
STEPHEN D. LOSH

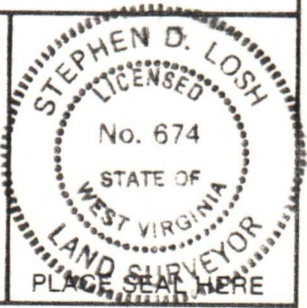

STATE OF WEST VIRGINIA  
DEPARTMENT OF MINES  
OIL AND GAS DIVISION



DATE MARCH 22, 19 85  
OPERATOR'S WELL NO. CNGD 1829  
API WELL NO. \_\_\_\_\_

47 - 033 - 3222  
STATE COUNTY PERMIT

WELL TYPE: OIL \_\_\_ GAS X LIQUID INJECTION \_\_\_ WASTE DISPOSAL \_\_\_  
(IF "GAS,") PRODUCTION X STORAGE \_\_\_ DEEP \_\_\_ SHALLOW X  
LOCATION: ELEVATION 1308' WATER SHED SIMPSON CREEK  
DISTRICT SIMPSON COUNTY HARRISON  
QUADRANGLE CLARKSBURG 7.5 minute

SURFACE OWNER VANDILLA FETTY ACREAGE 24.50  
OIL & GAS ROYALTY OWNER JOSEPH SUTTON, HEIRS LEASE ACREAGE 400  
LEASE NO. 8764

PROPOSED WORK: DRILL X CONVERT \_\_\_ DRILL DEEPER \_\_\_ REDRILL \_\_\_ FRACTURE OR STIMULATE \_\_\_ PLUG OFF OLD FORMATION X PERFORATE NEW FORMATION \_\_\_ OTHER PHYSICAL CHANGE IN WELL (SPECIFY) \_\_\_\_\_

PLUG AND ABANDON \_\_\_ CLEAN OUT AND REPLUG \_\_\_

TARGET FORMATION BENSON ESTIMATED DEPTH 4925'  
WELL OPERATOR CNG DEVELOPMENT COMPANY DESIGNATED AGENT GARY A. NICHOLAS  
ADDRESS 1 PARK RIDGE CENTER ADDRESS ROUTE 2, BOX 698  
PITTSBURGH, PA. 15244 BRIDGEPORT, WV 26330

FORM IV-6 (8-78)

COUNTY NAME

PERMIT