



Ford Unit 1H
Harrison County West Virginia
 Northing: 14254490.84
 Easting: 1764889.92



To convert Magnetic North to Grid, Subtract 8.90°
 To convert True North to Grid, Subtract 0.28°

Azimuths to Grid North
 True North: -0.28°
 Magnetic North: -8.90°

Magnetic Field
 Strength: 52205.6snT
 Dip Angle: 66.81°
 Date: 7/2/2014
 Model: BGGM2014

WELL DETAILS							
Ground Level: 1374.0							
+N/-S	+E/-W	Northing	Easting	Latitude	Longitude		
0.0	0.0	14254490.84	1764889.92	39° 15' 12.130 N	80° 33' 37.070 W		

Genie Lightfoot
 14.03, August 27 2014

Scientific Drilling
 421 South Eagle Lane
 Oklahoma City, OK 73123

SITE DETAILS: Ruth/Norris/Nellie/Ford Pad
 Site Center: Ruth Unit 2H
 Site Centre Northing: 14254530.66
 Easting: 1764845.07
 Positional Uncertainty: 2.0
 Convergence: 0.28
 Local North: Grid

PROJECT DETAILS: Harrison County West Virginia
 Geodetic System: Universal Transverse Mercator (US Survey Feet)
 Datum: NAD 1927 (NADCON CONUS)
 Ellipsoid: Clarke 1866
 Zone: Zone 17N (84 W to 78 W)
 System Datum: Mean Sea Level

LEGEND

- Ford Unit 1H, Original Wellpath, Plan 5 V0
- As Drilled

DESIGN TARGET DETAILS							
Name	TVD	+N/-S	+E/-W	Northing	Easting	Latitude	Longitude
SHL Ford Unit 1H	0.0	0.0	0.0	14254490.84	1764889.92	39° 15' 12.130 N	80° 33' 37.070 W
Actual BHL Ford Unit 1H	7546.3	9685.9	-1837.514264176.74	1763052.4339	16° 47.987 N	80° 33' 59.847 W	

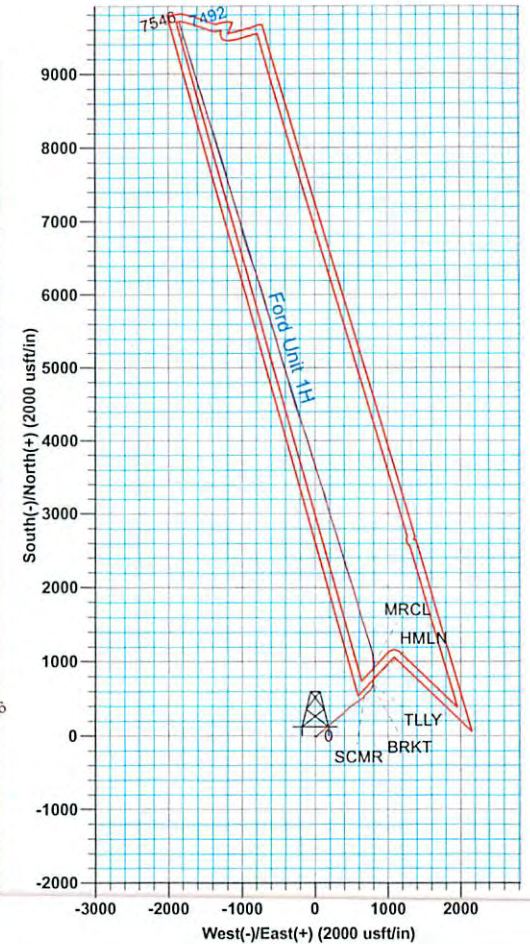
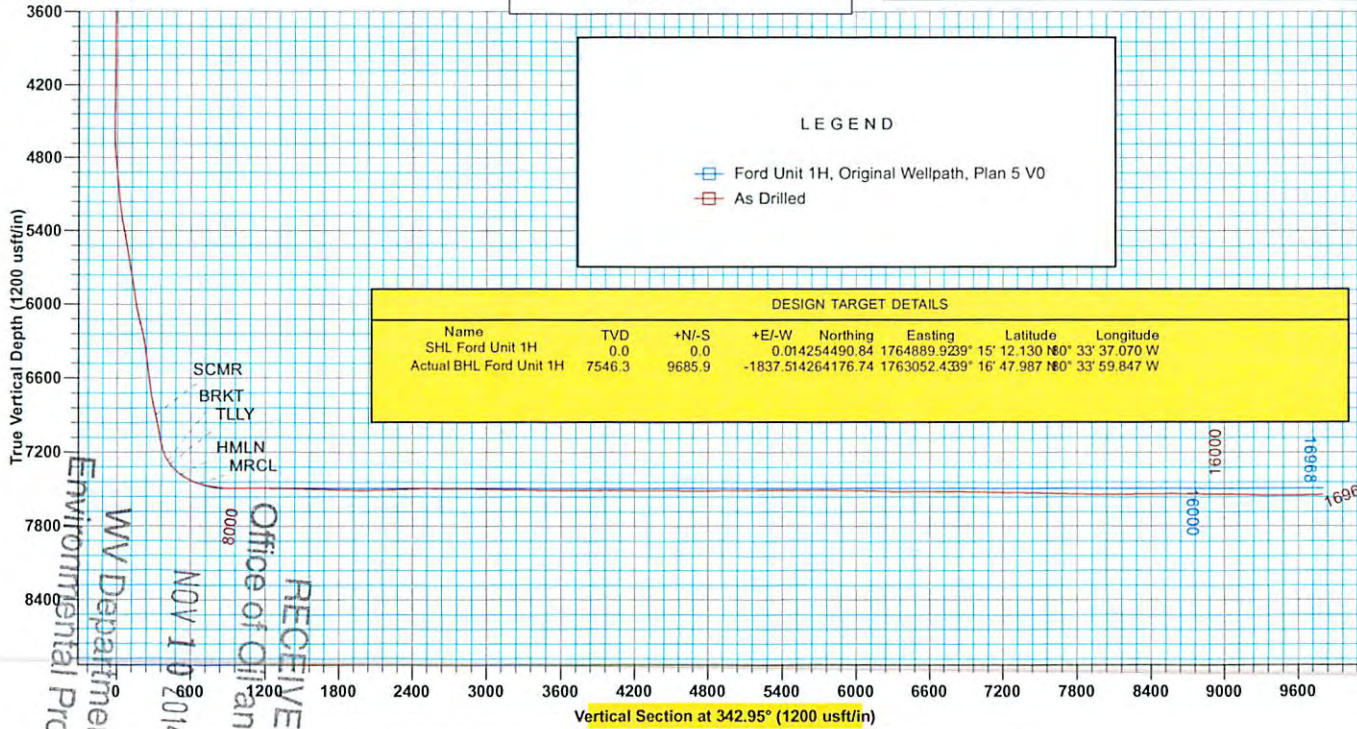

Patterson 340: GL 1374' + 24' RKB @ 1398.0usft
 1374.0

33.05702

RECEIVED
 Office of Oil and Gas
 NOV 10 2014
 WV Department of
 Environmental Protection

33.05702



Antero Resources

Harrison County West Virginia
Ruth/Norris/Nellie/Ford Pad
Ford Unit 1H
Original Wellpath

Design: As Drilled

EOW Completion Report

27 August, 2014



RECEIVED
Office of Oil and Gas
November 10, 2014

WV Department of
Environmental Protection
11/28/2014

33.05702



EOW Completion Report

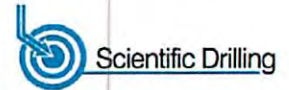

Company:	Antero Resources	Local Co-ordinate Reference:	Well Ford Unit 1H
Project:	Harrison County West Virginia	TVD Reference:	Patterson 340: GL 1374' + 24' RKB @ 1398.0usft
Site:	Ruth/Norris/Nellie/Ford Pad	MD Reference:	Patterson 340: GL 1374' + 24' RKB @ 1398.0usft
Well:	Ford Unit 1H	North Reference:	Grid
Wellbore:	Original Wellpath	Survey Calculation Method:	Minimum Curvature
Design:	As Drilled	Database:	Oklahoma District

Project	Harrison County West Virginia, Harrison County, USA		
Map System:	Universal Transverse Mercator (US Survey Fee	System Datum:	Mean Sea Level
Geo Datum:	NAD 1927 (NADCON CONUS)		
Map Zone:	Zone 17N (84 W to 78 W)		

Site	Ruth/Norris/Nellie/Ford Pad				
Site Position:		Northing:	14,254,530.66 usft	Latitude:	39° 15' 12.526 N
From:	Map	Easting:	1,764,845.07 usft	Longitude:	80° 33' 37.638 W
Position Uncertainty:	2.0 usft	Slot Radius:	13-3/16"	Grid Convergence:	0.28 °

Well	Ford Unit 1H					
Well Position	+N/-S	0.0 usft	Northing:	14,254,490.84 usft	Latitude:	39° 15' 12.130 N
	+E/-W	0.0 usft	Easting:	1,764,889.92 usft	Longitude:	80° 33' 37.070 W
Position Uncertainty		2.0 usft	Wellhead Elevation:	1,398.0 usft	Ground Level:	1,374.0 usft

Wellbore	Original Wellpath
-----------------	-------------------

Magnetics	Model Name	Sample Date	Declination (°)	Dip Angle (°)	Field Strength (nT)
	BGGM2014	7/2/2014	-8.62	66.81	52,206

Design	As Drilled
---------------	------------

Audit Notes:					
Version:	1.0	Phase:	ACTUAL	Tie On Depth:	0.0
Vertical Section:	Depth From (TVD) (usft)	+N/-S (usft)	+E/-W (usft)	Direction (°)	
	0.0	0.0	0.0	342.95	

Survey Program	Date	8/27/2014			
From (usft)	To (usft)	Survey (Wellbore)	Tool Name	Description	
95.7	7,174.9	Survey #6 Gyro to KOP (Original Wellpath)	SDI Standard Keeper	Scientific Drilling Intl. Standard Wireline Keeper	
7,175.0	16,966.0	Survey #7 MWD (Original Wellpath)	SDI MWD	Scientific Drilling Intl. MWD - Standard ver 1.0.1	

MD (usft)	Inc (°)	Azi (azimuth) (°)	TVD (usft)	N/S (usft)	E/W (usft)	V. Sec (usft)	DLeg (°/100usft)
0.0	0.00	0.00	0.0	0.0	0.0	0.0	0.00
95.7	0.20	300.40	95.7	0.1	-0.1	0.1	0.21
120.7	0.05	154.57	120.7	0.1	-0.2	0.1	0.97
145.7	0.04	40.68	145.7	0.1	-0.2	0.1	0.30
170.7	0.09	27.36	170.7	0.1	-0.2	0.2	0.21
195.7	0.17	10.74	195.7	0.2	-0.1	0.2	0.35
220.7	0.19	338.26	220.7	0.2	-0.1	0.3	0.41
245.7	0.17	310.31	245.7	0.3	-0.2	0.4	0.36
270.7	0.10	217.02	270.7	0.3	-0.2	0.4	0.81
295.7	0.13	179.99	295.7	0.3	-0.2	0.3	0.31
320.7	0.13	157.85	320.7	0.2	-0.2	0.3	0.20

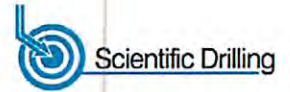

Company:	Antero Resources	Local Co-ordinate Reference:	Well Ford Unit 1H
Project:	Harrison County West Virginia	TVD Reference:	Patterson 340: GL 1374' + 24' RKB @ 1398.0usft
Site:	Ruth/Norris/Nellie/Ford Pad	MD Reference:	Patterson 340: GL 1374' + 24' RKB @ 1398.0usft
Well:	Ford Unit 1H	North Reference:	Grid
Wellbore:	Original Wellpath	Survey Calculation Method:	Minimum Curvature
Design:	As Drilled	Database:	Oklahoma District

Survey							
MD (usft)	Inc (°)	Azi (azimuth) (°)	TVD (usft)	N/S (usft)	E/W (usft)	V. Sec (usft)	DLeg (°/100usft)
345.7	0.10	123.60	345.7	0.2	-0.2	0.2	0.29
370.7	0.06	57.84	370.7	0.2	-0.2	0.2	0.37
395.7	0.05	19.44	395.7	0.2	-0.2	0.2	0.15
420.7	0.03	136.96	420.7	0.2	-0.2	0.2	0.28
445.7	0.21	166.83	445.7	0.1	-0.1	0.2	0.74
470.7	0.31	163.16	470.7	0.0	-0.1	0.1	0.41
495.7	0.27	148.34	495.7	-0.1	-0.1	-0.1	0.34
520.7	0.28	134.67	520.7	-0.2	0.0	-0.2	0.26
545.7	0.28	123.61	545.7	-0.2	0.1	-0.3	0.22
570.7	0.25	123.13	570.7	-0.3	0.2	-0.4	0.12
595.7	0.13	130.57	595.7	-0.4	0.3	-0.4	0.49
620.7	0.22	177.71	620.7	-0.4	0.3	-0.5	0.65
645.7	0.23	171.23	645.7	-0.5	0.3	-0.6	0.11
670.7	0.32	169.77	670.7	-0.6	0.3	-0.7	0.36
695.7	0.37	149.49	695.7	-0.8	0.4	-0.9	0.52
720.7	0.34	142.36	720.7	-0.9	0.5	-1.0	0.21
745.7	0.40	139.24	745.7	-1.0	0.6	-1.2	0.25
770.7	0.26	127.50	770.7	-1.1	0.7	-1.3	0.62
795.7	0.14	133.14	795.7	-1.2	0.7	-1.4	0.49
820.7	0.11	170.14	820.7	-1.2	0.8	-1.4	0.34
845.7	0.13	164.31	845.7	-1.3	0.8	-1.5	0.09
870.7	0.17	186.97	870.7	-1.4	0.8	-1.5	0.28
895.7	0.23	199.28	895.7	-1.4	0.8	-1.6	0.29
920.7	0.25	180.03	920.7	-1.5	0.7	-1.7	0.33
945.7	0.31	183.57	945.7	-1.7	0.7	-1.8	0.25
970.7	0.28	164.03	970.7	-1.8	0.8	-1.9	0.42
995.7	0.20	130.30	995.7	-1.9	0.8	-2.0	0.64
1,020.7	0.09	108.88	1,020.7	-1.9	0.9	-2.1	0.48
1,045.7	0.08	105.80	1,045.7	-1.9	0.9	-2.1	0.04
1,070.7	0.02	236.99	1,070.7	-1.9	0.9	-2.1	0.38
1,095.7	0.08	274.73	1,095.7	-1.9	0.9	-2.1	0.26
1,120.7	0.10	224.46	1,120.7	-1.9	0.8	-2.1	0.31
1,145.7	0.15	230.29	1,145.7	-2.0	0.8	-2.1	0.21
1,170.7	0.21	171.98	1,170.7	-2.0	0.8	-2.2	0.73
1,195.7	0.07	138.98	1,195.7	-2.1	0.8	-2.2	0.62
1,220.7	0.05	196.16	1,220.7	-2.1	0.8	-2.3	0.24
1,245.7	0.03	115.94	1,245.7	-2.1	0.8	-2.3	0.22
1,270.7	0.05	23.17	1,270.7	-2.1	0.8	-2.3	0.24
1,295.7	0.08	302.54	1,295.7	-2.1	0.8	-2.3	0.35
1,320.7	0.17	274.29	1,320.7	-2.1	0.8	-2.2	0.43
1,345.7	0.08	232.82	1,345.7	-2.1	0.7	-2.2	0.49
1,370.7	0.17	238.70	1,370.7	-2.1	0.7	-2.2	0.36
1,395.7	0.15	217.58	1,395.7	-2.2	0.6	-2.3	0.25
1,420.7	0.22	185.01	1,420.7	-2.3	0.6	-2.3	0.49

33.05702



EOW Completion Report

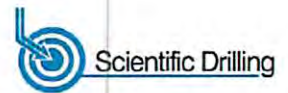

Company:	Antero Resources	Local Co-ordinate Reference:	Well Ford Unit 1H
Project:	Harrison County West Virginia	TVD Reference:	Patterson 340: GL 1374' + 24' RKB @ 1398.0usft
Site:	Ruth/Norris/Nellie/Ford Pad	MD Reference:	Patterson 340: GL 1374' + 24' RKB @ 1398.0usft
Well:	Ford Unit 1H	North Reference:	Grid
Wellbore:	Original Wellpath	Survey Calculation Method:	Minimum Curvature
Design:	As Drilled	Database:	Oklahoma District

Survey							
MD (usft)	Inc (°)	Azi (azimuth) (°)	TVD (usft)	N/S (usft)	E/W (usft)	V. Sec (usft)	DLeg (°/100usft)
1,445.7	0.09	191.34	1,445.7	-2.3	0.6	-2.4	0.52
1,470.7	0.04	73.85	1,470.7	-2.3	0.6	-2.4	0.46
1,495.7	0.09	308.90	1,495.7	-2.3	0.6	-2.4	0.47
1,520.7	0.12	265.91	1,520.7	-2.3	0.5	-2.4	0.33
1,545.7	0.16	242.12	1,545.7	-2.3	0.5	-2.4	0.28
1,570.7	0.22	243.96	1,570.7	-2.4	0.4	-2.4	0.24
1,595.7	0.36	224.99	1,595.7	-2.4	0.3	-2.4	0.67
1,620.7	0.29	207.18	1,620.7	-2.6	0.2	-2.5	0.49
1,645.7	0.26	199.80	1,645.7	-2.7	0.2	-2.6	0.19
1,670.7	0.23	184.31	1,670.7	-2.8	0.2	-2.7	0.29
1,695.7	0.15	159.18	1,695.7	-2.8	0.2	-2.8	0.45
1,720.7	0.08	241.73	1,720.7	-2.9	0.2	-2.8	0.64
1,745.7	0.17	229.94	1,745.7	-2.9	0.1	-2.8	0.37
1,770.7	0.28	252.56	1,770.7	-3.0	0.0	-2.8	0.56
1,795.7	0.31	238.81	1,795.7	-3.0	-0.1	-2.9	0.31
1,820.7	0.34	235.71	1,820.7	-3.1	-0.2	-2.9	0.14
1,845.7	0.23	213.46	1,845.7	-3.2	-0.3	-2.9	0.62
1,870.7	0.37	214.29	1,870.7	-3.3	-0.4	-3.0	0.56
1,895.7	0.44	207.89	1,895.7	-3.4	-0.5	-3.2	0.33
1,920.7	0.39	207.49	1,920.7	-3.6	-0.5	-3.3	0.20
1,945.7	0.30	191.18	1,945.7	-3.7	-0.6	-3.4	0.53
1,970.7	0.28	187.98	1,970.7	-3.9	-0.6	-3.5	0.10
1,995.7	0.15	214.33	1,995.7	-3.9	-0.6	-3.6	0.64
2,020.7	0.22	222.07	2,020.7	-4.0	-0.7	-3.6	0.30
2,045.7	0.28	209.75	2,045.7	-4.1	-0.8	-3.7	0.32
2,070.7	0.28	211.54	2,070.7	-4.2	-0.8	-3.8	0.03
2,095.7	0.36	211.59	2,095.7	-4.3	-0.9	-3.9	0.32
2,120.7	0.40	202.54	2,120.7	-4.5	-1.0	-4.0	0.29
2,145.7	0.38	190.51	2,145.7	-4.6	-1.0	-4.1	0.34
2,170.7	0.37	181.22	2,170.7	-4.8	-1.0	-4.3	0.25
2,195.7	0.46	160.67	2,195.7	-5.0	-1.0	-4.5	0.69
2,220.7	0.27	176.59	2,220.7	-5.1	-1.0	-4.6	0.85
2,245.7	0.30	148.30	2,245.7	-5.2	-0.9	-4.7	0.57
2,270.7	0.20	146.22	2,270.7	-5.3	-0.9	-4.8	0.40
2,295.7	0.25	149.93	2,295.7	-5.4	-0.8	-4.9	0.21
2,320.7	0.25	148.60	2,320.7	-5.5	-0.8	-5.0	0.02
2,345.7	0.20	150.39	2,345.7	-5.6	-0.7	-5.1	0.20
2,370.7	0.18	163.03	2,370.7	-5.7	-0.7	-5.2	0.19
2,395.7	0.21	180.73	2,395.7	-5.8	-0.7	-5.2	0.27
2,420.7	0.32	193.19	2,420.7	-5.9	-0.7	-5.4	0.49
2,445.7	0.16	188.26	2,445.7	-6.0	-0.7	-5.5	0.64
2,470.7	0.27	165.37	2,470.7	-6.1	-0.7	-5.6	0.55
2,495.7	0.40	168.64	2,495.7	-6.2	-0.7	-5.7	0.53
2,520.7	0.48	169.30	2,520.7	-6.4	-0.6	-5.9	0.32
2,545.7	0.36	149.99	2,545.7	-6.6	-0.6	-6.1	0.74

RECEIVED
Office of Oil and Gas
NOV 20 2014
WV Department of
Environmental Protection
COMPASS 5000-1 Build 70

33.05702



EOW Completion Report



Company:	Antero Resources	Local Co-ordinate Reference:	Well Ford Unit 1H
Project:	Harrison County West Virginia	TVD Reference:	Patterson 340: GL 1374' + 24' RKB @ 1398.0usft
Site:	Ruth/Norris/Nellie/Ford Pad	MD Reference:	Patterson 340: GL 1374' + 24' RKB @ 1398.0usft
Well:	Ford Unit 1H	North Reference:	Grid
Wellbore:	Original Wellpath	Survey Calculation Method:	Minimum Curvature
Design:	As Drilled	Database:	Oklahoma District

Survey

MD (usft)	Inc (°)	Azi (azimuth) (°)	TVD (usft)	N/S (usft)	E/W (usft)	V. Sec (usft)	DLeg (°/100usft)
2,570.7	0.42	147.82	2,570.7	-6.7	-0.5	-6.3	0.25
2,595.7	0.34	142.99	2,595.7	-6.8	-0.4	-6.4	0.34
2,620.7	0.29	159.55	2,620.7	-7.0	-0.3	-6.6	0.41
2,645.7	0.36	174.90	2,645.7	-7.1	-0.3	-6.7	0.44
2,670.7	0.43	178.03	2,670.7	-7.3	-0.3	-6.9	0.29
2,695.7	0.39	159.04	2,695.7	-7.4	-0.2	-7.0	0.56
2,720.7	0.54	164.33	2,720.7	-7.6	-0.2	-7.2	0.62
2,745.7	0.56	156.19	2,745.7	-7.9	-0.1	-7.5	0.32
2,770.7	0.56	156.89	2,770.7	-8.1	0.0	-7.7	0.03
2,795.7	0.52	148.14	2,795.7	-8.3	0.1	-8.0	0.37
2,820.7	0.49	140.99	2,820.7	-8.5	0.2	-8.2	0.28
2,845.7	0.41	147.56	2,845.7	-8.6	0.3	-8.4	0.38
2,870.7	0.36	165.00	2,870.7	-8.8	0.4	-8.5	0.51
2,895.7	0.46	170.27	2,895.7	-9.0	0.5	-8.7	0.43
2,920.7	0.53	162.28	2,920.7	-9.2	0.5	-8.9	0.39
2,945.7	0.60	154.59	2,945.7	-9.4	0.6	-9.2	0.41
2,970.7	0.60	142.95	2,970.7	-9.6	0.7	-9.4	0.49
2,995.7	0.59	136.36	2,995.7	-9.8	0.9	-9.6	0.28
3,020.7	0.48	128.48	3,020.7	-10.0	1.1	-9.9	0.53
3,045.7	0.49	141.25	3,045.7	-10.1	1.2	-10.0	0.43
3,070.7	0.44	151.97	3,070.7	-10.3	1.3	-10.2	0.40
3,095.7	0.51	157.00	3,095.7	-10.5	1.4	-10.4	0.33
3,120.7	0.50	154.61	3,120.7	-10.7	1.5	-10.7	0.09
3,145.7	0.54	149.92	3,145.7	-10.9	1.6	-10.9	0.23
3,170.7	0.62	143.32	3,170.7	-11.1	1.8	-11.1	0.42
3,195.7	0.57	141.31	3,195.7	-11.3	1.9	-11.4	0.22
3,220.7	0.58	128.86	3,220.7	-11.5	2.1	-11.6	0.50
3,245.7	0.53	125.29	3,245.7	-11.6	2.3	-11.8	0.24
3,270.7	0.44	127.92	3,270.7	-11.7	2.5	-11.9	0.37
3,295.7	0.40	145.86	3,295.7	-11.9	2.6	-12.1	0.55
3,320.7	0.36	151.78	3,320.7	-12.0	2.7	-12.3	0.22
3,345.7	0.43	140.29	3,345.7	-12.2	2.8	-12.4	0.42
3,370.7	0.43	149.75	3,370.7	-12.3	2.9	-12.6	0.28
3,395.7	0.56	137.75	3,395.7	-12.5	3.0	-12.8	0.66
3,420.7	0.53	135.62	3,420.7	-12.7	3.2	-13.0	0.14
3,445.7	0.39	121.67	3,445.7	-12.8	3.3	-13.2	0.71
3,470.7	0.35	140.36	3,470.7	-12.9	3.4	-13.3	0.51
3,495.7	0.40	138.86	3,495.7	-13.0	3.5	-13.5	0.20
3,520.7	0.40	142.28	3,520.7	-13.1	3.7	-13.6	0.10
3,545.7	0.42	159.90	3,545.7	-13.3	3.7	-13.8	0.51
3,570.7	0.45	147.58	3,570.7	-13.5	3.8	-14.0	0.39
3,595.7	0.44	148.70	3,595.7	-13.6	3.9	-14.2	0.05
3,620.7	0.39	144.32	3,620.7	-13.8	4.0	-14.4	0.24
3,645.7	0.38	140.62	3,645.7	-13.9	4.1	-14.5	0.11

33.05702



EOW Completion Report

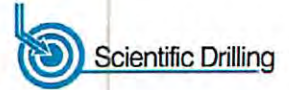

Company:	Antero Resources	Local Co-ordinate Reference:	Well Ford Unit 1H
Project:	Harrison County West Virginia	TVD Reference:	Patterson 340: GL 1374' + 24' RKB @ 1398.0usft
Site:	Ruth/Norris/Nellie/Ford Pad	MD Reference:	Patterson 340: GL 1374' + 24' RKB @ 1398.0usft
Well:	Ford Unit 1H	North Reference:	Grid
Wellbore:	Original Wellpath	Survey Calculation Method:	Minimum Curvature
Design:	As Drilled	Database:	Oklahoma District

Survey

MD (usft)	Inc (°)	Azi (azimuth) (°)	TVD (usft)	N/S (usft)	E/W (usft)	V. Sec (usft)	DLeg (°/100usft)
3,670.7	0.37	142.29	3,670.7	-14.0	4.2	-14.7	0.06
3,695.7	0.41	137.50	3,695.7	-14.2	4.3	-14.8	0.21
3,720.7	0.40	137.63	3,720.7	-14.3	4.5	-15.0	0.04
3,745.7	0.37	126.86	3,745.6	-14.4	4.6	-15.1	0.31
3,770.7	0.42	119.46	3,770.6	-14.5	4.7	-15.3	0.29
3,795.7	0.41	113.92	3,795.6	-14.6	4.9	-15.4	0.17
3,820.7	0.42	119.98	3,820.6	-14.7	5.0	-15.5	0.18
3,845.7	0.49	117.19	3,845.6	-14.8	5.2	-15.7	0.29
3,870.7	0.34	125.15	3,870.6	-14.9	5.4	-15.8	0.64
3,895.7	0.35	123.95	3,895.6	-14.9	5.5	-15.9	0.05
3,920.7	0.28	143.81	3,920.6	-15.0	5.6	-16.0	0.51
3,945.7	0.31	141.93	3,945.6	-15.1	5.7	-16.1	0.13
3,970.7	0.42	138.73	3,970.6	-15.3	5.8	-16.3	0.45
3,995.7	0.37	150.40	3,995.6	-15.4	5.9	-16.5	0.38
4,020.7	0.62	140.54	4,020.6	-15.6	6.0	-16.7	1.05
4,045.7	0.63	133.34	4,045.6	-15.8	6.2	-16.9	0.32
4,070.7	0.63	126.86	4,070.6	-16.0	6.4	-17.1	0.28
4,095.7	0.55	113.33	4,095.6	-16.1	6.6	-17.3	0.64
4,120.7	0.50	124.14	4,120.6	-16.2	6.8	-17.5	0.44
4,145.7	0.41	127.54	4,145.6	-16.3	7.0	-17.6	0.38
4,170.7	0.51	120.95	4,170.6	-16.4	7.2	-17.8	0.45
4,195.7	0.57	131.25	4,195.6	-16.6	7.3	-18.0	0.46
4,220.7	0.65	125.52	4,220.6	-16.7	7.5	-18.2	0.40
4,245.7	0.72	120.45	4,245.6	-16.9	7.8	-18.4	0.37
4,270.7	0.70	118.39	4,270.6	-17.0	8.1	-18.7	0.13
4,295.7	0.63	115.05	4,295.6	-17.2	8.3	-18.9	0.32
4,320.7	0.58	117.42	4,320.6	-17.3	8.6	-19.0	0.22
4,345.7	0.60	124.26	4,345.6	-17.4	8.8	-19.2	0.29
4,370.7	0.70	123.86	4,370.6	-17.6	9.0	-19.4	0.40
4,395.7	0.70	113.55	4,395.6	-17.7	9.3	-19.7	0.50
4,420.7	0.60	110.90	4,420.6	-17.8	9.5	-19.8	0.42
4,445.7	0.45	126.66	4,445.6	-17.9	9.7	-20.0	0.83
4,470.7	0.39	132.21	4,470.6	-18.1	9.9	-20.2	0.29
4,495.7	0.82	125.57	4,495.6	-18.2	10.1	-20.4	1.74
4,520.7	0.88	124.71	4,520.6	-18.4	10.4	-20.7	0.25
4,545.7	0.66	114.62	4,545.6	-18.6	10.7	-20.9	1.03
4,570.7	0.74	108.63	4,570.6	-18.7	11.0	-21.1	0.43
4,595.7	0.89	105.84	4,595.6	-18.8	11.3	-21.3	0.62
4,620.7	1.16	75.61	4,620.6	-18.8	11.7	-21.4	2.38
4,645.7	1.93	57.11	4,645.6	-18.5	12.3	-21.3	3.63
4,670.7	3.16	47.10	4,670.6	-17.8	13.2	-20.9	5.21
4,695.7	4.50	42.35	4,695.5	-16.6	14.4	-20.1	5.50
4,720.7	5.80	39.73	4,720.4	-14.9	15.8	-18.9	5.28
4,745.7	6.87	38.32	4,745.3	-12.8	17.6	-17.4	4.32

RECEIVED
Office of Oil and Gas
NOV 10 2014

WV Department of Environmental Protection
COMPASS 5000.1 Build 70
11/28/2014

33.05702



EOW Completion Report

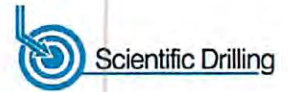

Company:	Antero Resources	Local Co-ordinate Reference:	Well Ford Unit 1H
Project:	Harrison County West Virginia	TVD Reference:	Patterson 340: GL 1374' + 24' RKB @ 1398.0usft
Site:	Ruth/Norris/Nellie/Ford Pad	MD Reference:	Patterson 340: GL 1374' + 24' RKB @ 1398.0usft
Well:	Ford Unit 1H	North Reference:	Grid
Wellbore:	Original Wellpath	Survey Calculation Method:	Minimum Curvature
Design:	As Drilled	Database:	Oklahoma District

Survey							
MD (usft)	Inc (°)	Azi (azimuth) (°)	TVD (usft)	N/S (usft)	E/W (usft)	V. Sec (usft)	DLeg (°/100usft)
4,770.7	7.69	37.27	4,770.1	-10.3	19.5	-15.5	3.32
4,795.7	8.13	36.76	4,794.8	-7.5	21.6	-13.5	1.78
4,820.7	8.57	37.04	4,819.6	-4.6	23.8	-11.4	1.77
4,845.7	9.21	37.18	4,844.3	-1.5	26.1	-9.1	2.56
4,870.7	9.64	37.48	4,868.9	1.7	28.6	-6.7	1.73
4,895.7	9.98	38.73	4,893.6	5.1	31.2	-4.3	1.60
4,920.7	10.36	44.25	4,918.2	8.4	34.1	-2.0	4.18
4,945.7	11.11	45.22	4,942.7	11.7	37.4	0.2	3.09
4,970.7	11.96	46.86	4,967.2	15.1	41.0	2.4	3.64
4,995.7	12.54	48.08	4,991.6	18.7	44.9	4.7	2.54
5,020.7	13.20	50.16	5,016.0	22.4	49.1	7.0	3.23
5,045.7	13.61	51.09	5,040.3	26.0	53.6	9.2	1.85
5,070.7	14.15	51.22	5,064.6	29.8	58.3	11.4	2.16
5,095.7	14.90	51.53	5,088.8	33.7	63.2	13.7	3.02
5,120.7	15.45	51.49	5,112.9	37.8	68.3	16.1	2.20
5,145.7	16.44	51.46	5,137.0	42.1	73.7	18.6	3.96
5,170.7	17.29	51.45	5,160.9	46.6	79.3	21.3	3.40
5,195.7	17.62	51.29	5,184.7	51.3	85.2	24.0	1.33
5,220.7	18.17	51.07	5,208.5	56.1	91.2	26.9	2.22
5,245.7	18.72	50.42	5,232.3	61.1	97.3	29.9	2.35
5,270.7	19.39	49.83	5,255.9	66.3	103.6	33.0	2.79
5,295.7	20.37	49.20	5,279.4	71.8	110.0	36.4	4.01
5,320.7	21.31	48.58	5,302.8	77.7	116.7	40.0	3.86
5,345.7	22.13	47.99	5,326.0	83.8	123.6	43.9	3.39
5,370.7	22.78	47.28	5,349.1	90.3	130.7	48.0	2.82
5,395.7	22.98	47.15	5,372.1	96.9	137.8	52.2	0.83
5,420.7	23.34	46.79	5,395.1	103.6	145.0	56.5	1.55
5,445.7	23.50	46.86	5,418.0	110.4	152.3	60.9	0.65
5,470.7	24.08	47.82	5,440.9	117.2	159.7	65.3	2.79
5,495.7	24.09	49.99	5,463.7	123.9	167.4	69.4	3.54
5,520.7	23.64	50.35	5,486.6	130.4	175.1	73.3	1.89
5,545.7	23.35	50.43	5,509.5	136.8	182.8	77.1	1.17
5,570.7	23.55	51.25	5,532.5	143.0	190.5	80.9	1.53
5,595.7	23.80	52.25	5,555.4	149.3	198.4	84.5	1.89
5,620.7	23.63	52.20	5,578.3	155.4	206.4	88.1	0.68
5,645.7	23.16	51.49	5,601.2	161.6	214.2	91.7	2.19
5,670.7	22.21	50.47	5,624.3	167.6	221.7	95.3	4.11
5,695.7	21.42	49.77	5,647.5	173.6	228.8	98.9	3.33
5,720.7	21.16	49.25	5,670.8	179.5	235.7	102.5	1.29
5,745.7	21.37	49.25	5,694.1	185.4	242.6	106.1	0.84
5,770.7	21.76	49.31	5,717.3	191.4	249.5	109.8	1.56
5,795.7	22.46	49.57	5,740.5	197.5	256.7	113.6	2.83
5,820.7	23.28	49.85	5,763.5	203.8	264.1	117.4	3.31
5,845.7	24.36	50.01	5,786.4	210.3	271.8	121.3	4.33

RECEIVED
 Office of Oil and Gas
 NOV 10 2014
 WV Department of Environmental Protection
 COMPASS 6000.1 Build 70
 11/28/2014

33.05702



EOW Completion Report

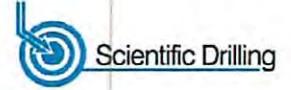

Company:	Antero Resources	Local Co-ordinate Reference:	Well Ford Unit 1H
Project:	Harrison County West Virginia	TVD Reference:	Patterson 340: GL 1374' + 24' RKB @ 1398.0usft
Site:	Ruth/Norris/Nellie/Ford Pad	MD Reference:	Patterson 340: GL 1374' + 24' RKB @ 1398.0usft
Well:	Ford Unit 1H	North Reference:	Grid
Wellbore:	Original Wellpath	Survey Calculation Method:	Minimum Curvature
Design:	As Drilled	Database:	Oklahoma District

Survey							
MD (usft)	Inc (°)	Azi (azimuth) (°)	TVD (usft)	N/S (usft)	E/W (usft)	V. Sec (usft)	DLeg (°/100usft)
5,870.7	24.91	49.98	5,809.1	217.0	279.8	125.4	2.20
5,895.7	24.79	50.12	5,831.8	223.7	287.9	129.5	0.53
5,920.7	24.93	51.40	5,854.5	230.4	296.0	133.5	2.22
5,945.7	25.18	52.32	5,877.1	236.9	304.3	137.3	1.85
5,970.7	25.07	53.07	5,899.8	243.3	312.8	140.9	1.35
5,995.7	24.87	55.51	5,922.4	249.5	321.3	144.3	4.20
6,020.7	24.70	56.11	5,945.1	255.4	330.0	147.4	1.21
6,045.7	24.61	54.47	5,967.8	261.3	338.6	150.6	2.76
6,070.7	25.07	52.86	5,990.5	267.6	347.0	154.0	3.27
6,095.7	25.37	51.52	6,013.1	274.1	355.4	157.8	2.58
6,120.7	25.44	49.35	6,035.7	280.9	363.7	161.9	3.73
6,145.7	25.10	46.27	6,058.3	288.1	371.6	166.5	5.43
6,170.7	24.85	43.61	6,081.0	295.6	379.1	171.4	4.60
6,195.7	25.51	42.21	6,103.6	303.3	386.3	176.7	3.56
6,220.7	26.04	41.80	6,126.1	311.4	393.6	182.3	2.24
6,245.7	26.13	42.20	6,148.6	319.6	400.9	188.0	0.79
6,270.7	26.23	42.57	6,171.0	327.7	408.4	193.6	0.77
6,295.7	25.91	43.52	6,193.5	335.8	415.9	199.1	2.10
6,320.7	25.83	44.52	6,216.0	343.6	423.5	204.3	1.77
6,345.7	25.58	45.91	6,238.5	351.2	431.2	209.4	2.61
6,370.7	25.27	47.91	6,261.1	358.6	439.0	214.1	3.65
6,395.7	24.60	49.40	6,283.8	365.5	446.9	218.4	3.67
6,420.7	23.70	51.25	6,306.6	372.1	454.8	222.4	4.70
6,445.7	23.14	53.02	6,329.5	378.2	462.6	225.9	3.60
6,470.7	22.77	54.18	6,352.5	384.0	470.5	229.1	2.34
6,495.7	22.42	54.01	6,375.6	389.6	478.2	232.2	1.42
6,520.7	22.17	53.29	6,398.7	395.2	485.9	235.4	1.48
6,545.7	22.25	51.88	6,421.9	401.0	493.4	238.7	2.16
6,570.7	22.72	50.79	6,445.0	406.9	500.8	242.2	2.51
6,595.7	23.04	50.82	6,468.0	413.1	508.4	245.9	1.28
6,620.7	22.99	52.39	6,491.0	419.1	516.0	249.4	2.46
6,645.7	23.01	53.96	6,514.0	425.0	523.9	252.7	2.46
6,670.7	23.23	55.46	6,537.0	430.7	531.9	255.8	2.51
6,695.7	23.59	56.81	6,560.0	436.2	540.1	258.7	2.58
6,720.7	24.15	58.52	6,582.8	441.6	548.7	261.3	3.56
6,745.7	24.67	59.19	6,605.6	447.0	557.5	263.8	2.36
6,770.7	25.37	59.46	6,628.3	452.3	566.6	266.3	2.84
6,795.7	26.13	59.08	6,650.8	457.9	575.9	268.9	3.11
6,820.7	27.19	58.39	6,673.1	463.7	585.5	271.7	4.42
6,845.7	27.23	58.01	6,695.3	469.7	595.2	274.6	0.71
6,870.7	27.32	56.55	6,717.6	475.9	604.9	277.7	2.70
6,895.7	26.98	54.92	6,739.8	482.4	614.3	281.0	3.27
6,920.7	26.80	52.73	6,762.1	489.0	623.4	284.7	4.03
6,945.7	27.21	50.19	6,784.4	496.1	632.3	288.9	4.90

RECEIVED
Office of Oil and Gas
NOV 10 2014

33-05702



EOW Completion Report

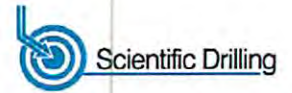

Company:	Antero Resources	Local Co-ordinate Reference:	Well Ford Unit 1H
Project:	Harrison County West Virginia	TVD Reference:	Patterson 340: GL 1374' + 24' RKB @ 1398.0usft
Site:	Ruth/Norris/Nellie/Ford Pad	MD Reference:	Patterson 340: GL 1374' + 24' RKB @ 1398.0usft
Well:	Ford Unit 1H	North Reference:	Grid
Wellbore:	Original Wellpath	Survey Calculation Method:	Minimum Curvature
Design:	As Drilled	Database:	Oklahoma District

Survey							
MD (usft)	Inc (°)	Azi (azimuth) (°)	TVD (usft)	N/S (usft)	E/W (usft)	V. Sec (usft)	DLeg (°/100usft)
6,970.7	25.89	47.82	6,806.7	503.4	640.7	293.4	6.77
6,995.7	26.38	45.67	6,829.2	511.0	648.8	298.3	4.26
7,020.7	25.44	42.84	6,851.7	518.8	656.4	303.5	6.21
7,045.7	25.30	40.41	6,874.3	526.8	663.5	309.1	4.20
7,070.7	25.04	40.45	6,896.9	534.9	670.4	314.8	1.04
7,075.0	25.09	40.78	6,900.8	536.3	671.6	315.8	3.50
SCMR							
7,095.7	25.34	42.38	6,919.5	542.9	677.4	320.4	3.50
7,120.7	24.13	44.63	6,942.2	550.5	684.6	325.5	6.13
7,145.7	23.26	45.59	6,965.1	557.6	691.7	330.2	3.81
7,170.7	22.77	47.18	6,988.1	564.3	698.8	334.6	3.17
7,174.9	22.69	47.48	6,992.0	565.4	700.0	335.3	3.32
7,226.0	22.69	50.95	7,039.1	578.3	714.9	343.2	2.62
7,256.0	22.45	50.85	7,066.8	585.5	723.9	347.5	0.81
7,286.0	22.93	47.25	7,094.5	593.1	732.6	352.2	4.90
7,316.0	23.99	42.87	7,122.0	601.5	741.0	357.8	6.80
7,346.0	25.73	39.29	7,149.3	611.1	749.3	364.5	7.67
7,376.0	27.62	37.32	7,176.1	621.6	757.7	372.2	6.95
7,406.0	29.84	34.84	7,202.4	633.3	766.1	380.8	8.40
7,436.0	32.12	28.89	7,228.1	646.4	774.3	391.0	12.72
7,466.0	34.21	21.52	7,253.2	661.2	781.2	403.1	15.13
7,487.0	36.56	16.84	7,270.3	672.7	785.2	412.9	17.07
BRKT							
7,496.0	37.62	15.00	7,277.5	677.9	786.7	417.5	17.07
7,522.0	40.87	10.74	7,297.7	694.0	790.3	431.7	16.22
TLLY							
7,526.0	41.38	10.14	7,300.7	696.6	790.8	434.1	16.22
7,556.0	44.19	7.14	7,322.7	716.7	793.8	452.4	11.57
7,586.0	46.34	4.39	7,343.8	737.9	796.0	472.1	9.68
7,616.0	49.93	1.90	7,363.8	760.2	797.2	493.0	13.47
7,646.0	54.84	0.39	7,382.1	783.9	797.6	515.6	16.84
7,647.0	54.95	0.36	7,382.7	784.8	797.7	516.4	11.79
HMLN							
7,676.0	58.29	359.45	7,398.7	809.0	797.6	539.6	11.79
7,706.0	61.82	358.54	7,413.6	835.0	797.1	564.5	12.06
7,736.0	65.40	358.25	7,427.0	861.8	796.4	590.4	11.96
7,766.0	69.34	358.22	7,438.5	889.5	795.5	617.1	13.13
7,796.0	73.62	358.43	7,448.0	917.9	794.7	644.6	14.28
7,826.0	75.84	358.62	7,455.9	946.9	794.0	672.4	7.43
MRCL							
7,856.0	76.80	359.29	7,463.0	976.0	793.4	700.5	3.87
7,886.0	78.30	0.15	7,469.5	1,005.3	793.3	728.5	5.73
7,916.0	80.11	358.26	7,475.1	1,034.8	792.9	756.8	8.64
7,946.0	80.93	354.92	7,480.1	1,064.3	791.1	785.0	11.32
7,976.0	81.37	352.05	7,484.7	1,093.7	787.8	814.7	9.57

RECEIVED
Office of Oil and Gas
NOV 15 2014
WV Department of Environmental Protection
COMPASS 5000.1 Build 70
11/28/2014

33.05702



EOW Completion Report

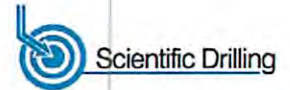

Company:	Antero Resources	Local Co-ordinate Reference:	Well Ford Unit 1H
Project:	Harrison County West Virginia	TVD Reference:	Patterson 340: GL 1374' + 24' RKB @ 1398.0usft
Site:	Ruth/Norris/Nellie/Ford Pad	MD Reference:	Patterson 340: GL 1374' + 24' RKB @ 1398.0usft
Well:	Ford Unit 1H	North Reference:	Grid
Wellbore:	Original Wellpath	Survey Calculation Method:	Minimum Curvature
Design:	As Drilled	Database:	Oklahoma District

Survey							
MD (usft)	Inc (°)	Azi (azimuth) (°)	TVD (usft)	N/S (usft)	E/W (usft)	V. Sec (usft)	DLeg (°/100usft)
8,012.0	83.80	348.64	7,489.3	1,128.9	781.8	850.1	11.57
8,070.0	90.20	344.08	7,492.4	1,185.2	768.1	907.9	13.54
8,166.0	90.34	341.52	7,491.9	1,276.9	739.7	1,003.8	2.67
8,260.0	89.93	341.49	7,491.7	1,366.0	709.9	1,097.8	0.44
8,354.0	89.16	342.20	7,492.4	1,455.3	680.6	1,191.8	1.11
8,447.0	88.83	342.68	7,494.1	1,544.0	652.6	1,284.8	0.63
8,542.0	88.42	342.27	7,496.3	1,634.5	624.0	1,379.7	0.61
8,636.0	89.06	343.49	7,498.4	1,724.3	596.3	1,473.7	1.47
8,730.0	88.39	345.30	7,500.5	1,814.9	571.0	1,567.7	2.05
8,824.0	87.92	342.71	7,503.5	1,905.2	545.1	1,661.6	2.80
8,919.0	88.63	342.48	7,506.4	1,995.8	516.7	1,756.5	0.79
9,013.0	89.19	340.06	7,508.2	2,084.8	486.6	1,850.5	2.64
9,106.0	88.81	341.61	7,509.8	2,172.6	456.0	1,943.4	1.72
9,200.0	89.03	342.76	7,511.6	2,262.1	427.3	2,037.4	1.25
9,294.0	92.11	343.12	7,510.6	2,351.9	399.7	2,131.4	3.30
9,388.0	93.49	343.61	7,506.0	2,441.9	372.8	2,225.2	1.56
9,482.0	92.85	344.44	7,500.8	2,532.1	347.0	2,319.1	1.11
9,576.0	92.21	344.90	7,496.7	2,622.7	322.2	2,412.9	0.84
9,670.0	88.99	341.91	7,495.7	2,712.7	295.3	2,506.9	4.67
9,763.0	89.60	340.57	7,496.9	2,800.8	265.4	2,599.9	1.58
9,858.0	90.37	341.72	7,496.9	2,890.7	234.7	2,694.8	1.46
9,951.0	89.30	344.07	7,497.1	2,979.6	207.4	2,787.8	2.78
10,045.0	89.60	345.55	7,498.1	3,070.3	182.8	2,881.7	1.61
10,137.0	88.09	345.51	7,499.9	3,159.3	159.8	2,973.6	1.64
10,230.0	88.02	342.59	7,503.1	3,248.7	134.2	3,066.5	3.14
10,325.0	88.89	341.44	7,505.6	3,339.0	104.9	3,161.5	1.52
10,419.0	89.93	342.05	7,506.6	3,428.3	75.5	3,255.5	1.28
10,513.0	87.71	344.17	7,508.5	3,518.2	48.2	3,349.4	3.27
10,607.0	89.46	343.16	7,510.8	3,608.4	21.7	3,443.4	2.15
10,701.0	91.01	343.61	7,510.5	3,698.4	-5.1	3,537.4	1.72
10,795.0	89.46	342.56	7,510.1	3,788.4	-32.5	3,631.4	1.99
10,889.0	90.27	343.86	7,510.3	3,878.4	-59.6	3,725.4	1.63
10,982.0	89.73	343.36	7,510.3	3,967.6	-85.9	3,818.4	0.79
11,076.0	89.83	340.39	7,510.7	4,056.9	-115.1	3,912.3	3.16
11,171.0	90.23	340.22	7,510.6	4,146.3	-147.1	4,007.2	0.46
11,265.0	89.70	339.90	7,510.7	4,234.7	-179.2	4,101.1	0.66
11,358.0	89.50	342.15	7,511.3	4,322.6	-209.4	4,194.1	2.43
11,452.0	89.93	339.41	7,511.8	4,411.4	-240.4	4,288.0	2.95
11,546.0	89.29	343.65	7,512.4	4,500.5	-270.1	4,381.9	4.56
11,640.0	89.50	342.40	7,513.4	4,590.4	-297.6	4,475.9	1.35
11,734.0	89.46	345.48	7,514.3	4,680.7	-323.6	4,569.9	3.28
11,828.0	90.00	345.69	7,514.7	4,771.8	-347.0	4,663.8	0.62
11,922.0	89.93	344.70	7,514.8	4,862.7	-371.0	4,757.7	1.06
12,016.0	90.40	342.32	7,514.5	4,952.8	-397.7	4,851.7	2.58

33-05702



EOW Completion Report

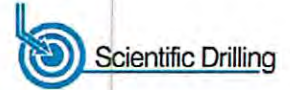

Company:	Antero Resources	Local Co-ordinate Reference:	Well Ford Unit 1H
Project:	Harrison County West Virginia	TVD Reference:	Patterson 340: GL 1374' + 24' RKB @ 1398.0usft
Site:	Ruth/Norris/Nellie/Ford Pad	MD Reference:	Patterson 340: GL 1374' + 24' RKB @ 1398.0usft
Well:	Ford Unit 1H	North Reference:	Grid
Wellbore:	Original Wellpath	Survey Calculation Method:	Minimum Curvature
Design:	As Drilled	Database:	Oklahoma District

Survey

MD (usft)	Inc (°)	Azi (azimuth) (°)	TVD (usft)	N/S (usft)	E/W (usft)	V. Sec (usft)	DLeg (°/100usft)
12,109.0	90.92	341.52	7,513.4	5,041.2	-426.5	4,944.7	1.03
12,200.0	90.47	343.44	7,512.3	5,128.0	-453.9	5,035.7	2.17
12,290.0	89.83	345.32	7,512.1	5,214.6	-478.2	5,125.6	2.21
12,381.0	90.40	346.96	7,511.9	5,303.0	-500.0	5,216.5	1.91
12,472.0	88.79	343.99	7,512.6	5,391.0	-522.8	5,307.4	3.71
12,563.0	90.91	342.28	7,512.8	5,478.1	-549.2	5,398.4	2.99
12,654.0	89.80	340.90	7,512.2	5,564.5	-577.9	5,489.4	1.95
12,745.0	90.50	344.12	7,512.0	5,651.2	-605.3	5,580.3	3.62
12,835.0	90.00	344.12	7,511.6	5,737.8	-629.9	5,670.3	0.56
12,926.0	89.63	346.52	7,511.9	5,825.8	-653.0	5,761.2	2.67
13,017.0	89.03	343.26	7,513.0	5,913.7	-676.7	5,852.2	3.64
13,108.0	89.33	341.56	7,514.3	6,000.4	-704.2	5,943.1	1.90
13,199.0	90.00	342.81	7,514.8	6,087.0	-732.0	6,034.1	1.56
13,293.0	88.69	342.43	7,515.9	6,176.7	-760.1	6,128.1	1.45
13,387.0	88.46	340.69	7,518.2	6,265.9	-789.8	6,222.1	1.87
13,481.0	88.76	340.78	7,520.5	6,354.6	-820.8	6,316.0	0.33
13,575.0	90.23	336.87	7,521.3	6,442.2	-854.8	6,409.7	4.44
13,670.0	90.24	340.67	7,520.9	6,530.8	-889.2	6,504.4	4.00
13,764.0	89.73	339.80	7,520.9	6,619.2	-920.9	6,598.3	1.07
13,858.0	90.07	345.14	7,521.1	6,708.8	-949.2	6,692.3	5.69
13,952.0	90.10	344.33	7,521.0	6,799.5	-974.0	6,786.2	0.86
14,046.0	90.40	346.13	7,520.6	6,890.4	-998.0	6,880.2	1.94
14,140.0	87.95	344.42	7,521.9	6,981.3	-1,021.8	6,974.1	3.18
14,234.0	87.82	343.99	7,525.4	7,071.7	-1,047.4	7,068.0	0.48
14,328.0	89.36	343.16	7,527.7	7,161.8	-1,074.0	7,161.9	1.86
14,422.0	89.46	343.93	7,528.7	7,251.9	-1,100.6	7,255.9	0.83
14,516.0	88.05	343.46	7,530.7	7,342.1	-1,127.0	7,349.9	1.58
14,610.0	88.52	343.86	7,533.5	7,432.3	-1,153.4	7,443.8	0.66
14,704.0	88.76	344.76	7,535.7	7,522.8	-1,178.8	7,537.8	0.99
14,798.0	89.66	344.44	7,537.0	7,613.4	-1,203.8	7,631.7	1.02
14,892.0	88.36	344.42	7,538.7	7,703.9	-1,229.0	7,725.7	1.38
14,986.0	89.56	344.86	7,540.4	7,794.6	-1,253.9	7,819.6	1.36
15,080.0	87.85	342.79	7,542.5	7,884.8	-1,280.1	7,913.6	2.86
15,174.0	90.74	342.14	7,543.7	7,974.4	-1,308.4	8,007.6	3.15
15,268.0	91.94	342.33	7,541.5	8,063.9	-1,337.1	8,101.5	1.29
15,362.0	90.10	342.63	7,539.8	8,153.5	-1,365.4	8,195.5	1.98
15,456.0	89.53	340.65	7,540.1	8,242.7	-1,395.0	8,289.5	2.19
15,550.0	90.64	340.22	7,539.9	8,331.3	-1,426.5	8,383.4	1.27
15,644.0	91.11	342.71	7,538.5	8,420.4	-1,456.3	8,477.3	2.70
15,738.0	89.53	345.32	7,538.0	8,510.8	-1,482.2	8,571.3	3.25
15,832.0	88.93	344.17	7,539.3	8,601.4	-1,506.9	8,665.3	1.38
15,926.0	89.63	343.23	7,540.4	8,691.7	-1,533.3	8,759.2	1.25
16,020.0	89.73	342.27	7,541.0	8,781.4	-1,561.2	8,853.2	0.03
16,114.0	88.96	342.21	7,542.0	8,870.9	-1,589.9	8,947.2	0.82
16,208.0	89.87	344.75	7,543.0	8,961.0	-1,616.6	9,041.2	2.87

RECEIVED
Office of Oil and Gas
NOV 11 2014

WV Department of Environmental Protection
COMPASS 5000.1 Build 70
11/28/2014

33-05702



EOW Completion Report

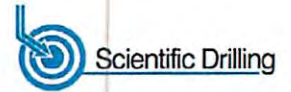

Company:	Antero Resources	Local Co-ordinate Reference:	Well Ford Unit 1H
Project:	Harrison County West Virginia	TVD Reference:	Patterson 340: GL 1374' + 24' RKB @ 1398.0usft
Site:	Ruth/Norris/Nellie/Ford Pad	MD Reference:	Patterson 340: GL 1374' + 24' RKB @ 1398.0usft
Well:	Ford Unit 1H	North Reference:	Grid
Wellbore:	Original Wellpath	Survey Calculation Method:	Minimum Curvature
Design:	As Drilled	Database:	Oklahoma District

MD (usft)	Inc (°)	Azi (azimuth) (°)	TVD (usft)	N/S (usft)	E/W (usft)	V. Sec (usft)	DLeg (°/100usft)
16,302.0	88.59	344.19	7,544.3	9,051.6	-1,641.8	9,135.2	1.49
16,397.0	88.08	341.63	7,547.0	9,142.4	-1,669.7	9,230.1	2.75
16,492.0	88.86	341.73	7,549.6	9,232.5	-1,699.5	9,325.1	0.83
16,586.0	89.33	342.72	7,551.0	9,322.0	-1,728.2	9,419.0	1.17
16,680.0	90.07	343.52	7,551.5	9,412.0	-1,755.5	9,513.0	1.16
16,774.0	91.17	343.72	7,550.5	9,502.1	-1,782.0	9,607.0	1.19
16,868.0	91.01	343.03	7,548.7	9,592.2	-1,808.9	9,701.0	0.75
16,909.0	91.58	343.10	7,547.8	9,631.4	-1,820.8	9,742.0	1.40
16,966.0	91.50	342.90	7,546.3	9,685.9	-1,837.5	9,799.0	0.38

Measured Depth (usft)	Vertical Depth (usft)	Local Coordinates		Comment
		+N/-S (usft)	+E/-W (usft)	
7,075.0	6,900.8	536.3	671.6	SCMR
7,487.0	7,270.3	672.7	785.2	BRKT
7,522.0	7,297.7	694.0	790.3	TLLY
7,647.0	7,382.7	784.8	797.7	HMLN
7,826.0	7,455.9	946.9	794.0	MRCL

Checked By: _____ Approved By: _____ Date: _____

RECEIVED
Office of Oil and Gas
NOV 10 2014
COMPASS 5000.1 Build 70
WV Department of Environmental Protection
11/28/2014