

State of West Virginia
Department of Environmental Protection - Office of Oil and Gas
Well Operator's Report of Well Work

API 47 - 033 - 05721 County Harrison District Tenmile
Quad Salem & Big Isaac Pad Name Varner West Pad Field/Pool Name _____
Farm name Varner, James A. Well Number Gideon Unit 2H
Operator (as registered with the OOG) Antero Resources Corporation
Address 1615 Wynkoop Street City Denver State CO Zip 80202

As Drilled location NAD 83/UTM Attach an as-drilled plat, profile view, and deviation survey
Top hole Northing 4,345,141.344m Easting 539,084.943m
Landing Point of Curve Northing 4,344,963.34m Easting 539,123.84m
Bottom Hole Northing 4,343,027.536m Easting 541,181.613m

Elevation (ft) 1456' GL Type of Well New Existing Type of Report Interim Final
Permit Type Deviated Horizontal Horizontal 6A Vertical Depth Type Deep Shallow
Type of Operation Convert Deepen Drill Plug Back Redrilling Rework Stimulate
Well Type Brine Disposal CBM Gas Oil Secondary Recovery Solution Mining Storage Other _____
Type of Completion Single Multiple Fluids Produced Brine Gas NGL Oil Other _____
Drilled with Cable Rotary

Drilling Media Surface hole Air Mud Fresh Water Intermediate hole Air Mud Fresh Water Brine
Production hole Air Mud Fresh Water Brine
Mud Type(s) and Additive(s)
Air - Foam & 4% KCL
Mud - Polymer

Date permit issued 4/3/2013 Date drilling commenced 7/27/2013 Date drilling ceased 10/29/2013
Date completion activities began 2/11/2014 Date completion activities ceased 7/11/2014
Verbal plugging (Y/N) N/A Date permission granted N/A Granted by N/A

Please note: Operator is required to submit a plugging application within 5 days of verbal permission to plug

Freshwater depth(s) ft 112', 173' Open mine(s) (Y/N) depths N
Salt water depth(s) ft None Identified Void(s) encountered (Y/N) depths N
Coal depth(s) ft 437', 497', 707', 1402', 1462', 1979' Cavern(s) encountered (Y/N) depths N
Is coal being mined in area (Y/N) N

RECEIVED
Office of Oil and Gas

MAY 26 2015
WV Department of
Environmental Protection

Reviewed by:
AK 5/27/15
W.S. 6/3/15
06/05/2015

API 47-033 - 05721 Farm name Varner, James A. Well number Gideon Unit 2H

CASING STRINGS	Hole Size	Casing Size	Depth	New or Used	Grade wt/ft	Basket Depth(s)	Did cement circulate (Y/ N) * Provide details below*
Conductor	24"	20"	40'	New	94#/H-40	N/A	Y
Surface	17-1/2"	13-3/8"	377'	New	48#/H-40	N/A	Y
Coal							
Intermediate 1	12-1/4"	9-5/8"	2560'	New	36#/J-55	N/A	Y
Intermediate 2							
Intermediate 3							
Production	8-3/4"/8-1/2"	5-1/2"	17,287'	New	20#/P-110	N/A	Y
Tubing		2-3/8"	7651'	New	4.7#/N-80	N/A	N/A
Packer type and depth set		N/A					

Comment Details _____

CEMENT DATA	Class/Type of Cement	Number of Sacks	Slurry wt (ppg)	Yield (ft ³ /sks)	Volume (ft ³)	Cement Top (MD)	WOC (hrs)
Conductor	Class A	193 sx	15.6	1.18	38 Cu. Ft.	0'	8 hrs
Surface	Class A	520 sx	15.6	1.18	262 Cu. Ft.	0'	8 hrs
Coal							
Intermediate 1	Class A	935 sx	15.6	1.18	802 Cu. Ft.	0'	8 hrs
Intermediate 2							
Intermediate 3							
Production	Class H	1064 sx (Lead), 1561 sx (Tail)	13.5 (Lead), 15.2 (Tail)	1.44 (Lead), 1.80 (Tail)	3489 Cu. Ft.	-500' into Intermediate Casing	8 hrs
Tubing							

Drillers TD (ft) 17,235' MD, 7393' TVD (BHL), 7562' TVD (Deepest Point Drilled) Loggers TD (ft) 17,240' MD
 Deepest formation penetrated Marcellus Plug back to (ft) N/A
 Plug back procedure N/A

Kick off depth (ft) 6962'

** This is a subsequent well. Antero only runs wireline logs on one well on a multi-well pad (Gideon Unit 1H API# 47-033-05722). Please reference the wireline logs submitted with Form WR-35 for the Gideon Unit 1H. A Cement Bond Log has been included with this submittal.

Check all wireline logs run caliper density deviated/directional induction neutron resistivity gamma ray temperature

Well cored Yes No Conventional Sidewall Were cuttings collected Yes No

DESCRIBE THE CENTRALIZER PLACEMENT USED FOR EACH CASING STRING _____

Conductor - 0
 Surface - 1 above guide shoe, 1 above insert float, 1 every 4th joint to surface
 Intermediate - 1 above float joint, 1 above float collar, 1 every 4th joint to surface
 Production - 1 above float joint, 1 below float collar, 1 every 3rd joint to top of cement

RECEIVED
Office of Oil and Gas

WAS WELL COMPLETED AS SHOT HOLE Yes No DETAILS _____
 MAY 26 2015

WAS WELL COMPLETED OPEN HOLE? Yes No DETAILS _____
 WV Department of Environmental Protection

WERE TRACERS USED Yes No TYPE OF TRACER(S) USED Radioactive & Chemical

API 47- 033 - 05721 Farm name Varner, James A. Well number Gideon Unit 2H

<u>PRODUCING FORMATION(S)</u>	<u>DEPTHS</u>	
<u>Marcellus</u>	<u>7504' (Top)</u> TVD	<u>7727' (Top)</u> MD
_____	_____	_____
_____	_____	_____
_____	_____	_____

Please insert additional pages as applicable.

GAS TEST Build up Drawdown Open Flow OIL TEST Flow Pump
 SHUT-IN PRESSURE Surface 3600 psi Bottom Hole --- psi DURATION OF TEST --- hrs
 OPEN FLOW Gas 9904 mcfpd Oil --- bpd NGL --- bpd Water 316 bpd GAS MEASURED BY Estimated Orifice Pilot

<u>LITHOLOGY/ FORMATION</u>	<u>TOP</u>		<u>BOTTOM</u>		<u>DESCRIBE ROCK TYPE AND RECORD QUANTITY AND TYPE OF FLUID (FRESHWATER, BRINE, OIL, GAS, H₂S, ETC)</u>
	<u>DEPTH IN FT NAME TVD</u>	<u>DEPTH IN FT TVD</u>	<u>DEPTH IN FT MD</u>	<u>DEPTH IN FT MD</u>	
	<u>0</u>		<u>0</u>		

*PLEASE SEE ATTACHED EXHIBIT 3

Please insert additional pages as applicable.

Drilling Contractor Frontier Drilling LLC
 Address 562 Spring Run Road City Pennsboro State WV Zip 26415

Logging Company Rush Wellsite Services
 Address 600 Alpha Drive City Canonsburg State PA Zip 15317

Cementing Company Allied Oil & Gas Services, LLC
 Address 1036 East Main Street City Bridgeport State WV Zip 26330

Stimulating Company U.S. Well Services
 Address 533 Industrial Park Drive City Jane Lew State WV Zip 26378

Stimulating Company: Nabors Completion & Production Services, Co.
 Address: 1650 Hackers Creek City: Jane Lew State: WV Zip: 26378

Completed by Natalie Komp Telephone 303-357-6820
 Signature *Natalie Komp* Title Permitting Agent Date 5/5/2015

RECEIVED
Office of Oil and Gas
MAY 26 2015

API 47-033-05721 Farm Name Varner, James A. Well Number Gideon Unit 2H

EXHIBIT 1

Stage No.	Perforation Date	Perforated from MD ft.	Perforated to MD ft.	Number of Perforations	Formations
1	11-Feb-14	17018'	17199'	60	Marcellus
2	5-Mar-14	16842'	16991'	60	Marcellus
3	5-Mar-14	16667'	16815'	60	Marcellus
4	5-Mar-14	16491'	16639'	60	Marcellus
5	6-Mar-14	16315'	16464'	60	Marcellus
6	6-Mar-14	16140'	16288'	60	Marcellus
7	7-Mar-14	15381'	15550'	60	Marcellus
8	8-Mar-14	15181'	15350'	60	Marcellus
9	8-Mar-14	14981'	15149'	60	Marcellus
10	8-Mar-14	14780'	14949'	60	Marcellus
11	9-Mar-14	14580'	14749'	60	Marcellus
12	9-Mar-14	14380'	14549'	60	Marcellus
13	9-Mar-14	14179'	14348'	60	Marcellus
14	10-Mar-14	13979'	14148'	60	Marcellus
15	10-Mar-14	13779'	13948'	60	Marcellus
16	11-Mar-14	13579'	13747'	60	Marcellus
17	11-Mar-14	13378'	13547'	60	Marcellus
18	11-Mar-14	13178'	13347'	60	Marcellus
19	12-Mar-14	12978'	13147'	60	Marcellus
20	12-Mar-14	12777'	12946'	60	Marcellus
21	13-Mar-14	12577'	12746'	60	Marcellus
22	13-Mar-14	12377'	12546'	60	Marcellus
23	14-Mar-14	12177'	12346'	60	Marcellus
24	18-Jun-14	11976'	12145'	60	Marcellus
25	19-Jun-14	11776'	11945'	60	Marcellus
26	19-Jun-14	11576'	11745'	60	Marcellus
27	20-Jun-14	11376'	11544'	60	Marcellus
28	20-Jun-14	11175'	11344'	60	Marcellus
29	20-Jun-14	10975'	11144'	60	Marcellus
30	20-Jun-14	10775'	10944'	60	Marcellus
31	20-Jun-14	10574'	10743'	60	Marcellus
32	21-Jun-14	10374'	10543'	60	Marcellus
33	21-Jun-14	10174'	10343'	60	Marcellus
34	21-Jun-14	9974'	10142'	60	Marcellus
35	21-Jun-14	9773'	9942'	60	Marcellus
36	22-Jun-14	9573'	9742'	60	Marcellus
37	22-Jun-14	9373'	9542'	60	Marcellus
38	22-Jun-14	9172'	9341'	60	Marcellus
39	22-Jun-14	8972'	9141'	60	Marcellus
40	23-Jun-14	8772'	8941'	60	Marcellus
41	23-Jun-14	8572'	8740'	60	Marcellus
42	23-Jun-14	8371'	8540'	60	Marcellus
43	23-Jun-14	8171'	8340'	60	Marcellus
44	24-Jun-14	7971'	8140'	60	Marcellus
45	24-Jun-14	7770'	7939'	60	Marcellus

RECEIVED
Office of Oil and Gas

MAY 26 2015

WV Department of
Environmental Protection

06/05/2015

EXHIBIT 2

Stage No.	Stimulations Date	Avg Pump Rate	Avg Treatment Pressure (PSI)	Max Breakdown Pressure (PSI)	ISIP (PSI)	Amount of Proppant (lbs)	Amount of Water (bbls)	Amount of Nitrogen/ other (units)
1	3-Mar-14	71.0	7,661	5,216	5,062	142,120	7,314	N/A
2	5-Mar-14	76.0	8,302	5,999	3,981	264,600	7,015	N/A
3	5-Mar-14	75.0	8,234	5,686	3,853	236,000	7,088	N/A
4	5-Mar-14	75.0	8,272	5,879	4,234	264,500	7,092	N/A
5	6-Mar-14	68.0	8,073	5,565	4,867	156,002	7,140	N/A
6	6-Mar-14	77.0	8,169	5,579	4,742	264,500	7,484	N/A
7	7-Mar-14	74.0	7,525	5,482	3,773	263,780	6,819	N/A
8	8-Mar-14	77.0	8,237	5,651	3,941	255,075	6,746	N/A
9	8-Mar-14	73.0	7,882	5,507	4,667	238,430	7,014	N/A
10	8-Mar-14	78.0	8,026	5,339	4,356	264,700	6,824	N/A
11	9-Mar-14	73.0	7,747	5,325	4,882	259,000	6,750	N/A
12	9-Mar-14	76.0	7,840	5,418	4,964	123,030	7,292	N/A
13	9-Mar-14	77.0	7,971	5,693	4,578	265,400	6,721	N/A
14	10-Mar-14	76.0	8,296	5,507	4,985	260,460	6,733	N/A
15	10-Mar-14	78.0	8,001	5,665	5,225	264,900	6,693	N/A
16	11-Mar-14	75.0	7,990	5,608	5,025	261,000	6,577	N/A
17	11-Mar-14	77.0	8,136	5,533	4,553	267,590	6,772	N/A
18	11-Mar-14	74.0	7,734	5,121	4,606	176,200	6,732	N/A
19	12-Mar-14	78.0	7,794	5,536	4,506	217,750	7,265	N/A
20	12-Mar-14	77.0	7,638	5,472	4,610	248,500	6,448	N/A
21	13-Mar-14	80.0	7,781	5,486	4,735	265,180	6,685	N/A
22	13-Mar-14	78.0	7,822	5,411	4,674	264,900	6,682	N/A
23	14-Mar-14	74.0	8,052	5,475	5,490	250,420	6,526	N/A
24	18-Jun-14	70.7	7,559	6,650	4,349	229,700	6,556	N/A
25	19-Jun-14	78.7	6,945	5,941	4,758	262,000	6,521	N/A
26	19-Jun-14	78.9	7,401	6,124	5,001	230,300	6,491	N/A
27	20-Jun-14	74.3	6,991	6,035	4,640	263,700	6,450	N/A
28	20-Jun-14	76.4	6,850	5,859	4,876	265,000	6,464	N/A
29	20-Jun-14	72.4	7,430	6,359	4,671	122,900	6,459	N/A
30	20-Jun-14	77.0	6,946	6,189	5,289	264,200	6,545	N/A
31	20-Jun-14	76.4	7,034	6,477	4,797	260,600	6,375	N/A
32	21-Jun-14	76.5	6,840	6,021	4,326	264,500	6,478	N/A
33	21-Jun-14	77.0	7,086	5,815	4,980	265,000	6,467	N/A
34	21-Jun-14	74.1	7,246	6,749	4,659	187,500	7,092	N/A
35	21-Jun-14	74.8	7,171	6,296	5,016	263,200	6,582	N/A
36	22-Jun-14	76.3	7,221	6,035	4,598	230,200	6,643	N/A
37	22-Jun-14	76.8	7,049	6,313	5,127	261,300	6,439	N/A
38	22-Jun-14	76.9	7,053	6,812	5,765	257,700	6,357	N/A
39	22-Jun-14	76.7	6,954	6,379	5,653	210,300	6,733	N/A
40	23-Jun-14	76.5	7,114	5,991	5,274	219,600	6,104	N/A
41	23-Jun-14	74.8	7,008	5,991	4,685	180,600	6,408	N/A
42	23-Jun-14	76.4	6,757	6,050	4,752	244,500	6,153	N/A
43	23-Jun-14	74.0	6,867	6,570	4,381	263,400	6,390	N/A
44	24-Jun-14	74.8	6,761	6,393	4,397	265,700	6,364	N/A
45	24-Jun-14	75.1	6,874	6,901	5,281	211,500	6,775	N/A
	AVG=	75.6	7,519	5,891	4,746	10,697,437	REPER	TOTAL

Office of Oil and Gas

MAY 26 2015

06/05/2015

WV Department of
Environmental Protection

EXHIBIT 3

LITHOLOGY/ FORMATION	TOP DEPTH (TVD)	BOTTOM DEPTH (TVD)	TOP DEPTH (MD)	BOTTOM DEPTH (MD)
	From Surface	From Surface	From Surface	From Surface
Freshwater	112	NA	112	NA
Freshwater	173	NA	173	NA
Silty Shale	0	437	0	437
Coal	est. 437	467	est. 437	467
Sandstone	est. 467	497	est. 467	497
Coal	est. 497	527	est. 497	527
Sandstone	est. 527	597	est. 527	597
Silty Shale	est. 597	667	est. 597	667
Sandstone	est. 667	707	est. 667	707
Coal	est. 707	737	est. 707	737
Sandstone	est. 737	797	est. 737	797
Sandy Shale	est. 797	887	est. 797	887
Shale	est. 887	977	est. 887	977
Sandy Siltstone	est. 977	1,107	est. 977	1,107
Shale	est. 1107	1,307	est. 1107	1,307
Sandstone	est. 1307	1,402	est. 1307	1,402
Coal	est. 1402	1,427	est. 1402	1,427
Shale	est. 1427	1,462	est. 1427	1,462
Coal	est. 1462	1,487	est. 1462	1,487
Shale	est. 1487	1,577	est. 1487	1,577
Sandstone	est. 1577	1,637	est. 1577	1,637
Shale	est. 1637	1,797	est. 1637	1,797
Sandy Siltstone/Coal	est. 1797	1,827	est. 1797	1,827
Silty Sandstone	est. 1827	1,979	est. 1827	1,979
Coal	est. 1979	1,997	est. 1979	1,997
Sandy Shale/Coal	est. 1997	2,238	est. 1997	2,341
Big Lime	2,238	2,467	2,341	2,470
Big Injun	2,467	2,812	2,470	2,815
Gantz Sand	2,812	2,907	2,815	2,910
Fifty Foot Sandstone	2,907	3,018	2,910	3,021
Gordon	3,018	3,340	3,021	3,343
Fifth Sandstone	3,340	3,373	3,343	3,376
Bayard	3,373	3,718	3,376	3,721
Warren	3,718	4,149	3,721	4,152
Speechley	4,149	4,456	4,152	4,459
Baltown	4,456	4,794	4,459	4,797
Bradford	4,794	5,313	4,797	5,316
Benson	5,313	5,603	5,316	5,606
Alexander	5,603	5,830	5,606	5,833
Elk	5,830	6,293	5,833	6,296
Rhinestreet	6,293	6,945	6,296	6,948
Sycamore	6,945	7,166	6,948	7,187
Middlesex	7,166	7,316	7,187	7,374
Burkett	7,316	7,343	7,374	7,411
Tully	7,343	7,504	7,411	7,727
Marcellus	7,504	NA	7,727	NA

*Please note Antero determines shallow formation tops based on mud and/or wireline logs that are only run on one well on a multi-well pad (Please reference Wireline Logs submitted for the Gideon Unit 1H API# 47-033-05722). The measured depth (MD) data on subsequent wells may be slightly different due to the well's unique departure.

RECEIVED
Office of Oil and Gas

MAY 26 2015

WV Department of
Environmental Protection 06/05/2015

Hydraulic Fracturing Fluid Product Component Information Disclosure

Job Start Date:	3/3/2014
Job End Date:	3/14/2014
State:	West Virginia
County:	Harrison
API Number:	47-033-05721-00-00
Operator Name:	Antero Resources Corporation
Well Name and Number:	Gideon Unit 2H
Longitude:	-80.54718300
Latitude:	39.25463100
Datum:	NAD27
Federal/Tribal Well:	NO
True Vertical Depth:	7,562
Total Base Water Volume (gal):	5,999,532
Total Base Non Water Volume:	0



Hydraulic Fracturing Fluid Composition:

Trade Name	Supplier	Purpose	Ingredients	Chemical Service Abstract Number (CAS #)	Maximum Ingredient Concentration in Additive (% by mass)**	Maximum Ingredient Concentration in HF Fluid (% by mass)**	Comments
Water	ANTERO RESOURCES	Water					
			Water	7732-18-5	100.00000	90.33389	
Sand	Nabors Completion and Production Services	Sand - Bulk - West Virginia					
			Crystalline Silica, quartz	14808-60-7	99.90000	5.70505	
			Aluminum Oxide	1344-28-1	1.10000	0.06282	
			Titanium Oxide	13463-67-7	0.10000	0.00571	
			Iron Oxide	1309-37-1	0.10000	0.00571	
Sand	Nabors Completion and Production Services	Sand - Bulk - West Virginia					
			Crystalline Silica, quartz	14808-60-7	99.90000	2.90771	
			Aluminum Oxide	1344-28-1	1.10000	0.03202	
			Iron Oxide	1309-37-1	0.10000	0.00291	
			Titanium Oxide	13463-67-7	0.10000	0.00291	
Sand	Nabors Completion and Production Services	Sand - Bulk - West Virginia					
			Crystalline Silica, quartz	14808-60-7	99.90000	0.80800	
			Aluminum Oxide	1344-28-1	1.10000	0.00890	

LSG-100L	Nabors Completion and Production Services	Gelling Agents	Iron Oxide	1309-37-1	0.10000	0.00081
			Titanium Oxide	13463-67-7	0.10000	0.00081
WFR-3B	Nabors Completion and Production Services	Friction Reducer	Petroleum Distillates	64742-47-8	70.00000	0.06450
			Hydrotreated light distillates, non-aromatic, BTEX free	64742-47-8	30.00000	0.02618
			Ethoxylated alcohols	68002-97-1	15.00000	0.01309
			Ethoxylated oleylamine	26635-93-8	5.00000	0.00436
HCl Acid (12.5-18.0%), 22 Baume	Nabors Completion and Production Services	Bulk Acid	Water	7732-18-5	100.00000	0.01147
KR-153SL	Nabors Completion and Production Services	Biocides				
			Polyethylene-Glycol	25322-68-3	50.00000	0.00813
			2,2-dibromo-3-nitropropanamide	10222-01-2	20.00000	0.00325
HCl Acid (12.5-18.0%), 22 Baume	Nabors Completion and Production Services	Bulk Acid				
			22° Baume Hydrochloric Acid	7647-01-0	100.00000	0.00938
Super GREEN SOLV-M	Nabors Completion and Production Services	Paraffin & Scale Additives				
			Aliphatic Hydrocarbons	Proprietary	95.00000	0.00300
			Dodecane	Proprietary	14.00000	0.00044
			tetradecane	Proprietary	11.00000	0.00035
			Tridecane	Proprietary	9.00000	0.00029
			Undecane	Proprietary	8.00000	0.00025
Super TSC 2 LT	Nabors Completion and Production Services	Paraffin & Scale Additives				
			Bis(hexamethylene)triamine	35657-77-3	15.00000	0.00222
			Penta (methylene phosphonic acid), Sodium Salt			
OB-2 LT	Nabors Completion and Production Services	Gel Breakers	Ammonium Persulfate	7727-54-0	85.00000	0.00058
			Crystalline Silica (in the form of quartz)	14808-60-7	10.00000	0.00007
Acid Inhibitor 2 (AI-2)	Nabors Completion and Production Services	Acid Corrosion Inhibitors				
			Glycol Ethers	111-46-6	40.00000	0.00013
			Isopropyl Alcohol	67-63-0	40.00000	0.00013
			Propargyl Alcohol	107-19-7	40.00000	0.00013

WV Department of Environmental Protection
 Office of Oil and Gas
 RECEIVED
 MAY 26 2015

MA 09 JUL 1954

MA 09 JUL 1954

MA 09 JUL 1954

EB-4L	Nabors Completion and Production Services	Gel Breakers	68412-54-4	13.00000	0.00004
		Etlioxyated Nonylphenol	72480-70-7	10.00000	0.00003
		Tar bases, quinoline derivs, benzyl chloride-quaternized			
			107-21-1	40.00000	0.00016
		Ethylene Glycol			
Ingredients shown above are subject to 29 CFR 1910.1200(i) and appear on Material Safety Data Sheets (MSDS). Ingredients shown below are Non-MSDS.					
Other Ingredients	Nabors Completion and Production Services	Other Ingredients			
		guar gum	9000-30-0	50.00000	0.04607
		Water	7732-18-5	40.00000	0.03491
		Anionic Polyacrylamide	910644-97-2	40.00000	0.03491
		Water	7732-18-5	90.00000	0.01333
		Propylene glycol	57-55-6	15.00000	0.01309
		Water	7732-18-5	80.00000	0.01300
		Surfactant	68439-51-0	2.00000	0.00184
		Crystalline Silica (in the form of quartz)	14808-60-7	2.00000	0.00184
		Proprietary	Proprietary	2.00000	0.00175
		Proprietary	Proprietary	100.00000	0.00040
		Sugar	57-50-1	100.00000	0.00040
		Water	7732-18-5	100.00000	0.00020
		Water	7732-18-5	48.00000	0.00016
		Alkali Chloride salt	Proprietary	15.00000	0.00010
		2-Butoxyethanol	111-76-2	13.00000	0.00004
		Proprietary	Proprietary	1.00000	0.00000
		Proprietary	Proprietary	1.00000	0.00000
		Proprietary	Proprietary	1.00000	0.00000
		Proprietary	Proprietary	1.00000	0.00000
		Dioxane	123-91-1	1.00000	0.00000
		Organophylic Clay	68953-58-2	1.00000	0.00000

RECEIVED
 Office of Oil and Gas
 MAY 26 2015
 WV Department of Environmental Protection

* Total Water Volume sources may include fresh water, produced water, and/or recycled water

** Information is based on the maximum potential for concentration and thus the total may be over 100%

Note: For Field Development Products (products that begin with FDP), MSDS level only information has been provided. Ingredient information for chemicals subject to 29 CFR 1910.1200(i) and Appendix D are obtained from suppliers Material Safety Data Sheets (MSDS)

Antero Resources
Well No. Gideon Unit 2H
As-Drilled Plat
Antero Resources Corporation



6,577' to Bottom Hole
 1,719' to Top Hole
TOP HOLE LATITUDE 39 - 17 - 30
BOTTOM HOLE LATITUDE 39 - 15 - 00

Notes:
 West Virginia Coordinate System of 1927, North Zone
based upon Differential GPS Measurements.
 Well No. Gideon Unit 2H Top Hole coordinates are
 N: 276,579.87' Latitude: 39°15'16.67"
 E: 1,703,463.51' Longitude: 80°32'49.86"
 Bottom Hole coordinates are
 N: 269,528.62' Latitude: 39°14'07.75"
 E: 1,710,228.07' Longitude: 80°31'22.85"
UTM Zone 17, NAD 1983
 Top Hole Coordinates Bottom Hole Coordinates
 N: 4,345,141.344m N: 4,343,027.536m
 E: 539,084.943m E: 541,181.613m
 Plat orientation and corner and well references
 are based upon the grid north meridian.
 Well location references are based upon the magnetic
 meridian.

TOP HOLE LONGITUDE 80 - 32 - 30
 BOTTOM HOLE LONGITUDE 80 - 30 - 00



Par	Tax Map 321 Owner	Bk/Pg	Acres
1	31.2 Patrick J. Shaver	1427/445	5.0
2	31.4 Dan Arnold & Crystal Shahan	1268/976	9.55
3	40 Clifford S. Cleavenger, et al	1407/977	25.88
4	40.3 Clifford S. Cleavenger, et al	1407/979	0.81
5	40.4 Clifford & Laura Cleavenger	1406/1196	1.06
6	30 Anthony E. Feathers	1453/1121	52.5
7	39 John & Marianne Cleavenger	1247/290	33.5

Par	Tax Map 322 Owner	Bk/Pg	Acres
8	19 David B. Taylor	1301/1067	14.0
9	20 James A. Varner	197/478	16.63
10	21.2 Jeffrey W. Nelson	1284/7	1.08
11	21.1 James A. Varner	1261/953	1.45
12	22 Kitty Sugars, et al	WB165/211	0.35
13	22.3 James A. Varner	1131/151	15.94
14	21 James A. Varner	1199/860	35.0



Top Hole coordinates verified by survey grade GPS.
 As-drilled data and information was provided by Antero Resources Corporation.
 Allegheny Surveys, Inc. (ASI) is not certifying the data and information provided. ASI is not responsible for any errors or inaccuracies with the data and information that has been provided.

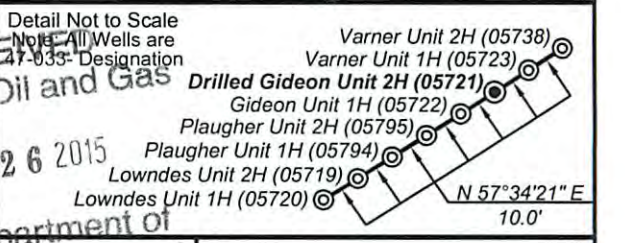

FILE NO: 153-36-TM-12
 DRAWING NO: 153-12 Gideon 2H As-Drilled
 SCALE: 1" = 1200'
 MINIMUM DEGREE OF ACCURACY:
 Submeter
 PROVEN SOURCE OF ELEVATION:
 WVDOT, Bridgeport, WV

STATE OF WEST VIRGINIA
 DEPARTMENT OF ENVIRONMENTAL PROTECTION
OIL AND GAS DIVISION

DATE: March 30 2015
 OPERATOR'S WELL NO. Gideon Unit 2H
 API WELL NO
47 - 033 - 05721
 STATE COUNTY PERMIT

WELL TYPE: OIL GAS LIQUID INJECTION WASTE DISPOSAL
 (IF GAS) PRODUCTION: STORAGE DEEP SHALLOW
 LOCATION: ELEVATION: Original Grade - 1474' Existing Grade - 1456' WATERSHED: Tenmile Creek QUADRANGLE: Salem & Big Isaac
 DISTRICT: Tenmile-Outside COUNTY: Harrison
 SURFACE OWNER: James A. Varner James A. Varner, Sr.; James A. Varner, et al; Tetrick Group II Revocable Trust; ACREAGE: 65.45 62.394 36; 1026.936
 ROYALTY OWNER: Gideon M. & J. I. Thompson; Richard Roach, et al; Justin L. Henderson LEASE NO: 044999; 21193; 21179 ACREAGE: 144; 17.5; 35
 PROPOSED WORK: DRILL CONVERT DRILL DEEPER FRACTURE OR STIMULATE PLUG OFF OLD FORMATION
 PERFORATE NEW FORMATION OTHER PHYSICAL CHANGE IN WELL (SPECIFY) As-Drilled
 PLUG AND ABANDON CLEAN OUT AND REPLUG TARGET FORMATION: Marcellus Shale 7,393' TVD DEPTH: 17,235' MD

WELL OPERATOR: Antero Resources Corporation DESIGNATED AGENT: Dianna Stamper - CT Corporation System
 ADDRESS: 1615 Wynkoop Street ADDRESS: 5400 D Big Tyler Road
Denver, CO 80202 Charleston, WV 25313