

Legend

- Proposed gas well
- Found Monument (as noted)
- Creek or Drain
- Existing Road
- Surface boundary (approx.)
- Interior surface tracts (approx.)

	Bearing	Distance
L1	S 67°34' E	578.4'
L2	N 89°42' W	942.1'
L3	S 47°46' W	1391.8'
L4	S 00°54' W	1103.9'
L5	N 61°17' E	1195.4'

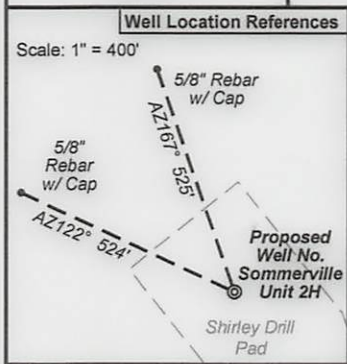

Par.	Tax Map	362 Owner	Bk/Pg	Acres
1	27	Michael S. Kingston & Elizabeth Kocsis	1308/104	54.58

I, the undersigned, hereby certify that this plat is correct to the best of my knowledge and belief and shows all the information required by law and the rules issued and prescribed by the Department of Environmental Protection.

Kenneth J. Plum
Kenneth J. Plum, P.S. 2216

Notes:
West Virginia Coordinate System of 1927, North Zone based upon Differential GPS Measurements.
Well No. Somerville Unit 2H Top Hole coordinates are
N: 261,119.99' Latitude: 39°12'44.67"
E: 1,710,524.03' Longitude: 80°31'17.87"
Bottom Hole coordinates are
N: 269,618.92' Latitude: 39°14'08.52"
E: 1,709,136.27' Longitude: 80°31'36.74"
UTM Zone 17, NAD 1983
Top Hole Coordinates Bottom Hole Coordinates
N: 4,340,467.329m N: 4,343,049.498m
E: 541,314.474m E: 540,848.530m
Plat orientation and corner and well references are based upon the grid north meridian.
Well location references are based upon the magnetic meridian.

FILE NO: 310-36-U-12
DRAWING NO: 310-12 Somerville 2H Well
SCALE: 1" = 1200'
MINIMUM DEGREE OF ACCURACY: Submeter
PROVEN SOURCE OF ELEVATION: WVDOT, Bridgeport, WV

STATE OF WEST VIRGINIA
DEPARTMENT OF ENVIRONMENTAL PROTECTION
OIL AND GAS DIVISION

DATE: October 29 2013
OPERATOR'S WELL NO. Somerville Unit 2H
API WELL NO
47 - 033 - 05799 H6A
STATE COUNTY PERMIT

WELL TYPE: OIL GAS LIQUID INJECTION WASTE DISPOSAL
(IF GAS) PRODUCTION: STORAGE DEEP SHALLOW
LOCATION: ELEVATION: 1328' WATERSHED: Tenmile Creek QUADRANGLE: Big Isaac
DISTRICT: Union COUNTY: Harrison
SURFACE OWNER: Shirley Jo Davis ACREAGE: 87.70
ROYALTY OWNER: Douglas Roy Meister; Freda M. Allman; Sally D. Federer; Jean Elizabeth King LEASE NO: 21443; DAD65592/001 ACREAGE: 22.75; 112.64; 48.3
PROPOSED WORK: DRILL CONVERT DRILL DEEPER FRACTURE OR STIMULATE PLUG OFF OLD FORMATION
 PERFORATE NEW FORMATION OTHER PHYSICAL CHANGE IN WELL (SPECIFY) _____
 PLUG AND ABANDON CLEAN OUT AND REPLUG TARGET FORMATION: Marcellus Shale ESTIMATED DEPTH: 18,200' MD

WELL OPERATOR: Antero Resources Corporation DESIGNATED AGENT: Dianna Stamper - CT Corporation System
ADDRESS: 1625 17th Street ADDRESS: 5400 D Big Tyler Road
Denver, CO 80202 Charleston, WV 25313

CANCELLED

02/05/2016

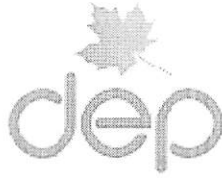

west virginia department of environmental protection

Office of Oil and Gas
601 57th Street SE
Charleston, WV 25304
(304) 926-0450
(304) 926-0452 fax

Earl Ray Tomblin, Governor
Randy C. Huffman, Cabinet Secretary
www.dep.wv.gov

January 22, 2016

FINAL INSPECTION REPORT

Well Permit Cancelled

ANTERO RESOURCES CORPORATION,

The FINAL INSPECTION REPORT for the CANCELLED permit, API Well Number: 47-3305799, issued to ANTERO RESOURCES CORPORATION, and listed below has been received in this office. The permit has been cancelled as of 1/21/2016.

James Martin
Chief

Operator: ANTERO RESOURCES CORPORATION
Operator's Well No: SOMMERVILLE UNIT 2H
Farm Name: DAVIS, SHIRLEY JO
API Well Number: 47-3305799
Date Issued: 01/15/2014

Date Cancelled: 01/21/2016

Promoting a healthy environment.

02/05/2016

INSPECTORS PERMIT SUMMARY FORM

GPS YES [] NO []

DATE STARTED/LOCATION: _____ OPERATOR: ANTERO RESOURCES CORPORATI
 DRILLING COMMENCED: _____ FARM: DAVIS, SHIRLEY JO
 TO DATE: _____ DEPTHS: _____ Well No: SOMMERVILLE UNIT 2H
 WATER DEPTHS: _____ COAL DEPTHS _____

QUESTIONS FOR THIS REPORT ARE IN ACCORDANCE OF WV CODE 22-6-30 AND REGULATIONS 35CSR 4-12.1 AND 35CSR 4-16 AND THE GENERAL WATER POLLUTION CONTROL PERMIT.

POINTS ARE TO BE GIVEN UP TO MAXIMUM AS SHOWN BASED ON PERFORMANCE.

1. DID OPERATOR GIVE PROPER NOTICE TO INSPECTOR BEFORE THE FOLLOWING:
 - A. CONSTRUCTION YES [] NO [] (2_PTS) (4_PTS) _____
 - B. DRILLING YES [] NO [] (2_PTS)
2. WAS THE TIMBER CUT, STACKED, AND BRUSH USED FOR SEDIMENT BARRIERS BEFORE DIRT WORK STARTED? YES [] NO [] (2_PTS) (4_PTS) _____
3. ARE ALL LOCATION AND/OR ROAD BANKS BEING SLOPED? YES [] NO [] (4_PTS) (4_PTS) _____
4. CONSTRUCTIONS:
 WERE THE FOLLOWING SEDIMENT CONTROL STRUCTURES PROPERLY INSTALLED/MAINTAINED?
 - A. ROAD DITCHES (1)_ (2)_ (3)_ (4)_ (PTS) B. CROSS DRAINS (1)_ (2)_ (3)_ (4)_ (5)_ (PTS)
 - C. CULVERTS (1)_ (2)_ (3)_ (4)_ (5)_ (PTS) D. CREEK CROSSINGS (1)_ (2)_ (3)_ (PTS)
 - E. DIVERSION DITCHES (1)_ (2)_ (3)_ (PTS) F. BARRIERS (1)_ (2)_ (3)_ (PTS)
 - G. TEMPORARY SEEDING YES [] NO [] (10_PTS)

POINTS AVAILABLE FOR QUESTION 4: (33_PTS) _____

5. HAS TOP SOIL (IF ANY) BEEN STOCKED PILED? YES [] NO [] (2_PTS) (2_PTS) _____
6. IS THE PIT PROPERLY INSTALLED AND MAINTAINED? YES [] NO [] (9_PTS) (9_PTS) _____
7. RECLAMATION:
 - A. ROADWAY (1)_ (2)_ (3)_ (PTS) B. LOCATION (1)_ (2)_ (3)_ (PTS)
 - C. PITS (1)_ (2)_ (3)_ (PTS) D. PIPELINES (1)_ (2)_ (3)_ (PTS)
 - E. TANK DIKES (1)_ (2)_ (3)_ (PTS) F. API INSTALLED YES [] NO [] (3_PTS)
 - G. ADEQUATE SEEDING MATERIALS (1)_ (2)_ (3)_ (PTS)
 - H. WAS SEED BED ADEQUATE (1)_ (2)_ (3)_ (PTS)

POINTS AVAILABLE FOR QUESTION 7: (24_PTS) _____

8. WAS RECLAMATION COMPLETED WITHIN:
 6 MTHS OF TD 6_PTS ONLY; 4 MTHS OF TD 12_PTS ONLY; 2 MTHS OF TD 19_PTS ONLY;
 POINTS AVAILABLE FOR QUESTION 8: (19_PTS) _____

TOTAL MAXIMUM POSSIBLE SCORE OF 99.

TOTAL RECLAMATION SCORE: _____

1/21/2016
DATE RELEASED

[Signature]
INSPECTOR'S SIGNATURE

RECORD INSPECTIONS TO THIS WELL ON PAGE 2

Cancel