



190° S

Latitude

39.336470°

LOCAL 12:12 PM

Longitude

-80.417840°

TUESDAY 09.02.2025

ALTITUDE 284 FEET

03/13/2026

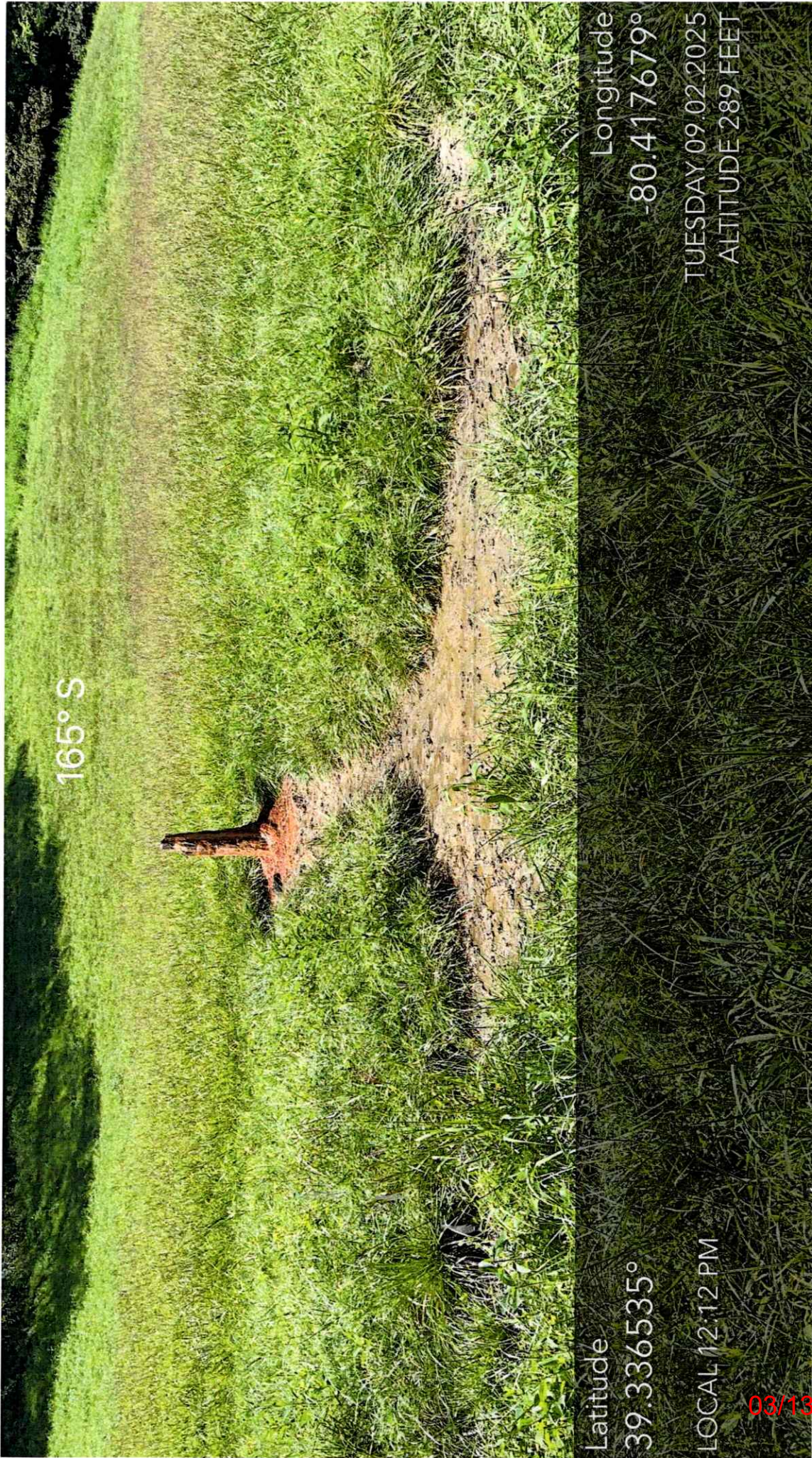

165° S

Latitude

39.336535°

LOCAL 12:12 PM

Longitude

-80.417679°

TUESDAY 09.02.2025

ALTITUDE 289 FEET

03/13/2026

WW-7
8-30-06



West Virginia Department of Environmental Protection
Office of Oil and Gas
WELL LOCATION FORM: GPS

API: 4703305917 WELL NO.: Nancy Allen 795
FARM NAME: McPherson
RESPONSIBLE PARTY NAME: DEP Paid Plugging Contract
COUNTY: Harrison DISTRICT: Sardis
QUADRANGLE: Wolf Summit
SURFACE OWNER: McPherson Adam S. & Lena A.
ROYALTY OWNER: Consolidated Gas
UTM GPS NORTHING: 5 50 172
UTM GPS EASTING: 43 54 279 GPS ELEVATION: 941'

The Responsible Party named above has chosen to submit GPS coordinates in lieu of preparing a new well location plat for a plugging permit or assigned API number on the above well. The Office of Oil and Gas will not accept GPS coordinates that do not meet the following requirements:

1. Datum: NAD 1983, Zone: 17 North, Coordinate Units: meters, Altitude: height above mean sea level (MSL) – meters.
2. Accuracy to Datum – 3.05 meters
3. Data Collection Method:

Survey grade GPS : Post Processed Differential

Real-Time Differential

Mapping Grade GPS : Post Processed Differential

Real-Time Differential

4. **Letter size copy of the topography map showing the well location.**

I the undersigned, hereby certify this data is correct to the best of my knowledge and belief and shows all the information required by law and the regulations issued and prescribed by the Office of Oil and Gas.

Bryan Harris

Inspector Specialist

Nov 6, 2025

Signature

Title

Date

03/13/2026