

HG Energy II Appalachia, LLC
Well No. 1208 N-2H

Page 1 of 3

7,546' to Bottom Hole
2,227' to Top Hole

BTM LATITUDE 39 - 12 - 30
TOP LATITUDE 39 - 10 - 00

I, the undersigned, hereby certify that this plat is correct to the best of my knowledge and belief and shows all the information required by law and the rules issued and prescribed by the Department of Environmental Protection.

Dwayne D. Matheny, P.S. 2070

LONGITUDE 80 - 25 - 00
4,886' to Top Hole
8,415' to Bottom Hole

Tag	Bearing	Dist.
L1	S 37°21' E	1,217.2'
L2	S 21°53' E	1,230.3'
L3	N 89°37' W	1,352.0'
L4	N 67°27' W	1,180.0'
L5	N 87°32' W	1,250.3'



Notes:
Well No. 1208 N-2H
UTM NAD 1983 (USSF)
Top Hole Coordinates
N: 14,218,970.45' E: 1,803,605.49'
Landing Point Coordinates
N: 14,219,024.29' E: 1,802,356.35'
Bottom Hole Coordinates
N: 14,230,578.81' E: 1,798,212.32'

Notes: Well No. 1208 N-2H
West Virginia Coordinate System of 1927, South Zone based upon Differential GPS Measurements.
Top Hole coordinates Bottom Hole coordinates
Latitude: 39°09'11.69" Latitude: 39°11'08.80"
Longitude: 80°25'28.28" Longitude: 80°26'35.86"
UTM Zone 17, NAD 1983
Top Hole Coordinates Bottom Hole Coordinates
N: 4,333,950.861m N: 4,337,489.096m
E: 549,740.052m E: 548,096.211m
Plat orientation and corner and well references are based upon the grid north meridian.
Well location references are based upon the magnetic meridian.

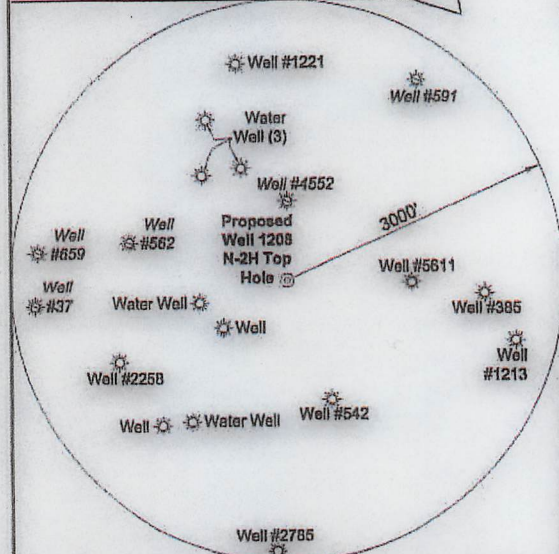

Note: 5 water wells were found within 2000' of proposed well. No occupied dwellings or buildings 2,500 square feet or larger used to house or shelter dairy cattle or poultry husbandry are located within 625' of the center of the well pad.

ID	Lessee
1	Jerome B. Guzman
2	Leeman B. Maxwell Heirs
3	William Burnside, et al
4	Oris Myers, et al
5	Claude Hackett, et al
6	Leeman B. Maxwell Heirs
10	Rebecca D. Reed, et al
11	David Scott, et al
12	Nathan Post, et al
13	William Burnside, et al
14	Joseph Cheuvront, et al
16	Howard W. Vanscoy, et al
18	George W. Washburn, et al
19	Lloyd Washburn, et al
21	Dige E. Washburn, et al
21.2	HG Energy II 108
21.3	HG Energy II 108
21.4	HG Energy II 110
22	J.P. Post & C.F. Post
23	Fee

Top Hole
7.5' Spot



SEAL

Legend	
	Proposed gas well
	Well Reference, as noted
	Monument, as noted
	Existing Well, as noted
	Existing Plugged Well, as noted
	Digitized Well, as noted
	Creek or Drain
	Existing Road
	Surface boundary (approx.)
	Interior surface tracts (approx.)

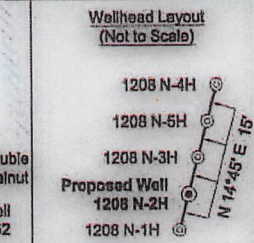
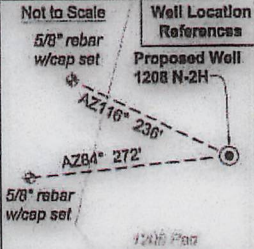

FILE NO: 195-36-G-18
DRAWING NO: 1208 N-2H Well Plat
SCALE: 1" = 1500'
MINIMUM DEGREE OF ACCURACY: Submeter
PROVEN SOURCE OF ELEVATION: CORS, Bridgeport, WV

STATE OF WEST VIRGINIA
DEPARTMENT OF ENVIRONMENTAL PROTECTION
OIL AND GAS DIVISION

DATE: January 24 20 19
OPERATOR'S WELL NO. 1208 N-2H
API WELL NO
47 - 033 - 05453
STATE COUNTY PERMIT

WELL TYPE: OIL GAS LIQUID INJECTION WASTE DISPOSAL
(IF GAS) PRODUCTION: STORAGE DEEP SHALLOW

LOCATION: ELEVATION: 1,149' WATERSHED: Middle West Fork Creek
DISTRICT: Grant / Union
SURFACE OWNER: Linda & William W. Brodwater III
ROYALTY OWNER: Leeman B. Maxwell Heirs, et al LEASE NO: ACREAGE: 247.84

PROPOSED WORK: DRILL CONVERT DRILL DEEPER FRACTURE OR STIMULATE PLUG OFF OLD FORMATION
 PERFORATE NEW FORMATION OTHER PHYSICAL CHANGE IN WELL (SPECIFY) 7,050' TVD
 PLUG AND ABANDON CLEAN OUT AND REPLUG TARGET FORMATION: Marcellus Shale ESTIMATED DEPTH: 19,910' MD

WELL OPERATOR: HG Energy II Appalachia, LLC DESIGNATED AGENT: Diane C. White
ADDRESS: 5260 Dupont Road ADDRESS: 5260 Dupont Road
Parkersburg, WV 26101 Parkersburg, WV 26101