

LATITUDE 39° 17' 30"



0.95 D
1.86 W

80° 21' 08" LONGITUDE

7'5 OGIS topo location

7.5' loc _____ 15' loc _____
(calc.) _____

Company HNG Co. (7537)

Farm Samuel Farris

Quad Rosemont 7 1/2

County Harrison

District Simpson

WELL LOCATION MAP

File No. 033 - 30292

Simpson District, Harrison County, W. Va. 292A
 By Hope Natural Gas Co., 445 W. Main St., Clarksburg, W. Va.
 On 105 acres, surface owned by Samuel S. Farris Heirs,
 Bridgeport, W. Va.
 Elevation, 1346' L.
 10" casing, 156' (pulled); 8 $\frac{1}{2}$ "², 903' (260' pulled); 6-5/8"²,
 1419' (pulled); 2" tubing, 1574'.
 6-5/8 x 2" anchor packer, set at 1462'; 2" anchor, 112'.
 No coal was encountered.
 Abandonment reported to Dept. of Mines March 12, 1936.
 Well was shot at 1516'.
 Water at 660-725' (salt).
 Gas well.

	Top.	Bottom.	Thickness.
Little Dunkard Sand	475	- 500	25
Big Dunkard Sand (water, 660-725')	555	- 600	45
First Salt Sand	710	- 745	35
Second Salt Sand	820	- 875	55
Third Salt Sand	877	- 915	38
Maxton Sand	1240	- 1305	65
Little Lime	1390	- 1405	15
Pencil Cave	1405	- 1410	5
Big Lime	1410	- 1485	75
Big Injun Sand (gas, 1500-1508-1524')	1485	- 1595	110
Fifty-foot Sand	1833	- 1950	117
Thirty-foot Sand	1960	- 2150	90
Stray Sand	2126		
Gordon Sand	2270	- 2300	30
Fourth Sand	2385	- 2400	15
Fifth Sand	2450	- 2500	50
Original total depth		2603	
Filled up to		1574	

W. PE NAURAL GAS CO
SAMUEL FARIS
SIMPSON

District

HARRISON

County, W. Va.

Clayburg, W. Va. on the

Face containing of 102 Acres

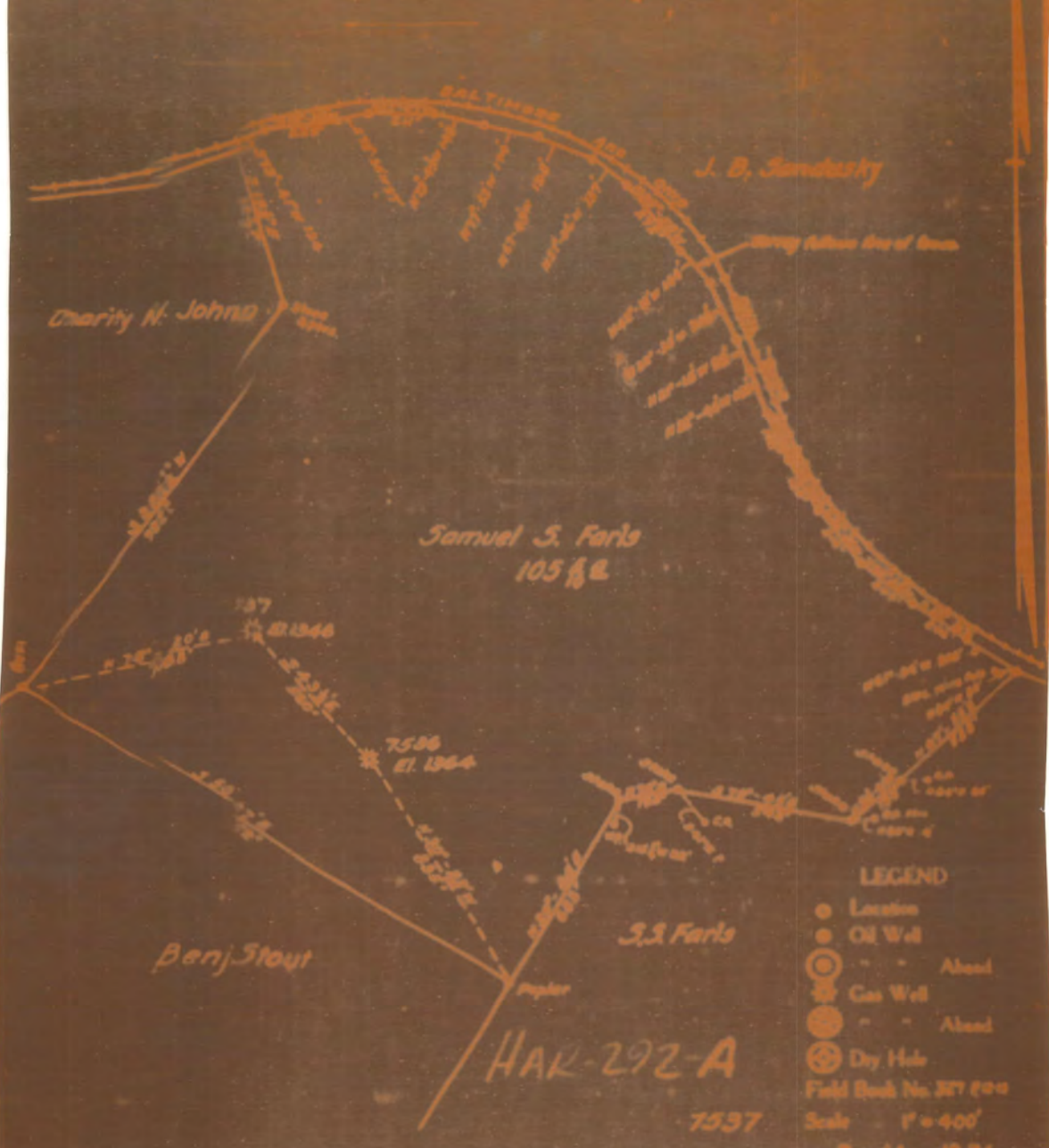

LEGEND

- Location
- Oil Well
- ⊙ " " Ahead
- ⊙ Gas Well
- ⊙ " " Ahead
- ⊙ Dry Hole

Field Book No. 277 000

Scale 1" = 400'

5-11-1936

HAR-292-A

7537

ENGINEERS CERTIFICATE

I, the undersigned, hereby certify that this map is correct and shows all the information to the best of my knowledge and belief, required by the oil and gas section of the mining laws of West Virginia.