

New Location
 Drill Design
 Abandonment

Company *South Penn Natural Gas Co*
 Address *Parkersburg, W Va*
 Farm *G.W. Hartley*
 Tract Acres *40* Lease No. *83126*
 Well Farm No. Serial No.
 Elevation *258 10*
 Ownership *Fairmont*

SEE IT MAKE NOTE

STATE OF WEST VIRGINIA
DEPARTMENT OF MINES
OIL AND GAS DIVISION
CHARLESTON

WELL LOCATION MAP
FILE NO. *11AR-699A*

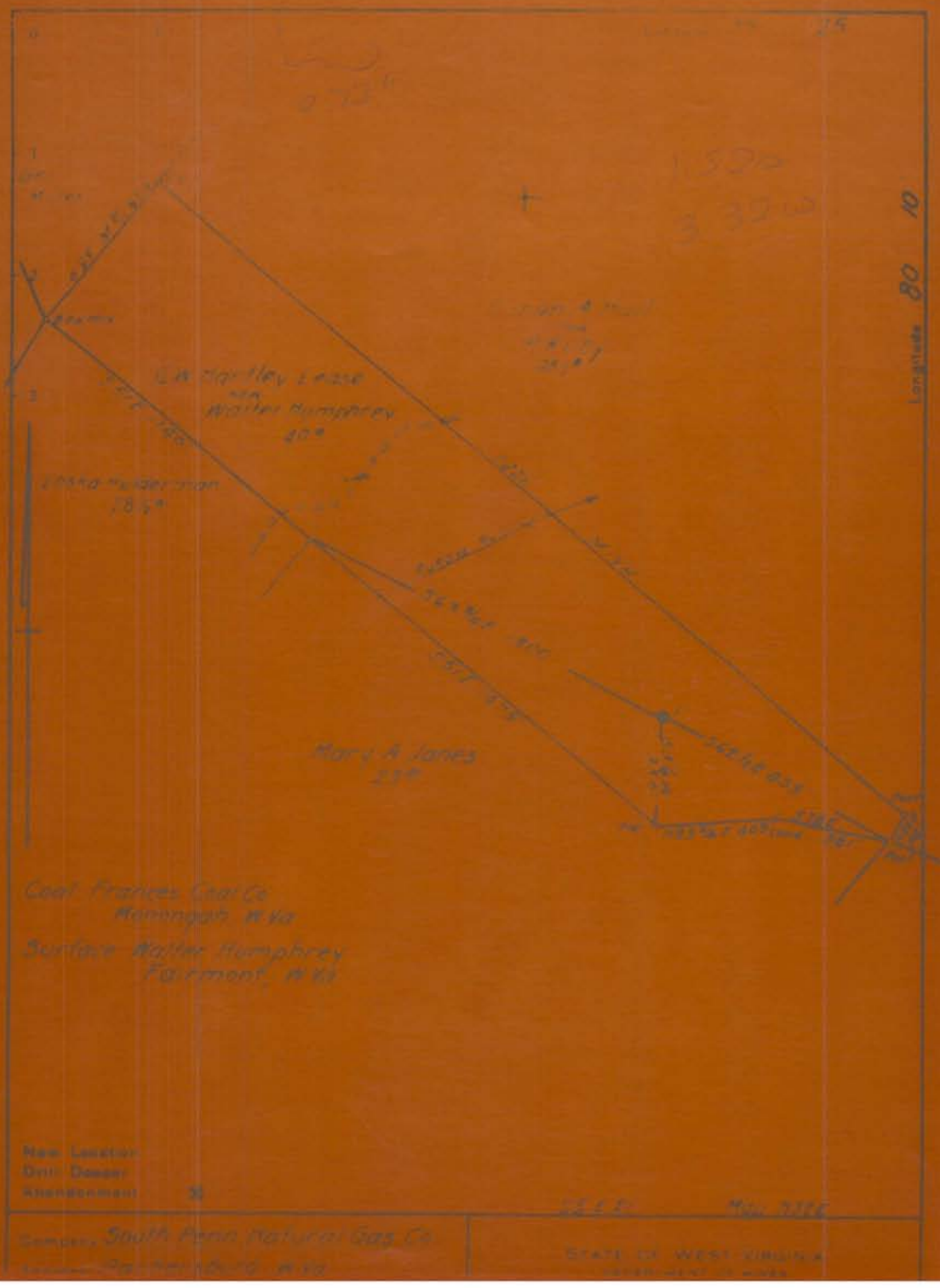

2734

1890
332W

Latitude 80 10

Walter Humphrey
40°

20th Amendment
78 5°

Mary A Jones
21°

Coal Frances Coal Co
Martinsburg, W. Va.

Surface Walter Humphrey
Fairmont, W. Va.

New Location
Drill Docket
Amendment 35

1/4 MI 1/2 MI

Company: South Penn. Natural Gas Co

State of West Virginia
Department of State

WELL RECORD

Oil or Gas Well
No. 111

Company	South Penn Natural Gas Company	Casing and Tubing	Used in Drilling	Left in Well	Packers	
Address	Union Trust Bldg. Park St. Bldg., N. Va.					
Name	G. S. Hartley					
Location	Purdy out of Warner Am				Cal. 2 1/2" Anchor	
Well No.	1				Nips Shoe	
District	Play				Size of 6-5/8"	
The surface of well is owned in fee by	Walter Humphrey					
Mineral rights are owned by	Walter Humphrey					
ERL Country Club	Walter S. Humphrey et al				Depth set "	
Dating commenced	Nov. 9, 1910				Perf. top "	
Dating completed	Dec. 27, 1910				Perf. bottom "	
Drilled by	W. S. Hill				Perf. top "	
Open Flow	10 hrs Water 0				Perf. bottom "	
	10 hrs Mercur					
Volume		cu ft	USED - CEMENTED -	STEEL -	No. Ft	Date
Back Pressure		hrs				
Oil		666.1st 24 hrs	ALL WAY ENCOUNTERED AT	200 FEET	84	INCHES
Fresh Water		feet	FEET	INCHES	FEET	INCHES
SALT WATER	1155	feet	FEET	INCHES	FEET	INCHES

Formation	Color	Hard or Soft	Top	Bottom	Oil, Gas or Water	Depth Found	Remarks
Pittsburgh Coal			505	517			
Little Duffard			740	8-0			
Gas Sand			840	1085			
Salt Sand			1155	1294	Water	1155	
Little Lime			1310	1630			
Big Lime			1640	1706			
Big Injun			1706	1840			
Fifty Foot			1890	2297			
					oil	2226-2230	

Total Depth