

Latitude 39° 30'

Longitude 80° 25'

Scale 1" = 800 Feet

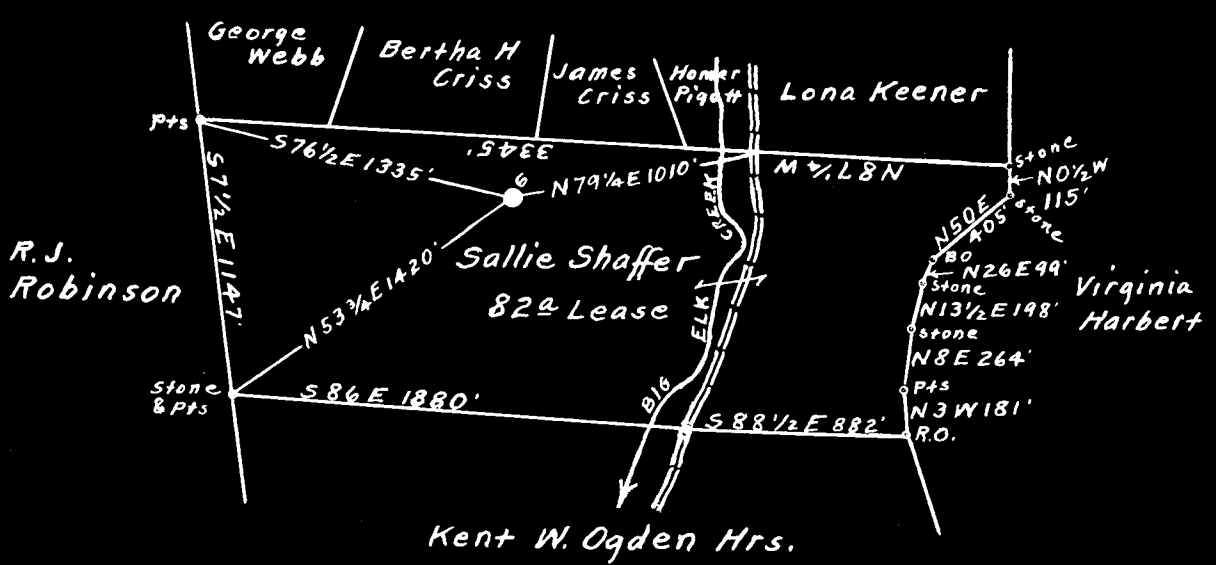

5.72 S
3.73 W

Surface owned by Thos E. Keyser, Harmony, Roane Co. W. Va.

Cool owned by Willis G. Tetrick, Jr. et al.
Address: Willis G. Tetrick, Jr. P.O. Box No. 267. Clarksburg, W. Va.

- New Location...
- Drill Deeper.....
- Abandonment.....

On 400' Map Sheet No. 3154, Sqs. S3 E 7-8.

Company Otis Eastern Service, Inc.
 Address Edgar L. Thompson Terrace Apts, NewMartinsville, W. Va.
 Farm Sallie Shaffer
 Tract _____ Acres 82 Lease No. _____
 Well (Farm) No. 6 Serial No. _____
 Elevation (Spirit Level) Floor-- 1373.12
Ground-- 1372.12
 Quadrangle Clarksburg
 County Harrison District Sardis
 Engineer Glen K. Huey
 Engineer's Registration No. 2011
 File No. _____ Drawing No. _____
 Date Jan. 26th, 1949 Scale 1" = 800 Feet

STATE OF WEST VIRGINIA
DEPARTMENT OF MINES
OIL AND GAS DIVISION
CHARLESTON

WELL LOCATION MAP

FILE NO. HAR-1309-A

- + Denotes location of well on United States Topographic Maps, scale 1 to 62,500, latitude and longitude lines being represented by border lines as shown.
- Denotes one inch spaces on border line of original tracing.



STATE OF WEST VIRGINIA
DEPARTMENT OF MINES
OIL AND GAS DIVISION

1115

WELL RECORD

Ab 1309-A

Permit No. 1309-A Oil or Gas Well Oil (KIND)

Company Otis Eastern Service, Inc.
Address Box 929, Charleston, W. Va.
Farm Sallie Shaffer Acres 84
Location (waters) Big Elk Creek
Well No. 6 Elev. 1373.12
District Sardin County Harrison
The surface of tract is owned in fee by Thos E. Keyser
Harmony Address Roane Co. W. Va.
Mineral rights are owned by Willis G. Tetrick, Jr.
Box 267 Address Charlottesville, W. Va.
Drilling commenced _____
Drilling completed Nov. 10, 1914
Date Shot _____ From _____ To _____
With _____
Open Flow _____ /10ths Water in _____ Inch
_____ /10ths Merc. in _____ Inch
Volume _____ Cu. Ft.
Rock Pressure _____ lbs. _____ hrs.
Oil _____ bbls., 1st 24 hrs.
Fresh water _____ feet _____ feet
Salt water _____ feet _____ feet

Casing and Tubing	Used in Drilling	Left in Well	Packers
Size			Kind of Packer
16			
13			
10	<u>292'</u>	<u>None</u>	Size of _____
8 1/2	<u>1530'</u>	<u>None</u>	
6	<u>2427'</u>	<u>2427'</u>	Depth set _____
5 3/16	<u>2923'</u>	<u>2923'</u>	
3			Perf. top _____
2" UR	<u>3168'</u>	<u>3168'</u>	Perf. bottom _____
Liners Used			Perf. top _____
			Perf. bottom _____

CASING CEMENTED _____ SIZE _____ No. Ft. _____ Date _____
COAL WAS ENCOUNTERED AT 1050 FEET 96 INCHES
_____ FEET _____ INCHES FEET _____ INCHES
_____ FEET _____ INCHES FEET _____ INCHES

Formation	Color	Hard or Soft	Top	Bottom	Oil, Gas or Water	Depth Found	Remarks
Pittsburgh Coal			1050	1050			
Big Line			2280	2330			
Pencil Cove			2260	2280			
Big Injun			2330	2457			
1st. Pay Gas			2923				
Gordon Stray			3068	3112			
Gordon Sand			3139	3168			
Oil			3149				
Total Depth				3168			
Torque Record							
Date	Size	Shell	Top	Bottom			
12-15-14	20	4x7	----	-----			
12-29-14	10	4x4	3149	-----			
9-11-17	20	4x7	3147	-----			

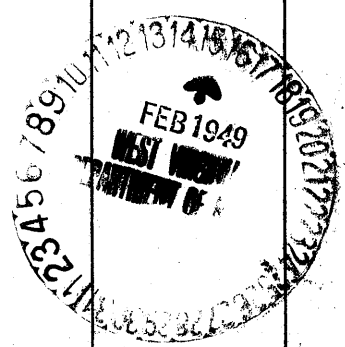

SARLIT SHAFTER NO. 6 WELL.

Sardis District, Harrison County, W. Va.

By Otis Eastern Service, Inc., Box 929, Charleston, W. Va.

Abandoned under permit Har-----A1

On 84 acres, on Elk Creek.

Elevation, 1373.12' L.

Surface owned by Thos. E. Keyser, Harmony, W. Va., and minerals by

Willis G. Petrick, Jr., Box 267, Clarksburg, W. Va.

Drilling completed Nov. 10, 1914.

Shot Dec. 15, 1914, with 20 qts., 4x7 shell; Dec. 29, 1914, with 10 qts.,
4x7" shell, top, 3149'; Sept. 11, 1917, with 20 qts., 4x7 shell,
top, 3147'.

10" casing, 292' (pulled); 8 1/2", 1530' (pulled); 6 3/4", 2427'; 5", 2923';
2" U. S. tubing, 3168'.

Coal was encountered at 1050-1058'.

Oil well. Record to Dept. of Mines stamped Feb. 15, 1949.

Record to RGT from Mrs. Griffith April 18, 1949. Old File No. 1115.

	Top.	Bottom.
Pittsburgh Coal	1050	- 1058
Big Lime	2280	- 2330
Pencil Cave	2260	- 2280
Big Injun Sand (shaly sand) (1st pay gas, 2923')	2330	- 2457
Gordon Stray Sand	3068	- 3112
Gordon Sand (oil, 3149')	3139	- 3168
Total depth		3168

1309A